

# SET FORM BY LAUFEN

## Countertop basin / cutable

### 81367.6



#### TECHNICAL DATA

Order no.	81367.6
Certified to	EN 31
Dimensions	1500 x 480 mm
Specification	Cutable to 900 mm, with 2 side cover to 930 mm Charge 104 – 1 centre tap hole
Special specification	Charge 108 – 3 tap holes Charge 109 – without tap hole
Weight	35,7 kg
Accessories excl.	Chromed frame, order no. 89267.6 also mirror available, order no. 44050.6 Side cover for cut surface left, order no. 87267.1 right, order no. 87267.2
Mounting acc. excl.	2x Mounting set M10 x 140 mm, order no. 89988.2

Otherwise When ordering the cut version use the  
order form for cutting

Colours see colour table

#### SPECIFICATION TEXT

Cutable countertop basin FORM BY LAUFEN, sanitary ceramic  
EN 31  
dimensions 1500 x 360/480 mm, symmetric  
1 centre tap hole  
Special feature: overflow channel glazed, cutable to 900 mm, integrated shelves  
Further options / accessories: Surface refinement LCC (only white),  
3 tap holes, without tap holes, chromed frame, side cover, bathtubs,  
furniture  
Order no. 81367.6

#### TECHNICAL DRAWINGS / S 1 : 20

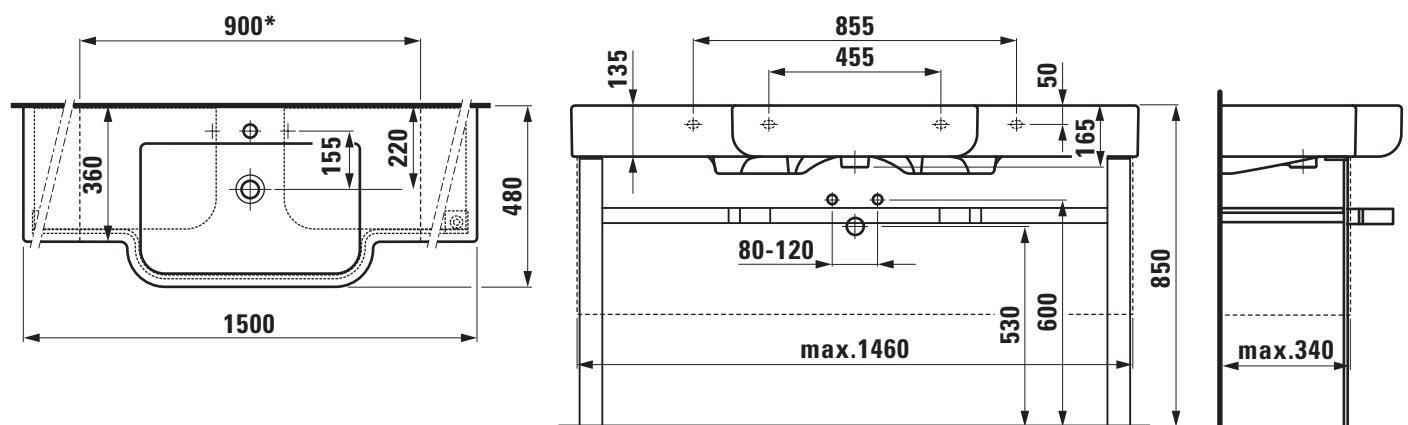

\* = minimum measure for cutting