





BarlowTyrie

**Monaco Swing Seat
1MOSW15**



- 1**  x 2 1309
 x 2 1946

- 2**  x 2 1515

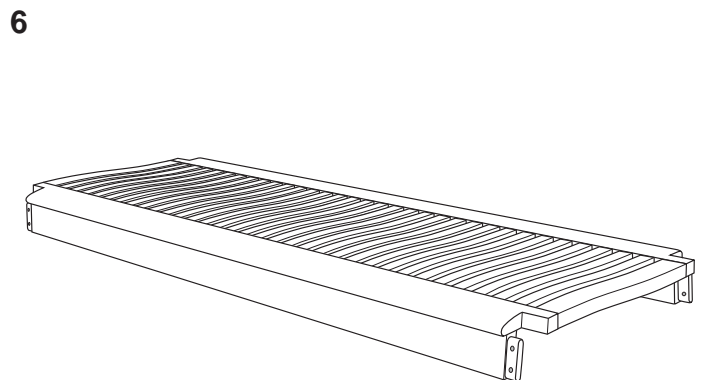
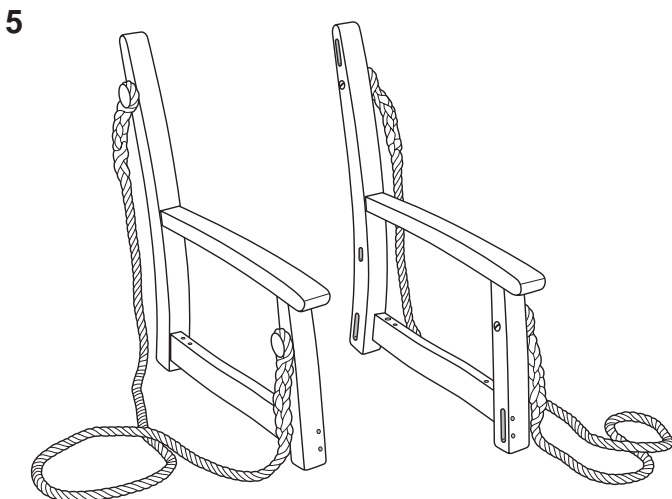
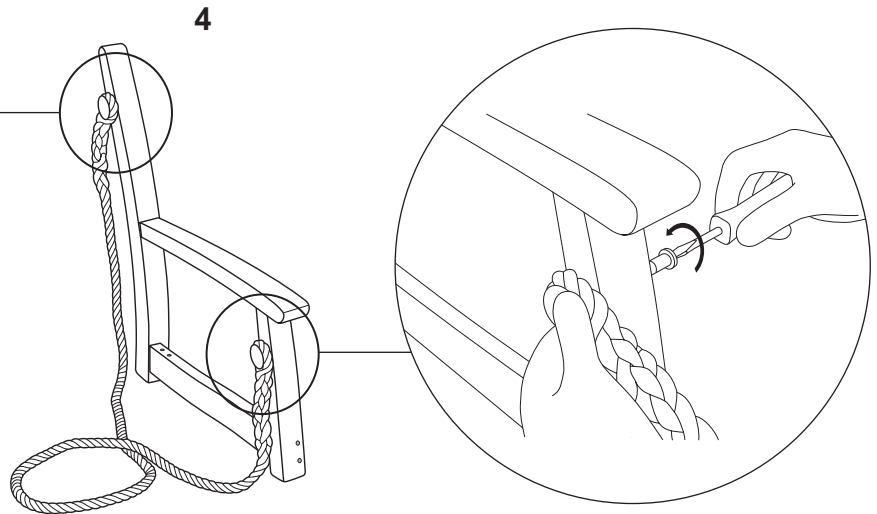
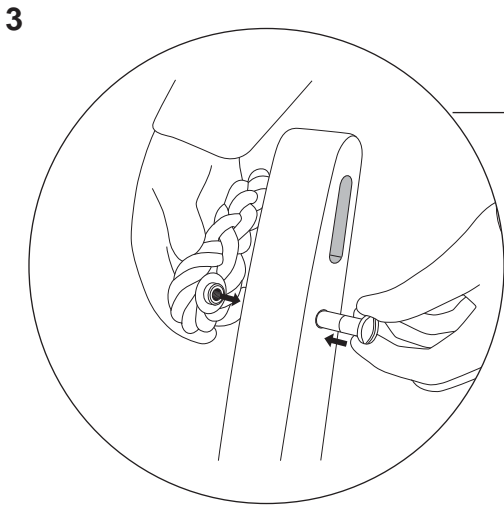
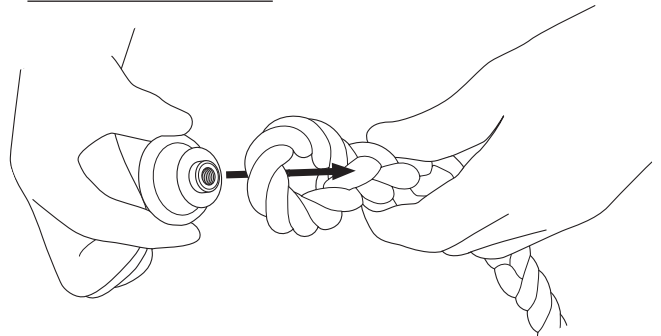
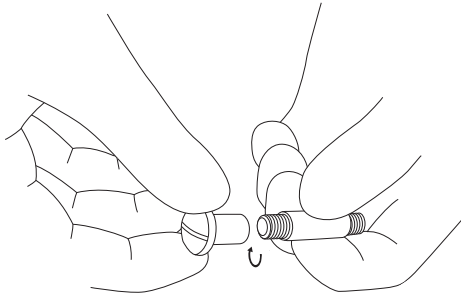



BarlowTyrie

**Monaco Swing Seat
1MOSW15**

7

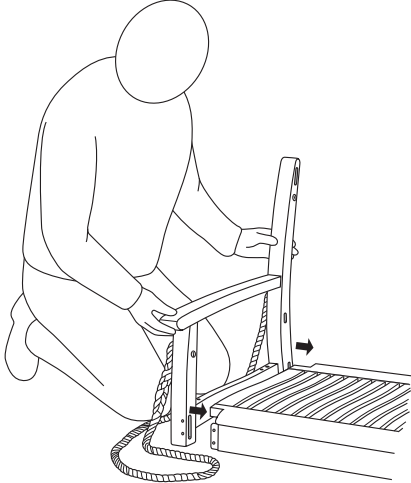

8

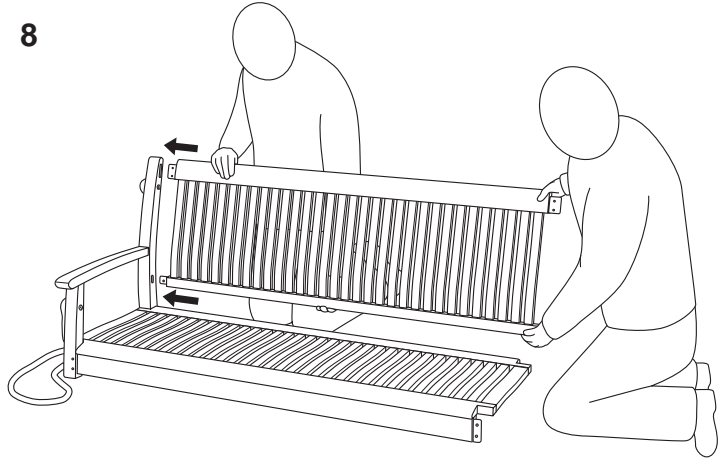

9

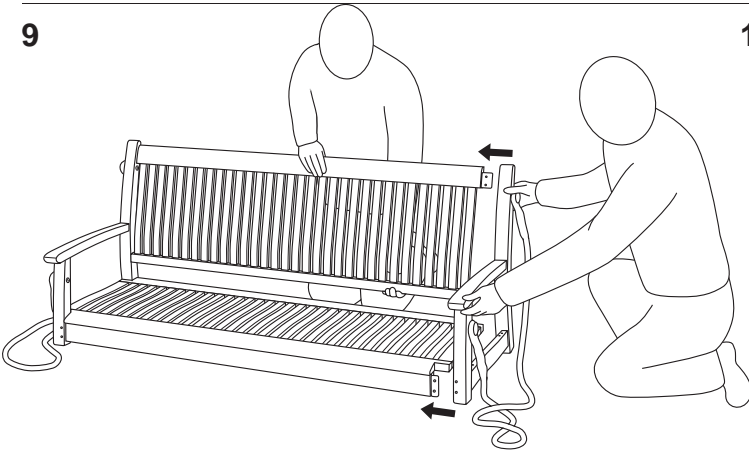

10

 x 4 2708 8mm Ø - 33mm

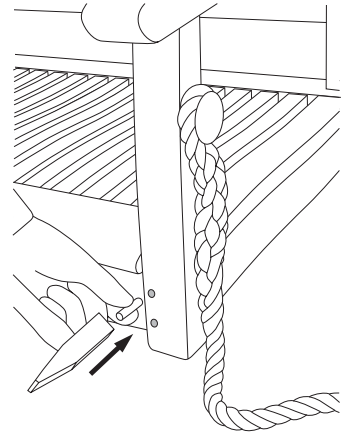

11

 x 6 2708 8mm Ø - 33mm

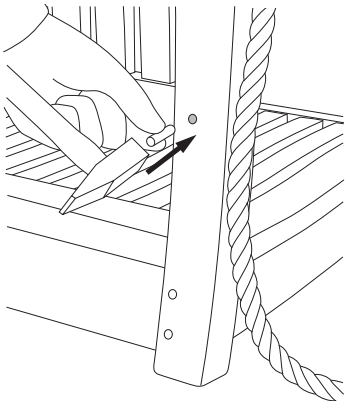

12

 x 4 2709 6mm Ø - 22mm

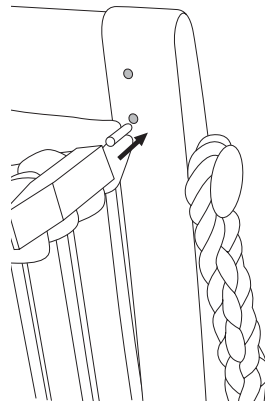



Barlow Tyrie

Monaco Swing Seat 1MOSW15

13

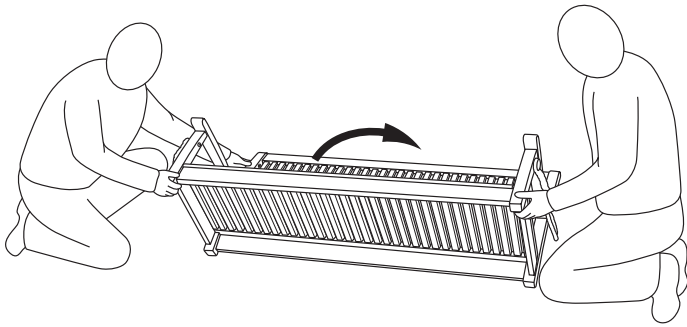

14

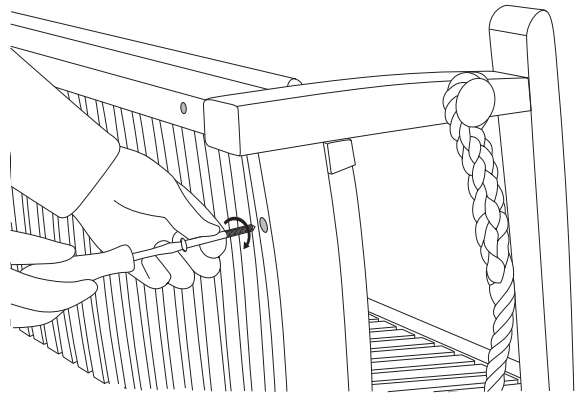
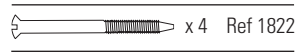

15

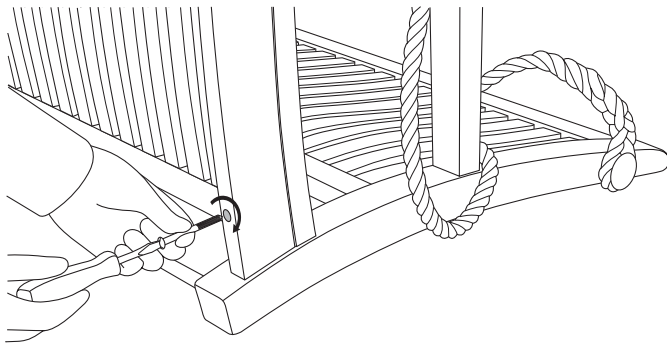

16

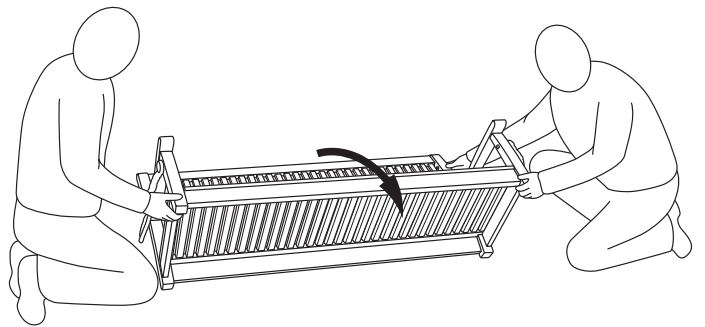

17

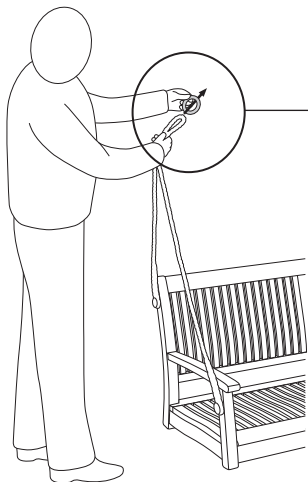

18

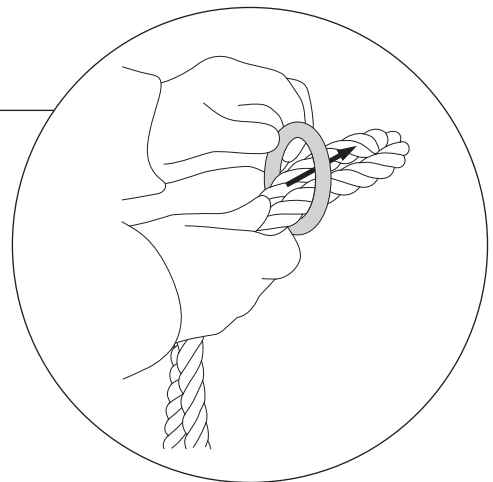



BarlowTyrie

**Monaco Swing Seat
1MOSW15**

19

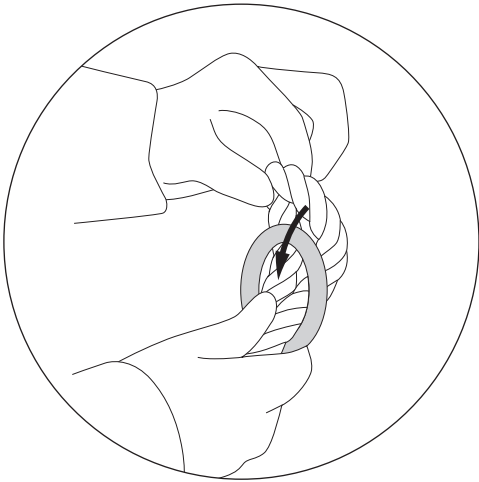

20

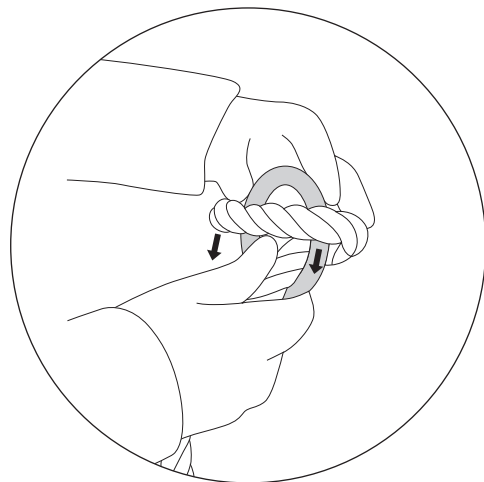

21

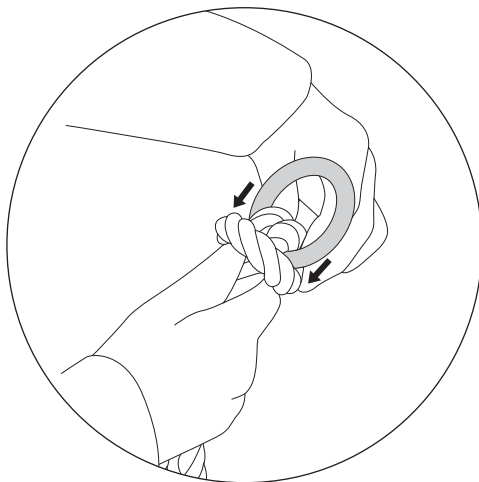

22

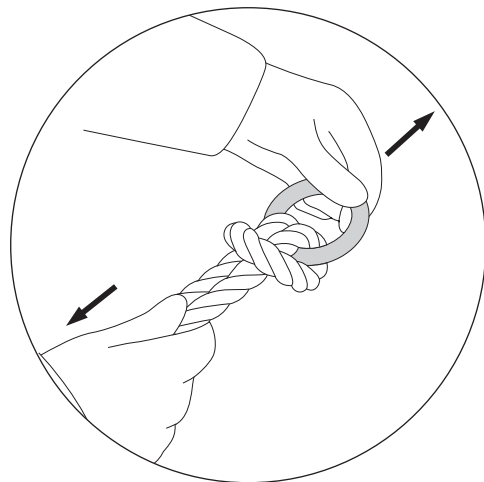

It is highly recommended that you seek professional advice for the hanging of your swing seat, especially if you intend to hang it from a ceiling where the joists may be concealed. Proper mounting hardware and chain (*not supplied*) sufficient to hold the expected weight load must be purchased dependent on the type of installation.

The safe installation of the swing seat is the responsibility of the purchaser, not Barlow Tyrie.

Nous vous recommandons vivement de faire appel à un professionnel pour fixer votre siège suspendu, particulièrement s'il doit être fixé à un plafond dont les poutres sont cachées. Quel que soit le type d'installation, il convient d'acheter la chaîne et les fixations appropriées (non fournies) capables de soutenir le poids en charge prévu.

L'installation en toute sécurité du siège suspendu incombe à l'acheteur et non à Barlow Tyrie.

Wir empfehlen wärmstens, sich vor dem Aufhängen Ihres Schaukelsessels von einem Fachmann beraten zu lassen, besonders wenn er an einer Decke mit verdecktem Gebälk aufgehängt werden soll. Je nach Art der Montage müssen die richtigen Befestigungsteile sowie eine Kette (nicht im Lieferumfang) gekauft werden, die stark genug sind, um die erwartete Last zu tragen.

Für die sichere Montage des Schaukelsessels ist nicht die Firma Barlow Tyrie, sondern der Käufer verantwortlich.

Het is sterk aan te raden om deskundig advies te vragen bij het ophangen van uw schommelstoel, vooral als u van plan bent om deze aan een plafond te hangen waarvan de balken niet zichtbaar zijn. Men moet montagegereedschap en een toereikende ketting (wordt niet bijgeleverd) voor de verwachte gewichtslast aanschaffen, afhankelijk van het type montage.

Veilige montage van de schommelstoel is de verantwoordelijkheid van de koper, niet van Barlow Tyrie.