



## PRODUCT SHEET

# MERIDIAN 50

60 x 36 x 20

Versatile by design.



© BAINULTRA®

### FEATURES

<b>Installation type</b>	- Drop-in - Alcove (3 walls) - Undermount
<b>No. of bathers</b>	1
<b>Heated backrest</b>	1
<b>Control</b>	MiaPlus
<b>ThermoMasseur® bath</b>	\$
<b>Soaker bath</b>	\$

### THERAPIES

<b>Chromatherapy 2-LED</b>	\$
<b>Sound Therapy (Euphonia™ System)</b>	\$

### COLORS

#### Standards



#### Optionals



### WARRANTY

<b>Controls*</b>	5 years
<b>Bath &amp; turbine*</b>	20 years
*Some restrictions apply   <a href="http://www.bainultra.com/warranty">www.bainultra.com/warranty</a>	



**IMPORTANT: KEEP THE ORIGINAL. PLEASE MAKE COPIES.**

MERIDIAN™: ELLIPSE 6036, ELLIPSE 7240, ELLIPSE 7842, MERIDIAN 50, MERIDIAN 55, MERIDIAN 60, PRO-MERIDIAN 55, PRO-MERIDIAN 60

 **BainUltra®**

The quest for your wellness™  
[www.bainultra.com](http://www.bainultra.com)

# MERIDIAN 50 60 x 36 x 20

## ACCESSORIES - OPTIONAL

Skirts	Littora \$	Elegance \$
<b>Drain &amp; overflow</b>	D-10 (17" - 22") - Chrome - White, Biscuit, Bone - Brass - Brushed nickel, Polished nickel, Oil-rubbed bronze	 \$ \$ \$ \$

<b>Control</b>	MiaMulti \$
<b>Cutting template</b>	# 90000006
<b>Others</b>	- Optional tile flange. \$ (specify right or left) - If ordered with an installed tile flange, the control will be shipped separately. - Available with flat deck for undermounting.

**TOTAL PRICE** \$

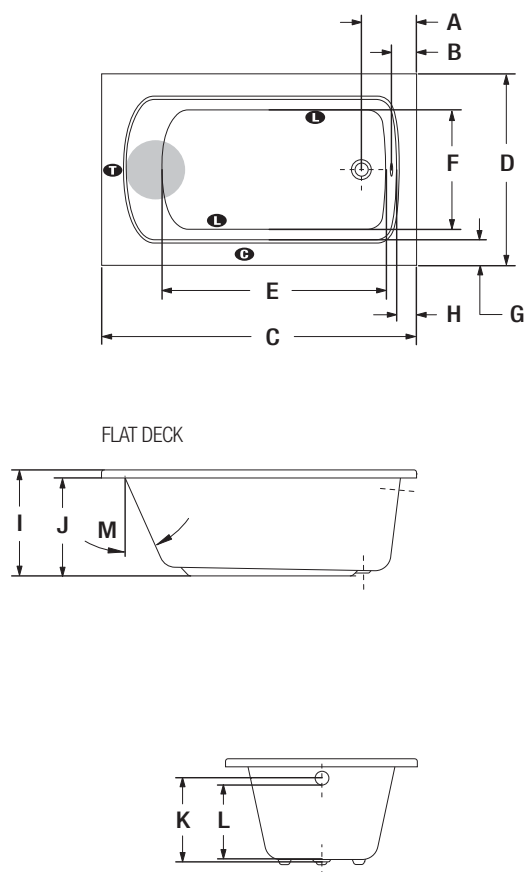

LETTER	DESCRIPTION	MEASURE
<b>A</b>	Outside edge to center drain	10 7/8"
<b>B</b>	Outside edge to overflow	4 1/8"
<b>C</b>	Total length	60"
<b>D</b>	Total width	36 1/2"
<b>E</b>	Bathing well length	42 3/8"
<b>F</b>	Bathing well width	22 3/4"
<b>G</b>	Deck width at backrest end	4 1/4"
<b>H</b>	Deck width	3 7/8"
<b>I</b>	Height from bottom of tub to top deck	20 1/4"
<b>J</b>	Height from bottom of tub to bottom of lip	18 3/4"
<b>K</b>	Height from drain to center of overflow	15 7/8"
<b>L</b>	Maximum water level	14 1/4"
<b>M</b>	Slope of backrest	24°

**T** Indicates turbine position  
**L** Indicates LED light position  
**C** Indicates control position when factory-installed

## MERIDIAN 50 TECHNICAL SPECIFICATIONS

<b>Jets</b>	40	<b>Hot water supply required</b>	Should be 70% of water capacity of tub or greater.
<b>US gallons</b>	45	<b>Turbine access</b>	Must be at least 18" X 22" to access the pump. Must be connected to a 15 A. 120 V, 60 Hz, protected by a ground-fault circuit interrupter (GFCI) on a dedicated line.
<b>Imp. gallons</b>	38	<b>Standards</b>	All BainUltra products meet and/or exceed the highest quality and certification standards. For further details about BainUltra's product standards, please go to the following link: ( <a href="http://www.bainultra.com/standards">www.bainultra.com/standards</a> ).
<b>Approx. shipping weight</b>	124 lbs	Our products must be installed by certified professionals only and according to our Owner's Manual as well as federal, provincial/state and local building codes and regulations ( <a href="http://www.bainultra.com/documentation">www.bainultra.com/documentation</a> ).	
<b>Turbine power</b>	755 W		
<b>Air heater</b>	700 W		

1 800 463.2187 | From 8 a.m. to 8 p.m. Monday to Thursday (EST) . From 8 a.m. to 5 p.m. on Friday (EST)

The specifications shown indicate the outer edge dimension and the inside bathing capacity dimension measured at air jets' height. The manufacturer accepts a 1/4" [0.64 cm] variance. There are variations on each product and specifications are subject to change as we improve upon our product as required. The dimensions needed for site preparation and structure building will differ. BainUltra® assumes no responsibility for preparatory work done prior to the product being on site.