

FIXTURE NO.: W-110 PLANAR CREVASSE SCONCE		TYPE:
DRAWN BY: DsS	DATE DRAWN: 9/26/12	1:8
REVISED BY: PTO	DATE REVISED: 10/02/12	REV: B

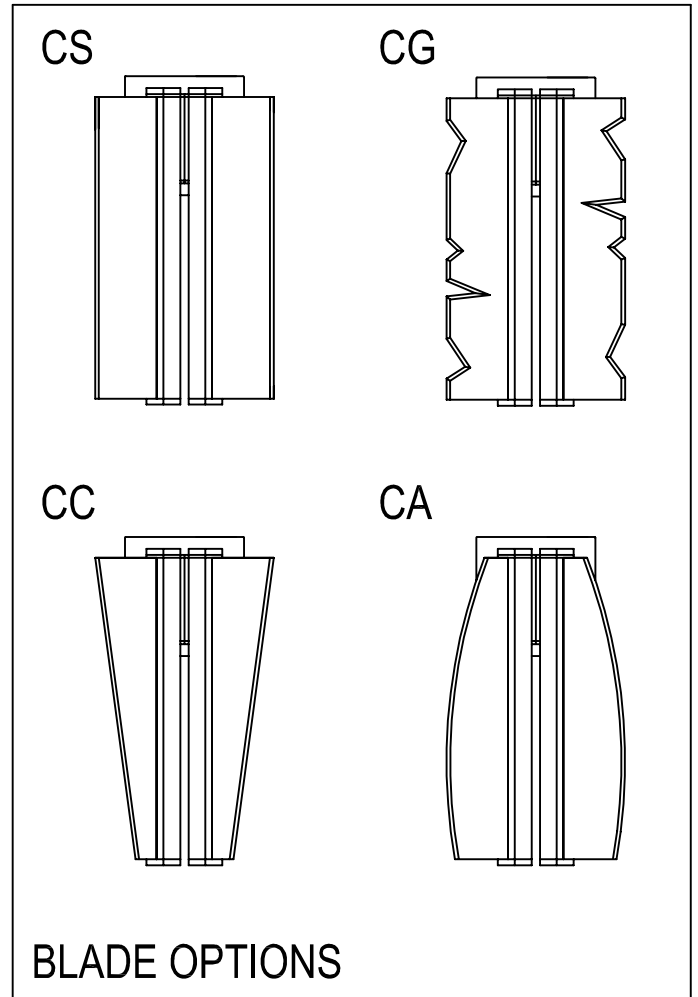
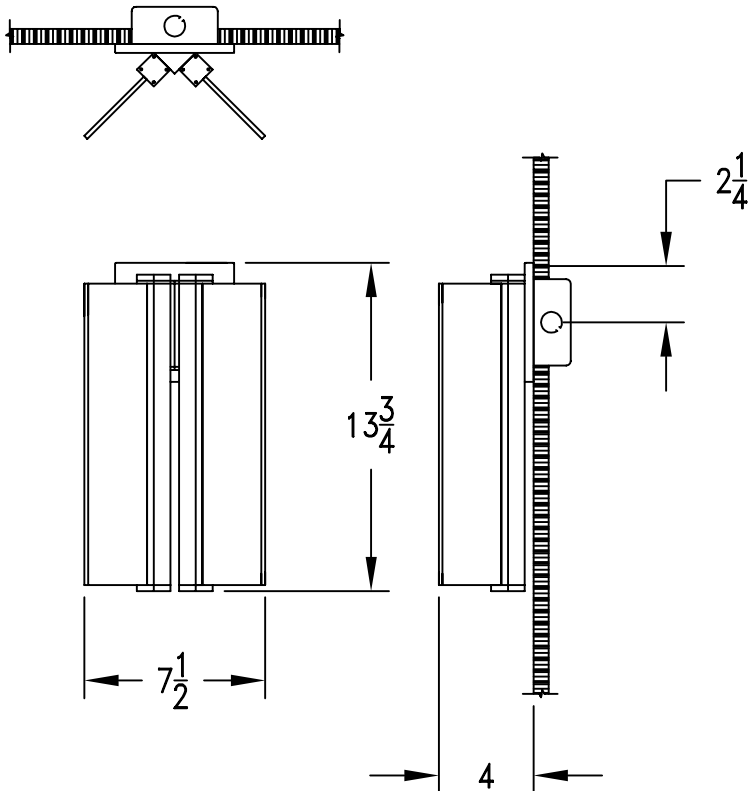

SPECIFICATIONS

PATENT PENDING - DESIGN MODIFICATION RIGHTS RESERVED © 2012 DIGITAL SPECK LIGHTING by Manning

HOUSING: W-110 – CUSTOM EXTRUDED FRAME MEMBERS, MACHINED ALUMINUM BODY COMPONENTS, WITH A FAB CANOPY & MOUNT.

BLADES: (2) OPTICALLY CLEAR, 4.5mm THICK, LASER CUT AND LIGHT GUIDE DISTRIBUTION ENHANCED, ACRYLIC PLANAR OPTIC.

SPECIFY BLADE DESIGN OPTION: ☐ CS ☐ CG ☐ CC ☐ CA

LAMPING: 4L7C40 – (4) INTEGRATED LED STRIPS = 28 WATTS, 2940 Lm, 4000K, 82 CRI, L70–60,000 HR.

DRIVER: UNIVERSAL VOLTAGE AND 0–10 DIMMING ARE AVAILABLE ON MOST SOLID STATE CONFIGURATIONS.
PLEASE CONSULT FACTORY WITH YOUR SPECIFIC CONTROL SYSTEM FOR VERIFICATION OF COMPATIBILITY.

FINISH: ANODIZED ARCHITECTURAL BLACK OR MATTE SILVER WITH BLACK ANODIZED OR POWDER COAT COMPONENT DETAILS.

SPECIFY ANODIZED OPTION: ☐ ZB – ANODIZED BLACK ☐ ZS – ANODIZED SILVER

MOUNTING: FIXTURE MOUNTS TO A STANDARD OCTAGONAL JUNCTION BOX. ALL MOUNTING HARDWARE TO BE SUPPLIED BY OTHERS.
FIXTURE IS SUITABLE FOR USE IN INTERIOR "DRY" LOCATIONS, WITH UL RECOGNIZED COMPONENTS.

WARRANTY: DIGITAL SPECK LIGHTING by Manning: 5 YEARS.

APPROVED: _____ DATE: _____