

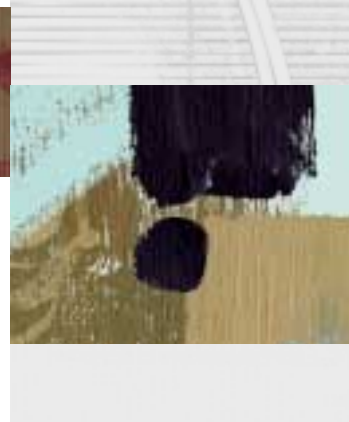

NEVERS®

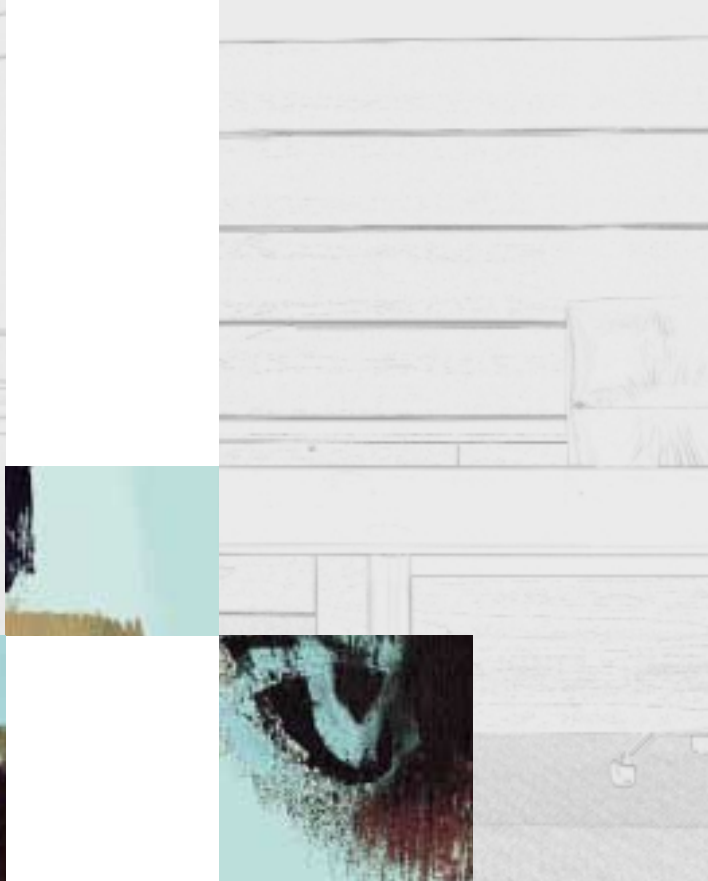



NEVERS®

FOR THE COMPLETE MEETING ROOM

Eventi™
Seminario™
Americana™

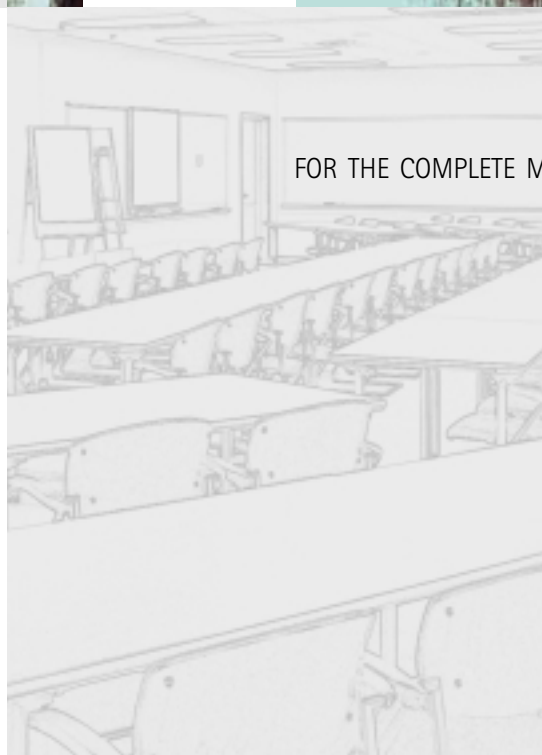





MEETING SPACES. ALWAYS THINK NEVERS.

The office is a place where people meet.

When they do it more effectively, business prospers.

When you think about furnishing these spaces, think Nevers.

- We understand what it takes to create meeting room solutions that help people get together productively, whether to meet, present, learn, brainstorm, or create.
- It's all we do—today, as we have for the past 30 years, we focus on furniture solutions for meeting, conferencing, and collaborative workspaces.

From their exquisite design to their ingenious methods for integrating technology, our furnishings foster more effective communication.



YOU STRIVE. WE RELATE.

It used to be that "do more with less" was a worthwhile goal. Now it's a fact of business life.

The landscape of work is changing—from cubicles only to a much higher percentage of space used for collaboration.

At Nevers, we understand that the new realities of the office require new ways of furnishing space. We address these issues in three ways.



SUPPORT CHANGE.

Savvy managers know that business success depends on an ability to change. We make our furnishings so they reconfigure easily—whether on the micro or macro scale. That way, you can rearrange meeting, conferencing, and collaborative spaces to seize market opportunities as they arise.

INTEGRATE TECHNOLOGY.

Technology's transformation of the office continues, nowhere more so than in meeting, conferencing, and collaborative spaces. We design furnishings that support new technologies, whether they bring people together face-to-face or virtually, so organizations get the most from their investment.

REACH THE NEXT LEVEL.

Regardless of economic conditions, organizations are constantly searching for ways to better use their resources. We enable people to contribute at their most productive level by developing solutions that encompass their needs for function, equipment and furnishings.

YOU REQUIRE. WE PROVIDE.

Defining requirements marks the starting point of every conversation with our customers. Our straightforward process ensures that we understand who will use a space and for what purpose.

Once we gain this understanding, we can propose effective solutions that meet your functional needs, address technology requirements, and provide appropriate furnishings.

Key components of these solutions include our extensive furniture collections for boardrooms, conference rooms, training rooms, teaming spaces, and other collaborative environments.



Eventi



Seminario



Americana



The Eventi™ Collection combines modern design with unprecedented customization capabilities and an incredible degree of modular flexibility. Our unique collaboration with Italian designer Roberto Danesi ensures that Eventi delivers both aesthetic choice and practical function.

The Seminario™ Collection brings contemporary European styling to seminar, training, meeting, and multi-purpose rooms. Through an exclusive arrangement, we are able to offer this Daniel Figueroa design created for Drabert GmbH.

The Americana™ Collection designed by Nevers' founder Gerald Evenstad offers a wide range of meeting and conference room furnishings. Its enduring popularity demonstrates the appeal of attractive appearance combined with contemporary performance.

The signature aesthetics and innovative utility of these collections result from one simple fact: we direct all of our energy and resources to making furniture that helps people work together more effectively.



YOU EXPECT. WE DELIVER.

Based on what you do and how you do it, your organization has unique requirements.

Anyone can claim to address them.

We think it's more eloquent to show how we've helped others reach their goals for spaces that are functional and aesthetically pleasing.

Here is a case in point.

A pharmaceutical company, in bringing all its employees under one roof, noted that much of people's best work resulted from collaboration.

Nevers worked with the company to define and deliver a solution that integrates technology and provides easy reconfiguration to support this collaborative work.

PROJECT

INDUSTRY: PHARMACEUTICAL

INTERIOR AND EXTERIOR ARCHITECTURE, DESIGN AND CONSTRUCTION:
RYAN COMPANIES US, INC., GREGORY E. MADSEN, SENIOR ARCHITECT

FURNITURE COLLECTIONS: EVENTI AND SEMINARIO BY NEVERS

FURNITURE DEALER: WILLIAM J. BUSINESS INTERIORS

AUDIO VISUAL SYSTEMS: AVI SYSTEMS

SCOPE: BOARDROOM
COMMON CONFERCING
DEPARTMENTAL CONFERCING
TRAINING
CAFETERIA

LOCATION: MINNEAPOLIS

TOTAL FLOOR AREA: 200,000 SQUARE FEET

NUMBER OF FLOORS: 3

BOARDROOM

REQUIREMENTS

The boardroom is the place where senior management makes critical business decisions and welcomes important guests. The client required a seamless integration of technology into a comfortable, well-appointed boardroom.

SOLUTION

The custom cherry table, situated to take full advantage of the natural light from the panoramic windows, is the focal point of the room. The technology in the room is incorporated into the furniture and millwork so that it does not intrude on the activities of participants. Materials and finishes reflect the company's industry leadership and stability.

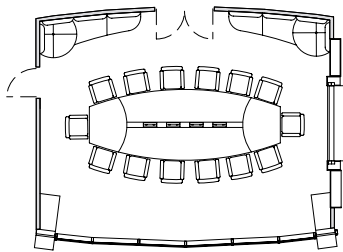

EVENTI BOAT SHAPE TABLE WITH CRESTRON TOUCH PANEL CONTROLLER





COMMON CONFERENCING

REQUIREMENTS

Employees needed a variety of functional spaces that would enhance productivity and collaboration. They reserve these rooms using an appointment system.

SOLUTION

All employees have access to common conference rooms. These rooms include collaboration areas, "soft" conferencing areas for informal conversations, 3-to-5-person enclaves as well as multipurpose rooms with technology integration and presentation capabilities.

FIVE PERSON ENCLAVE



SOFT CONFERENCING WITH NEVERS HOSPITALITY CART AND DAVIS FURNITURE







EXECUTIVE BOARDROOM

CONFERENCE TABLE: EVENTI BOAT SHAPE WITH CUSTOM BASE, AMBER CHERRY FINISH AND MAHARAM SIMULATED LEATHER.

HOSPITALITY UNITS: CUSTOM MILLWORK

SEATING: LEATHERCRAFT

TECHNOLOGY EQUIPMENT:

NEVERS POWERCHANNEL PVD SYSTEM

CRESTRON TOUCH PANEL CONTROLLER

DA-LITE 16:9 REAR SCREEN PROJECTION SYSTEM

SONY HIGH BRIGHTNESS LCD VIDEO PROJECTOR

CLEAR ONE-GENTNER AUDIOCONFERENCE SYSTEM

JBL PROGRAM AUDIO SYSTEM



DEPARTMENTAL CONFERENCING

REQUIREMENTS

The client required multiple departmental conference rooms that could be used in many different ways—from financial reviews to collaborative problem-solving sessions to training seminars—often in the same day.

SOLUTION

The Eventi modular tables reconfigure quickly and still accommodate full PVD/AV integration. Technology in these rooms supports presentation and communication capabilities. Materials and finishes are consistent with those used throughout the project.

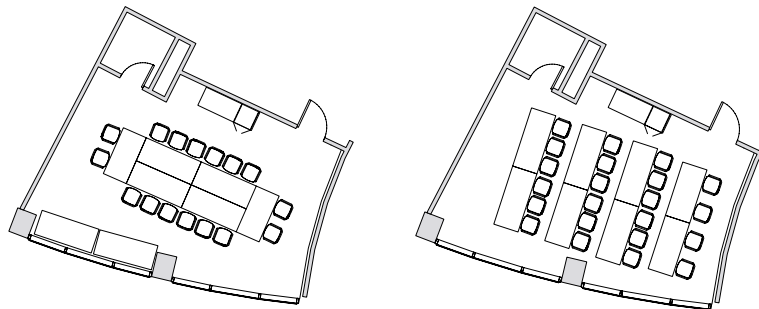

EVENTI TRIANGLE TABLE: BOARDROOM AND CLASSROOM STYLE CONFIGURATIONS



COMMON CONFERENCING

CONFERENCE TABLE: EVENTI TRIANGLE MODULAR SYSTEM,
AMBER CHERRY FINISH.

PRESENTATION BOARDS: CUSTOM WALLTALKER BY NEVERS

SEATING: HAWORTH X-99

TECHNOLOGY EQUIPMENT:

NEVERS POWERCHANNEL PVD SYSTEM

SONY FRONT PROJECTION LCD SYSTEM

SMART TECHNOLOGIES 72" SMART BOARDS

JBL PROGRAM AUDIO SYSTEM

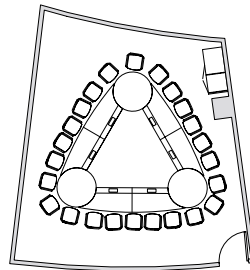





DEPARTMENTAL CONFERENCING

CONFERENCE TABLE: EVENTI MODULAR TABLES, AMBER CHERRY FINISH.

PRESENTATION BOARDS: CUSTOM WALLTALKER BY NEVERS

STORAGE AND HOSPITALITY: NEVERS BUFFET HEIGHT CREDENZA (E-VERSION)

INCORPORATES STONE SERVING SHELF, TRASH MANAGEMENT AND ELECTRONICS STORAGE

THE TRAINING CENTER

REQUIREMENTS

The training center is the educational hub of the corporation. It serves the company's employees, sales force, distributors, and retailers. It requires versatility, utility, and comfort in order to make it a productive space.

SOLUTION

The training center features movable walls for subdivision into three rooms. Participants can enter or exit from the rear of the room or through the full-width garage doors on the side. A kitchen adjacent to the garage doors facilitates food and beverage service. A Nevers electronic lectern serves as a command center for the room. The lectern electronically controls all room functions, including, lights, sound, video, LCD projection, and room dividers. Nevers Seminario tables provide a rugged, flexible system for organizing the space into classroom, seminar, conference, and breakout configurations.

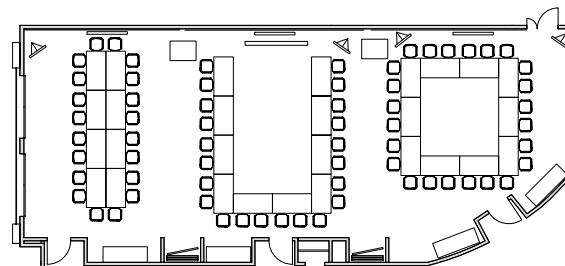
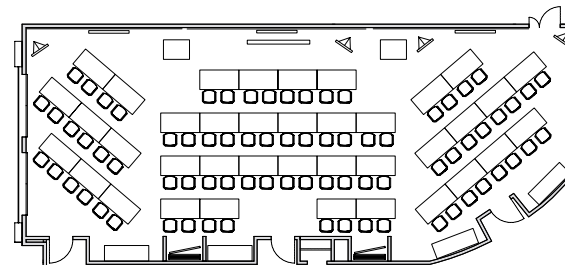
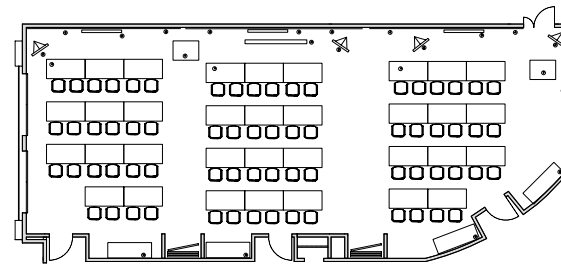





DEPARTMENTAL CONFERENCING

CONFERENCE TABLE: EVENTI TABLES,
AMBER CHERRY FINISH.

PRESENTATION BOARDS: CUSTOM WALLTALKER™
BY NEVERS, SMART INTERACTIVE BOARD

SEATING: HAWORTH X-99

TECHNOLOGY EQUIPMENT:
NEVERS POWERCHANNEL PVD SYSTEM
SONY FRONT PROJECTION SYSTEM
SMART TECHNOLOGIES 72" SMART BOARDS
JBL PROGRAM AUDIO SYSTEM

HUMAN RESOURCES CONFERENCE ROOM.



NEVERS POWERCHANNEL PVD SYSTEM



NEVERS POWERCHANNEL ENCLOSURE



NEVERS POWERLEG THROUGH-FLOOR INSTALLATION







CAFETERIA

REQUIREMENTS

Beyond providing a relaxing, functional space for employees to have lunch, the company wanted to use the cafeteria space effectively at other times during the day. This required the ability to reconfigure the space easily to accommodate other functions, such as large meetings or presentations.

SOLUTION

Nevers Seminario tables and chairs provide a functional solution that suggests a café as opposed to a traditional food-service setting. Soft seating around the fireplace offers a casual place for informal discussions. Dining booths with Seminario tables line the perimeter of the space. Using a Seminario rolling easel converts these booths to small meeting areas with enhanced privacy.

LUNCH TABLES: SEMINARIO ROUND TABLE, P-LAM WITH NATURAL CHERRY EDGE

CHAIRS: SEMINARIO STACKING CHAIRS WITH MOLDED CHERRY PLYWOOD/UPHOLSTERED SEAT AND BACK

EASEL: SEMINARIO ROLLING EASEL

SOFT SEATING: KEILHAUER

BAR STOOLS: PATRICIAN

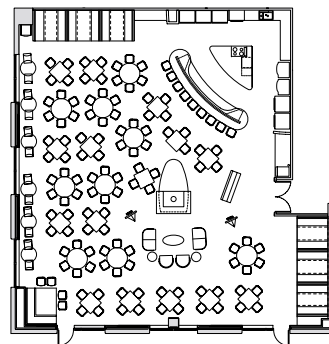





TRAINING CENTER

TABLES: SEMINARIO RECTANGULAR TABLE. P-LAM WITH 3MM PVC EDGE. CAM-LOCK ADJUSTABLE LEG SYSTEM.

STORAGE AND HOSPITALITY UNITS: NEVERS BUFFET HEIGHT CREDENZA (E-VERSION) INCORPORATES STONE SERVING SHELF, TRASH MANAGEMENT AND ELECTRONICS STORAGE.

LECTERN: NEVERS CUSTOM ELECTRONIC LECTERN WITH INTEGRATED DOCUMENT CAMERA AND TOUCH SCREEN CONTROLLER.

SEMINARIO LEG SYSTEM.





THE NEVERS COLLECTIONS

Eventi

Articulating Tables

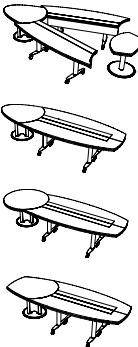

Modular Tables

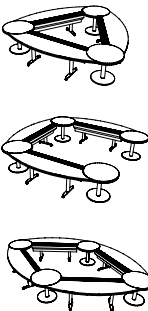

Eventi Executive Conference Tables

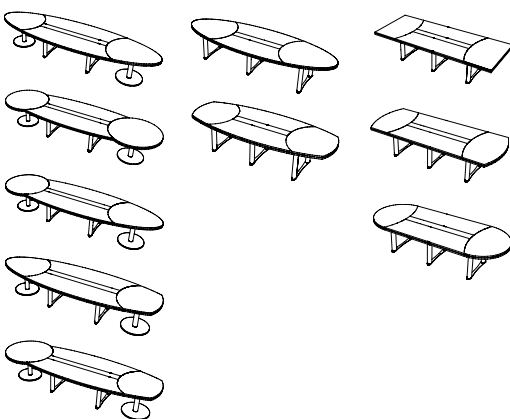

Eventi Dué Conference Tables

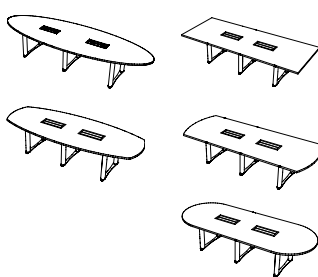

Eventi Dué Small Meeting Room Tables

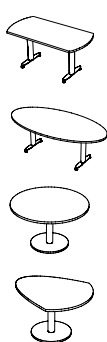

Eventi Dué Mobile Tables



Seminario

Tables

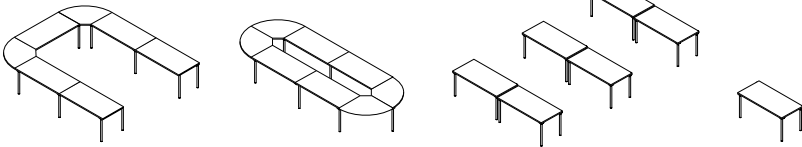

Mobile Lectern

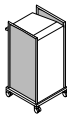

Mobile Carts

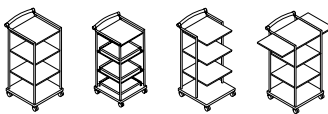

Mobile Storage

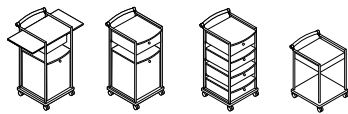

Americana

Conference Tables



Modular Tables

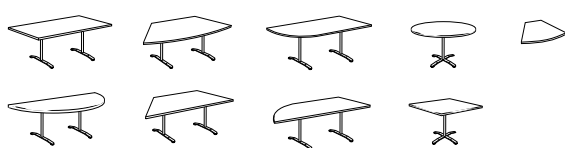

Visual Et Power Boards

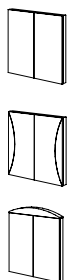

Wallworks



Casegoods

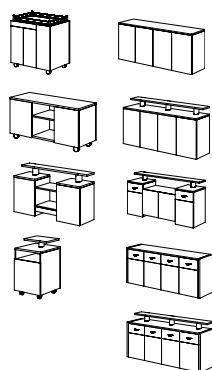

Media Wall

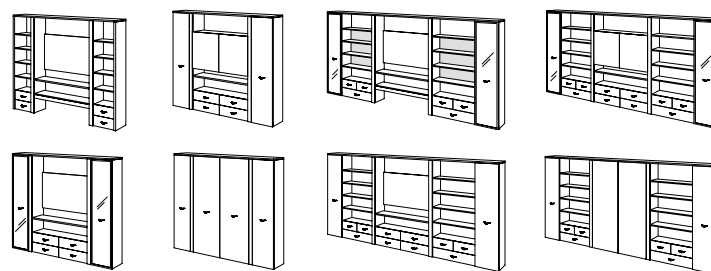

Mobile Presentation

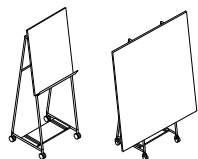

Mobile Personal Table



Seating

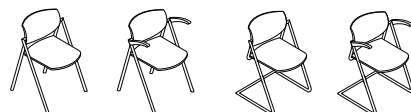

Visual Presentation



Lecterns

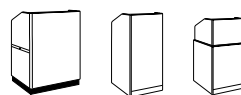

VCR/TV Consoles and Cabinets

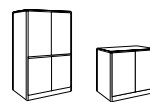

Storage Credenzas and Hospitality Carts



MEETING SPACES. ALWAYS THINK NEVERS.

NEVERS INDUSTRIES

14125 21st Avenue North
Minneapolis, Minnesota 55447

P: 763.553.1632

F: 763.553.1770

T: 800.242.2443

info@nevers.com

www.nevers.com



NEVERS®

LIT13030