

LEUCOS®

INSTALLATION INSTRUCTIONS GOLF S/ST - NELLY S/ST with canopy A and transformer with canopy C without transformer

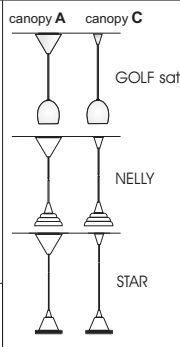

A1 Enclosed For self-shielded tungsten halogen lamps. One installer Save instructions Revised 23 June 2004

CAUTION, RISK OF FIRE - REMOTE TRASFORMER MUST BE AN ISOLATING TYPE TRANSFORMER IN ACCORDANCE WITH THE NATIONAL ELECTRICAL CODE, ARTICLE 250-5A - THIS FIXTURE MUST BE FUSED FOR 5 A MAX- ALL THE ASSEMBLY OPERTIONS HAVE TO BE CARRIED OUT BY SPECIALIZED PEOPLE ATTENTION: DISCONNECT ELECTRICITU BEFORE INSTALLATION.

- 1a - **Rose A:** Open the protective housing with the screw placed on the side.
- 2a - Take out disc "N" and the box "X"
- 3a - Connect the protective housing including the trasformer to the disc, leading the ectrical cable through the transformer's centre. Fasten with screw "A".
- 4a - Connect the electrical cable to the upper part of washer "B", voltage 120V.
- 1c - **Rose C** - Place the inner bracket "M" to the ceiling by two holes "T" provided.
- 5 - Open the capsule "O" at the end of the cable.
- 6 - Before cutting the pipe pull out the cables at least 5.3/4".
- 7 - Cut the pipe in desired length. Replaces the lampholder "P" in the site as shown in 5.
- 8 - Connect lampholder "P" and pipe as described in picture 8, close the two halves "O" of the lampholder with respective screw.
- 9 - Connect lampholder and capsule by using screw "J" provided..
- 10 - Guide the pipe inside the hole of the glass holder ring and then release the three springs "Q" of lampholder "D" inside the three corresponding holes of the ring.
- 11 - Push now the lamp glass and the cover "E" in the proper order (as picture 11 shows) over the pipe untill everything is in the right position.
- 12a - **Rose A** - Fix the pipe by fastening the screws of the locking washer "F".
- 13a - Connect the cables of the lamp to washer "C", voltage 12V, and fasten them with the locking washer "G". It is very important to leave around 4" of cable between washers "F" and "G". Close the protective housing with respective screws.
- 12c - **Rose C** - Insert the rubber ring "A" on the pipe and than the protective housing as shown in picture: -Loosen the plastic screw "F". -Insert the pipe on the hole "G" and lock it strongly by the same screw.
- 13c - Connect wires to the terminal connector "H" 12Volts, than plug the terminal into the inner bracket provided as shown in picture. Slide up the protective housing "C" and lock it by the rubber ring "A".
- 14 - Put the bulb into the socket and secure it with the spring holders.

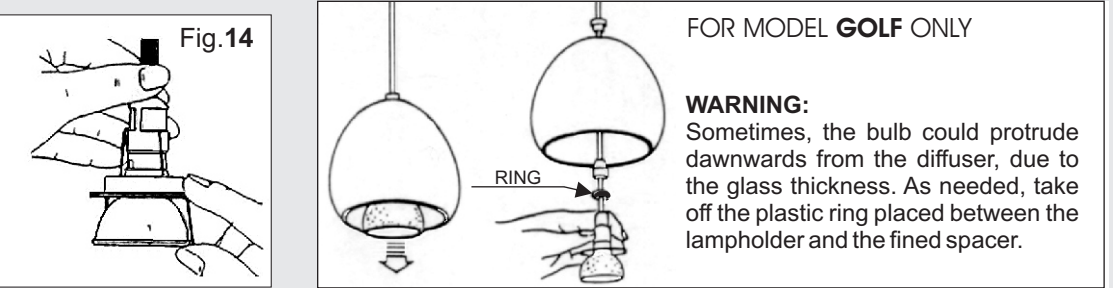
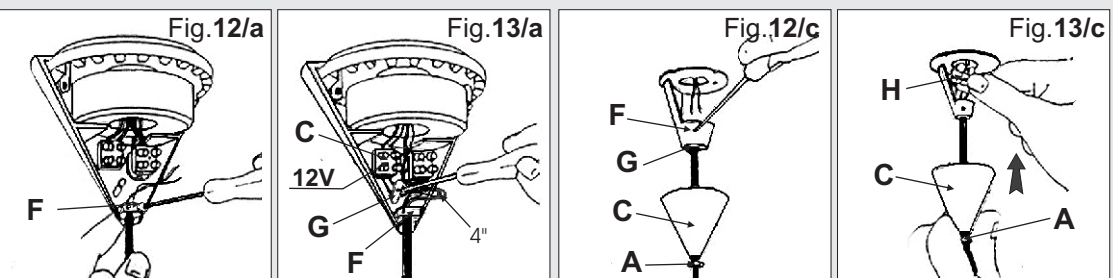
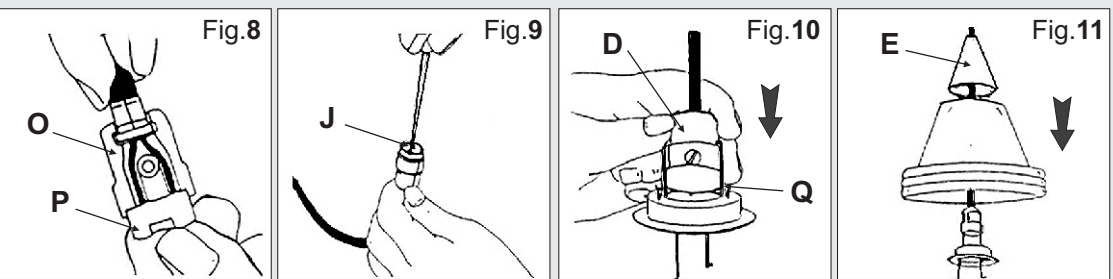
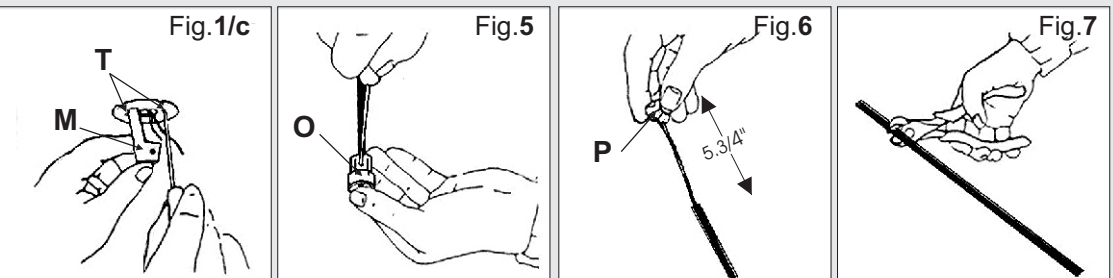
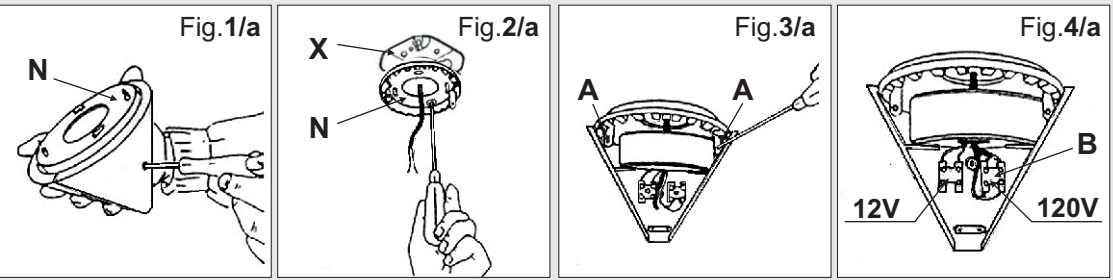

GOLF - STAR - NELLY pendant max 1x50W 12V GX 5,3 Type Mr 16

Minimum distance between lamp and objects 0.5m

WARNING - This lamp can not be installed with power regulator or dimmer. GIVEN THE FEATURES OF ACID FINI GLASS, TO CLEAN DO NOT USE PRODUCTS WITH ALCOHOL OR SOLVENTS ABSLUTELY.

For additional informational please contact your local dealer or **LEUCOS U.S.A.** At: Tel. (732)225-0010 - Fax (732) 225-0250

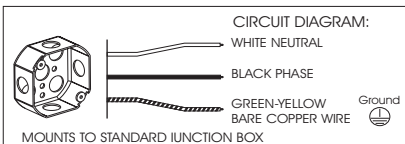

FOR MODEL **GOLF** ONLY

WARNING: Sometimes, the bulb could protrude dawnwards from the diffuser, due to the glass thickness. As needed, take off the plastic ring placed between the lampholder and the fined spacer.