

# Lightedge® Curved Wall

## Installation Planning Guide

Type:

Project:

7" x 2" Wall Mount

### MOUNTING DETAIL

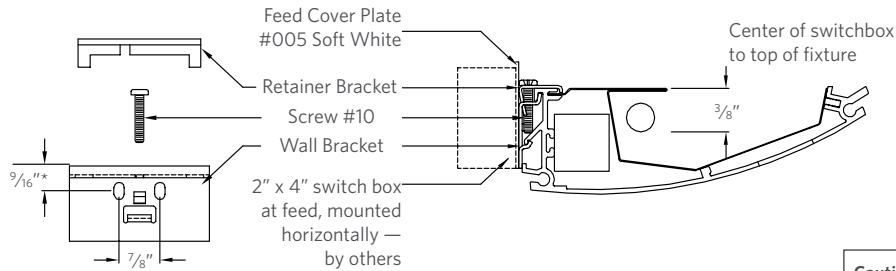

\*Dimension shown is from mounting hole to top of fixture

#### Caution:

Wall must be adequately reinforced at support locations for sound structural and aesthetic installations of the luminaire — by others

### JOINING DIAGRAM

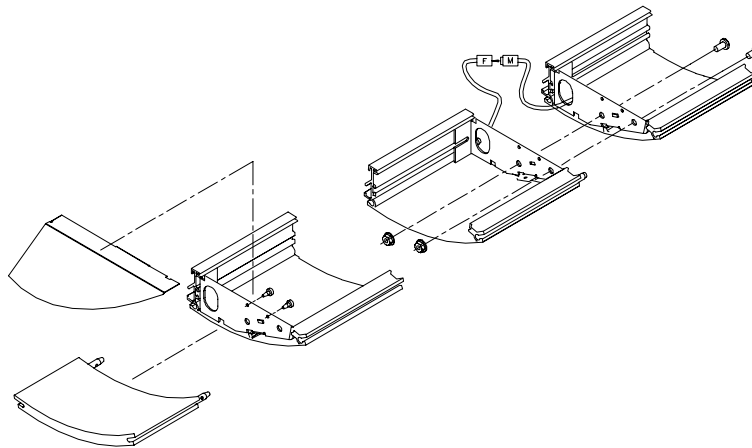

### WEIGHTS AND SUPPORT SPACING

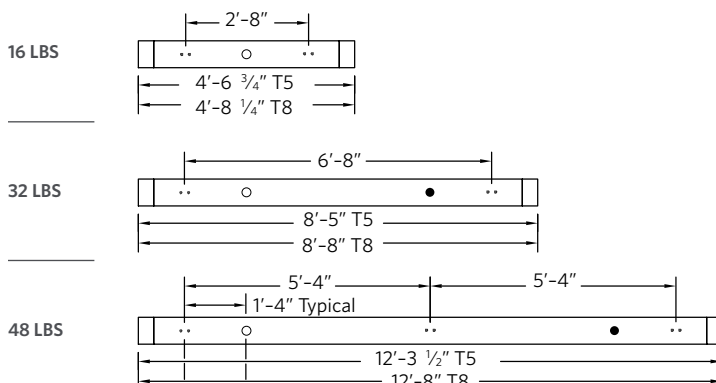

#### Notes:

- 4' emergency module always at end of section and requires separate power feed.
- Emergency battery pack operates 1 lamp only.

#### Key:

- Support location
- Feed location
- EM feed location