

## Installation Planning Guide

Type:

Project:

6" x 2" Curved

### UNIVERSAL MOUNTING BRACKET (F1)

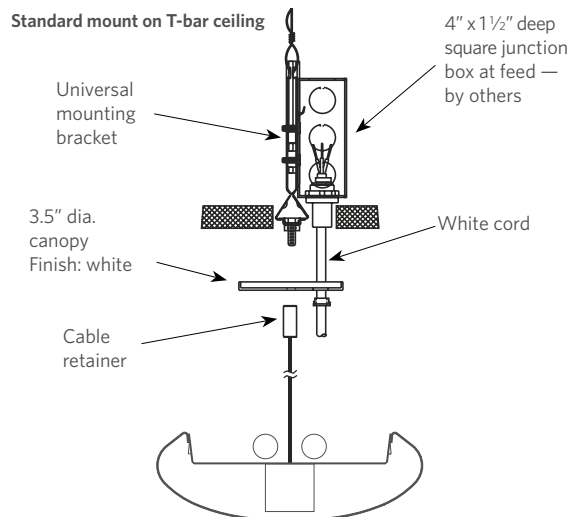

### HORIZONTAL J BOX MOUNT (F2)

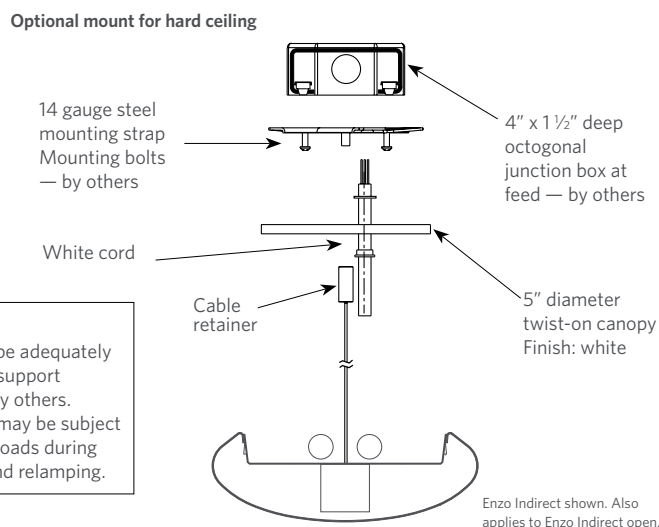

**Caution:**

- Ceiling must be adequately reinforced at support locations — by others.
- Junction box may be subject to additional loads during installation and relamping.

### JOINING DIAGRAM

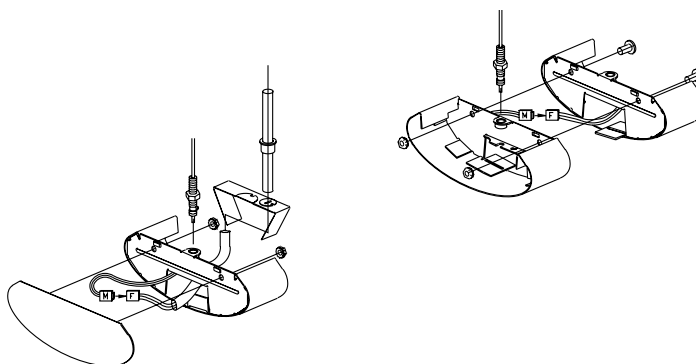

### WEIGHTS AND SUPPORT SPACING

Suspension spacing equals section length.

STANDARD SECTIONS	
15 LBS	
30 LBS	
45 LBS	

**Notes:**

- 4' emergency module always at end of section and requires separate power feed.
- Emergency battery pack (1 lamp only) rated at 825 lumens.

**Key:**

- Support or feed location