

# General Installation Instructions

**READ AND FOLLOW ALL SAFETY INSTRUCTIONS!**  
**SAVE THESE INSTRUCTIONS AND DELIVER TO OWNER AFTER INSTALLATION**

## **⚠ WARNING**

To reduce the risk of death, injury or property damage from fire, electric shock, cuts, abrasions, falling parts, and other hazards:

- Service of the equipment must be performed by qualified service personnel.
- Installation and maintenance must be performed by a person familiar with the construction and operation of this product and any hazards involved. All applicable codes and ordinances must be followed.
- Read this document before installing, servicing, or maintaining this equipment or installing a lamp. These instructions do not cover all installation, service, and maintenance situations. If your situation is not covered, or if you do not understand these instructions or additional information is required, contact Peerless Lighting or your local Peerless Lighting Distributor.
- Read and follow all warnings and instructions provided by the lamp manufacturer.

## **⚠ WARNING**

Before installing, servicing, or maintaining this equipment, follow these general precautions. To reduce the risk of electrocution:

- Make sure the equipment is properly grounded.
- Always de-energize the circuit and/or equipment before connecting to, disconnecting from, or servicing the equipment.

To prevent fixture row from over-current:

- By adding the input current of each fixture section marked on the fixture, the total current per power feed must not exceed the maximum line wire amperage marked on the fixture and the power feed cord/wire amperage rating whichever the least.

To reduce the risk of fire:

- Keep material away that can burn from hot lamp.
- Make sure lamps are correctly installed.
- Use supply conductors with a minimum installation temperature rating as specified on equipment.

To reduce the risk of personal injury from cuts, abrasions, or falling parts:

- Wear gloves to prevent cuts or abrasions from sharp edges when removing from carton, handling and maintaining this equipment.
- Do not use abrasive materials, glass cleaners or other solvents on reflector or lens. These substances may damage equipment and cause parts to eventually break and fall.
- Do not install a damaged fixture.

## **⚠ CAUTION**

Observe lamp manufacturer's recommendations and restrictions on lamp operation, including but not limited to ballast type, burning position, replacement and cycling. Use only lamps that comply with applicable ANSI standards.

**NOTICE:** If lamp is marked (Hg) it contains mercury. Follow disposal laws. See [www.lamprecycle.org](http://www.lamprecycle.org)

Peerless Lighting, a division of Acuity Brands Lighting, Inc., assumes no responsibility for claims arising out of improper or careless installation or handling of this product.

**SAVE THESE INSTALLATION INSTRUCTIONS**

**Part Number: PIN004100 Revision: C Effective Date: 12/20/2010 ECO3618**

# CERRA™ 10 FIXTURE

## INSTALLATION INSTRUCTIONS

Rev. B 04/05 ECO3351



These installation instructions are used for installing the following fixtures and kits:

Fixture			Endcap Kit	Corner Kit	Tenon Kit
10CRM1	10CRM2	10CRM4	10CRM3EP	10CRM3CNR	10CRM3TNN
10CRM6	10CRM7	10CRM3	10CRM3EP	10CRM3CNR	10CRM3TNN

**WARNING:** Risk of fire and electrical shock. This product must be installed in accordance with the applicable installation code by a person familiar with the construction and operation of the production and the hazards involved

- A) Fixture Run Installation----- page 1-2  
 B) Mounting Kit Accessory----- page 2  
 C) Fixture with Corner Installation----- page 2-3  
 D) Fixture with Tenon Installation ----- page 4

### A) Fixture Run Installation

#### A.1 Hanging First Fixture

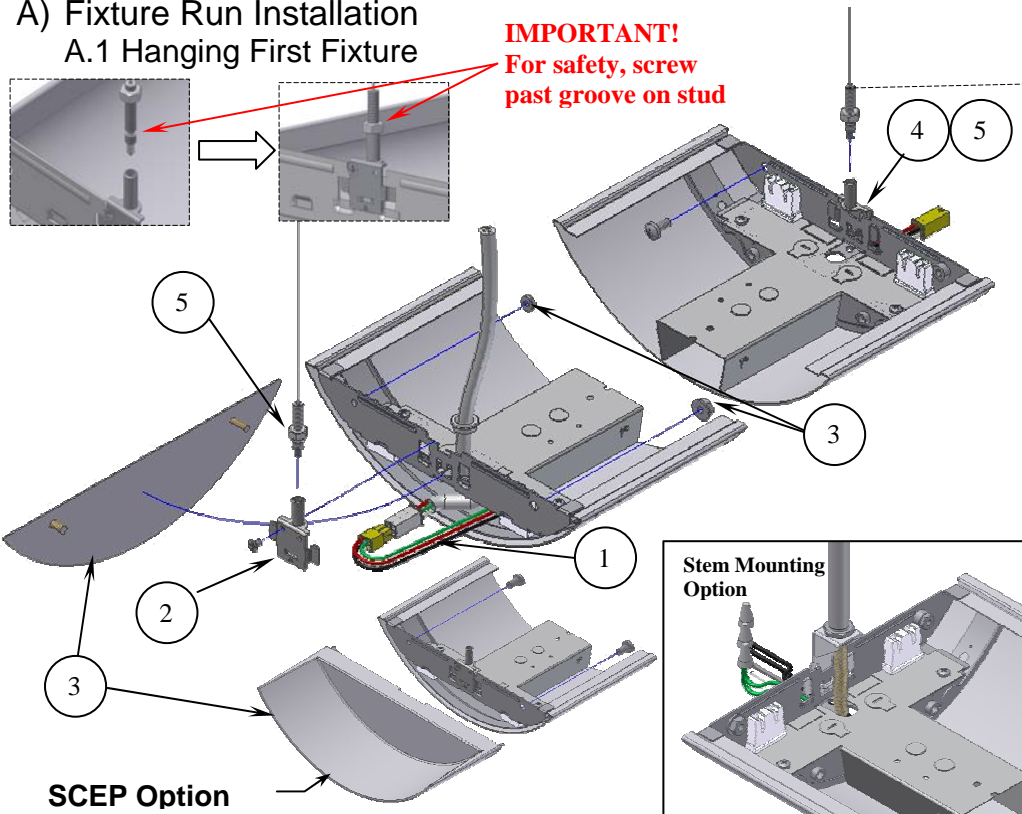

### Adjustable Cable Option

1. Attach adjustable cable gripper (ACG) to fixture and tighten securely.

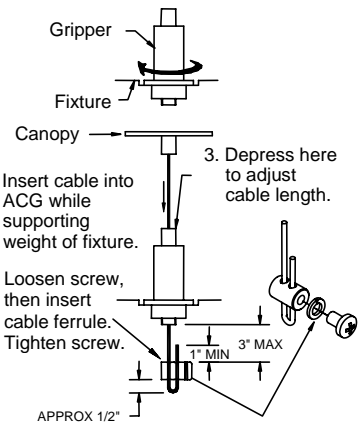

### IMPORTANT

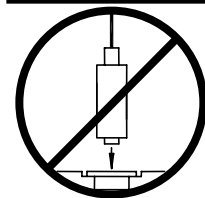

Do NOT insert cable into ACG prior to ACG being attached to fixture. Twisting the cable could cause gripper to become loose.

- 1) Insert power feed cord through fixture center feed hole at the male quick connector end. Connect male and female wire quick connectors.
- 2) Attach hanger to the end of the fixture and secure with screw.
- 3) Attach endcap to the fixture feed end or sculptured end cap and secure with nuts or screw.
- 4) Attach the hanger to the other end of the fixture. Raise fixture into position.
- 5) Screw cable stud into hanger on each end of first fixture. Level the fixture by adjusting the cable stud.

### For Stem Mounting Option:

Attach stem-mounting hanger onto joiner. Secure stem with two nuts on both side of the hole of the hanger. Be sure to use the stem with internal wires and sleeve where power feed is. Cut off the male wire connector from the fixture. Connect wires with wire nuts then insert back into fixture. Continue as step 3 (above).

**CERRA™ 10 FIXTURE**

## INSTALLATION INSTRUCTIONS

Rev. B 04/05 ECO3351

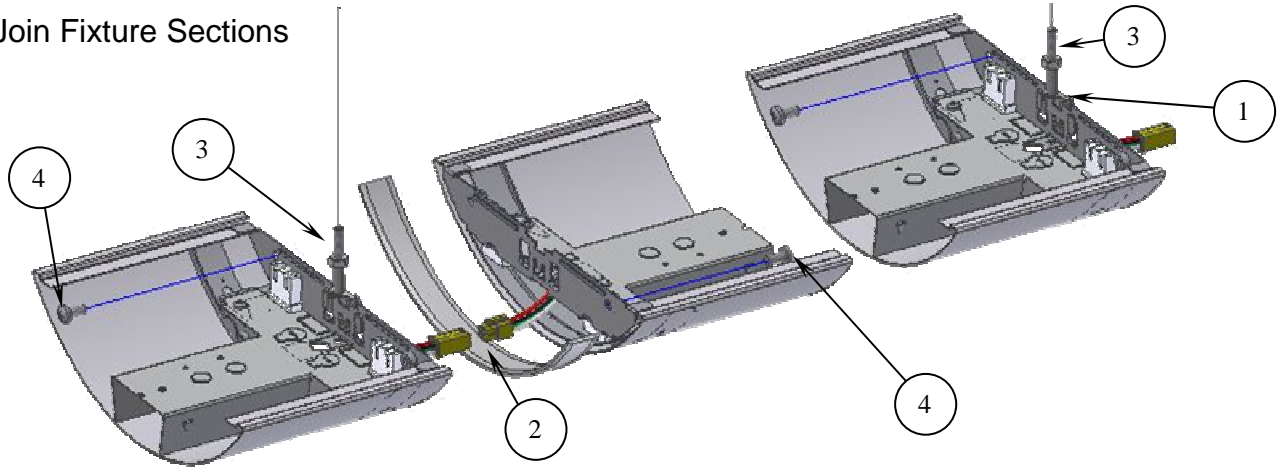
**A.2 Join Fixture Sections**

- 1) Attach hanger to the next fixture at the end with female quick wire connector.
- 2) Raise the fixture into position and connect quick wire connectors. Insert aligner strip between sections.
- 3) Screw cable stud into the hanger of the fixture.
- 4) Bolt fixtures together. Be sure to align and level the fixtures for a smooth, straight row.
- 5) Repeat step 1 to 4 until last fixture in row is hung. Attach endcap to the last fixture.

For Stem Mounting Option, Please see page 1

**B) Mounting Kit Accessories**

Used On	Kit Name (Accessories)	
	Fixed Cable	Adjustable cable
Support location at normal power feed	10CRMFK/10CRM3FK	ACGFK/ACG1FKMTY
Support location at emergency power feed	10CRMEK/10CRM3EK	ACGEK/ACG1EKMTY
Support location without power feed	10CRMSK/10CRM3SK	ACGSK/ACG1SKMTY

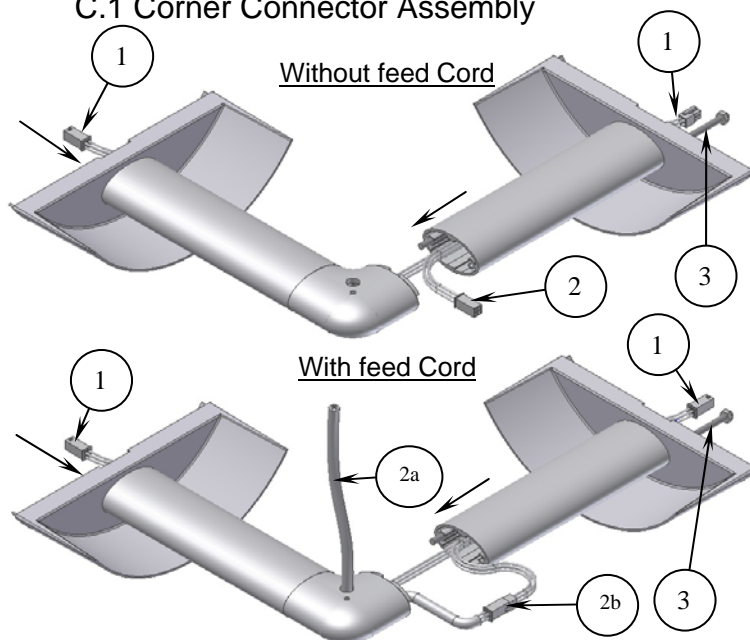
**C) Fixture with Corner Installation****C.1 Corner Connector Assembly**

- 1) Insert wire harness through the tenon tubing.  
\*Identify Male/female orientation connector orientation upon fixture configuration.
- For corner connector without feed cord:**
- 2) Hide one unused quick connector into the tenon tubing.
- For corner connector with the feed cord:**
- 2a) Insert feed cord through the 1/2" hole on the corner.
- 2b) Connect the male and female quick wire connectors, then fit the connectors into the tenon tubing.
- 3) Screw in the 1/4-20" cap nut and threaded rod to join the two pre-assembled corner parts. Tighten it to finish the assembly.

# CERRA™ 10 FIXTURE

## INSTALLATION INSTRUCTIONS

Rev. B 04/05 ECO3351

### C.2 Mounting On Fixture

Fig. C-1 Without feed cord on the fixture

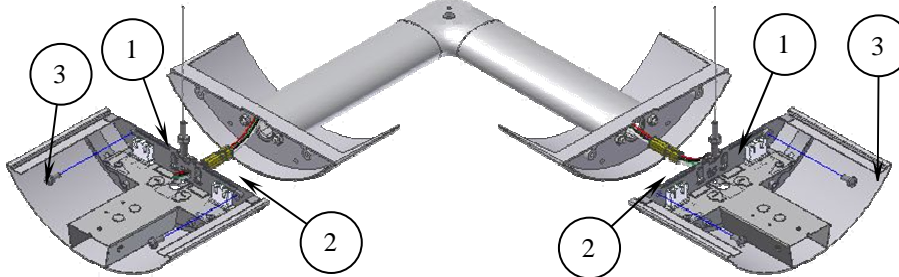

- 1) With the fixture hanging in position, attach hanger with #8 flat head screw at the fixture ends.
- 2) Connect quick wire connectors to the fixture wire harness. If there is no need for the wire harness to run through the corner connector, follow the fixture installation guide to install the power feed on the fixture or leave the fixture wire connector as the line-wire-end.

Fig. C-2 With feed cord on the fixture

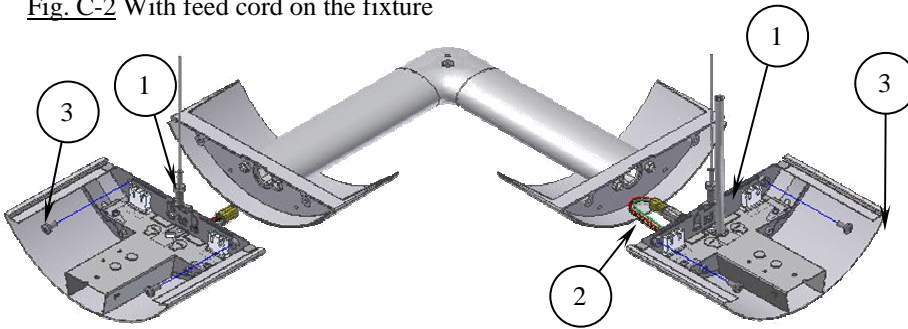

- 3) Bolt the fixture together with the corner connector.
- 4) Level the fixture and corner connector by adjusting the cable stud.

For Stem Mounting Option, Please see page 1

### C.3 Mounting On Corner

Fig. C-3 Without feed cord on the Corner

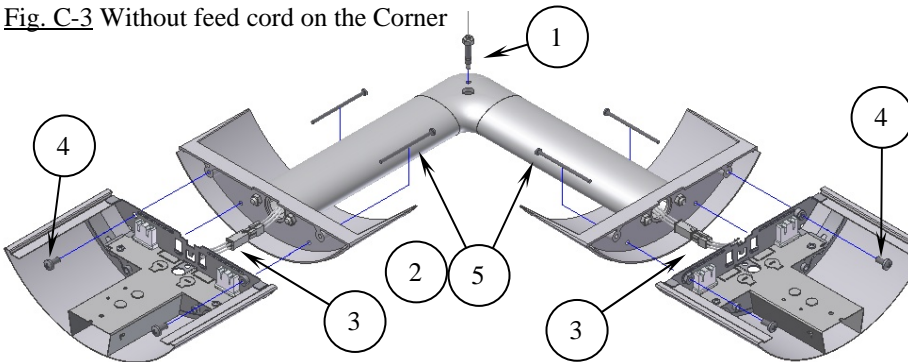

- 1) With the fixture hanging in position, attach cable stud onto the corner.
- 2) Remove long bolts from fixture ends.
- 3) Connect quick wire connectors to the fixture wire harness. If there is no need for the wire harness to run through the corner connector, follow the fixture installation guide to install the power feed on the fixture or leave the fixture wire connector as the line-wire-end.

Fig. C-4 With feed cord on the Corner

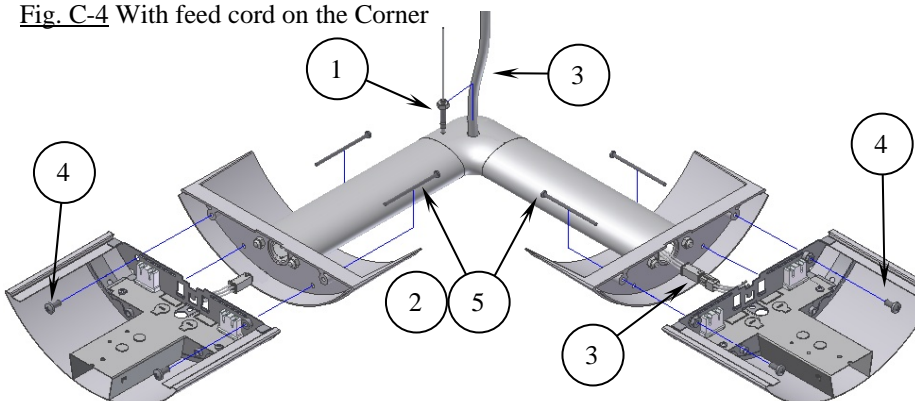

- 4) Bolt the fixture together with the corner connector.
- 5) Insert long bolts through the die-cast ends, then screw into the end bracket of the fixture.
- 6) Level the fixture and corner connector by adjusting the cable stud.



# CERRA™ 10 FIXTURE

## INSTALLATION INSTRUCTIONS

Rev. B 04/05 ECO3351

### D) Fixture with Tenon Installation

#### D.1 Mounting On Fixture

Fig. D-1 Without feed cord on the fixture

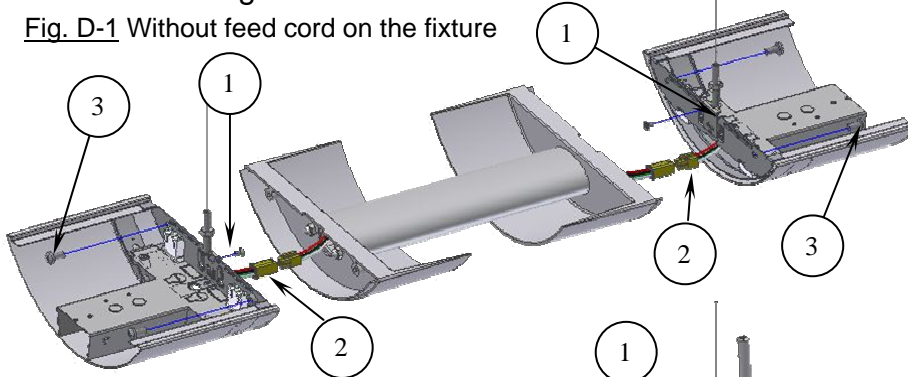
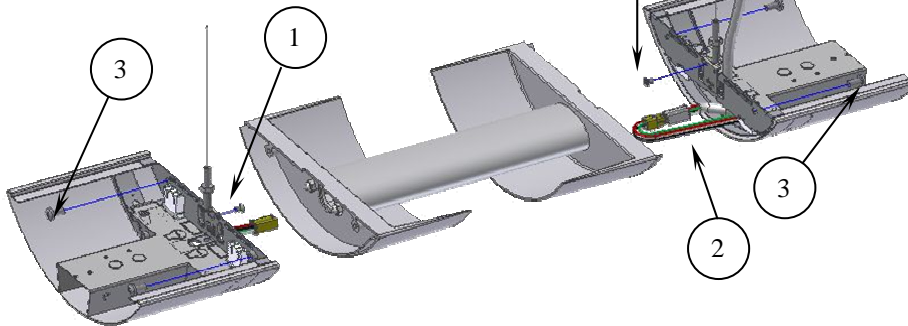

Fig. D-2 With feed cord on the fixture



- 1) With the fixtures hanging in position, attach hanger with #8 flat head screw at the fixture ends.
- 2) Insert tenon wire harness through the tenon tubing where necessary. (see Fig. D-1). Connect quick wire connectors to the fixture wire harness. If there is a feed at tenon joint, omit relative tenon wire harness. Insert power cord through fixture feed hole then connect the fixture wire harness (see Fig. D-2).
- 3) Bolt the fixtures together with tenon. Level the fixture and tenon by adjusting the cable stud.

For Stem Mounting Option, Please see page 1

#### D.2 Mounting On Tenon

Fig. D-3 Without feed cord on the Tenon

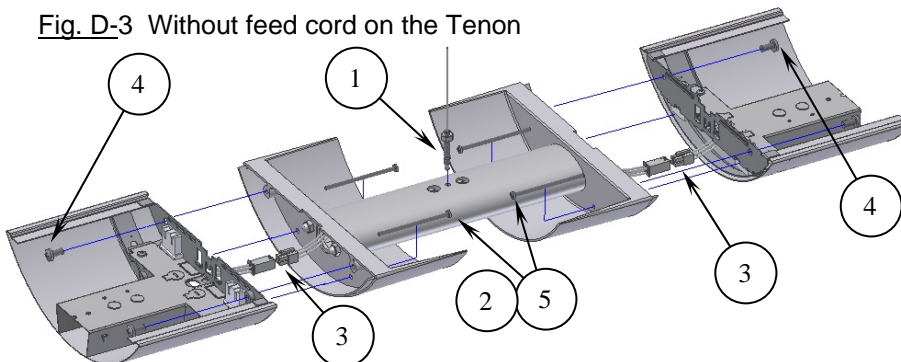
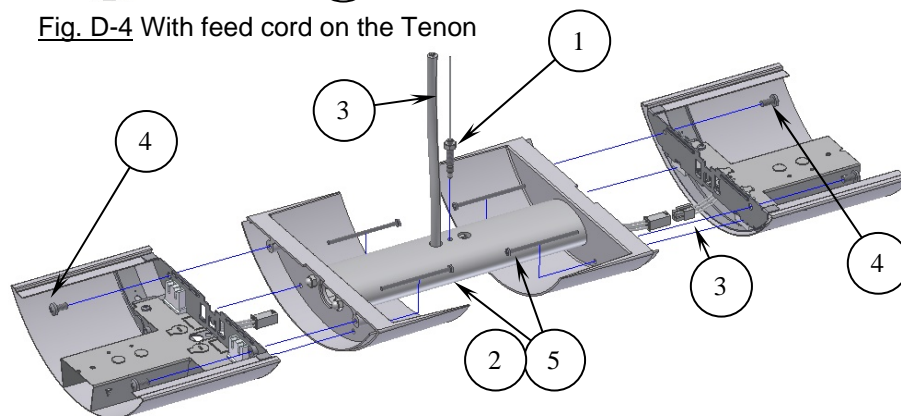

Fig. D-4 With feed cord on the Tenon



- 1) Raise the fixture Into position, insert cable stud onto the tenon.
- 2) Remove long bolts from fixture ends.
- 3) Insert tenon wire harness through the tenon tubing where necessary (see Fig. D-3). Connect quick wire connectors to the fixture wire harness. If there is a feed at tenon joint, omit relative tenon wire harness. Insert power cord through fixture feed hole then connect the fixture wire harness (see Fig. D-4).
- 4) Bolt the fixtures together with tenon.
- 5) Insert long bolts through the die-cast ends, then screw into the end bracket of the fixture.
- 6) Level the fixture and corner connector by adjusting the cable stud.