

INSTALLATION SHEET

Safety, Warnings and Suggestions

- ¹ **Care** should be taken not to position fixtures in locations where bare skin can come into contact with the potentially high temperatures on the lens.
- ² **Avoid** installing fixtures in locations where water collects and stands for prolonged periods.
- ³ **Make** sure that electrical power is disconnected before any work is performed.
- ⁴ **All** gaskets and sealing surfaces must be kept clean during installation.
- ⁵ **All** wiring and installation should meet local, state and national electrical codes.
- ⁶ **Install** correct lamp type and wattage.

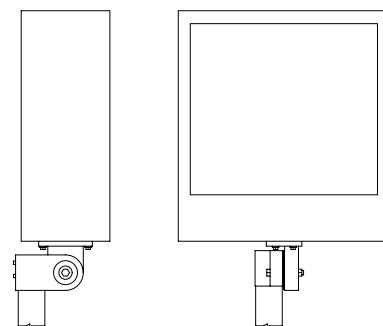

TYPICAL VIEWS

TYPICAL ARM INSTALLATIONS

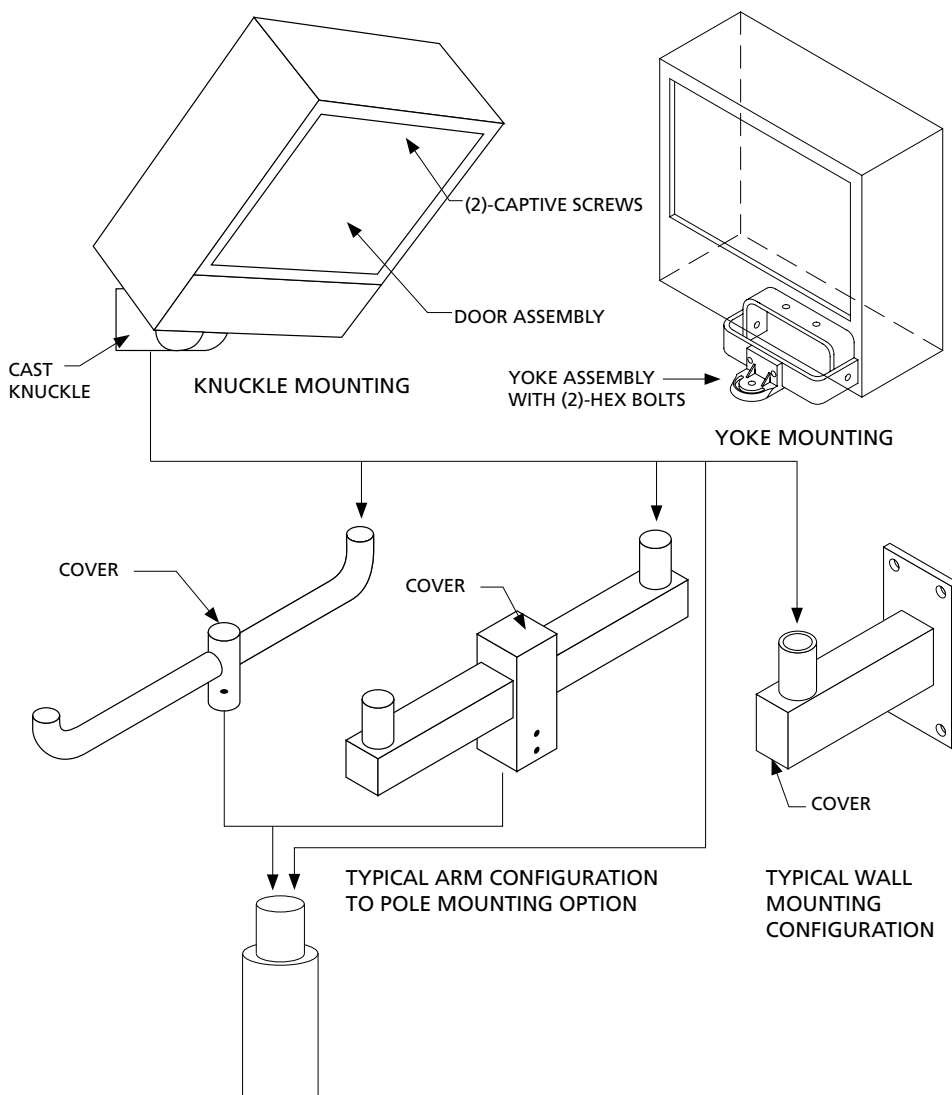

1. Secure the arm assembly or wall bracket as required if they are not already installed.

2. (KNUCKLE INSTALLATION)
Remove the fixture from the box and install to the 2 3/8 O.D. tenon on the pole, on the arm assembly or on the wall bracket.

2-A. (YOKE INSTALLATION)
Remove the fixture from the box and remove (2)-hex bolts from the cross arm or wall bracket. mount the fixture by using the 2-hex bolts.

3. Make power and ground connection using UL approved connectors at the knuckle splice compartment. (Note yoke power connection, SO-cord is provided. Splice connection at J-box (J-box by others)).

4. Aiming Horizontally- Aim the fixture to the desired orientation. Secure the unit with the 3/8" set screws provided with the knuckle. (Yoke aiming loosen the Hex bolt, aim and retighten.)

5. Aiming Vertically- loosen the hex bolt and aim the fixture to the desired position. Retighten the hex bolt. (Yoke aiming loosen the 2-hex bolts, aim and retighten.)

6. Open the door by loosening 2-captive screws at the door. Swing the door down. Install the proper lamp then close the door, and retighten the captive screws.