

**Landscape Areas**  
**Sign Lighting**  
**Tree Lighting**  
**Building Accent Lighting**



**BABY BELERO**

SL

## Specifications



**Certifications** ETL and CETL listed for wet location, direct burial, and concrete pour. Also meets IP65 standard.

**Fixture Housing** Injection molded Ryton™ composite material, structurally reinforced with glass fibers. Superior resistance to ultra violet degradation and corrosion resistant in harsh environments. 1/2" NPT adjustable nylon knuckle with strength support against vertical displacement. The knuckle provides 135° vertical and 360° horizontal adjustability. Stainless steel screws are used as standard.

**Lens** Clear flat tempered glass.

**Lampholder** Porcelain 4KV pulse rated medium base, for HID and Incandescent lamp source.

**Options** Cast aluminum junction box with 1/2" NPT opening at top and two 3/4" NPT conduit entrances on bottom. Other options available. See product order guide.

**Composite Ballast Housing** Compression molded Rhinolite™ composite material, structurally reinforced with glass fibers. Superior resistance to ultra violet degradation and corrosion resistant in harsh environments. 10-24 stainless steel cap screws and sealed with high temperature silicone gasket. Supplied with two 3/4" NPT conduit entrances and separated from the ballast compartment by the anti-wicking chamber hermetically sealed with high temperature sealing compound. (Supplied with HID fixtures).

**Finish** Black or Bronze standard.

**Safety** Caution: Care should be taken when specifying fixtures for use in pedestrian areas to avoid problems that may be caused by high lens temperatures. Consult factory for more information.

**Warning** Caution: Care should be taken not to install in-ground ballast housings in areas where water can stand for prolonged periods of time. Sufficient drainage must be provided to avoid problems. Consult factory for more information.

PROJECT
FIXTURE TYPE
CATALOG#

**Consult Belero Application Brochure For More Options**

**Product Order Guide**

Series	Max Watts	Lamp Type	Voltage <sup>1</sup>	Finish <sup>1</sup>	Options
SL-36	50INC	PAR 20	120	BK Black	RCBH Remote Composite Ballast Housing
	35MH	PAR 20	208	BZ Bronze	CBH Composite Ballast Housing
	75LV	MR16	240		RWMS <sup>2</sup> Remote Wall Mount Surface
			277		WMR Wall Mount Recessed
					WMS <sup>2</sup> Wall Mount Surface
					HL Internal Hexcel Louver
					GF Glass Color Filter- (Specify Color)
					UD <sup>2</sup> Up/Down Mount
					SP Straight Post
					STNM Stanchion Mount
					JBR <sup>2</sup> Junction Box Round
					JBS Junction Box Square
					JBRTM Tree Mount Junction Box
					LP Low Post (Plastic)
					PL 90° Post
					DPL 90° Double Post
					CP Curve Post
					SA Straight Arm
					CA Curve Arm
					LV Low Voltage

1 Consult factory for other colors and voltages  
2 Specify Junction Box Mounting or Surface Conduit Connection

**Example: SL-36-35MH-120-PAR20-BK-CBH**

**Luminaire Dimensions**

Luminaire	A	B	C	D	E
SL-36	7-1/2"	4-1/4"	6"	n/a	n/a
SL-36-WMR	n/a	3-1/2"	6-3/8"	6"	n/a
SL-36-WMS	9-1/2"	3-1/2"	6-3/8"	6"	n/a
SL-36-UD	6"	3-1/2"	10-3/8"	6"	16"

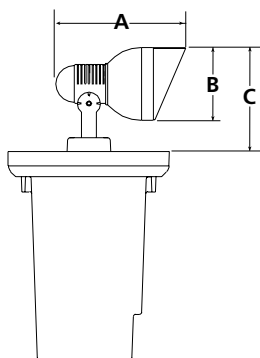

CBH

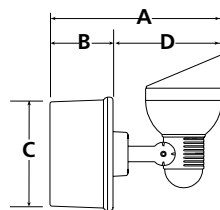

WMS/WMR

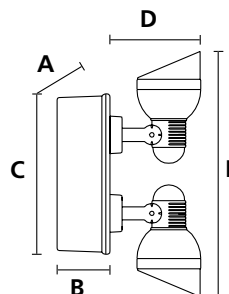

UD