

Triton Grab Bars

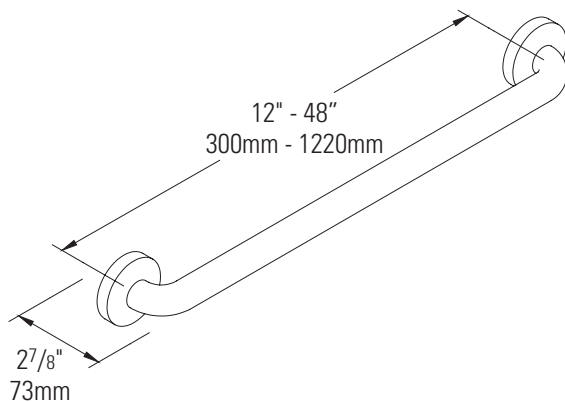

- ▶ Choose from a variety of grab bar styles including straight, angled, corner, l-shaped and curved
- ▶ Superior non-slip surface helps obtain a firmer grip
- ▶ Offers a secure and safe installation by giving the installer the flexibility to choose from 11 mounting holes on the mounting flange
- ▶ Most grab bars are ADA Compliant
- ▶ Available in white or ivory; other colors and grab bar styles available upon request

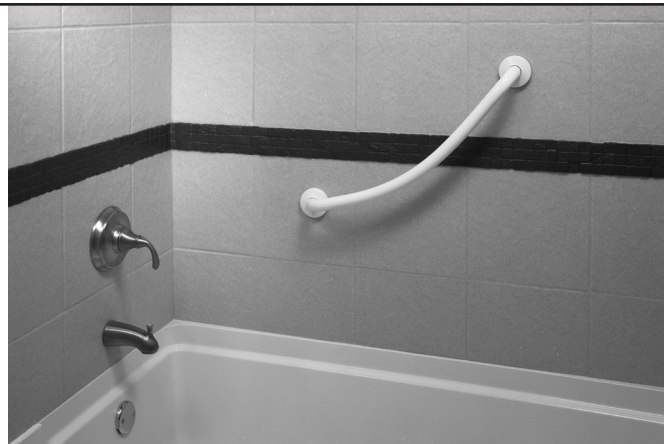
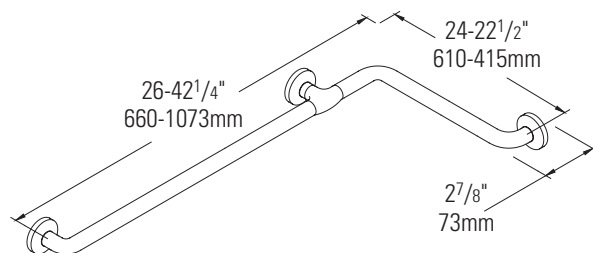
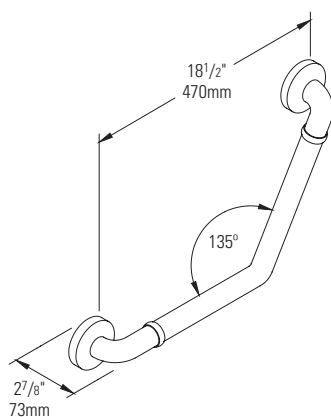

IPC.572/Rev.1



P.O. Box 406 · Muskego, Wisconsin 53150 USA
inprocorp.com
Nationwide 800.222.5556/Fax 888.715.8407
International Sales 262.679.5521/Fax 262.679.5524

INPRO
IPC Interior Protection Products
and Decorative Surfaces

Triton Grab Bars

Suggested Specifications

PART 1 GENERAL

1.1 SUMMARY

A. Grab bars safety and decoration.

1.2 SECTION INCLUDES

A. Section 10800 – Color grab bars

1.3 REFERENCES

A. American with Disabilities Act Accessibility Guidelines (ADAAG)

B. American National Standards Institute (ANSI)

C. American Society for Testing and Materials (ASTM)

1.4 SUBMITTALS

A. Product Data: Manufacturer's standard product data for each product specified, including detail dimensions, function, and finish.

B. Samples: Manufacturer's color selection and verification samples – full size or 12" in length.

C. Manufacturer's printed installation instruction: Include anchoring and fastening details.

1.06 DELIVERY, STORAGE AND HANDLING

A. Deliver materials in unopened factory packaging to the jobsite

B. Inspect materials at delivery to assure that specified products have been received.

C. Store in original packaging in a climate controlled location away from direct sunlight.

1.07 PROJECT CONDITIONS

A. Environmental Requirements: Products must be installed in an interior climate controlled environment.

1.08 WARRANTY

A. Standard IPC Limited Lifetime Warranty against material and manufacturing defects.

PART 2 PRODUCTS

2.1 MANUFACTURER

A. Acceptable Distributor/Manufacturer: IPC Interior Protection Products, InPro Corporation, PO Box 406, Muskego, WI 53150, USA; Telephone: 800-222-5556, Fax: 888-715-8407, www.inprocorp.com

B. Substitutions: Not permitted.

C. Provide all grab bars and bathroom accessories from a single manufacturer.

2.2 MANUFACTURED UNITS

A. Color grab bars.

1. Comply with ADA guidelines to withstand 300lbs of loading.

2. Corrosion resistant steel core with PVC finish coating, round 1¹/₄" (32mm) diameter with 1¹/₂" clear space to wall. Stainless steel flange.

3. Flange cover shall be snap-on design polyamide with no set screw. Flange cover to be 3¹/₄" in diameter 1¹/₈" thick.

4. Colors as selected from manufacturers standard range.

5. Straight bars length.

a. Size 12" long.

b. Size 16" long.

c. Size 18" long.

d. Size 24" long.

e. Size 30" long.

f. Size 32" long.

g. Size 36" long.

h. Size 42" long.

i. Size 48" long.

6. Corner safety support (reversible, horizontal)

a. Size 25.5" by 27.5"

b. Size 20" by 40".

7. Vertical and horizontal safety support (reversible)

a. Size 32" vertical extension by 30" by 35" horizontal corner rail.

8. "L" Shaped support (left and right options)

a. Size 24" vertical extension by 12" horizontal.

b. Size 36" vertical extension by 18" horizontal.

9. Side support rails (options)

a. Fold-up safety support, rotating for space savings with reinforced joint.

b. Fixed safety support with toilet roll holder.

c. Fixed safety support.

PART 3 EXECUTION

3.1 EXAMINATION

A. Do not begin installation until substrates finishing operations are completed, including painting.

B. Verify that prepared openings are sized and located in accordance with architects recommendations. Verify that blocking, reinforcement and anchoring devices are the correct type.



P.O. Box 406 • Muskego, Wisconsin 53150 USA
inprocorp.com
Nationwide 800.222.5556/Fax 888.715.8407
International Sales 262.679.5521/Fax 262.679.5524

INPRO CORPORATION
Interior and Exterior Architectural Products