

# Installation Instructions

## Grab Bars

FIG. 1

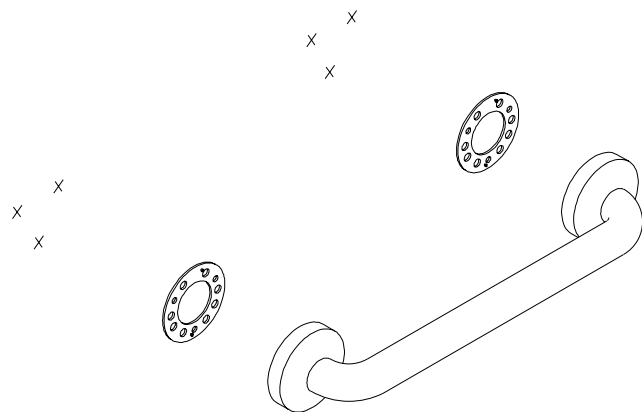

FIG. 2

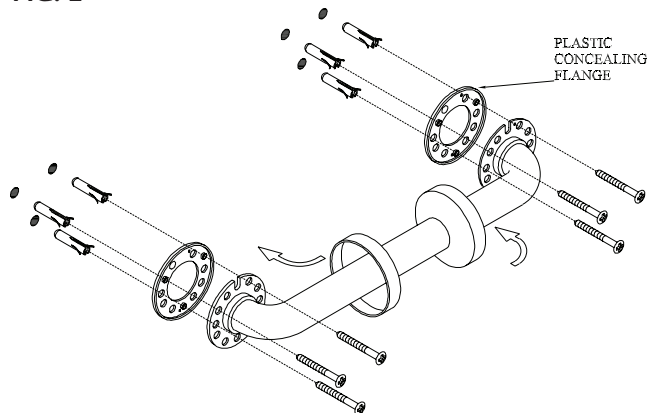
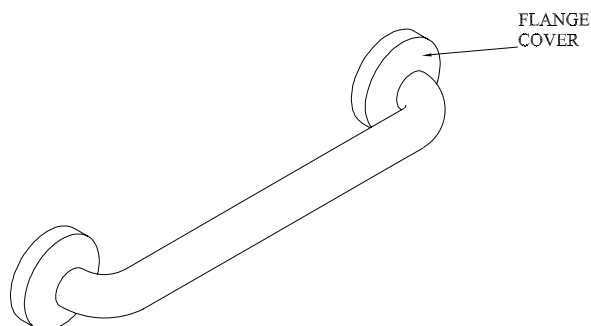

FIG.3



**Please read all instructions before installing grab bars**  
**Material must be stored, installed and used in environmentally controlled conditions.**

Note: Install grab bars into the wall structure or backing plates. If this is not possible, the Wing-It fastener is an alternate installation method.

### Standard Installation

1. Determine the location of the grab bar. Using the flange as a template, hold the grab bar in position against the wall and transfer the hole locations to the wall. See Figure 1.
2. Drill  $\frac{5}{16}$  " (8mm) holes at each fastener location.
3. Insert the plastic anchor into each hole lightly hammering if needed.
4. Snap the plastic concealing seal onto the flanges.
5. Hold the grab bar on the wall and attach it to the wall by tightening the provided fastener into the plastic anchors. See Figure 2.
6. After securely tightening the grab bar to the wall, snap the plastic flange cover over the flange. See Figure 3.

IPC.S71/Rev.1

### Installation Questions?

Contact our Installation Hotline 866.EZINPRO  
For Sales & Customer Service call 800.222.5556

**INPRO**  
**IPC** Interior Protection Products  
and Decorative Surfaces

# Installation Instructions

## Grab Bars

FIG. 1

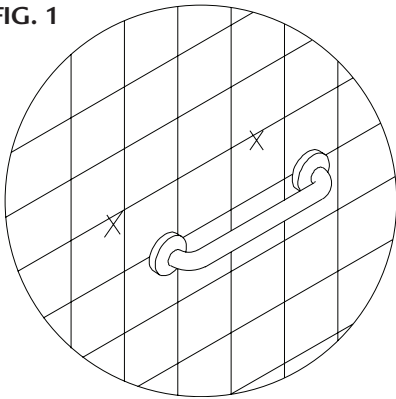

FIG. 2

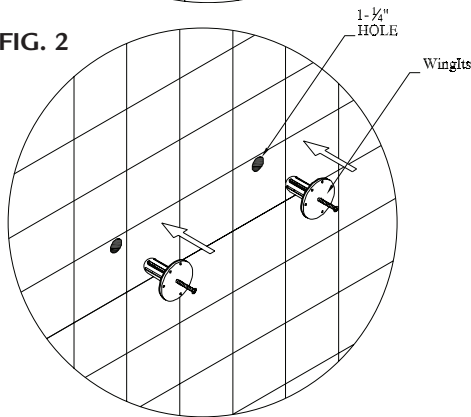

FIG. 3

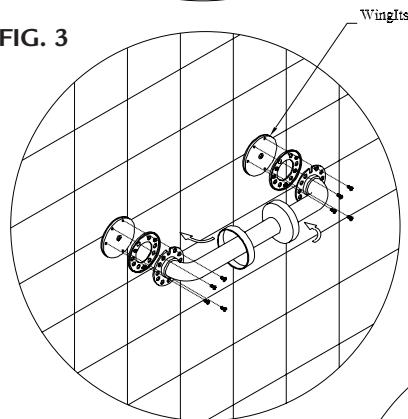
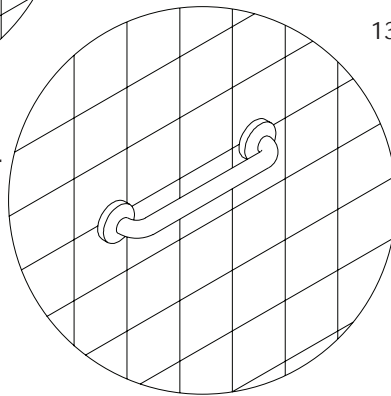

FIG. 4



### Grab Bars with WingIts Installation

1. Verify the grab bar length by measuring from the outside edge of one flange to the inside edge of the next flange. This is the distance needed between starter holes. See Figure 1.
2. Drill starter holes using a 1/4" drill bit. To verify stud will not interfere, make an L-shaped piece of wire with a 1 1/4" bend and insert it into the starter hole. If a stud is found, move over an appropriate distance and drill a new starter hole.
3. With a 1 1/4" hole saw, drill a 1 1/4" hole at each starter hole. When drilling on ceramic tile, tape the surface and use a carbide tipped hole saw. After cutting through the tile, stop and remove the tile pieces from the saw.
4. Continue drilling through the drywall by letting the hole saw cut the drywall (do not push). Remove any debris that may interfere with the WingIt. See Figure 2.
5. Make sure the flat head screw in the WingIt is flush with the faceplate.
6. Attach the WingIts to the grab bar flanges.
7. Clean the tile surface with rubbing alcohol and let it dry. Remove the waterproof tape release liner from the back of the WingIt.
8. Insert the WingIts which are attached to the grab bar into the 1 1/4" holes. Push them firmly to the wall allowing the waterproof tape to adhere to the wall.
9. Remove the grab bar from the WingIt flanges. Back out the flat head screw 1 1/4" from the WingIt flange.
10. Hit the head of the screw with a rubber hammer to open the wing behind the drywall.
11. Hand tighten the screw securing the WingIt to the wall.
12. Attach the grab bar to the WingIt flange with two screws per flange. See Figures 3 and 4.
13. After securely tightening the grab bar, snap the plastic flange cover over the flange.

### Installation Questions?

Contact our Installation Hotline 866.EZINPRO  
For Sales & Customer Service call 800.222.5556