

100 Series

Elastomeric Seal Systems for Floors, Walls and Ceilings

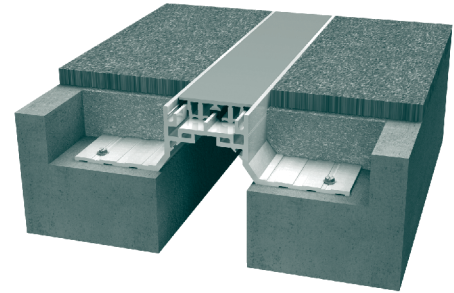

Movement Rating $\pm 25\%$

Product Guide

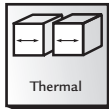

Taking Care of Building Movement

Because of how the world works, buildings move. Temperatures change causing buildings to expand and contract. Earthquake activity shifts buildings horizontally, vertically and diagonally. And winds force structures to sway.

To accommodate this movement, buildings must be designed with openings or expansion joints, to absorb the movement. That's where architectural joint systems can help. Architectural joint systems are transitions across these building openings, allowing people and traffic to safely move through the building. These systems are also engineered to move with the building.

The 100 Series architectural joint systems are designed with dual durometer elastomeric seals providing a secure fit and optimal flexibility for movement.

There are numerous types of systems for various applications. To select the system that meets your needs, visit Engineered Metal Products tab at inprocorp.com and click on the Engineered Metal Products SpecWizard.



IPC.800/REV.4



P.O. Box 406 · Muskego, Wisconsin 53150 USA
inprocorp.com
Nationwide 800.222.5556/Fax 888.715.8407
International Sales 262.679.5521/Fax 262.679.5524

INPRO CORPORATION
Interior and Exterior Architectural Products

100 Series

Suggested Specifications

PART 1 – GENERAL

1.01 SUMMARY

- A. Furnish Expansion Joint Systems in accordance with the drawings and general provisions of the Contract.

1.02 WORK INCLUDED

- A. Furnish complete JointMaster/InPro Corporation Expansion Joint Systems.

1. Interior floor expansion joint systems.
2. Interior wall expansion joint systems.
3. Interior ceiling expansion joint systems.
4. Roof expansion joint systems.
5. Exterior wall expansion joint systems.
6. Exterior floor expansion joint systems.
7. Parking deck expansion joint systems.
8. Fire Rated Assemblies.

1.03 RELATED WORK

- A. Related work which is specified elsewhere.
1. Cast-In-Place Concrete: Section 03300.
 2. Unit Masonry: Section 04810.
 3. Structural Steel: Section 05120.
 4. Lightgage Metal Framing: Section 05400.
 5. Roof Expansion Assemblies - 07716
 6. Sheet Metal Flashing and Trim: Section 7620.
 7. Cement Plaster: Section 09210.
 8. Gypsum Wallboard: Section 09260.

1.04 REFERENCES

- A. Publications listed herein are part of this specification to the extent referenced. The criteria established in the specifications shall take precedence over the standards referenced herein. (An example of a reference standard is given below.)

1. American Society for Testing and Materials (ASTM):
 - a. ASTM B 221, Standard Specifications for Aluminum and Aluminum-Alloy Extruded Bars, Rods, Wire, Shapes, and Tubes.

1.05 DEFINITIONS

- A. Define industry and product terms as necessary.

1.06 SYSTEM DESCRIPTION

- A. Joint systems shall permit limited movement of joint without disengagement.

1. Specify x-axis joint movement (horizontal).
 2. Specify y-axis joint movement (vertical).
 3. Specify z-axis joint movement (lateral).
- B. Allowable load on floor joint cover plate shall be [50] [100] [200] psf uniform load and [300 pounds concentrated load] [2,000 pounds concentrated load for heavy duty systems] with maximum 12,000 psi stress (6063-T5 aluminum extrusions) or 28,000 psi stress (6061-T6 aluminum plate) or 16,000 psi stress (5052-H32 aluminum sheet) or 36,000 psi stress (stainless steel plate) at full open position.
1. Deflection shall be $[\frac{1}{16}] [\frac{1}{8}]$ inch at neutral position.
 2. In the absence of load selections the minimum load will apply - [50] psf with $[\frac{1}{8}]$ inch deflection.

- C. Fire Rated Assemblies shall have been tested by Underwriters Laboratories, in accordance with [ANSI/U.L. No. 263 and ASTM E 119/E 814] [UL 2079] [including hose stream test at full rated period]. Underwriter's Laboratories shall classify assemblies. Fire rating shall be 2 hours or not less than the fire rating of adjacent construction.

1.07 QUALITY ASSURANCE

- A. Manufacturer: Furnish assemblies from one (1) manufacturer with a minimum of five (5) years of experience in the design, engineering and fabrication of expansion joint systems.
- B. Installer: Firm with not less than three (3) years of successful experience in the installation of systems similar to those required by this project and acceptable to the manufacturer of the system.

1.08 SUBMITTALS

- A. Manufacturer's specifications, technical data, installation instructions, and detail drawings for each

system.

- B. Certificates or other documentation confirming UL approved compliance with fire resistance rating of fire barrier assemblies.

- C. Sample of specified systems where required.

1.09 DELIVERY AND STORAGE

- A. Provide temporary protective covers on [anodized aluminum] [stainless steel] finished surfaces.
- B. Deliver joint systems to jobsite in new, clean, unopened cartons or crates of sufficient size and strength to protect materials during transit.
- C. Store components in original containers in a clean, dry location.

1.10 SEQUENCING

- A. Submittals shall be completed and submitted within a reasonable amount of time after award of subcontract.
- B. Subcontract for the work of this section shall be planned to allow sufficient time for manufacturer's production and delivery scheduling.

1.11 WARRANTY

- A. Standard JointMaster/InPro Corporation limited warranty against material and manufacturing defects for a period of not less than three (3) years when installed in accordance with manufacturer's recommendations.

PART 2 – PRODUCTS

2.01 MANUFACTURER

- A. JointMaster/InPro Corporation
S80 W18766 Apollo Drive
Muskego, WI 53150 USA
Phone: (800) 222-5556
Fax: (888) 715-8407
Email: service@inprocorp.com

- B. Substitutions: Not permitted.

- C. Requests for substitutions will be considered in accordance with provisions of section 01600.

2.02 MATERIALS

- A. Aluminum: ASTM B 221, alloy 6063-T6.
- B. Stainless Steel Caps (optional): SS316.
- C. Brass Caps (optional): CZ108
- D. Elastomeric Seal: Dual durometer Santoprene or equal. Colors to be selected from manufacturer's standard range – Black, Gray, Beige, Off-White and Bright White. Custom colors available.
- E. Vapor Barrier (optional): 40 mils thick PVC or 30 mils thick EPDM.
- F. Fire Barrier (optional): [Reactofire 900 Blanket System to UL2079 with hose stream test to walls] or [Reactofire 920 Mineral Wool and Sealant Fire Barrier System to UL2079] required for indicated fire resistance rating.
- G. Fasteners, accessories and other materials required for complete installation in accordance with the manufacturer's instructions.

2.03 INTERIOR JOINT SYSTEMS FOR FLOORS, WALLS AND CEILINGS

- A. Elastomeric Seal Systems: JointMaster 100 Series – Aluminum frame with continuous Santoprene seal
1. Floor Systems
 - a. Recessed frame, floor/floor – 101-A01
 - Recessed frame, floor/wall – 101-A02
 - b. Surface mount frame, floor/floor – 103-A01 for $\frac{1}{8}$ " VCT, 104-A01 flush, 105-A01 for $\frac{1}{8}$ " sheet vinyl, 106-A01 for $\frac{1}{4}$ " carpet
 - c. Surface mount frame, floor/wall – 103-A02 for $\frac{1}{8}$ " VCT, 104-A02 flush, 105-A02 for $\frac{1}{8}$ " sheet vinyl, 106-A02 for $\frac{1}{4}$ " carpet
 - d. New to existing (one frame recessed and one surface mount) floor/floor – 107-A01 flush, 108-A01 for $\frac{1}{8}$ " sheet vinyl, 109-A01 for $\frac{1}{4}$ " carpet and 110-A01 for $\frac{1}{8}$ " VCT
 - e. Flush frame with reduced sightline for any floor finish, floor/floor – 120-A01, Flush frame with reduced sightline for any floor finish, floor/wall – 120-A02
 - f. Recessed frame with reduced sightline for sheet vinyl, floor/floor – 132-A01, Recessed frame with reduced sightline for sheet vinyl, floor/wall – 132-A02
 - g. Recessed frame with reduced sightline for carpet, floor/floor – 133-A01, Recessed frame with reduced sightline for carpet, floor/wall – 133-A02
 - h. Recessed frame with reduced sightline for carpet or VCT, floor/floor – 141-A01.
 2. Wall/Ceiling Systems
 - a. Recessed frame for $\frac{5}{8}$ " finishes, wall/wall – 101-A07, Recessed frame for $\frac{5}{8}$ " finishes, wall/corner – 101-A09
 - b. Surface mount frame, wall/wall – 104-A07
 - Surface mount frame, wall/corner – 104-A09
 - c. Recessed frame for $\frac{5}{8}$ " drywall, wall/wall – 112-A07, Recessed frame for $\frac{5}{8}$ " drywall, wall/corner – 112-A09
 - d. Surface mount frame for $\frac{5}{8}$ " drywall, wall/wall – 113-A07
 - Surface mount frame for $\frac{5}{8}$ " drywall, wall/corner – 113-A09, Pre-assembled surface mount frame for $\frac{5}{8}$ " drywall, wall/wall – 113A-A07
 - e. Surface mount frame with bellows seal for $\frac{5}{8}$ " drywall, wall/wall – 114-A07, Surface mount frame with bellows seal for $\frac{5}{8}$ " drywall, wall/corner, 114-A09
 - f. Flush frame with reduced sightline for any wall finish, wall/wall – 118-A07, Flush frame with reduced sightline for any wall finish, wall/corner – 118-A09
 3. Ceiling Systems
 - a. Bellows seal system for acoustical ceiling systems, ceiling/ceiling – 115-A24
 - Bellows seal system for acoustical ceiling systems, wall/ceiling – 115-A18

ish, floor/floor – 120-A01, Flush frame with reduced sightline for any floor finish, floor/wall – 120-A02

- f. Recessed frame with reduced sightline for sheet vinyl, floor/floor – 132-A01, Recessed frame with reduced sightline for sheet vinyl, floor/wall – 132-A02
- g. Recessed frame with reduced sightline for carpet, floor/floor – 133-A01, Recessed frame with reduced sightline for carpet, floor/wall – 133-A02
- h. Recessed frame with reduced sightline for carpet or VCT, floor/floor – 141-A01.
2. Wall/Ceiling Systems
- a. Recessed frame for $\frac{5}{8}$ " finishes, wall/wall – 101-A07, Recessed frame for $\frac{5}{8}$ " finishes, wall/corner – 101-A09
 - b. Surface mount frame, wall/wall – 104-A07
 - Surface mount frame, wall/corner – 104-A09
 - c. Recessed frame for $\frac{5}{8}$ " drywall, wall/wall – 112-A07, Recessed frame for $\frac{5}{8}$ " drywall, wall/corner – 112-A09
 - d. Surface mount frame for $\frac{5}{8}$ " drywall, wall/wall – 113-A07
 - Surface mount frame for $\frac{5}{8}$ " drywall, wall/corner – 113-A09, Pre-assembled surface mount frame for $\frac{5}{8}$ " drywall, wall/wall – 113A-A07
 - e. Surface mount frame with bellows seal for $\frac{5}{8}$ " drywall, wall/wall – 114-A07, Surface mount frame with bellows seal for $\frac{5}{8}$ " drywall, wall/corner, 114-A09
 - f. Flush frame with reduced sightline for any wall finish, wall/wall – 118-A07, Flush frame with reduced sightline for any wall finish, wall/corner – 118-A09
3. Ceiling Systems
- a. Bellows seal system for acoustical ceiling systems, ceiling/ceiling – 115-A24
 - Bellows seal system for acoustical ceiling systems, wall/ceiling – 115-A18

2.04 FABRICATION

- A. Field assemble components provided in standard lengths with pre-packaged fasteners and accessories.
- B. Fabricate special transitions and corner fittings as required. Miter and weld elastomeric seal as applicable.

2.05 FINISHES

- A. Aluminum:
1. Floors: Mill finish
 2. Walls and Ceilings: 204-R1 Commercial Clear Anodized [Custom Color Anodized] [Other] [Prime Painted] optional. 104 and 115: Mill Finish Standard
- B. Stainless Steel: 2B

PART 3 – EXECUTION

3.01

- A. Verify that structural gap and blockout dimensions are in conformance with manufacturer's submittal data.

3.02 INSTALLATION

- A. Joint systems: Install in accordance with manufacturer's instructions. Align work plumb, level and flush with adjacent surfaces. Rigidly anchor to substrate. Allowances should be made where actual structural gap at time of installation varies from nominal design gap.
- B. Fire Rated Assemblies: Where required, install to manufacturer's instructions.
- C. Vapor Barrier: Where required, install to manufacturer's instructions. Provide drainage fittings where required.

3.03 PROTECTION AND CLEANING

- A. Protect installation from damage by work of others. At completion of the installation, clean exposed surfaces with non-solvent cleaner.



101 Series Recess Mount

A01 - Floor to Floor

A02 - Floor to Wall

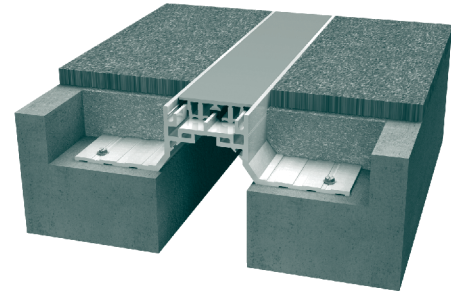

| Movement Rating \pm 25% | |
|--|---|
| Product Guide |  Thermal |
| |  Fire Rated Option |
|  Quick Ship Available | |

- ▶ Dual durometer seal provides secure fit and optimal flexibility
- ▶ Seals absorb limited serviceable seismic movement
- ▶ Recessed modular frames for minimal sight line
- ▶ Adaptable to many finishes, including ceramic tile, marble, stone, vinyl tile and carpet
- ▶ Seamlessly integrates with the following wall and ceiling systems

| Wall | Ceiling |
|-------------|-------------|
| 101-A07/A09 | 101-A07/A09 |
| 112-A07/A09 | 112-A07/A09 |
| 113-A07/A09 | 113-A07/A09 |

- ▶ Easy to clean flush seals. No dirt or water traps
- ▶ Snap-fit design for easy on site assembly
- ▶ Mill finish aluminum
- ▶ Load rated
- ▶ Optional decorative caps in brass or stainless steel
- ▶ Integral vapor barrier option available
- ▶ Standard seal colors: black, beige, gray, off white and bright white. Custom colors available upon request.

SYSTEM DATA

| Application | System | W Joint Width | | H1 Frame Height 1 | | H2 Height 2 | | S Sightline | | B Blockout | | Movement +/- Horizontal Vertical | | | | Load | |
|-------------|-------------|------------------|----|----------------------|----|----------------|----|----------------|----|---------------|----|-------------------------------------|----|------|----|--------|----|
| | | US | mm | US | mm | US | mm | US | mm | US | mm | US | mm | US | mm | US ton | kN |
| Floor/Floor | 101-A01-025 | 1" | 25 | 1 1/2" | 38 | * | * | 1" | 25 | 2 1/2" | 64 | 1/4" | 6 | 1/4" | 6 | 2.8 | 25 |
| | 101-A01-038 | 1 1/2" | 38 | 1 1/2" | 38 | * | * | 1 7/16" | 36 | 2 1/2" | 64 | 3/8" | 10 | 3/8" | 10 | 2.7 | 24 |
| | 101-A01-050 | 2" | 51 | 1 1/2" | 38 | * | * | 1 7/8" | 47 | 2 1/2" | 64 | 1/2" | 13 | 1/2" | 13 | 1.7 | 15 |
| | 101-A01-075 | 3" | 76 | 1 1/2" | 38 | * | * | 2 7/8" | 73 | 2 1/2" | 64 | 3/4" | 19 | 3/4" | 19 | 1.7 | 15 |
| Floor/Wall | 101-A02-025 | 1" | 25 | 1 1/2" | 38 | * | * | 1" | 25 | 2 1/2" | 64 | 1/4" | 6 | 1/4" | 6 | 2.8 | 25 |
| | 101-A02-038 | 1 1/2" | 38 | 1 1/2" | 38 | * | * | 1 7/16" | 36 | 2 1/2" | 64 | 3/8" | 10 | 3/8" | 10 | 2.7 | 24 |
| | 101-A02-050 | 2" | 51 | 1 1/2" | 38 | * | * | 1 7/8" | 47 | 2 1/2" | 64 | 1/2" | 13 | 1/2" | 13 | 1.7 | 15 |
| | 101-A02-075 | 3" | 76 | 1 1/2" | 38 | * | * | 2 7/8" | 73 | 2 1/2" | 64 | 3/4" | 19 | 3/4" | 19 | 1.7 | 15 |

Standard frame height 1 1/2" (38mm)

IPC.802/REV.4

101 Series Recessed Mount Floor Systems

101-A01 Floor/Floor (1" (25mm) system shown)

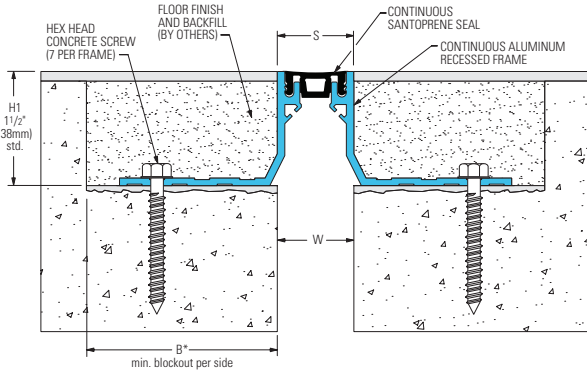

101-A01 Floor/Floor (2" (50mm) system shown)

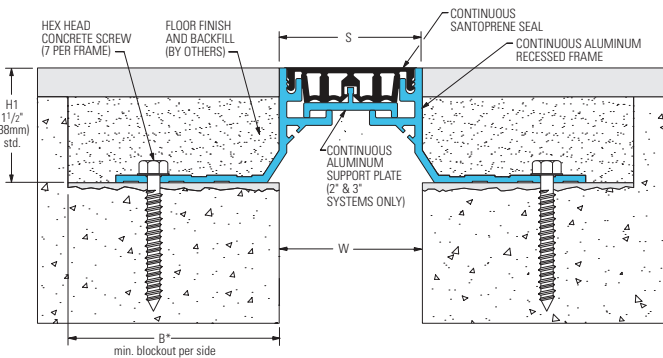

101-A02 Floor/Wall (1" (25mm) system shown)

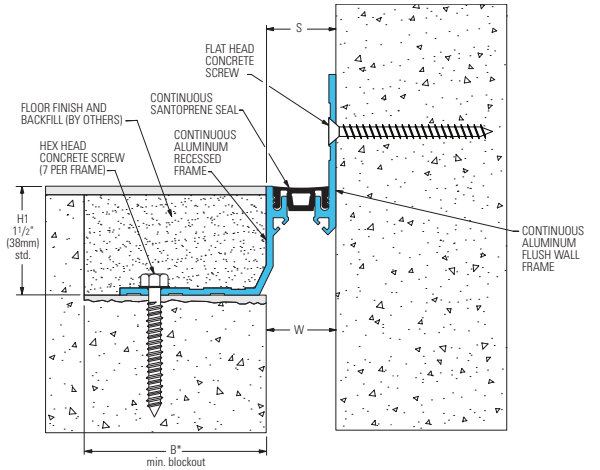

Wall Frame Options

101-A03 (3/8" Finishes)



101-A04 (5/8" Finishes)

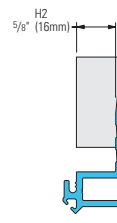

101-A05 (1" Finishes)

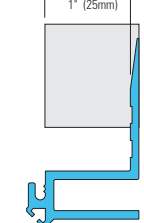

101 Series Options

Reactofire Mineral Wool & Sealant Fire Barrier System (101-A01-025 system shown)

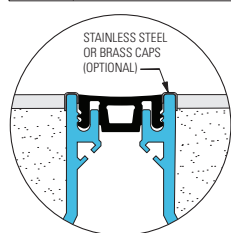
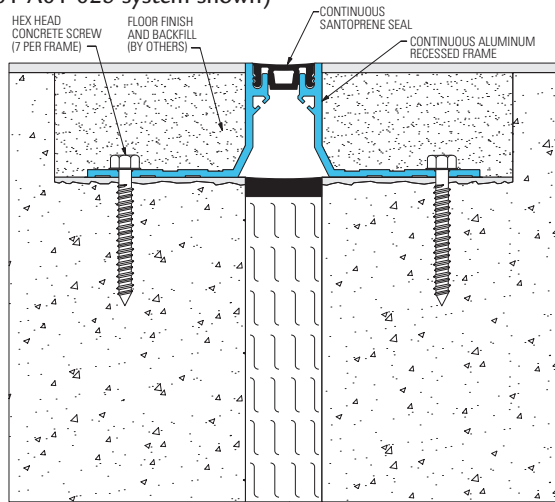

Decorative Caps (101-A01-025 system shown)

Integral Vapor Barrier (101-A01-050 system shown)

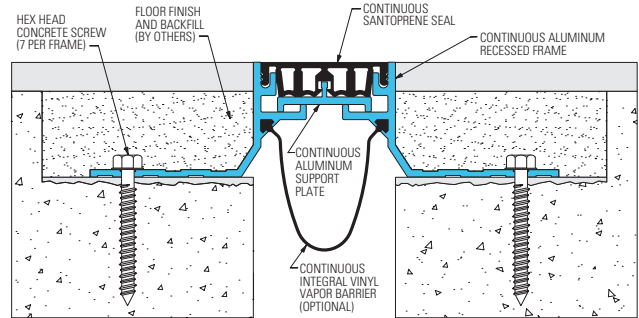

Reactofire Fire Blanket System (101-A01-050 system shown)

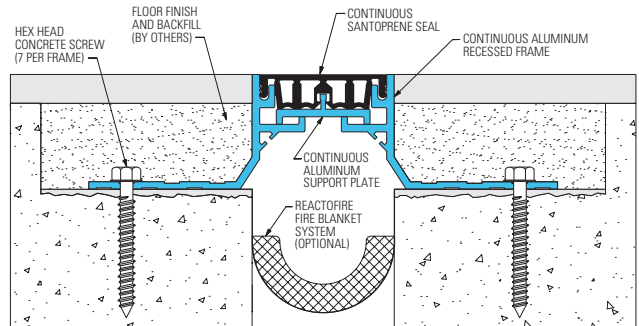

P.O. Box 406 · Muskego, Wisconsin 53150 USA

www.inprocorp.com

Nationwide 800.222.5556/Fax 888.715.8407



International Sales 262.679.5521 / Fax 262.679.5524

103, 104, 105, 106 Series Surface Mount

A01 - Floor to Floor

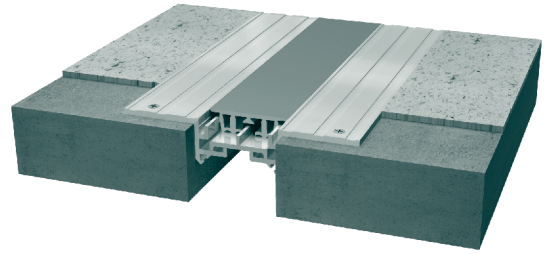
A02 - Floor to Wall

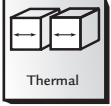

| | | | |
|---------------|---|---|--|
| Product Guide | Movement Rating \pm 25% | | |
| |  Thermal |  Fire Rated Option |  Quick Ship Available |

- ▶ Dual durometer seal provides secure fit and optimal flexibility
- ▶ Seals absorb limited serviceable seismic movement
- ▶ Designed for renovation and surface mount installations
- ▶ Adaptable to concrete, epoxy, vinyl and caret finishes
- ▶ Seamlessly integrates with the following wall and ceiling systems

| Wall | Ceiling |
|-------------|-------------|
| 101-A07/A09 | 101-A07/A09 |
| 104-A07/A09 | 104-A07/A09 |
| 112-A07/A09 | 112-A07/A09 |
| 113-A07/A09 | 113-A07/A09 |

- ▶ Easy to clean flush seals. No dirt or water traps
- ▶ Snap-fit design for easy on site assembly
- ▶ Mill finish aluminum
- ▶ Load rated
- ▶ Optional decorative caps in brass or stainless steel (*106 system only*)
- ▶ Integral vapor barrier option available
- ▶ Standard seal colors: black, beige, gray, off white and bright white. Custom colors available upon request.

SYSTEM DATA

| Application | System | W Joint Width | | H1 Frame Height 1 | | H2 Sub Height 2 | | S Sight Line | | B Blockout | | Movement \pm | | | | Load | |
|----------------|-------------|------------------|----|----------------------|----|--------------------|----|-----------------|-----|---------------|----|----------------|----|----------|----|-----------|----|
| | | | | | | | | | | | | Horizontal | | Vertical | | | |
| | | US | mm | US | mm | US | mm | US | mm | US | mm | US | mm | US | mm | US Ton | kN |
| Floor to Floor | 103-A01-025 | 1" | 25 | 5/8" | 16 | 1/8" | 4 | 4" | 102 | * | * | 1/4" | 6 | 1/4" | 6 | 2.8 | 25 |
| | 103-A01-038 | 1 1/2" | 38 | 5/8" | 16 | 1/8" | 4 | 4 1/2" | 114 | * | * | 3/8" | 10 | 3/8" | 10 | 2.7 | 24 |
| | 103-A01-050 | 2" | 51 | 1" | 25 | 1/8" | 4 | 4 7/8" | 124 | * | * | 1/2" | 13 | 1/2" | 13 | 1.7 | 15 |
| | 103-A01-075 | 3" | 76 | 1 1/8" | 28 | 1/8" | 4 | 6" | 152 | * | * | 3/4" | 19 | 3/4" | 19 | 1.7 | 15 |
| | 104-A01-025 | 1" | 25 | 5/8" | 16 | * | * | 4 3/4" | 121 | * | * | 1/4" | 6 | 1/4" | 6 | 2.8 | 25 |
| | 104-A01-038 | 1 1/2" | 38 | 5/8" | 16 | * | * | 5 1/8" | 131 | * | * | 3/8" | 10 | 3/8" | 10 | 2.7 | 24 |
| | 104-A01-050 | 2" | 51 | 1" | 25 | * | * | 5 5/8" | 143 | * | * | 1/2" | 13 | 1/2" | 13 | 1.7 | 15 |
| | 104-A01-075 | 3" | 76 | 1 1/8" | 28 | * | * | 6 5/8" | 169 | * | * | 3/4" | 19 | 3/4" | 19 | 1.7 | 15 |
| | 105-A01-025 | 1" | 25 | 5/8" | 16 | 1/8" | 3 | 1" | 25 | * | * | 1/4" | 6 | 1/4" | 6 | 2.8 | 25 |
| | 105-A01-038 | 1 1/2" | 38 | 5/8" | 16 | 1/8" | 3 | 1 1/2" | 36 | * | * | 3/8" | 10 | 3/8" | 10 | 2.7 | 24 |
| | 105-A01-050 | 2" | 51 | 1" | 25 | 1/8" | 3 | 2" | 47 | * | * | 1/2" | 13 | 1/2" | 13 | 1.7 | 15 |
| | 105-A01-075 | 3" | 76 | 1 1/8" | 28 | 1/8" | 3 | 3" | 73 | * | * | 3/4" | 19 | 3/4" | 19 | 1.7 | 15 |
| | 106-A01-025 | 1" | 25 | 5/8" | 16 | 1/4" | 6 | 1" | 25 | * | * | 1/4" | 6 | 1/4" | 6 | 2.8 | 25 |
| | 106-A01-038 | 1 1/2" | 38 | 5/8" | 16 | 1/4" | 6 | 1 1/2" | 36 | * | * | 3/8" | 10 | 3/8" | 10 | 2.7 | 24 |
| | 106-A01-050 | 2" | 51 | 1" | 25 | 1/4" | 6 | 2" | 47 | * | * | 1/2" | 13 | 1/2" | 13 | 1.7 | 15 |
| | 106-A01-075 | 3" | 76 | 1 1/8" | 28 | 1/4" | 6 | 3" | 73 | * | * | 3/4" | 19 | 3/4" | 19 | 1.7 | 15 |
| Floor to Wall | 103-A02-025 | 1" | 25 | 5/8" | 16 | 1/8" | 4 | 2 1/2" | 64 | * | * | 1/4" | 6 | 1/4" | 6 | 2.8 | 25 |
| | 103-A02-038 | 1 1/2" | 38 | 5/8" | 16 | 1/8" | 4 | 2 15/16" | 75 | * | * | 3/8" | 10 | 3/8" | 10 | 2.7 | 24 |
| | 103-A02-050 | 2" | 51 | 1" | 25 | 1/8" | 4 | 3 3/8" | 86 | * | * | 1/2" | 13 | 1/2" | 13 | 1.7 | 15 |
| | 103-A02-075 | 3" | 76 | 1 1/8" | 28 | 1/8" | 4 | 4 1/2" | 114 | * | * | 3/4" | 19 | 3/4" | 19 | 1.7 | 15 |
| | 104-A02-025 | 1" | 25 | 5/8" | 16 | * | * | 2 7/8" | 73 | * | * | 1/4" | 6 | 1/4" | 6 | 2.8 | 25 |
| | 104-A02-038 | 1 1/2" | 38 | 5/8" | 16 | * | * | 3 5/16" | 84 | * | * | 3/8" | 10 | 3/8" | 10 | 2.7 | 24 |
| | 104-A02-050 | 2" | 51 | 1" | 25 | * | * | 3 3/4" | 95 | * | * | 1/2" | 13 | 1/2" | 13 | 1.7 | 15 |
| | 104-A02-075 | 3" | 76 | 1 1/8" | 28 | * | * | 4 3/4" | 121 | * | * | 3/4" | 19 | 3/4" | 19 | 1.7 | 15 |
| | 105-A02-025 | 1" | 25 | 5/8" | 16 | 1/8" | 3 | 1" | 25 | * | * | 1/4" | 6 | 1/4" | 6 | 2.8 | 25 |
| | 105-A02-038 | 1 1/2" | 38 | 5/8" | 16 | 1/8" | 3 | 1 1/2" | 36 | * | * | 3/8" | 10 | 3/8" | 10 | 2.7 | 24 |
| | 105-A02-050 | 2" | 51 | 1" | 25 | 1/8" | 3 | 2" | 47 | * | * | 1/2" | 13 | 1/2" | 13 | 1.7 | 15 |
| | 105-A02-075 | 3" | 76 | 1 1/8" | 28 | 1/8" | 3 | 3" | 73 | * | * | 3/4" | 19 | 3/4" | 19 | 1.7 | 15 |
| | 106-A02-025 | 1" | 25 | 5/8" | 16 | 1/4" | 6 | 1" | 25 | * | * | 1/4" | 6 | 1/4" | 6 | 2.8 | 25 |
| | 106-A02-038 | 1 1/2" | 38 | 5/8" | 16 | 1/4" | 6 | 1 1/2" | 36 | * | * | 3/8" | 10 | 3/8" | 10 | 2.7 | 24 |
| | 106-A02-050 | 2" | 51 | 1" | 25 | 1/4" | 6 | 2" | 47 | * | * | 1/2" | 13 | 1/2" | 13 | 1.7 | 15 |
| | 106-A02-075 | 3" | 76 | 1 1/8" | 28 | 1/4" | 6 | 3" | 73 | * | * | 3/4" | 19 | 3/4" | 19 | 1.7 | 15 |

IPC.805/REV.6

103, 104, 105, 106 Series Surface Mount Floor Systems

106-A01 Floor/Floor for Carpet
(2" (50mm) system shown)

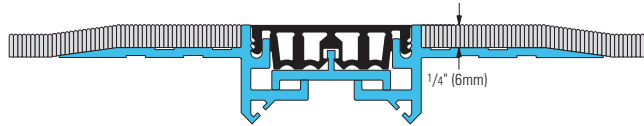

105-A01 Floor/Floor for Sheet
Vinyl Flooring
(2" (50mm) system shown)

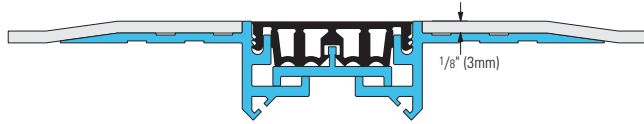

103-A01 Floor/Floor for VCT
(2" (50mm) system shown)

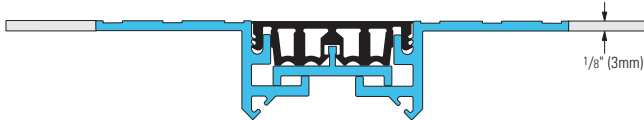

104-A01 Floor/Floor
(2" (50mm) system shown)

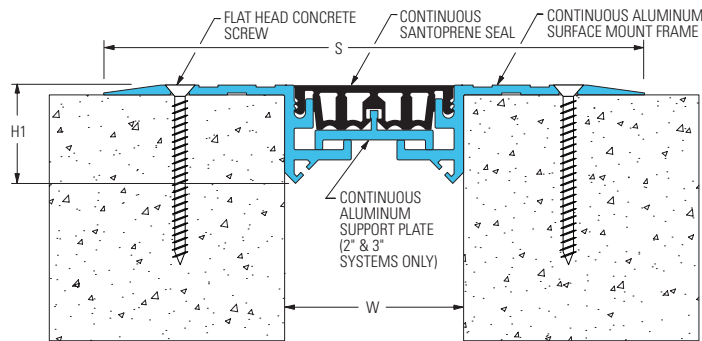

104-A02 Floor/Wall
(2" (50mm) system shown)

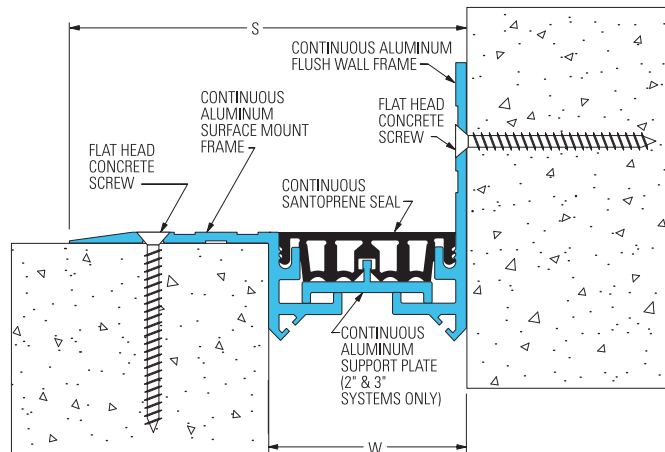

103, 104, 105, 106 Series Options

Integral Vapor Barrier
(104-A01-050 system shown)

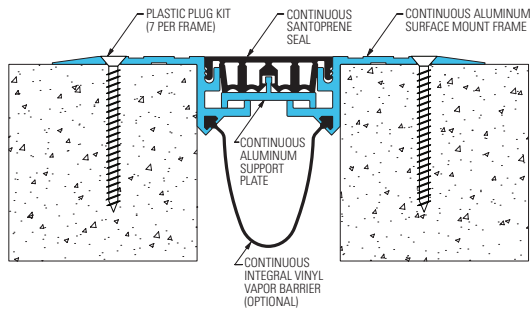

Reactofire Mineral Wool & Sealant Fire Barrier System
(106-A01-025 system shown)

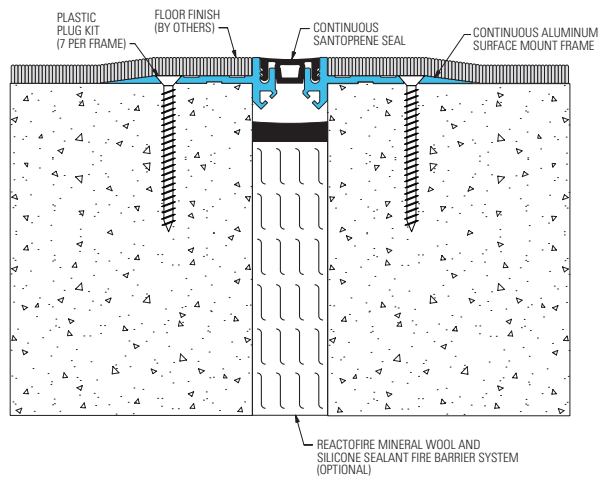

Reactofire Fire Blanket System
(105-A01-050 system shown)

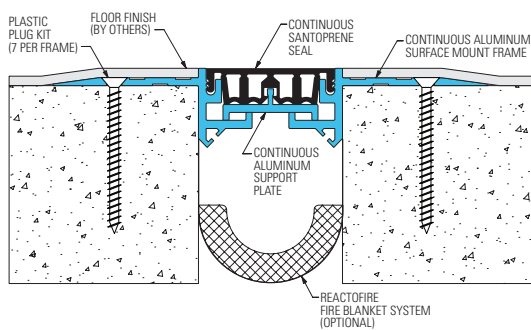

Decorative Caps
(106-A01-025 system shown)

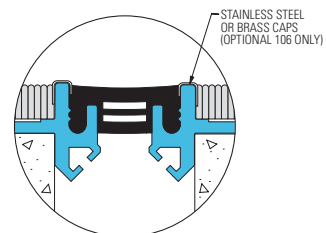

107, 108, 109, 110 Series New to Existing

A01 - Floor to Floor

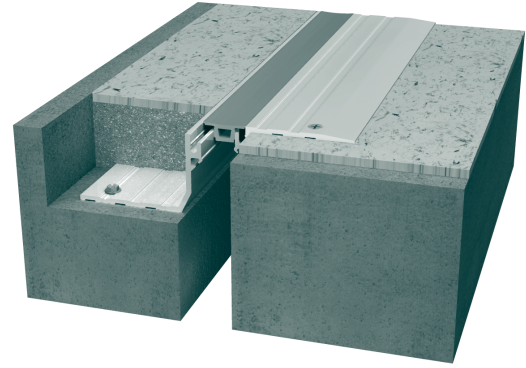

| | | | |
|----------------------|---|---|---|
| | | Movement Rating $\pm 25\%$ | |
| Product Guide |  |  |  |
| | Thermal | Fire Rated Option | Quick Ship Available |

- ▶ Dual durometer seal provides secure fit and optimal flexibility
- ▶ Seals absorb limited serviceable seismic movement
- ▶ Designed for retrofits, additions and renovations where blockout occurs on one side only
- ▶ Adaptable to many floor finishes including concrete, epoxy, ceramic tile, vinyl, carpet, marble and stone
- ▶ Seamlessly integrates with the following wall and ceiling systems

- ▶ Easy to clean flush seals No dirt or water traps
- ▶ Snap-fit design for easy on site assembly
- ▶ Mill finish aluminum
- ▶ Load rated
- ▶ Optional decorative caps in brass or stainless steel (*109 system only*)
- ▶ Integral vapor barrier option available
- ▶ Standard seal colors: black, beige, gray, off white and bright white. Custom colors available upon request.

| Wall | Ceiling |
|-------------|-------------|
| 101-A07/A09 | 101-A07/A09 |
| 104-A07/A09 | 104-A07/A09 |
| 112-A07/A09 | 112-A07/A09 |
| 113-A07/A09 | 113-A07/A09 |

SYSTEM DATA

| Application | System | W | | H1 | | H2 | | S | | B | | Movement +/- | | | | | |
|----------------|-------------|-------------|----|----------------|----|----------|----|-----------|-----|----------|----|--------------|----|----------|----|--------|----|
| | | Joint Width | | Frame Height 1 | | Height 2 | | Sightline | | Blockout | | Horizontal | | Vertical | | Load | |
| | | US | mm | US | mm | US | mm | US | mm | US | mm | US | mm | US | mm | US ton | kN |
| Floor to Floor | 107-A01-025 | 1" | 25 | 1 1/2" | 38 | * | * | 2 7/8" | 73 | 2 1/2" | 64 | 1/4" | 6 | 1/4" | 6 | 2.8 | 25 |
| | 107-A01-038 | 1 1/2" | 38 | 1 1/2" | 38 | * | * | 3 5/16" | 84 | 2 1/2" | 64 | 3/8" | 10 | 3/8" | 10 | 2.7 | 24 |
| | 107-A01-050 | 2" | 51 | 1 1/2" | 38 | * | * | 3 3/4" | 95 | 2 1/2" | 64 | 1/2" | 13 | 1/2" | 13 | 1.7 | 15 |
| | 107-A01-075 | 3" | 76 | 1 1/2" | 38 | * | * | 4 3/4" | 121 | 2 1/2" | 64 | 3/4" | 19 | 3/4" | 19 | 1.7 | 15 |
| | 108-A01-025 | 1" | 25 | 1 1/2" | 38 | 1/8" | 3 | 1" | 25 | 2 1/2" | 64 | 1/4" | 6 | 1/4" | 6 | 2.8 | 25 |
| | 108-A01-038 | 1 1/2" | 38 | 1 1/2" | 38 | 1/8" | 3 | 1 1/2" | 36 | 2 1/2" | 64 | 3/8" | 10 | 3/8" | 10 | 2.7 | 24 |
| | 108-A01-050 | 2" | 51 | 1 1/2" | 38 | 1/8" | 3 | 2" | 47 | 2 1/2" | 64 | 1/2" | 13 | 1/2" | 13 | 1.7 | 15 |
| | 108-A01-075 | 3" | 76 | 1 1/2" | 38 | 1/8" | 3 | 3" | 73 | 2 1/2" | 64 | 3/4" | 19 | 3/4" | 19 | 1.7 | 15 |
| | 109-A01-025 | 1" | 25 | 1 1/2" | 38 | 1/4" | 6 | 1" | 25 | 2 1/2" | 64 | 1/4" | 6 | 1/4" | 6 | 2.8 | 25 |
| | 109-A01-038 | 1 1/2" | 38 | 1 1/2" | 38 | 1/4" | 6 | 1 1/2" | 36 | 2 1/2" | 64 | 3/8" | 10 | 3/8" | 10 | 2.7 | 24 |
| | 109-A01-050 | 2" | 51 | 1 1/2" | 38 | 1/4" | 6 | 2" | 47 | 2 1/2" | 64 | 1/2" | 13 | 1/2" | 13 | 1.7 | 15 |
| | 109-A01-075 | 3" | 76 | 1 1/2" | 38 | 1/4" | 6 | 3" | 73 | 2 1/2" | 64 | 3/4" | 19 | 3/4" | 19 | 1.7 | 15 |
| | 110-A01-025 | 1" | 25 | 1 1/2" | 38 | 1/8" | 4 | 2 1/2" | 64 | 2 1/2" | 64 | 1/4" | 6 | 1/4" | 6 | 2.8 | 25 |
| | 110-A01-038 | 1 1/2" | 38 | 1 1/2" | 38 | 1/8" | 4 | 2 5/16" | 75 | 2 1/2" | 64 | 3/8" | 10 | 3/8" | 10 | 2.7 | 24 |
| | 110-A01-050 | 2" | 51 | 1 1/2" | 38 | 1/8" | 4 | 3 3/8" | 86 | 2 1/2" | 64 | 1/2" | 13 | 1/2" | 13 | 1.7 | 15 |
| | 110-A01-075 | 3" | 76 | 1 1/2" | 38 | 1/8" | 4 | 4 1/2" | 113 | 2 1/2" | 64 | 3/4" | 19 | 3/4" | 19 | 1.7 | 15 |

Standard frame height for recessed side 1 1/2" (38mm)

IPC.808/REV.4

107, 108, 109, 110 Series New to Existing Floor Systems

107-A01 Floor/Floor
(1" (25mm) system shown)

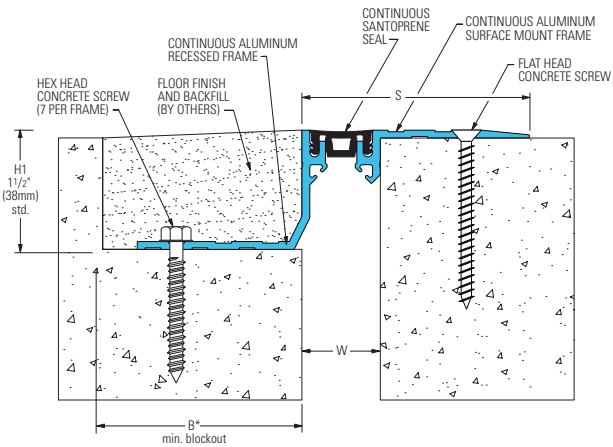

108-A01 Floor/Floor for sheet vinyl flooring
(1" (25mm) system shown)

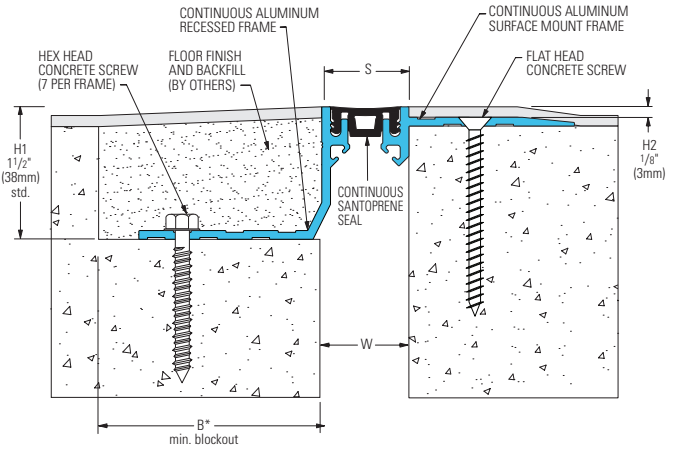

109-A01 Floor/Floor for carpet
(1" (25mm) system shown)

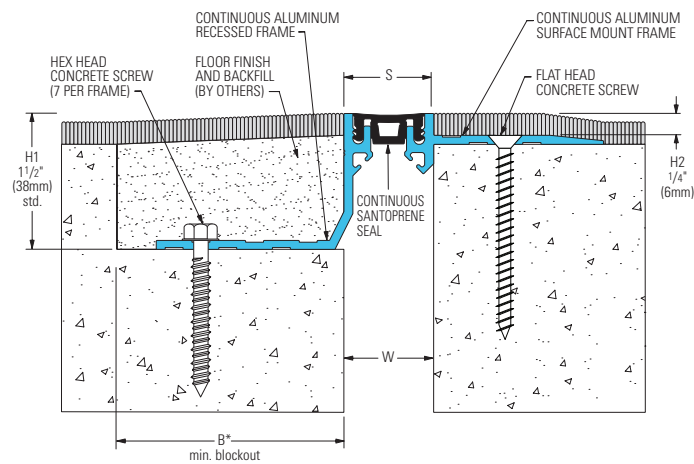

110-A01 Floor/Floor for VCT
(2" (50mm) system shown)

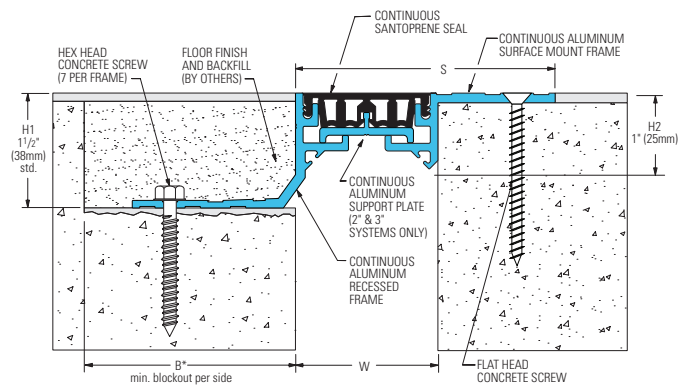

P.O. Box 406 · Muskego, Wisconsin 53150 USA

www.inprocorp.com

Nationwide 800.222.5556/Fax 888.715.8407

International Sales 262.679.5521 / Fax 262.679.5524

107, 108, 109, 110 Series Options

Integral Vapor Barrier (107-A01-025 system shown)

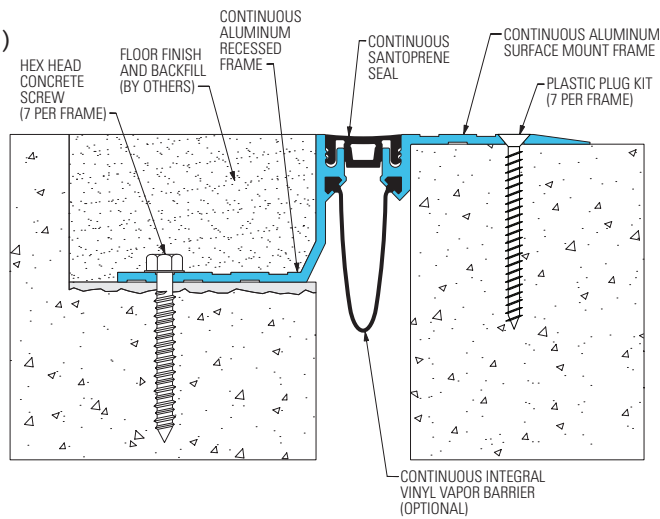

Reactofire Fire Blanket System (109-A01-050 system shown)

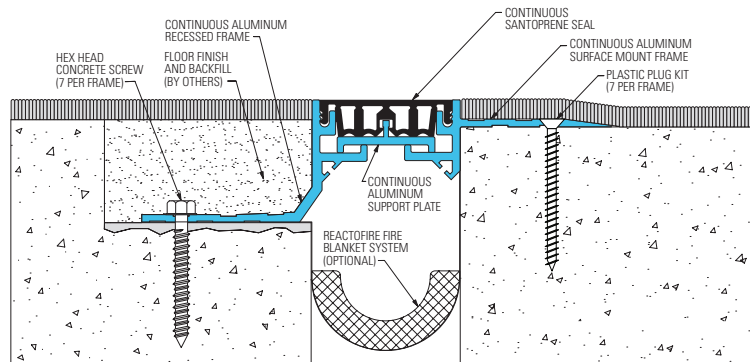

Reactofire Mineral Wool & Sealant Fire Barrier System (108-A01-050 system shown)

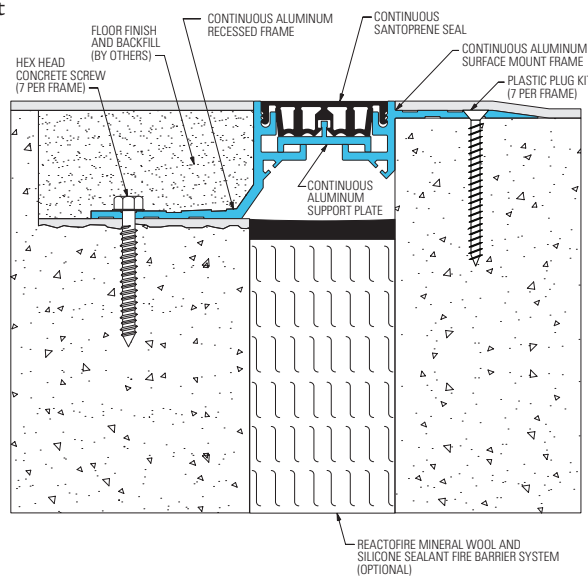

Decorative Caps (109-A01-050 system shown)

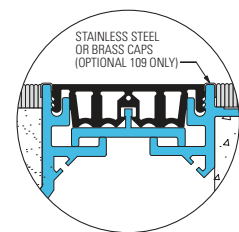



101 Series Recess Mount

A07 - Wall to Wall or Ceiling to Ceiling

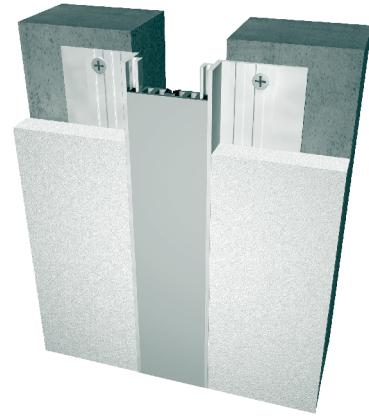
A09 - Wall to Corner or Wall to Ceiling

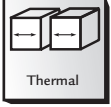

| Movement Rating $\pm 25\%$ | |
|----------------------------|---|
| Product Guide |  |
| |  |

- ▶ Dual durometer seal provide secure fit and optimal flexibility
- ▶ Seals absorb limited serviceable seismic movement
- ▶ Recessed mount frames for minimal sightline
- ▶ Interior and exterior applications
- ▶ Adaptable to any 5/8" (16mm) wall and ceiling finishes including drywall, plaster and tile
- ▶ Snap-on design for easy on site assembly
- ▶ Easy to clean sh seals
- ▶ Mill finish aluminum
- ▶ Optional decorative caps in brass or stainless steel
- ▶ Standard seal colors: black, beige, gray, off white and bright white. Custom colors available upon request.

SYSTEM DATA

| Application | System | W | | H1 | | H2 | | S | | B | | Movement +/- | | | | Load | |
|------------------------------|-------------|-------------|----|----------------|----|----------|----|------------|----|----------|----|--------------|----|----------|----|--------|----|
| | | Joint Width | | Frame Height 1 | | Height 2 | | Sight Line | | Blockout | | Horizontal | | Vertical | | | |
| | | US | mm | US | mm | US | mm | US | mm | US | mm | US | mm | US | mm | US ton | kN |
| Wall/Wall Ceiling/Ceiling | 101-A07-025 | 1" | 25 | 5/8" | 16 | * | * | 1" | 25 | * | * | 1/4" | 6 | 1/4" | 6 | * | * |
| | 101-A07-038 | 1 1/2" | 38 | 5/8" | 16 | * | * | 1 7/16" | 36 | * | * | 3/8" | 10 | 3/8" | 10 | * | * |
| | 101-A07-050 | 2" | 51 | 5/8" | 16 | * | * | 1 7/8" | 47 | * | * | 1/2" | 13 | 1/2" | 13 | * | * |
| | 101-A07-075 | 3" | 76 | 5/8" | 16 | * | * | 2 7/8" | 73 | * | * | 3/4" | 19 | 3/4" | 19 | * | * |
| Wall/Corner Wall/Ceiling | 101-A09-025 | 1" | 25 | 5/8" | 16 | * | * | 1" | 25 | * | * | 1/4" | 6 | 1/4" | 6 | * | * |
| | 101-A09-038 | 1 1/2" | 38 | 5/8" | 16 | * | * | 1 7/16" | 36 | * | * | 3/8" | 10 | 3/8" | 10 | * | * |
| | 101-A09-050 | 2" | 51 | 5/8" | 16 | * | * | 1 7/8" | 47 | * | * | 1/2" | 13 | 1/2" | 13 | * | * |
| | 101-A09-075 | 3" | 76 | 5/8" | 16 | * | * | 2 7/8" | 73 | * | * | 3/4" | 19 | 3/4" | 19 | * | * |

IPC.819/REV.4

101 Series Recessed Mount Wall and Ceiling Systems

101-A07 Wall/Wall Ceiling/Ceiling
(2" (50mm) system shown)

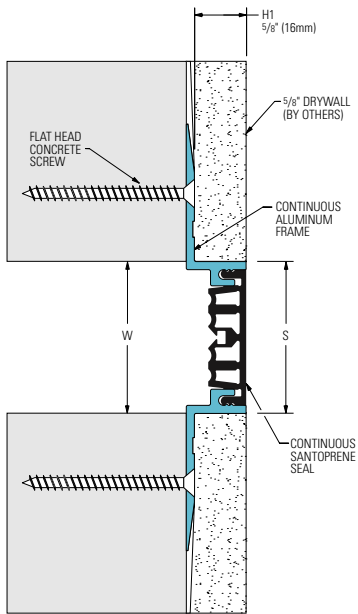

101-A09 Wall/Corner Wall/Ceiling
(2" (50mm) system shown)

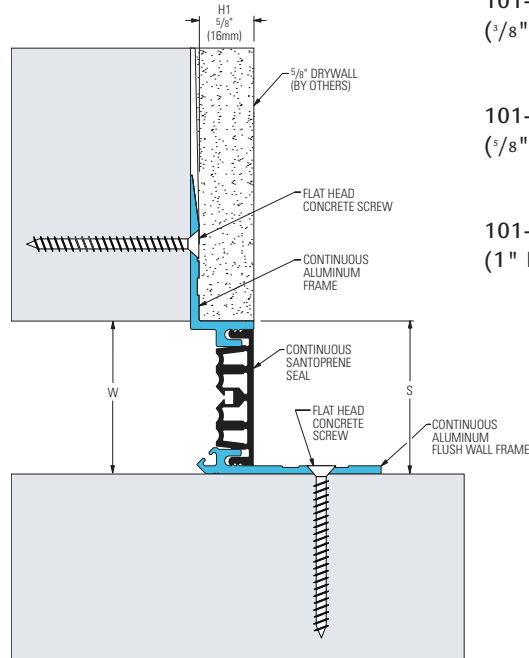

Wall Frame Options

101-A10
(3/8" Finishes)



101-A11
(5/8" Finishes)

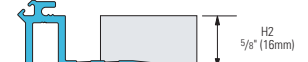

101-A12
(1" Finishes)

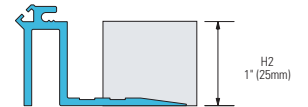

101 Series Options

Reactofire Fire Blanket System
(101-A07-050 system shown)

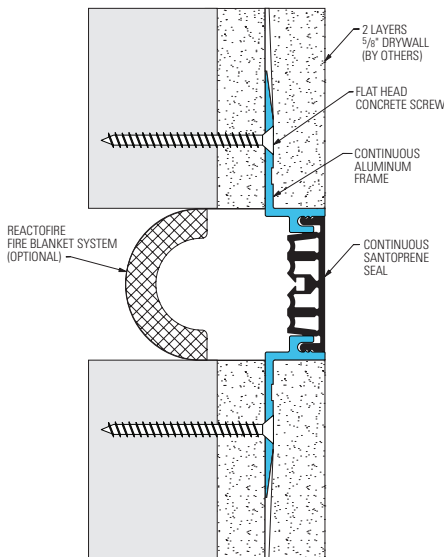

Decorative Caps
(101-A07-050 system shown)

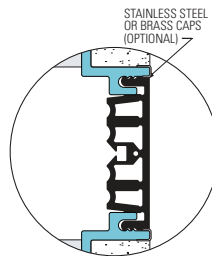

112, 113 Series Recess Mount

A07 - Wall to Wall or Ceiling to Ceiling

A09 - Wall to Corner or Wall to Ceiling



| | | | |
|---------------|---|---|---|
| | | Movement Rating $\pm 25\%$ | |
| Product Guide |  |  |  |
| | | | |

- ▶ Dual durometer seal provides secure fit and optimal flexibility
- ▶ Seals absorb limited serviceable seismic movement
- ▶ Designed for 5/8" (16mm) drywall installation
- ▶ Model **112** - Snap-in frame for 5/8" (16mm) drywall - No need to finish* Clear anodized finish on **112** model
- ▶ Model **113** - Finish with laster joint compound or wallcovering
- ▶ Easy to clean flush seals
- ▶ Snap-fit design for easy on site assembly
- ▶ Standard seal colors: black, beige, gray, off white and bright white. Custom colors available upon request.

SYSTEM DATA

| Application | System | W | | H1 | | H2 | | S | | B | | Movement +/- | | | | Load | |
|---------------------------|-------------|-------------|----|----------------|----|----------|----|------------|-----|----------|----|--------------|----|----------|----|--------|----|
| | | Joint Width | | Frame Height 1 | | Height 2 | | Sight Line | | Blockout | | Horizontal | | Vertical | | | |
| | | US | mm | US | mm | US | mm | US | mm | US | mm | US | mm | US | mm | US ton | kN |
| Wall/Wall Ceiling/Ceiling | 112-A07-025 | 1" | 25 | 5/8" | 16 | * | * | 2" | 51 | * | * | 1/4" | 6 | 1/4" | 6 | * | * |
| | 112-A07-038 | 1 1/2" | 38 | 5/8" | 16 | * | * | 2 7/16" | 62 | * | * | 3/8" | 10 | 3/8" | 10 | * | * |
| | 112-A07-050 | 2" | 51 | 5/8" | 16 | * | * | 2 7/8" | 73 | * | * | 1/2" | 13 | 1/2" | 13 | * | * |
| | 112-A07-075 | 3" | 76 | 5/8" | 16 | * | * | 4" | 102 | * | * | 3/4" | 19 | 3/4" | 19 | * | * |
| | 113-A07-025 | 1" | 25 | * | * | * | * | 1" | 25 | * | * | 1/4" | 6 | 1/4" | 6 | * | * |
| | 113-A07-038 | 1 1/2" | 38 | * | * | * | * | 1 1/2" | 36 | * | * | 3/8" | 10 | 3/8" | 10 | * | * |
| | 113-A07-050 | 2" | 51 | * | * | * | * | 2" | 47 | * | * | 1/2" | 13 | 1/2" | 13 | * | * |
| Wall/Corner Wall/Ceiling | 113-A07-075 | 3" | 76 | * | * | * | * | 3" | 76 | * | * | 3/4" | 19 | 3/4" | 19 | * | * |
| | 112-A09-025 | 1" | 25 | 5/8" | 16 | * | * | 1 1/2" | 38 | * | * | 1/4" | 6 | 1/4" | 6 | * | * |
| | 112-A09-038 | 1 1/2" | 38 | 5/8" | 16 | * | * | 1 15/16" | 49 | * | * | 3/8" | 10 | 3/8" | 10 | * | * |
| | 112-A09-050 | 2" | 51 | 5/8" | 16 | * | * | 2 3/8" | 60 | * | * | 1/2" | 13 | 1/2" | 13 | * | * |
| | 112-A09-075 | 3" | 76 | 5/8" | 16 | * | * | 3 3/8" | 86 | * | * | 3/4" | 19 | 3/4" | 19 | * | * |
| | 113-A09-025 | 1" | 25 | * | * | * | * | 1" | 25 | * | * | 1/4" | 6 | 1/4" | 6 | * | * |
| | 113-A09-038 | 1 1/2" | 38 | * | * | * | * | 1 1/2" | 36 | * | * | 3/8" | 10 | 3/8" | 10 | * | * |
| | 113-A09-050 | 2" | 51 | * | * | * | * | 2" | 47 | * | * | 1/2" | 13 | 1/2" | 13 | * | * |
| | 113-A09-075 | 3" | 76 | * | * | * | * | 3" | 73 | * | * | 3/4" | 19 | 3/4" | 19 | * | * |

IPC.811/REV.6

112, 113 Series Wall and Ceiling Systems for Drywall Finishes

112-A07 Wall/Wall Ceiling/Ceiling
(2" (50mm) system shown)

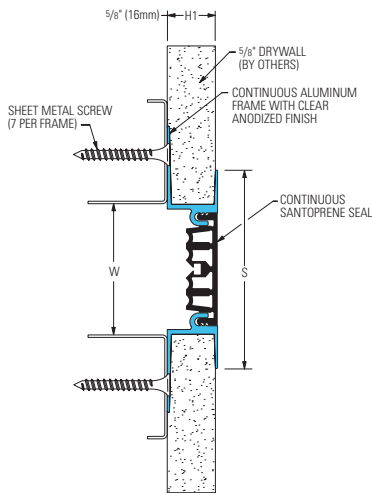

113-A07 Wall/Wall Ceiling/Ceiling
(2" (50mm) system shown)

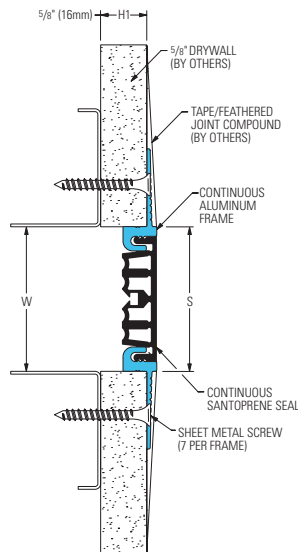

112-A09 Wall/Corner Wall/Ceiling
(2" (50mm) system shown)

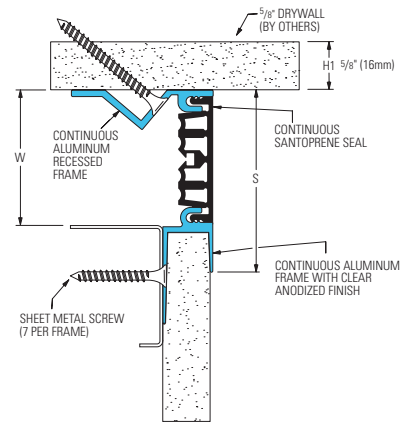

113-A09 Wall/Corner Wall/Ceiling
(2" (50mm) system shown)

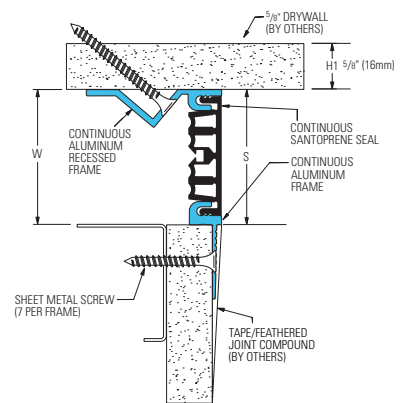

112, 113 Series Options

Reactofire Fire Blanket System
(113-A07-050 system shown)

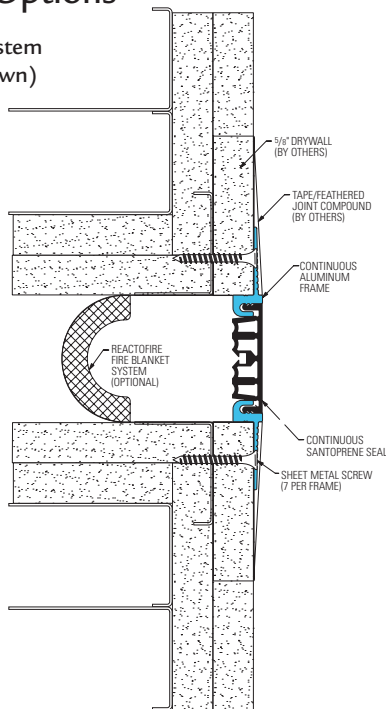

104 Series Surface Mount

A07 - Wall to Wall or Ceiling to Ceiling

A09 - Wall to Corner or Wall to Ceiling

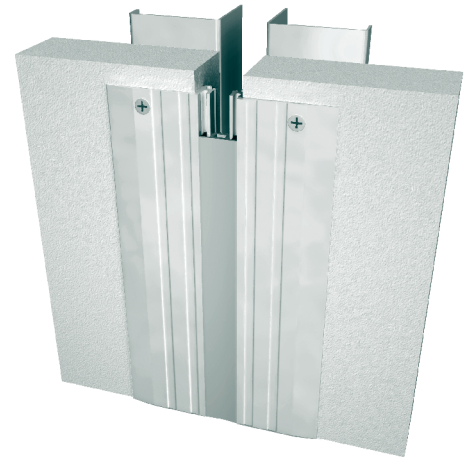

| Movement Rating $\pm 25\%$ | |
|--|---|
| Product Guide |  Thermal |
| |  Fire Rated Option |
|  Quick Ship Available | |

- ▶ Dual durometer seal provides secure fit and optimal flexibility
- ▶ Seals absorb limited serviceable seismic movement
- ▶ Designed for renovation and surface mount installations
- ▶ Adaptable on any wall finish
- ▶ Easy to clean flush seals
- ▶ Standard seal colors: black, beige, gray, off white and bright white. Custom colors available upon request.
- ▶ Clear anodized finish
- ▶ Snap-fit design for easy on site assembly

SYSTEM DATA

| Application | System | W | | H1 | | H2 | | S | | B | | Movement +/- | | | | Load | |
|------------------------------|-------------|-------------|----|----------------|----|--------------|----|------------|-----|----------|----|--------------|----|----------|----|--------|----|
| | | Joint Width | | Frame Height 1 | | Sub Height 2 | | Sight Line | | Blockout | | Horizontal | | Vertical | | US ton | |
| | | US | mm | US | mm | US | mm | US | mm | US | mm | US | mm | US | mm | US ton | kN |
| Wall/Wall Ceiling/Ceiling | 104-A07-025 | 1" | 25 | * | * | * | * | 4 3/4" | 121 | * | * | 1/4" | 6 | 1/4" | 6 | * | * |
| | 104-A07-038 | 1 1/2" | 38 | * | * | * | * | 5 1/8" | 130 | * | * | 3/8" | 10 | 3/8" | 10 | * | * |
| | 104-A07-050 | 2" | 51 | * | * | * | * | 5 5/8" | 143 | * | * | 1/2" | 13 | 1/2" | 13 | * | * |
| | 104-A07-075 | 3" | 76 | * | * | * | * | 6 5/8" | 168 | * | * | 3/4" | 19 | 3/4" | 19 | * | * |
| Wall/Corner Wall/Ceiling | 104-A09-025 | 1" | 25 | * | * | * | * | 2 7/8" | 73 | * | * | 1/4" | 6 | 1/4" | 6 | * | * |
| | 104-A09-038 | 1 1/2" | 38 | * | * | * | * | 3 5/16" | 84 | * | * | 3/8" | 10 | 3/8" | 10 | * | * |
| | 104-A09-050 | 2" | 51 | * | * | * | * | 3 3/4" | 95 | * | * | 1/2" | 13 | 1/2" | 13 | * | * |
| | 104-A09-075 | 3" | 76 | * | * | * | * | 4 3/4" | 121 | * | * | 3/4" | 19 | 3/4" | 19 | * | * |
| Wall/Wall | 118-A07-050 | 2" | 50 | * | * | * | * | 1 7/8" | 47 | * | * | 1/2" | 13 | 1/2" | 13 | * | * |
| | 118-A07-075 | 3" | 75 | * | * | * | * | 2 7/8" | 73 | * | * | 3/4" | 19 | 3/4" | 19 | * | * |
| Wall/Corner | 118-A09-050 | 2" | 50 | * | * | * | * | 1 7/8" | 47 | * | * | 1/2" | 13 | 1/2" | 13 | * | * |
| | 118-A09-075 | 3" | 75 | * | * | * | * | 2 7/8" | 73 | * | * | 3/4" | 19 | 3/4" | 19 | * | * |

IPC.814/REV.4

104 Series Surface Mount Wall and Ceiling Systems

104-A07

Wall/Wall Ceiling/Ceiling
(2" (50mm) system shown)

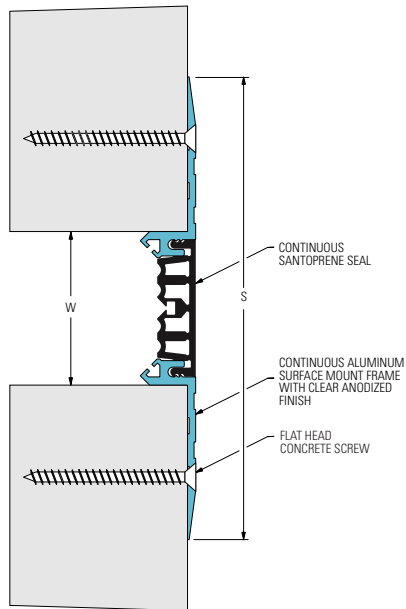

104-A09

Wall/Corner Wall/Ceiling
(2" (50mm) system shown)

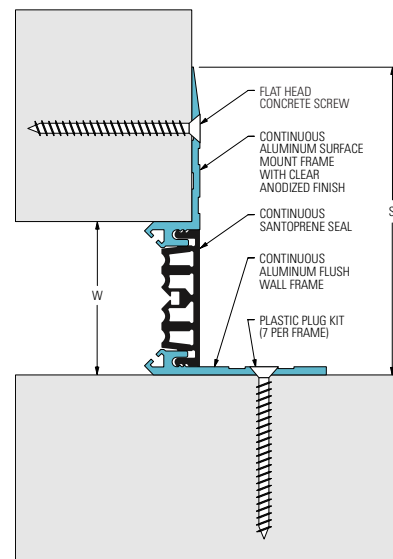

104 Series Options

Reactofire Fire Blanket System
(104-A07-050 system shown)

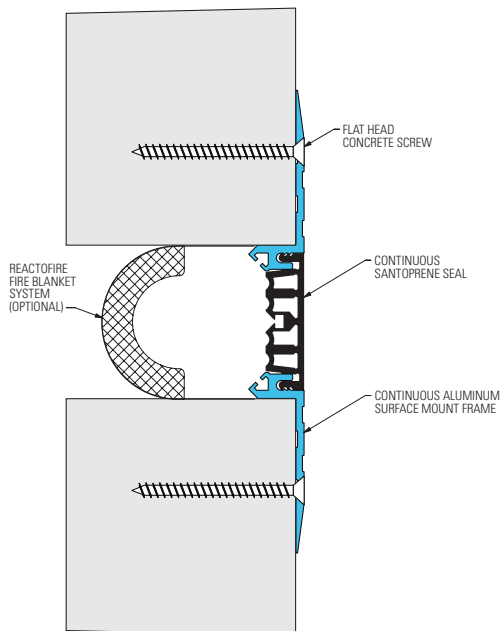

Reactofire Mineral Wool & Sealant Fire Barrier System
(104-A07-050 system shown)

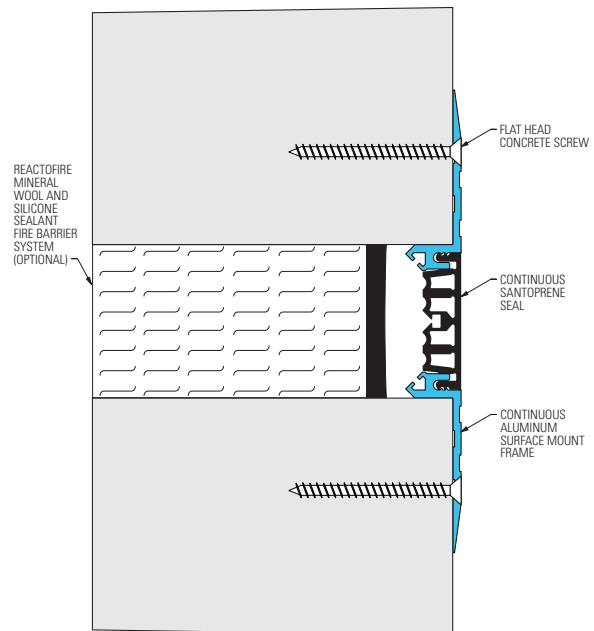

114, 115 Series

A07 - Wall to Wall or Ceiling to Ceiling

A09 - Wall to Corner or Wall to Ceiling

A24 - Ceiling to Ceiling

A18 - Wall to Ceiling

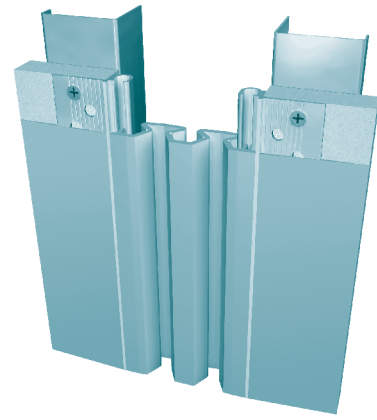

Product Guide



(114 only)



- ▶ Model **114** - Designed for 5/8" (16mm) drywall installation and minimal sightline
- ▶ 19 Finish with plaster joint compound or wall covering - Model **114**
- ▶ Model **115** frame pop rivets to T-Bar profile in suspended ceiling system
- ▶ Bellows seal allows for seismic movement
- ▶ Standard seal colors: black, beige, gray, off white and bright white. Custom colors available upon request.

SYSTEM DATA

| Application | System | W Joint Width | | H1 Frame Height 1 | | H2 Sub Height 2 | | S Sight Line | | B Blockout | | Movement +/- | | | | Load | |
|------------------------------|-------------|------------------|-----|----------------------|----|--------------------|----|-----------------|-----|---------------|----|--------------|----|----------|----|--------|----|
| | | | | | | | | | | | | Horizontal | | Vertical | | | |
| | | US | mm | US | mm | US | mm | US | mm | US | mm | US | mm | US | mm | US ton | kN |
| Wall/Wall Ceiling/Ceiling | 114-A07-050 | 2" | 51 | * | * | * | * | 2 1/8" | 54 | * | * | 1" | 25 | 1" | 25 | * | * |
| | 114-A07-075 | 3" | 76 | * | * | * | * | 3 1/16" | 78 | * | * | 1 1/2" | 38 | 1 1/2" | 38 | * | * |
| | 114-A07-100 | 4" | 102 | * | * | * | * | 4 1/8" | 105 | * | * | 2" | 51 | 2" | 51 | * | * |
| | 114-A07-150 | 6" | 152 | * | * | * | * | 6 1/8" | 156 | * | * | 3" | 76 | 3" | 76 | * | * |
| Wall/Corner Wall/Ceiling | 114-A09-050 | 2" | 51 | * | * | * | * | 2" | 51 | * | * | 1" | 25 | 1" | 25 | * | * |
| | 114-A09-075 | 3" | 76 | * | * | * | * | 3" | 76 | * | * | 1 1/2" | 38 | 1 1/2" | 38 | * | * |
| | 114-A09-100 | 4" | 102 | * | * | * | * | 4" | 102 | * | * | 2" | 51 | 2" | 51 | * | * |
| | 114-A09-150 | 6" | 152 | * | * | * | * | 6" | 152 | * | * | 3" | 76 | 3" | 76 | * | * |

| Application | System | W Joint Width | | H1 Frame Height 1 | | H2 Sub Height 2 | | S Sight Line | | B Blockout | | Movement +/- | | | | Load | |
|-----------------|-------------|------------------|-----|----------------------|----|--------------------|----|-----------------|-----|---------------|----|--------------|----|----------|----|--------|----|
| | | | | | | | | | | | | Horizontal | | Vertical | | | |
| | | US | mm | US | mm | US | mm | US | mm | US | mm | US | mm | US | mm | US ton | kN |
| Ceiling/Ceiling | 115-A24-050 | 2" | 51 | * | * | * | * | 2" | 51 | * | * | 1" | 25 | 1" | 25 | * | * |
| | 115-A24-075 | 3" | 76 | * | * | * | * | 3" | 76 | * | * | 1 1/2" | 38 | 1 1/2" | 38 | * | * |
| | 115-A24-100 | 4" | 102 | * | * | * | * | 4" | 102 | * | * | 2" | 51 | 2" | 51 | * | * |
| Wall/Ceiling | 115-A18-050 | 2" | 51 | * | * | * | * | 2" | 51 | * | * | 1" | 25 | 1" | 25 | * | * |
| | 115-A18-075 | 3" | 76 | * | * | * | * | 3" | 76 | * | * | 1 1/2" | 38 | 1 1/2" | 38 | * | * |
| | 115-A18-100 | 4" | 102 | * | * | * | * | 4" | 102 | * | * | 2" | 51 | 2" | 51 | * | * |

IPC.905/REV.4

114, 115 Series Wall and Ceiling Systems

114-A07

Wall/Wall Ceiling/Ceiling
(3" (75mm) system shown)

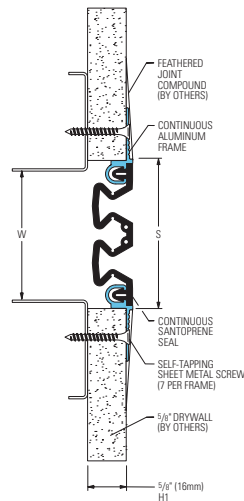

114-A09

Wall/Corner Wall/Ceiling
(2" (50mm) system shown)

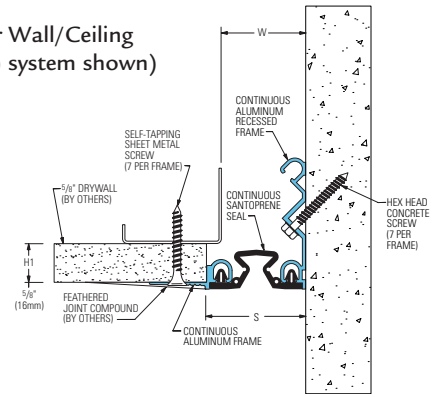

115-A24

Ceiling/Ceiling
(2" (50mm) system shown)

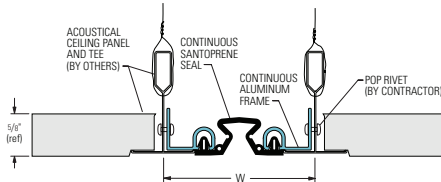

115-A18

Ceiling/Wall
(2" (50mm) system shown)

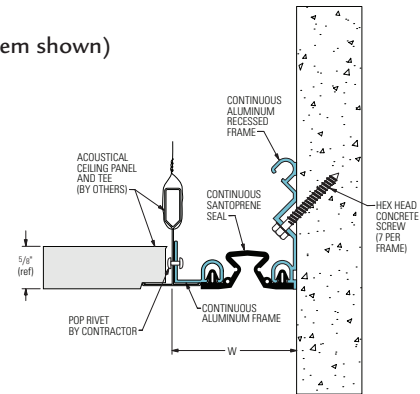

114, 115 Series Options

Reactofire Fire Blanket System
(114-A07-075 system shown)

