

# 107, 108, 109, 110 Series New to Existing

## A01 - Floor to Floor

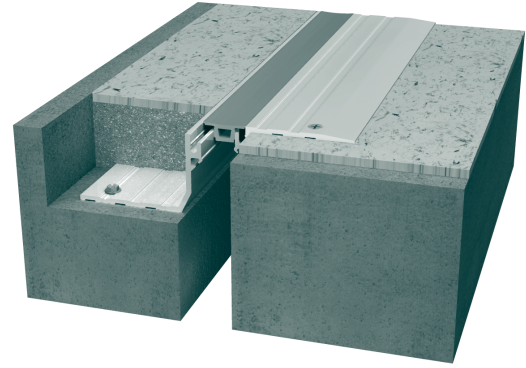

		<b>Movement Rating <math>\pm 25\%</math></b>	
<b>Product Guide</b>			
	Thermal	Fire Rated Option	Quick Ship Available

- ▶ Dual durometer seal provides secure fit and optimal flexibility
- ▶ Seals absorb limited serviceable seismic movement
- ▶ Designed for retrofits, additions and renovations where blockout occurs on one side only
- ▶ Adaptable to many floor finishes including concrete, epoxy, ceramic tile, vinyl, carpet, marble and stone
- ▶ Seamlessly integrates with the following wall and ceiling systems

- ▶ Easy to clean flush seals No dirt or water traps
- ▶ Snap-fit design for easy on site assembly
- ▶ Mill finish aluminum
- ▶ Load rated
- ▶ Optional decorative caps in brass or stainless steel (*109 system only*)
- ▶ Integral vapor barrier option available
- ▶ Standard seal colors: black, beige, gray, off white and bright white. Custom colors available upon request.

Wall	Ceiling
101-A07/A09	101-A07/A09
104-A07/A09	104-A07/A09
112-A07/A09	112-A07/A09
113-A07/A09	113-A07/A09

### SYSTEM DATA

Application	System	W		H1		H2		S		B		Movement +/-					
		Joint Width		Frame Height 1		Height 2		Sightline		Blockout		Horizontal		Vertical		Load	
		US	mm	US	mm	US	mm	US	mm	US	mm	US	mm	US	mm	US ton	kN
Floor to Floor	107-A01-025	1"	25	1 1/2"	38	*	*	2 7/8"	73	2 1/2"	64	1/4"	6	1/4"	6	2.8	25
	107-A01-038	1 1/2"	38	1 1/2"	38	*	*	3 5/16"	84	2 1/2"	64	3/8"	10	3/8"	10	2.7	24
	107-A01-050	2"	51	1 1/2"	38	*	*	3 3/4"	95	2 1/2"	64	1/2"	13	1/2"	13	1.7	15
	107-A01-075	3"	76	1 1/2"	38	*	*	4 3/4"	121	2 1/2"	64	3/4"	19	3/4"	19	1.7	15
	108-A01-025	1"	25	1 1/2"	38	1/8"	3	1"	25	2 1/2"	64	1/4"	6	1/4"	6	2.8	25
	108-A01-038	1 1/2"	38	1 1/2"	38	1/8"	3	1 1/2"	36	2 1/2"	64	3/8"	10	3/8"	10	2.7	24
	108-A01-050	2"	51	1 1/2"	38	1/8"	3	2"	47	2 1/2"	64	1/2"	13	1/2"	13	1.7	15
	108-A01-075	3"	76	1 1/2"	38	1/8"	3	3"	73	2 1/2"	64	3/4"	19	3/4"	19	1.7	15
	109-A01-025	1"	25	1 1/2"	38	1/4"	6	1"	25	2 1/2"	64	1/4"	6	1/4"	6	2.8	25
	109-A01-038	1 1/2"	38	1 1/2"	38	1/4"	6	1 1/2"	36	2 1/2"	64	3/8"	10	3/8"	10	2.7	24
	109-A01-050	2"	51	1 1/2"	38	1/4"	6	2"	47	2 1/2"	64	1/2"	13	1/2"	13	1.7	15
	109-A01-075	3"	76	1 1/2"	38	1/4"	6	3"	73	2 1/2"	64	3/4"	19	3/4"	19	1.7	15
	110-A01-025	1"	25	1 1/2"	38	1/8"	4	2 1/2"	64	2 1/2"	64	1/4"	6	1/4"	6	2.8	25
	110-A01-038	1 1/2"	38	1 1/2"	38	1/8"	4	2 5/16"	75	2 1/2"	64	3/8"	10	3/8"	10	2.7	24
	110-A01-050	2"	51	1 1/2"	38	1/8"	4	3 3/8"	86	2 1/2"	64	1/2"	13	1/2"	13	1.7	15
	110-A01-075	3"	76	1 1/2"	38	1/8"	4	4 1/2"	113	2 1/2"	64	3/4"	19	3/4"	19	1.7	15

Standard frame height for recessed side 1 1/2" (38mm)

IPC.808/REV.4

# 107, 108, 109, 110 Series New to Existing Floor Systems

**107-A01 Floor/Floor**  
(1" (25mm) system shown)

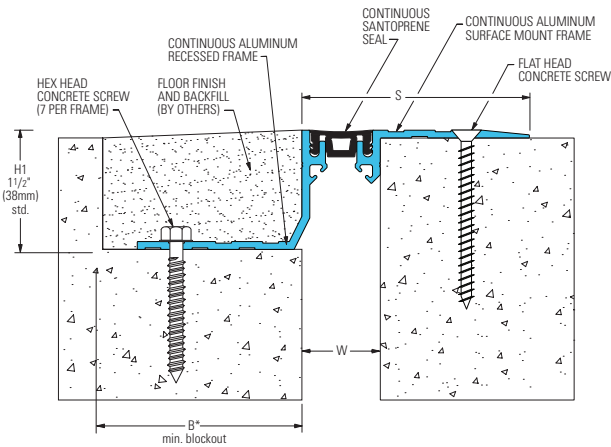

**108-A01 Floor/Floor for sheet vinyl flooring**  
(1" (25mm) system shown)

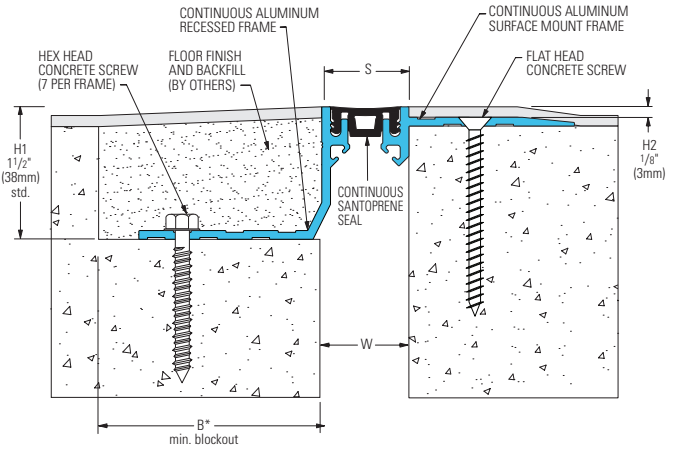

**109-A01 Floor/Floor for carpet**  
(1" (25mm) system shown)

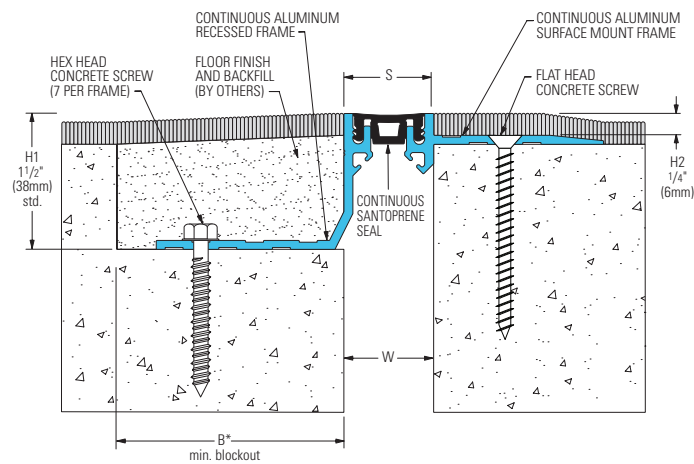

**110-A01 Floor/Floor for VCT**  
(2" (50mm) system shown)

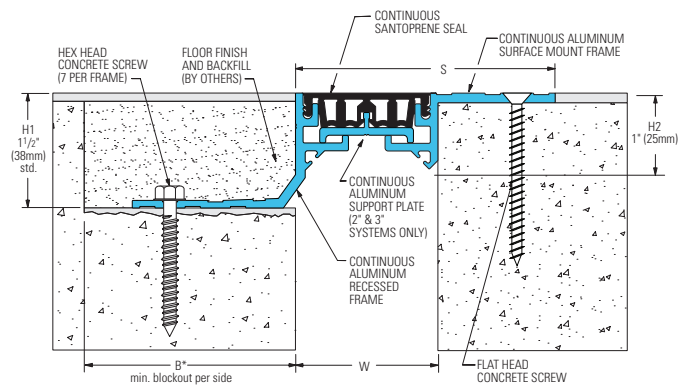

P.O. Box 406 · Muskego, Wisconsin 53150 USA

[www.inprocorp.com](http://www.inprocorp.com)

Nationwide **800.222.5556**/Fax 888.715.8407

International Sales **262.679.5521** / Fax 262.679.5524

## 107, 108, 109, 110 Series Options

### Integral Vapor Barrier (107-A01-025 system shown)

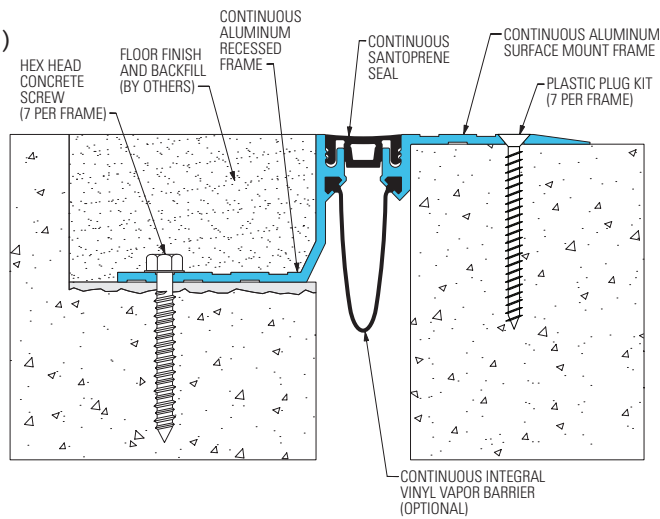

### Reactofire Fire Blanket System (109-A01-050 system shown)

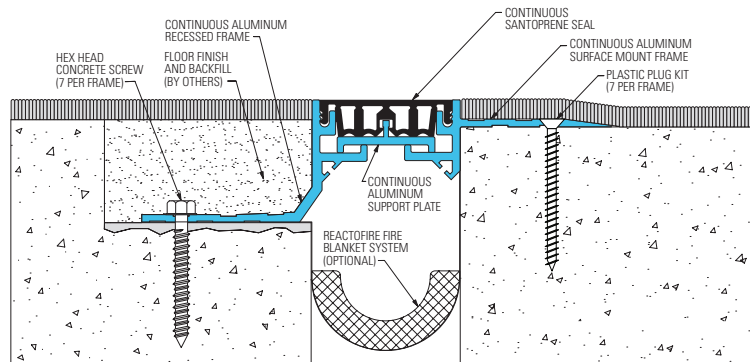

### Reactofire Mineral Wool & Sealant Fire Barrier System (108-A01-050 system shown)

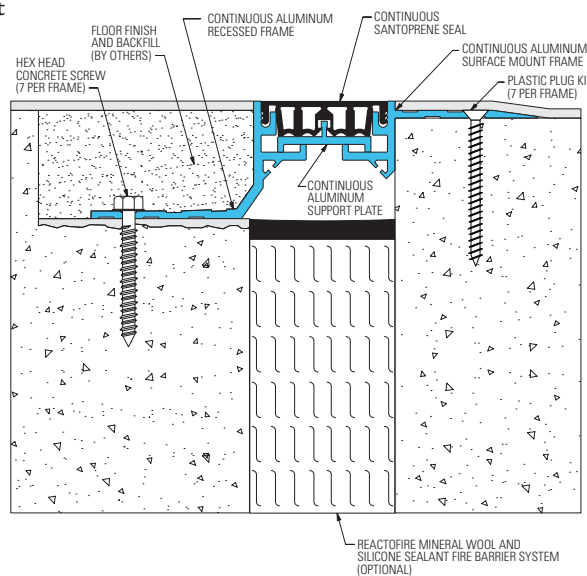

### Decorative Caps (109-A01-050 system shown)

