

Cams, Pintles & Hinge Pins

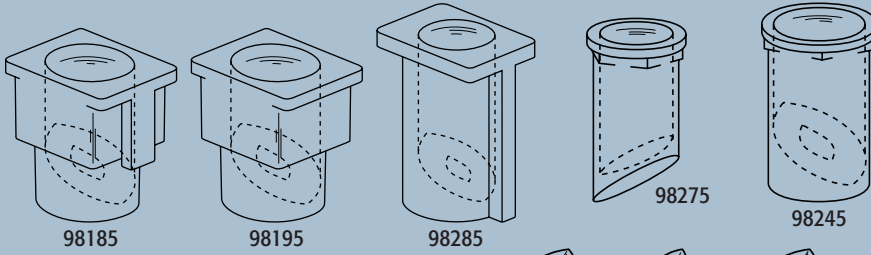

98185

98195

98285

98275

98245

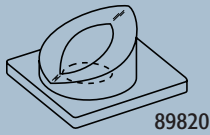

89820

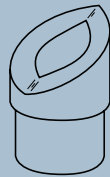

89830

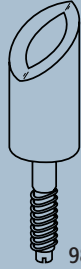

98175

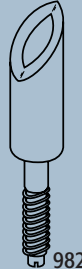

98265

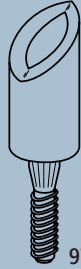

97275

PART #		CAMS	
89820	M-Hinges (3540 & 3550)		
98185	Square - Unshaved		
98195	Square - Shaved		
98245	Round for 5/8" Pintle		
98275	Round for 1/2" Pintle		
98285	Round with Keylock (Use with #97205 Pintle only)		
PART #		PINTLES	
89830	M-Hinges (3540 & 3550)		
97205	1/2" Diameter (Use with #98285 Cam only)		
97275	5/8" Diameter (Knickerbocker)		
98175	5/8" Diameter		
98265	1/2" Diameter		
98305	Nut and Washer Pack for Pintles		
PART #		CAM & PINTLE SETS (WITH NUTS & WASHERS)	
PINTLE	CAM	DESCRIPTION	
97305	98265	98275	5/8" Round
97315	97205	98285	5/8" Round with Keylock
97325	98175	98245	3/4" Round
97335	98175	98195	7/8" Square - Shaved
97345	98175	98185	7/8" Square - Unshaved

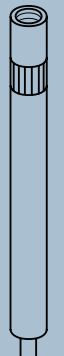
91715
91719

98614

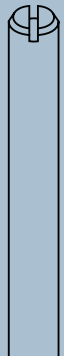

98584

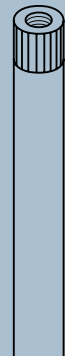

98634



99585

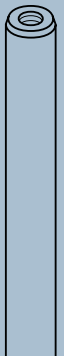

99574



99109

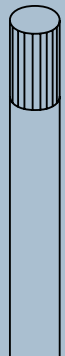

99119

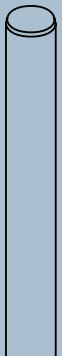

98544

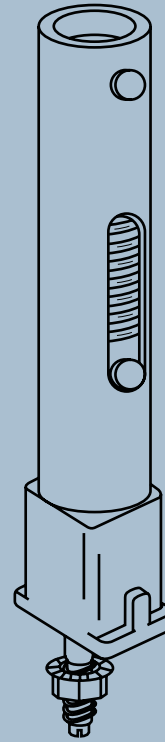

97435

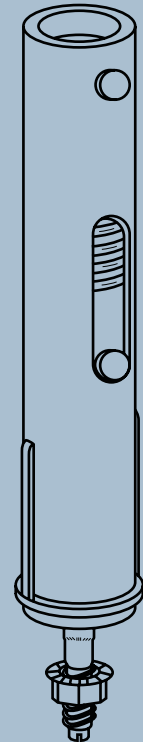

97245

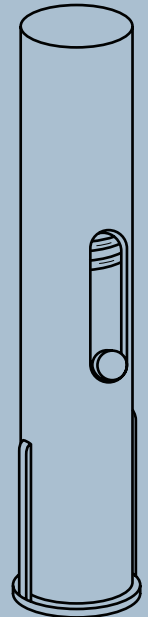

97265

PART #	CANDLE CAMS
97435	Metpar
97245	General
97265	Knickerbocker

PART #	HINGE PINS		
	MATERIAL	DIMENSIONS	USED FOR
98715	Knurled Plastic	3/8" Dia. x 2-1/2" L	Sanymetal
98719	Knurled Stainless		
98614	Knurled Steel	1/4" Dia. x 2-3/4" L	General
98584	Threaded Steel	3/8" Dia. x 3" L	Ampco, Metpar & Flush Metal
98589	Threaded Stainless		
98634	Knurled Steel	5/16" Dia. x 3" L	All American
99585	Knurled Steel	7/32" Dia. x 3-1/4" L	Ampco
99574	Zinc Plated Steel	7/16" Dia. x 3-5/16" L	Fiat
99109	Knurled Steel	3/8" Dia. x 3-1/2" L	
99119	Knurled Stainless		
98544	Zinc Plated Steel	3/8" Dia. x 3-3/4" L	Shanahan

PART #	INTEGRAL HINGE SET
7005	Includes Three Set Screws (T-7 Bit Required for Installation)

REPLACEMENT PARTS FOR SURFACE HINGES ON PAGE 13

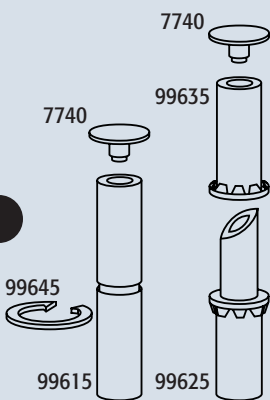

7740

99635

7740

99645

99615

99625

7035		CONTENTS		USED WITH	
7740	Nylon Cap	Round Barrel Hinge Parts for Surface Mounted Hinges (7011, 7021, 7033, 7043, 7053, 7063, 7113, 7123)			
99615	Nylon Pin				
99625	Nylon Pintle				
99635	Nylon Cam				
99645	Nylon Retaining Ring				
7405		CONTENTS		USED WITH	
97015	Pintle	Square Barrel Hinge Parts for Surface Mounted Hinges (7413, 7423)			
97025	Nylon Pintle Housing				
97035	Nylon Cam				
97045	Nylon Pin Assembly				
97055	Nylon Pin Housing				
97065	Nylon Cap				



97055



97035

97065 x 4

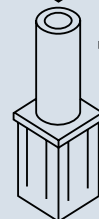

97045



97025

97015

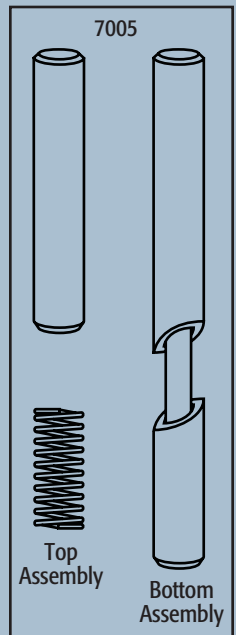

7005

Top Assembly

Bottom Assembly