

Special Profiles

AD-FOB-I

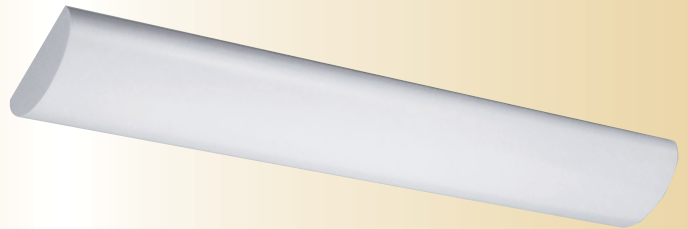
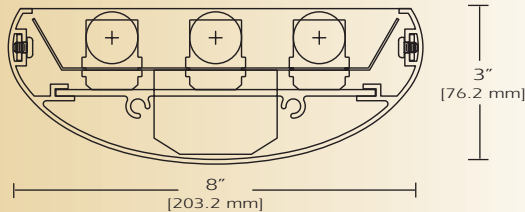

TYPE _____

FEATURES

The AD FOB I is a suspended mounted variation of this complete family of luminaires. A smooth laser cut welded end finishes the graceful elliptical contour of the extruded aluminum profile. The computer designed optical system creates a wide spread indirect distribution. The housing is available with a wide variety of direct perforated accent patterns. These fixtures can be mounted individually, in continuous runs or patterns.

SPECIFICATIONS

Housing: One-piece heavy gauge extruded aluminum 6063T5 alloy welded construction forming a 8" by 3" ellipse profile. Finished end caps are welded to the housing with no exposed hardware or knockouts. Special aperture patterns are available.

Reflector: Die formed 20-gauge cold rolled steel minimum 90% reflectivity finished in high gloss baked white enamel.

Shielding: Standard luminaire is solid construction. Shielding options are available. Aperture openings available on this fixture are 3/8" diameter stagger pattern, window openings of 1 1/4" x 2 1/2" and obround slots 5/16" x 1 5/16"

Electrical: Ballast is electronic, high power factor, thermally protected class P, sound rated A, with less than 20% total harmonic distortion. The minimum number of ballasts will be used unless otherwise specified.

Mounting: Standard Installation is an adjustable self-locking aircraft cable assembly 48" x 3/32" in diameter with 5" canopy. One 16/4 SJT straight 54" cord is provided per power feed. Standard pendants are available in 24" lengths. See Accessories for additional mounting.

Finish: Fixture housing and steel components are finished in baked white enamel applied over a five-stage pretreatment process.

Lamps: Fixtures are provided for use with one, two or three 32 watt T8 lamps or 54 watt T5 HO lamps. (Supplied by Others)

Certification: Luminaires are U. L. Listed, C. S. A. certified and are Union Made in the United States of America I.B.E.W.

ORDERING GUIDE

MODEL NO.	DIRECTION	SHIELDING	NO. OF LAMPS	LAMPS	MOUNTING	LENGTH	FINISH	VOLTAGE	OPTIONS
AD-FOB	I								
AD-FOB	I =Indirect Optional D/I	1 =Solid Standard 15 =Gill Slots 17 =Rectangular Slots 18 =3/8" Continuous Staggered Holes	1 2 3	17T8 25T8 32T8 14T5 21T5 28T5 24T5 HO 39T5 HO 54T5 HO O =Other Specify	AC = Cable PD = Pendant See Accessories	2 3 4 6 8 for other, please enter row length (eg. 48=48ft)	W = White CC = Custom Color	120v 277v	See Options Below

Example: **AD FOB-I-1-232T8-AC-4-W-120V**

AD FOB indirect luminaire with two 32watt T8 lamps with two 48 inch air craft cable and power feed four foot fixture finished in baked white enamel 120V electronic ballast less than 20% total harmonic distortion.

OPTIONS

E10=	Electronic ballast, high power factor, thermally protected class P, sound rated A, < 10% total harmonic distortion
DIM=	Dimming Ballast
EPC=	Emergency Battery Pack
EMC=	Emergency Circuit
TCW=	Two Circuit Wiring
TDW=	Tandem Wiring
QCW=	Quick Connect Wiring
OTH=	See Accessories for other options available

LINEAR SECTIONS AND SUSPENSION LOCATION

Technical drawing of a window assembly showing two views: a side elevation and a top plan view.

Side Elevation View (Top):

- Height: 15 1/16"
- Width: 8'-3 3/8" (8'-1 1/2")

Top Plan View (Bottom):

- Width: 20'-4 7/8"
- Height: 15 1/16"
- Section Dimensions: 12'-0 3/4" (central section), 4'-3 3/8" (4'-1 1/2") (side sections)

Corners and fixture extensions are custom fabricated to precise dimensions. Please indicate the specific requirements on the layout

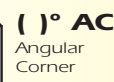

For any angular corner, ()° must be specified and dimensions must be included on the layout

For any pattern, a layout must accompany the order.

INSTALLATION PREPARATION

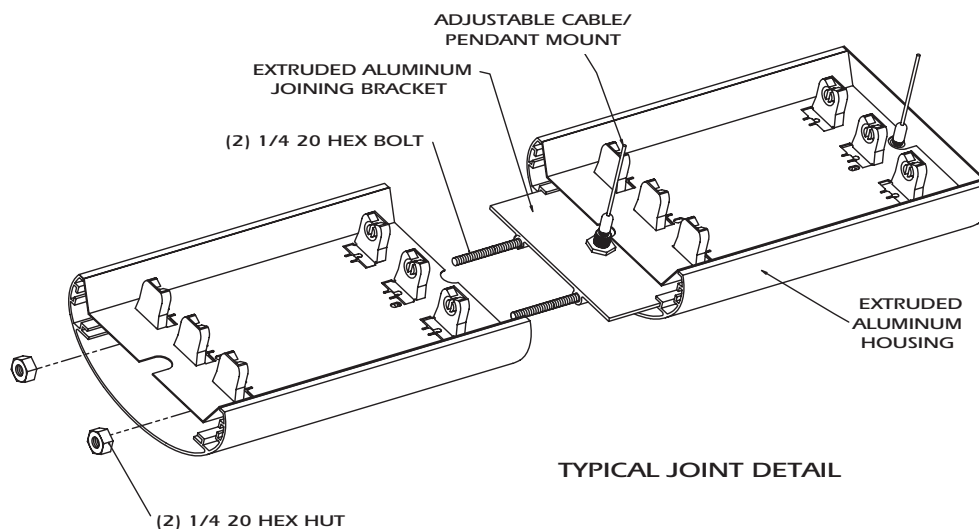

15



17

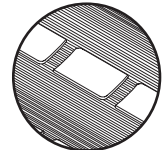

18

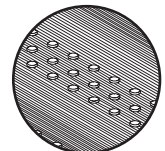

PHOTOMETRY

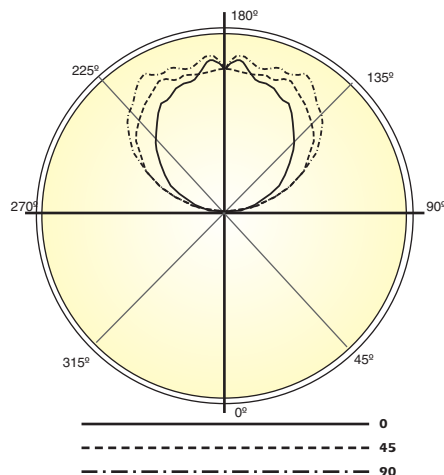

Vert. Angle	0	22.5	45	67.5	90
90	10.1	18.1	33.5	38.5	49.2
95	130	168	174	188	178
100	299	379	375	373	394
105	455	595	598	612	587
110	596	766	828	825	830
115	760	900	1078	1088	1050
120	876	1062	1241	1321	1303
125	1017	1182	1380	1473	1499
130	1144	1295	1524	1612	1658
135	1293	1419	1618	1747	1798
140	1391	1537	1712	1860	1882
145	1536	1619	1787	1971	2017
150	1664	1752	1874	2030	2100
155	1680	1770	1919	1982	1997
160	1772	1784	1867	1958	2034
165	1773	1809	1870	1932	1957
170	1879	1875	1855	1876	2002
175	2018	1926	1884	1873	2072
180	1890	1890	1890	1890	1890

	.8			.7			.5			.3			.1			0		
pw	.7	.5	.3	.1	.7	.5	.3	.1	.5	.3	.1	.5	.3	.1	.5	.3	.1	0
RCR																		0
0	75	75	75	75	64	64	64	64	44	44	44	25	25	25	8	8	8	0
1	68	65	62	60	58	56	53	51	38	37	35	22	21	20	7	6	6	0
2	62	57	52	49	53	48	45	42	33	31	29	19	18	17	6	5	5	0
3	56	50	44	40	48	42	38	35	29	26	24	17	15	14	5	5	4	0
4	51	44	38	34	44	37	33	29	26	23	20	15	13	12	4	4	4	0
5	47	39	33	28	40	33	28	25	23	20	17	13	11	10	4	3	3	0
6	43	34	28	24	36	29	25	21	20	17	15	11	10	9	3	3	2	0
7	40	31	25	21	34	26	21	18	18	15	13	10	9	7	3	2	2	0
8	36	28	22	18	31	24	19	16	16	13	11	9	8	6	3	2	2	0
9	34	25	19	16	29	21	17	14	15	12	10	8	7	5	2	2	1	0
10	31	22	17	14	27	19	15	12	13	10	8	8	6	5	2	2	1	0

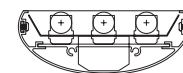

Total Luminaire Optical Efficiency = 79.3%