

PRODUCT APPLICATION

DriftCorner® is a simple solution for accommodating lateral drift at the corner of a wall. By positioning 2.625" horizontal slots vertically every 12" on a right angle 6.25"x6.25" stud and including pre-installed step bushings, up to 2" of lateral drift at corners can now be accommodated. Manufactured from mill-certified steel coated G-90, DriftCorner® may be utilized in either infill or bypass conditions.

Use DriftCorner® in conjunction with the DriftClip® or DriftTrak® series for a complete solution to vertical deflection and lateral movement of the structure. Contact TSN's Technical Services Team at (888) 474-4876 for design recommendations.

MATERIAL COMPOSITION

ASTM A653/A653M, Grade 33 (230), 33ksi (230MPa) minimum yield strength, 45ksi (310MPa) minimum tensile strength, G-90 (Z275) hot-dipped galvanized coating. With a standard thickness of 33mil (20ga), DriftCorner® is available in 12' lengths.

DRIFTCORNER® VALUE

- ◆ Prevents wall separation or collision at building corners during seismic events
- ◆ Accommodates orthogonal building drift at corner zones
- ◆ Step bushings are all pre-installed
- ◆ May be used with a variety of common sheathing components

QUANTITY / ORDER INFORMATION

Designation	Lbs/Piece	Qty/Skid (Pieces)	Qty/Skid (Feet)	Lbs/Skid
DriftCorner®	20.7	25	300	518

IMPORTANT CONSIDERATIONS

Attachment of DriftCorner® is made with #8 self-drilling screws. If using gypsum board sheathing, place 1.5" x 9" x 43mil (18ga) angle behind the sheathing on each side of the DriftCorner® to allow for proper screw purchase. TSN will provide the backing angle with DriftCorner® if requested.

Shown below are two detailed examples of DriftCorner® application. More details are available for download at www.steelnetwork.com, including those with the backing angle and with other drift products.

DriftCorner® at slab bypass:

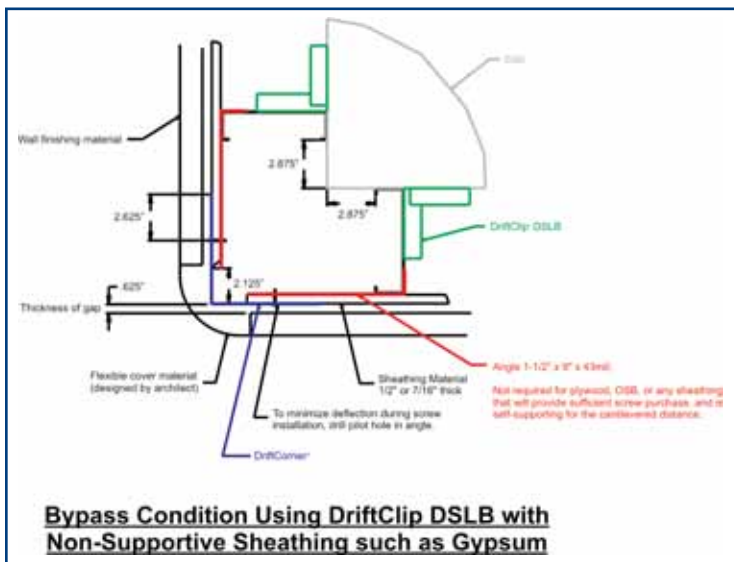

DriftCorner® at infill framing:

