



S8_SY_EN - 27.11.2009 - www.vs-furniture.com

SYSTEM INFORMATION

Serie 80000

Cupboard programme based on the DIN 18000 Euro design grid.

Construction: The body is either glued together or capable of being knocked-down and can be combined with other cupboards to form walls.

Body is of melamine-resin laminated LIGNOpal chipboard with glued-on (KU) plastic or (BU) beech edges. Some bodies have glued structural shelves and partitions (in the middle or displaced) to divide the body vertically and horizontally. Rows of holes or a perforated aluminium section (25 mm spacing) for adjustable shelves. Body with concealed adjustable feet and optionally with a plinth of solid beech or steel and with removable back panel.

Fronts are either open (shelves) or fitted with wing, sliding or glass doors as well as tambours or drawers.

Cylinder locks either keyed alike.

Bow handles of steel, wood or plastic as well as flush handles of plastic and knobs of steel.

Features: Optional panels, top covers, end and/or plinth panels as well as wall and ceiling closers.

Internal fittings: Adjustable shelves or wardrobes. Suspension files, drawers, "English drawers" and many others storage and filing accessories for special cupboards.

Following materials are available: Front LIGNOpal = L1,4,6,F1; Carcass/bases LIGNOpal = L1,4,6; Cover plate LIGNOpal = L1,4,6.

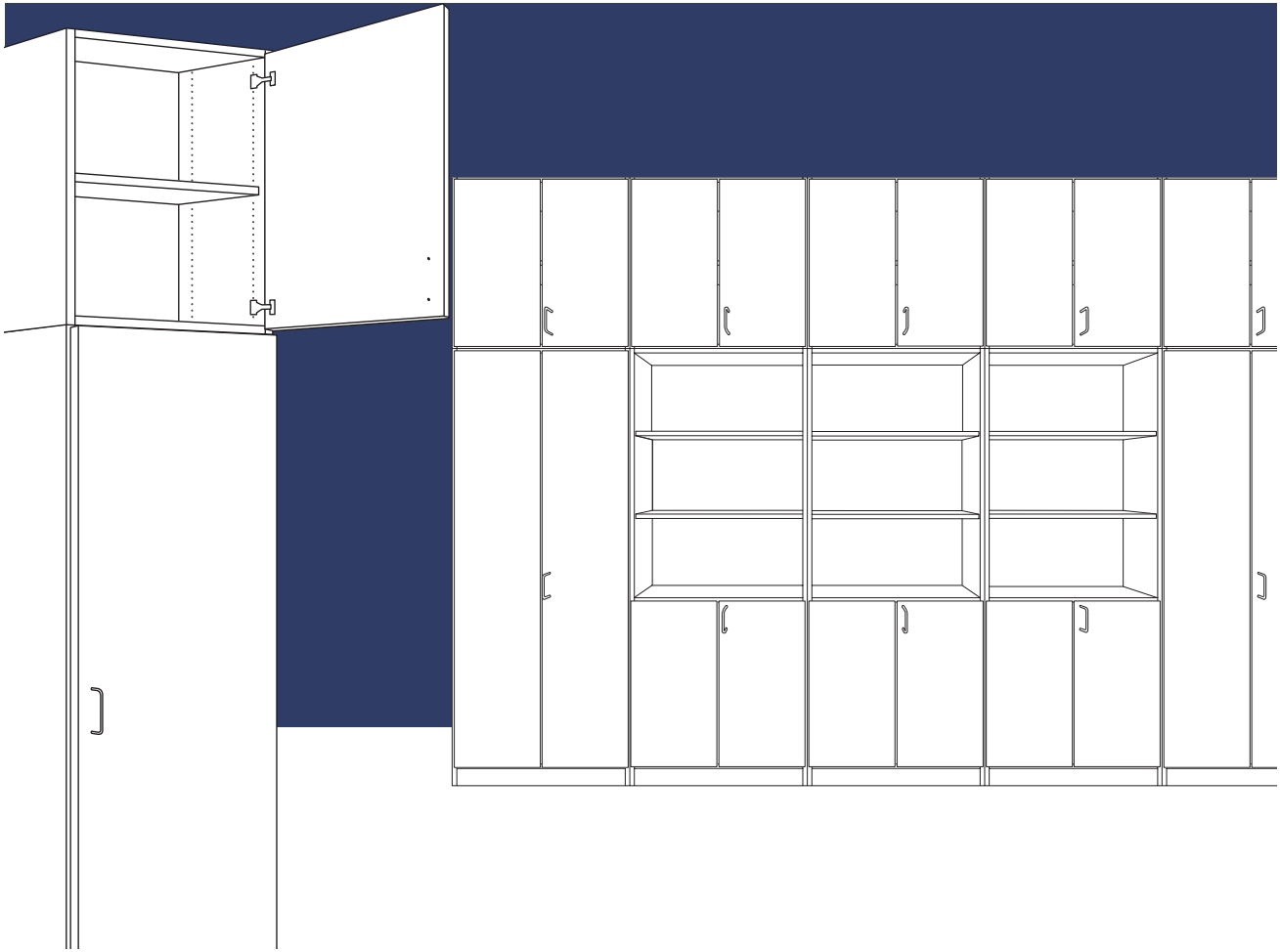

S8-AuffTuer_TY_EN - 27.11.2009 - www.vs-furniture.com

PRODUCT INFORMATION

Serie 80000

Add-on cupboard with single and double wing door. 2 OH.

Construction: The body is either glued together or capable of being knocked-down and can be combined with other cupboards to form walls.

Body is of melamine-resin laminated LIGNOpal chipboard with glued-on (KU) plastic or (BU) beech edges. Some cupboards have glued partition as well as rows of holes or a perforated aluminium section. With removable back panel.

Fronts with 1 double wing door or 2 separately-opening single wing doors in the case of a partition flush with front.

Optionally with **cylinder** or **turning knob locks**.

Bow handles of steel, wood or plastic as well as flush handles of plastic and knobs of steel.

Internal fittings: Adjustable shelves.

Following materials are available: Front LIGNOpal = L1,4,6,F1; Carcass/bases LIGNOpal = L1,4,6.

	Rows of holes: 25 mm.										
Serie 80000	d = 42	80181	80281	80381	80182	80282	80382	80184	80285	80385	80386
	d = 58	80481	80581	80681	80482	80582	80682	80484	80585	80685	80686
	w-h	40-75	50-75	60-75	40-75	50-75	60-75	80-75	100-75	120-75	
	Lock (optional)					(1)					(2)

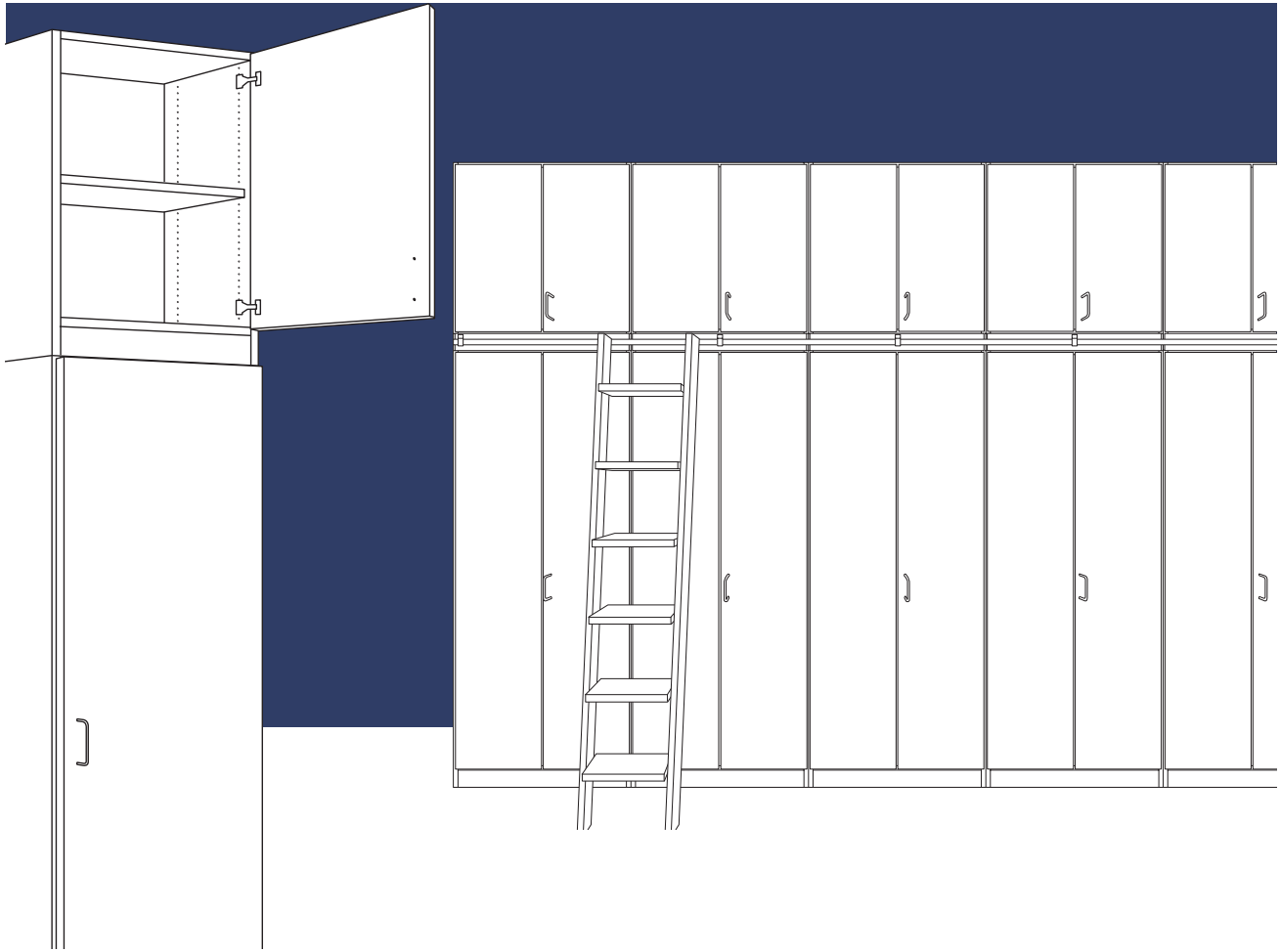

S8-AufLeifTuer_TY_EN - 27.11.2009 - www.vs-furniture.com

PRODUCT INFORMATION

Serie 80000

Add-on cupboard for ladder with single and double wing doors. 2 OH.

Construction: The body is either glued together or capable of being knocked-down and can be combined with other cupboards to form walls.

Body is of melamine-resin laminated LIGNOpal chipboard with glued-on (KU) plastic or (BU) beech edges. Some cupboards have a glued partition as well as rows of holes or a perforated aluminium section. Body has a base for attachment of a cupboard ladder. With removable back panel.

Fronts with 1 double wing door or 2 separately-opening single wing doors in the case of a partition flush with front. Optionally with **cylinder** or **turning knob locks**.

Bow handles of steel, wood or plastic as well as flush handles of plastic and knobs of steel.

Internal fittings: Adjustable shelves.

Following materials are available: Front LIGNOpal = L1,4,6,F1; Carcass/bases LIGNOpal = L1,4,6.

	Rows of holes: 25 mm.										
Serie 80000	d = 42	80191	80291	80391	80192	80292	80392	80194	80295	80395	80396
	d = 58	80491	80591	80691	80492	80592	80692	80494	80595	80695	80696
	w-h	40-84	50-84	60-84	40-84	50-84	60-84	80-84	100-84	120-84	
	Lock (optional)					(1)					(2)

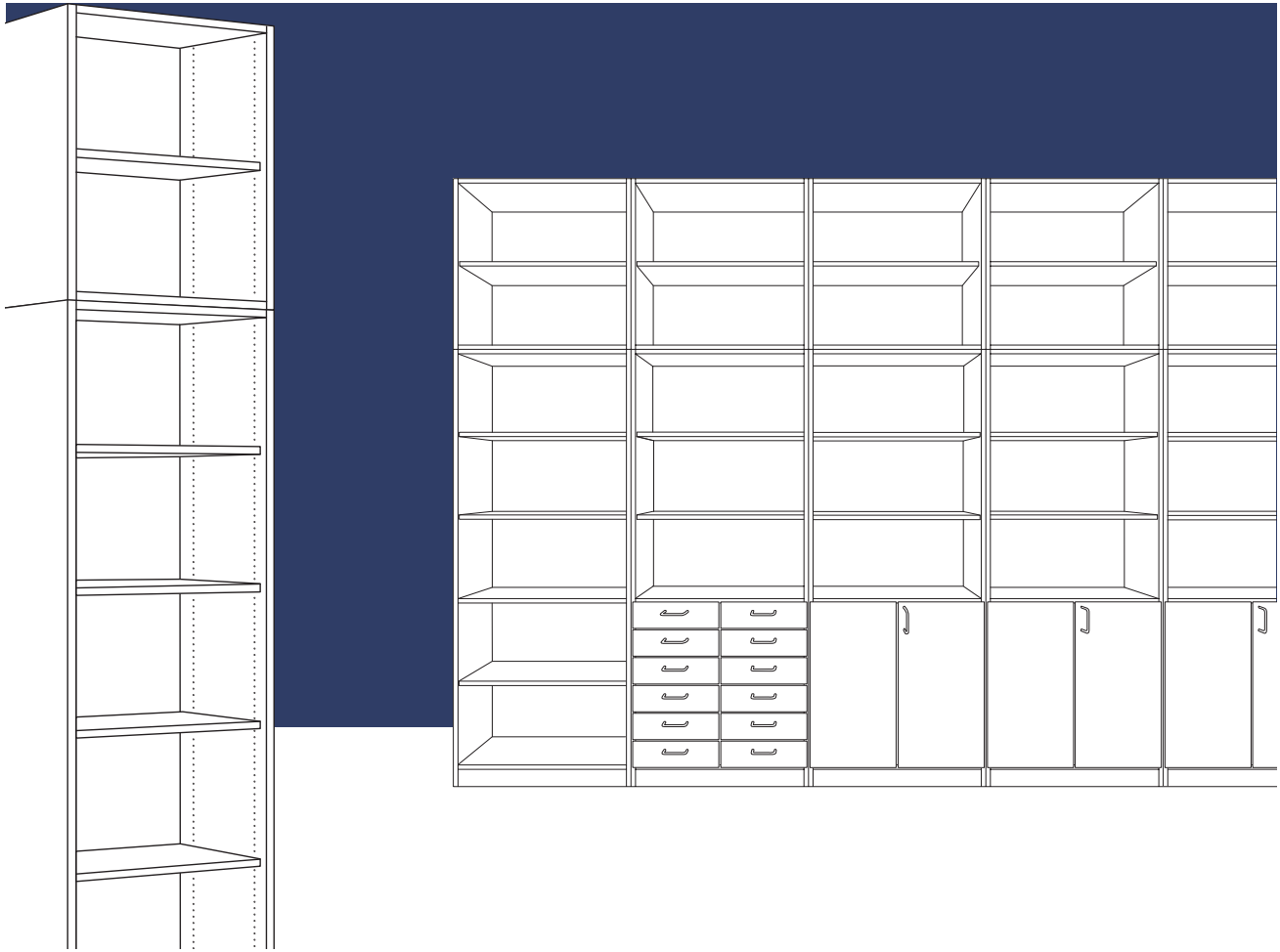

S8-AufReg_TY_EN - 27.11.2009 - www.vs-furniture.com

PRODUCT INFORMATION

Serie 80000

Add-on cupboard with open shelves. 2 OH.

Construction: The body is either glued together or capable of being knocked-down and can be combined with other cupboards to form walls.

Body is of melamine-resin laminated LIGNOpal chipboard with glued-on (KU) plastic or (BU) beech edges. Some cupboards have glued partition as well as rows of holes or a perforated aluminium section. With removable back panel.

Internal fittings: Adjustable shelves.

Following materials are available: Carcass/bases LIGNOpal = L1,4,6.

	Rows of holes: 25 mm.								
Serie 80000	d = 42	80180	80280	80380	80183	80283	80383	80284	80384
	d = 58	80480	80580	80680	80483	80583	80683	80584	80684
	w-h	40-75	50-75	60-75	80-75	100-75	120-75	100-75	120-75
	Lock (optional)								

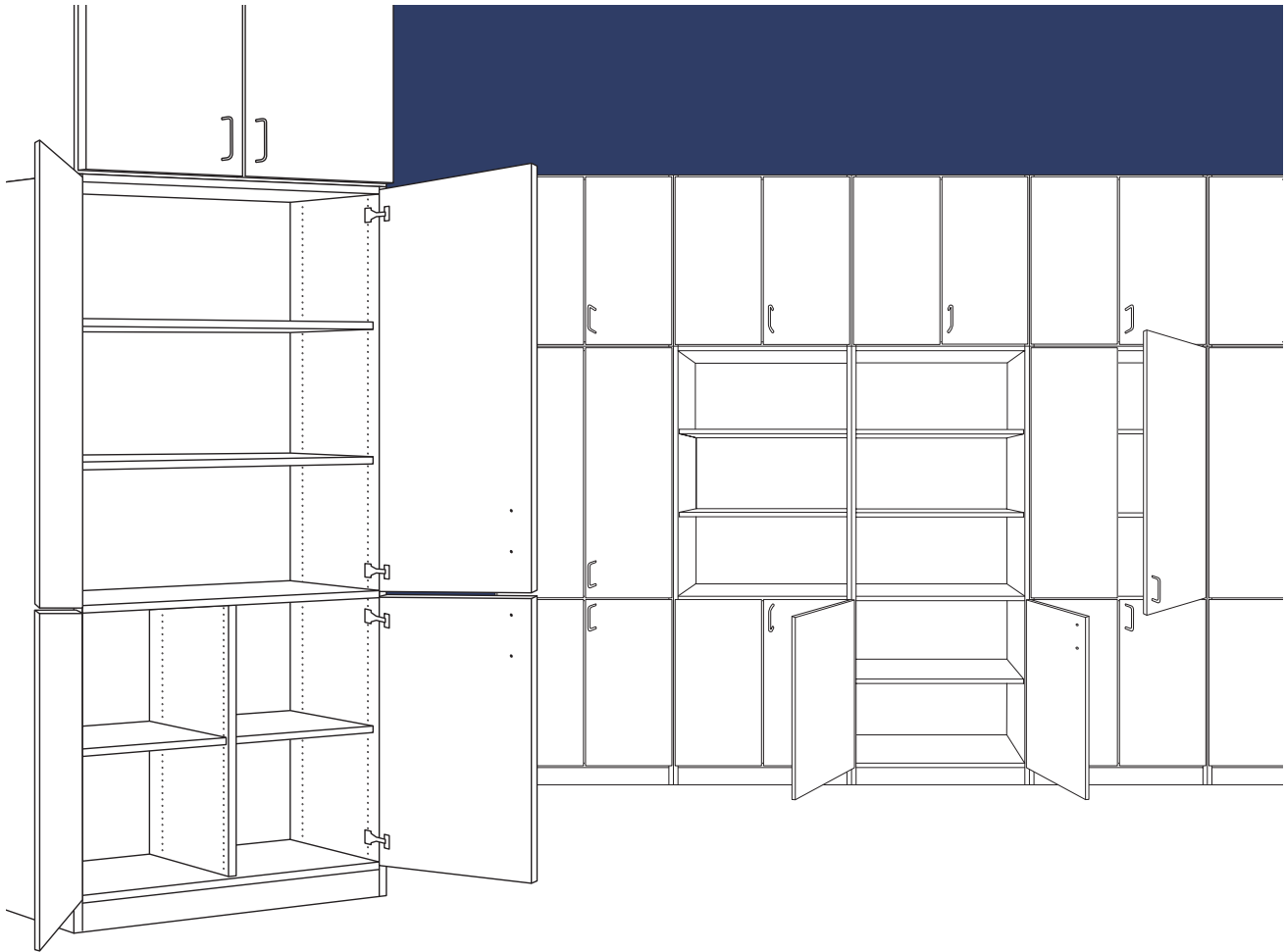

S8-DFuer2+3OH_TY_EN - 27.11.2009 - www.vs-furniture.com

PRODUCT INFORMATION

Serie 80000
Double wing doors. 2+3 OH.

Construction: The body is either glued together or capable of being knocked-down and can be combined with other cupboards to form walls.

Body is of melamine-resin laminated LIGNOpal chipboard with glued-on (KU) plastic or (BU) beech edges. The cupboards have glued structural shelves and some have partitions as well as rows of holes or a perforated aluminium section. Body with concealed adjustable feet and optionally with a plinth of solid beech or steel and with removable back panel.

Fronts with 1 or 2 double wing doors.

Optionally with **cylinder** or **turning knob locks**.

Bow handles of steel, wood or plastic as well as flush handles of plastic and knobs of steel.

Internal fittings: Adjustable shelves.

Following materials are available: Front LIGNOpal = L1,4,6,F1; Carcass/bases LIGNOpal = L1,4,6.

	Rows of holes: 25 mm.							
Serie 80000	d = 42		80116	80117	80216	80319	80217	80320
	d = 58		80416	80417	80516	80619	80517	80620
	w-h		80-197		100-197	120-197	100-197	120-197
	Lock (optional)		(1)	(2)	(1)		(2)	



S8-DFuer20H_TY_EN - 27.11.2009 - www.vs-furniture.com

PRODUCT INFORMATION

Serie 80000

Low cupboard with single and double wing door. 2 OH.

Construction: The body is either glued together or capable of being knocked-down and can be combined with other cupboards to form walls.

Body is of melamine-resin laminated LIGNOpal chipboard with glued-on (KU) plastic or (BU) beech edges. Some cupboards have a glued partition as well as rows of holes or a perforated aluminium section. Body with concealed adjustable feet and optionally with a plinth of solid beech or steel and with removable back panel.

Fronts with 1 double wing door or 2 separately-opening single wing doors in the case of a partition flush with front. Optionally with **cylinder** or **turning knob locks**.

Bow handles of steel, wood or plastic as well as flush handles of plastic and knobs of steel.

Internal fittings: Adjustable shelves.

Following materials are available: Front LIGNOpal = L1,4,6,F1; Carcass/bases LIGNOpal = L1,4,6.

	Rows of holes: 25 mm.							
Serie 80000	d = 42	80114	80214	80314	80215	80315	80316	
	d = 58	80414	80514	80614	80515	80615	80616	
	w-h	80-84,5	100-84,5	120-84,5	100-84,5	120-84,5	120-84,5	
	Lock (optional)		(1)		(2)		(1)	



S8-DFuer4+2OH_TY_EN - 27.11.2009 - www.vs-furniture.com

PRODUCT INFORMATION

Serie 80000
Double wing doors. 4+2 OH.

Construction: The body is capable of being knocked-down and can be combined with other cupboards to form walls.
Body is of melamine-resin laminated LIGNOpal chipboard with glued-on (KU) plastic or (BU) beech edges. The cupboards have glued structural shelves, some have partitions as well as rows of holes or a perforated aluminium section. Body with concealed adjustable feet and optionally with a plinth of solid beech or steel and with removable back panel.

Fronts with 2 double wing doors.

Optionally with **cylinder** or **turning knob locks**.

Bow handles of steel, wood or plastic as well as flush handles of plastic and knobs of steel.

Internal fittings: Adjustable shelves.

Following materials are available: Front LIGNOpal = L1,4,6,F1; Carcass/bases LIGNOpal = L1,4,6.

	Rows of holes: 25 mm.				
Serie 80000	d = 42		80724	80732	80736
	d = 58		80774	80782	80786
	w-h		80-234,5	100-234,5	120-234,5
	Lock (optional)		(2)		



S8-DFuer6OH_TY_EN - 27.11.2009 - www.vs-furniture.com

PRODUCT INFORMATION

Serie 80000

Cupboard with double-wing door. 6 OH.

Construction: The body is capable of being knocked-down and can be combined with other cupboards to form walls.

Body is of melamine-resin laminated LIGNOpal chipboard with glued-on (KU) plastic or (BU) beech edges as well as rows of holes or a perforated aluminium section for adjustable shelves. Body with concealed adjustable feet and optionally with a plinth of solid beech or steel and with removable back panel.

Fronts with one double wing door.

Optionally with **cylinder** or **turning knob locks**.

Bow handles of steel, wood or plastic as well as flush handles of plastic and knobs of steel.

Internal fittings: Adjustable shelves.

Following materials are available: Front LIGNOpal = L1,4,6,F1; Carcass/bases LIGNOpal = L1,4,6.

	Rows of holes: 25 mm.				
Serie 80000	d = 42 d = 58 w-h Lock (optional)				



S8-F-DFGlas50H_TY_EN - 27.11.2009 - www.vs-furniture.com

PRODUCT INFORMATION

Serie 80000

Single and double-wing door with glass insert. 5 OH.

Construction: The body is either glued together or capable of being knocked-down and can be combined with other cupboards to form walls.

Body is of melamine-resin laminated LIGNOpal chipboard with glued-on (KU) plastic or (BU) beech edges. Some cupboards have glued structural shelves as well as rows of holes or a perforated aluminium section for adjustable shelves. Body with concealed adjustable feet and optionally with a plinth of solid beech or steel and with removable back panel.

Fronts with one double wing door or when the partition is flush with the body, 2 separately-opening single wing doors, each with safety glass insert.

Optionally with **cylinder** or **turning knob locks**.

Bow handles of steel, wood or plastic as well as flush handles of plastic and knobs of steel.

Internal fittings: Adjustable shelves.

Following materials are available: Front LIGNOpal = L1,4,6,F1; Carcass/bases LIGNOpal = L1,4,6.

	Rows of holes: 25 mm.					
Serie 80000	d = 42	80360	80361	80363	80362	80364
	d = 58	80660	80661	80663	80662	80664
	w-h			120-197		
	Lock (optional)	(2)	(1)		(2)	



S8-F-DFuer2+4OH_TY_EN - 27.11.2009 - www.vs-furniture.com

PRODUCT INFORMATION

Serie 80000

Wing and double wing doors. 2+4 / 2+3 OH.

Construction: The body is either glued together or capable of being knocked-down and can be combined with other cupboards to form walls.

Body is of melamine-resin laminated LIGNOpal chipboard with glued-on (KU) plastic or (BU) beech edges. The cupboards have glued structural shelves and some have partitions as well as rows of holes or a perforated aluminium section. Body with concealed adjustable feet and optionally with a plinth of solid beech or steel and with removable back panel.

Fronts with 2 separately-opening single wing doors or 2 double wing doors.

Optionally with **cylinder** or **turning knob locks**.

Bow handles of steel, wood or plastic as well as flush handles of plastic and knobs of steel.

Internal fittings: Adjustable shelves.

Following materials are available: Front LIGNOpal = L1,4,6,F1; Carcass/bases LIGNOpal = L1,4,6.

	Rows of holes: 25 mm.									
Serie 80000	d = 42	80703	80710	80717	80704	80711	80718	80723	80731	80735
	d = 58	80753	80760	80767	80754	80761	80768	80773	80781	80785
	w-h	40-234,5	50-234,5	60-234,5	40-234,5	50-234,5	60-234,5	80-234,5	100-234,5	120-234,5
	Lock (optional)					(2)				

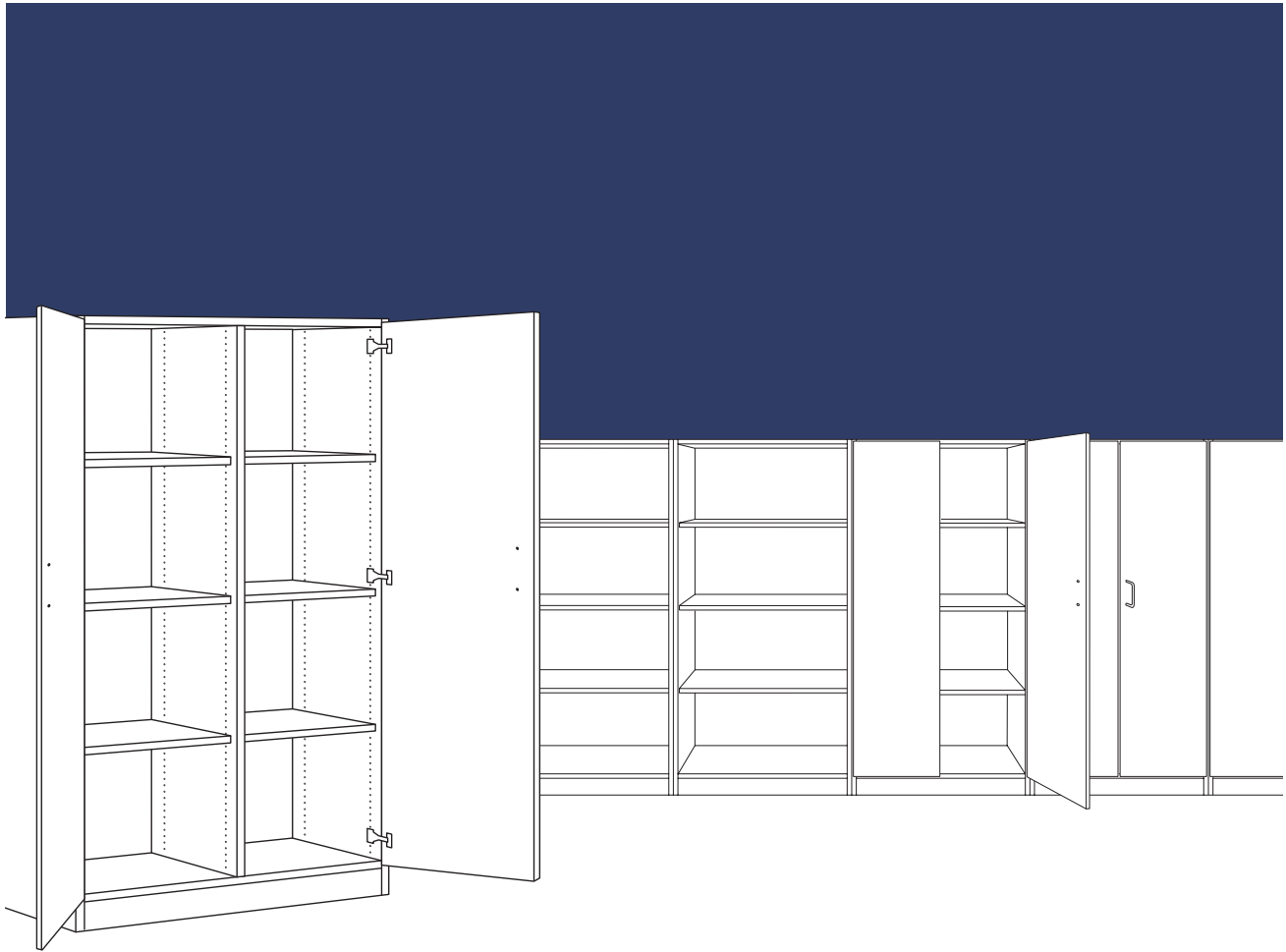

S8-F-DFuer40H_TY_EN - 27.11.2009 - www.vs-furniture.com

PRODUCT INFORMATION

Serie 80000

Cupboard with single and double-wing door. 4 OH.

Construction: The body is either glued together or capable of being knocked-down and can be combined with other cupboards to form walls.

Body is of melamine-resin laminated LIGNOpal chipboard with glued-on (KU) plastic or (BU) beech edges. Some cupboards have a glued partition as well as rows of holes or a perforated aluminium section for adjustable shelves. Body with concealed adjustable feet and optionally with a plinth of solid beech or steel and with removable back panel.

Fronts with one double wing door or when the partition is flush with the body, 2 separately-opening single wing doors. Optionally with **cylinder** or **turning knob locks**.

Bow handles of steel, wood or plastic as well as flush handles of plastic and knobs of steel.

Internal fittings: Adjustable shelves.

Following materials are available: Front LIGNOpal = L1,4,6,F1; Carcass/bases LIGNOpal = L1,4,6.

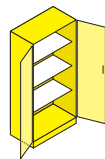
	Rows of holes: 25 mm.			
Serie 80000	d = 42		80115	80317
	d = 58		80415	80617
	w-h		80-159,5	120-159,5
	Lock (optional)		(1)	(2)
				80318
				80618
				120-159,5

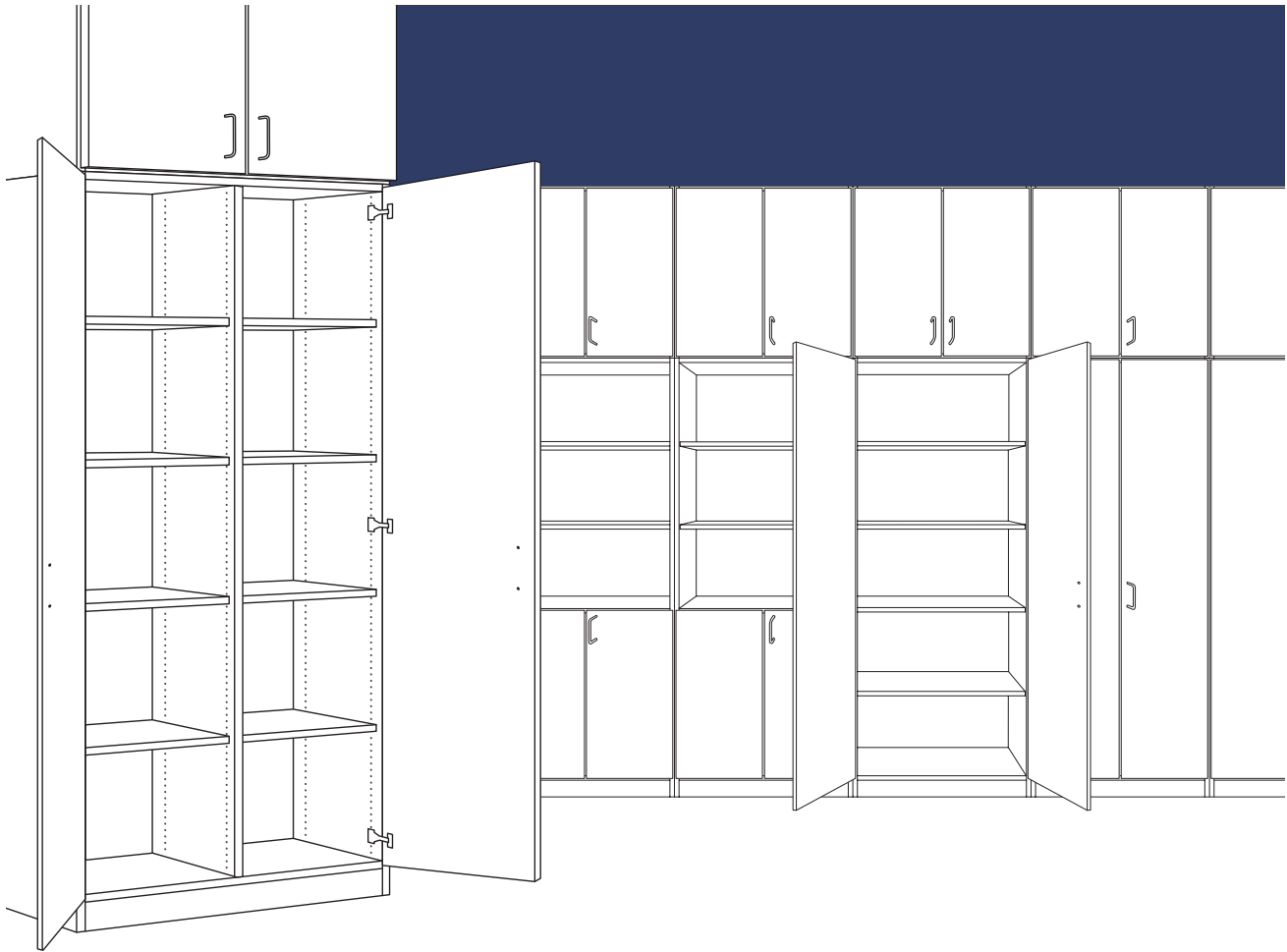

S8-F-DFuer50H_TY_EN - 27.11.2009 - www.vs-furniture.com

PRODUCT INFORMATION

Serie 80000

Cupboard with single and double-wing door. 5 OH.

Construction: The body is either glued together or capable of being knocked-down and can be combined with other cupboards to form walls.

Body is of melamine-resin laminated LIGNOpal chipboard with glued-on (KU) plastic or (BU) beech edges. Some cupboards have a glued partition as well as rows of holes or a perforated aluminium section for adjustable shelves. Body with concealed adjustable feet and optionally with a plinth of solid beech or steel and with removable back panel.

Fronts with one double wing door or when the partition is flush with the body, 2 separately-opening single wing doors. Optionally with **cylinder** or **turning knob locks**.

Bow handles of steel, wood or plastic as well as flush handles of plastic and knobs of steel.

Internal fittings: Adjustable shelves.

Following materials are available: Front LIGNOpal = L1,4,6,F1; Carcass/bases LIGNOpal = L1,4,6.

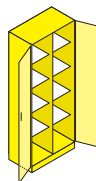
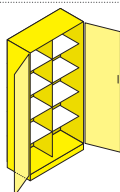
	Rows of holes: 25 mm.								
Serie 80000	d = 42	80118	80218	80321	80119	80219	80322	80220	80323
	d = 58	80418	80518	80621	80419	80519	80622	80520	80623
	w-h	80-197	100-197	120-197	80-197	100-197	120-197	100-197	120-197
	Lock (optional)		(1)			(2)		(1)	

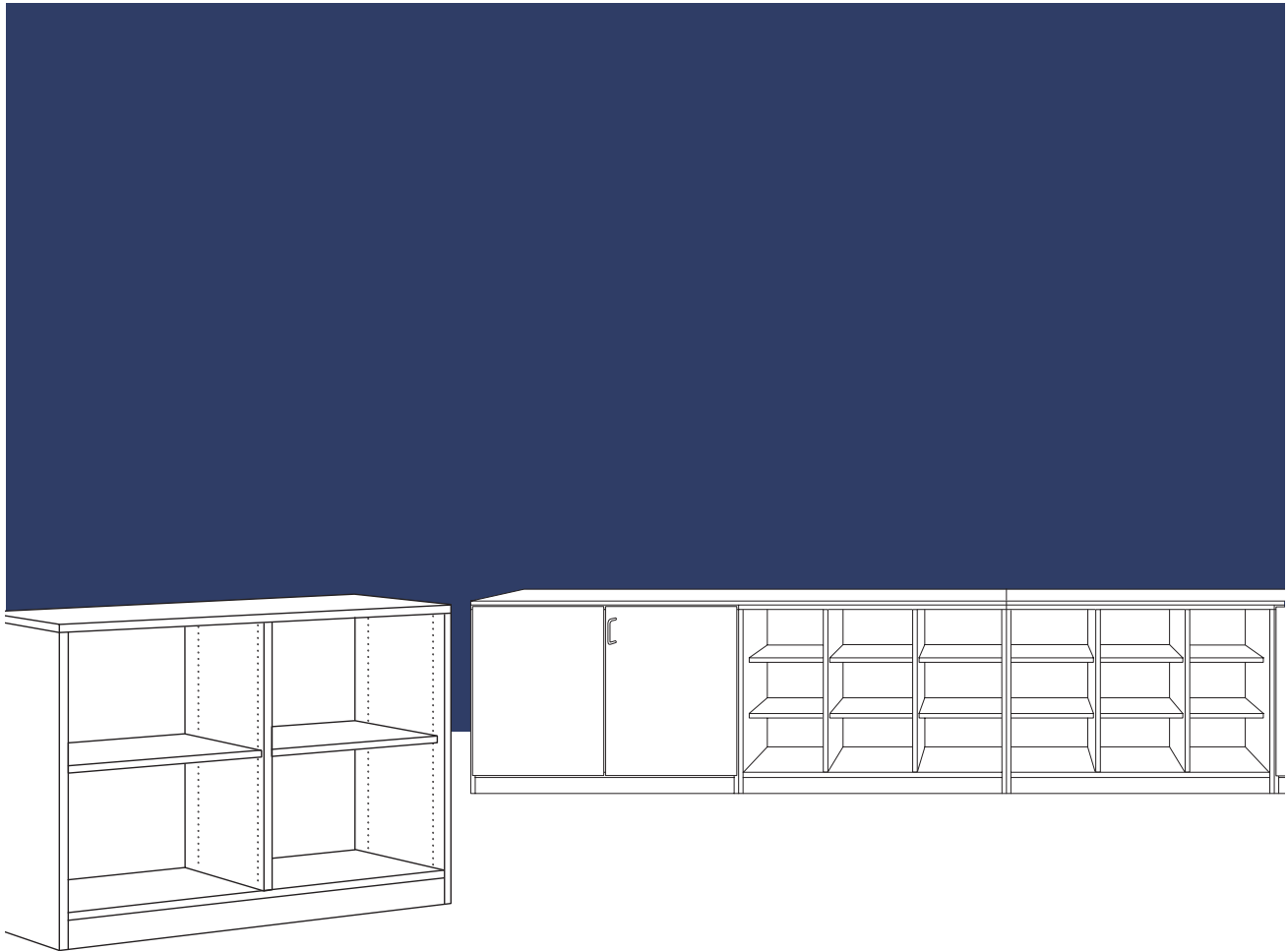

S8-Fach2OH_TY_EN - 27.11.2009 - www.vs-furniture.com

PRODUCT INFORMATION

Serie 80000

Low cupboard with compartments. 2 OH.

Construction: The body is either glued together or capable of being knocked-down and can be combined with other cupboards to form walls.

Body is of melamine-resin laminated LIGNOpal chipboard with glued-on (KU) plastic or (BU) beech edges. With glued partitions as well as rows of holes or a perforated aluminium section. Body with concealed adjustable feet and optionally with a plinth of solid beech or steel and with removable back panel.

Internal fittings: Adjustable shelves.

Following materials are available: Carcass/bases LIGNOpal = L1,4,6.

	Rows of holes: 25 mm.						
							
Serie 80000	d = 42		80203	80303	80304	80305	80306
	d = 58		80503	80603	80604		
	w-h		100·84,5		120·84,5		
	Lock (optional)		-		-		

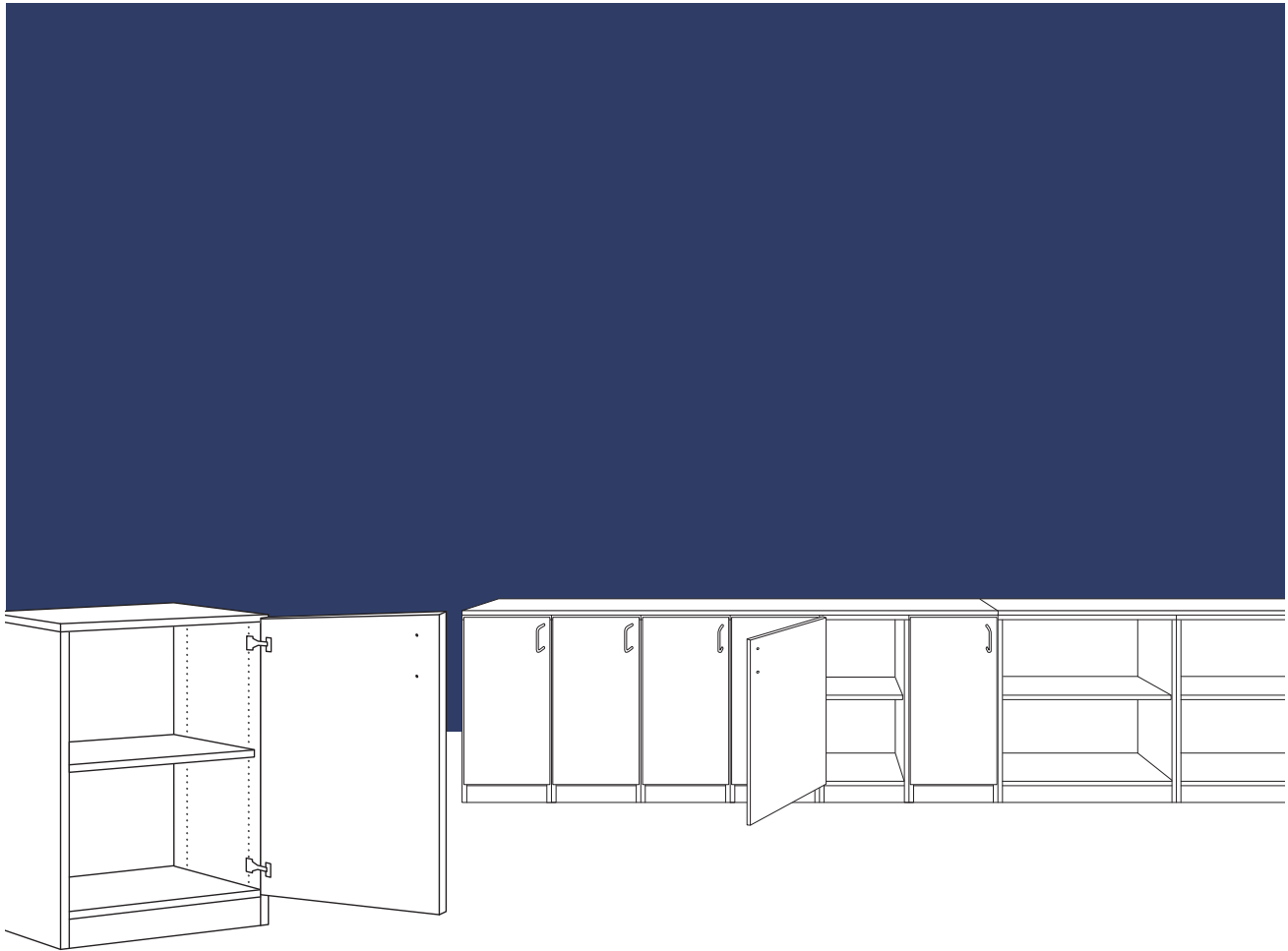

S8-FTuer20H_TY_EN - 27.11.2009 - www.vs-furniture.com

PRODUCT INFORMATION

Serie 80000

Low cupboard with wing door. 2 OH.

Construction: The body is either glued together or capable of being knocked-down and can be combined with other cupboards to form walls.

Body is of melamine-resin laminated LIGNOpal chipboard with glued-on (KU) plastic or (BU) beech edges as well as rows of holes or a perforated aluminium section. Body with concealed adjustable feet and optionally with a plinth of solid beech or steel and with removable back panel.

Fronts with 1 single wing door.

Optionally with **cylinder** or **turning knob locks**.

Bow handles of steel, wood or plastic as well as flush handles of plastic and knobs of steel.

Internal fittings: Adjustable shelves.

Following materials are available: Front LIGNOpal = L1,4,6,F1; Carcass/bases LIGNOpal = L1,4,6.

	Rows of holes: 25 mm.							
Serie 80000	d = 42		80110	80210	80310	80111	80211	80311
	d = 58		80410	80510	80610	80411	80511	80611
	w-h		40-84,5	50-84,5	60-84,5	40-84,5	50-84,5	60-84,5
	Lock (optional)							

(1)

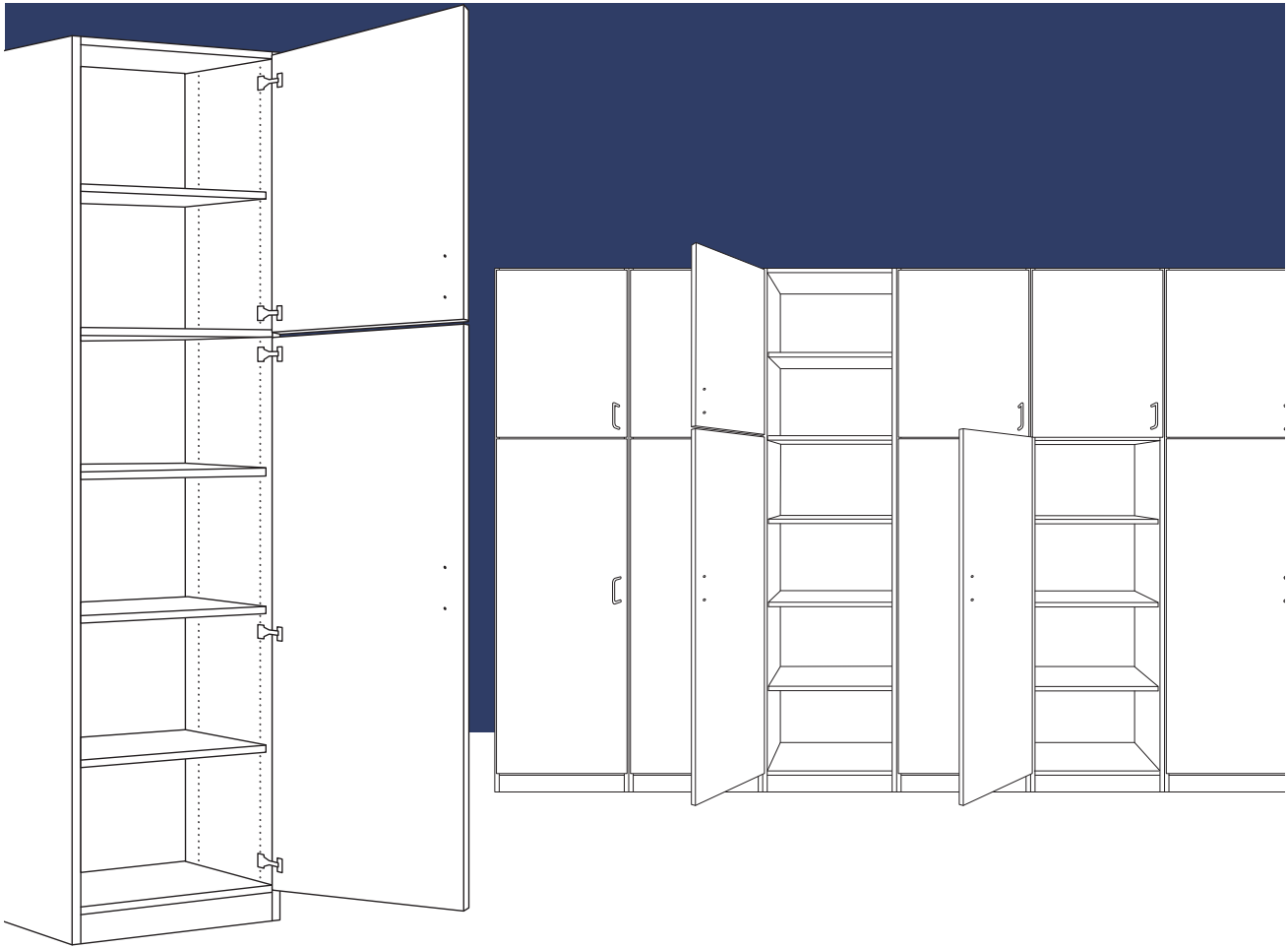

S8-FTuer4+20H_TY_EN - 27.11.2009 - www.vs-furniture.com

PRODUCT INFORMATION

Serie 80000
Wing doors. 4+2 OH.

Construction: The body is either glued together or capable of being knocked-down and can be combined with other cupboards to form walls.

Body is of melamine-resin laminated LIGNOpal chipboard with glued-on (KU) plastic or (BU) beech edges, glued structural shelves as well as rows of holes or a perforated aluminium section. Body with concealed adjustable feet and optionally with a plinth of solid beech or steel and with removable back panel.

Fronts with 2 separately-opening single wing doors.

Optionally with **cylinder** or **turning knob locks**.

Bow handles of steel, wood or plastic as well as flush handles of plastic and knobs of steel.

Internal fittings: Adjustable shelves.

Following materials are available: Front LIGNOpal = L1,4,6,F1; Carcass/bases LIGNOpal = L1,4,6.

	Rows of holes: 25 mm.							
Serie 80000	d = 42		80705	80712	80719	80706	80713	80720
	d = 58		80755	80762	80769	80756	80763	80770
	w-h		40-234,5	50-234,5	60-234,5	40-234,5	50-234,5	60-234,5
	Lock (optional)		(2)	(2)	(2)	(2)	(2)	(2)

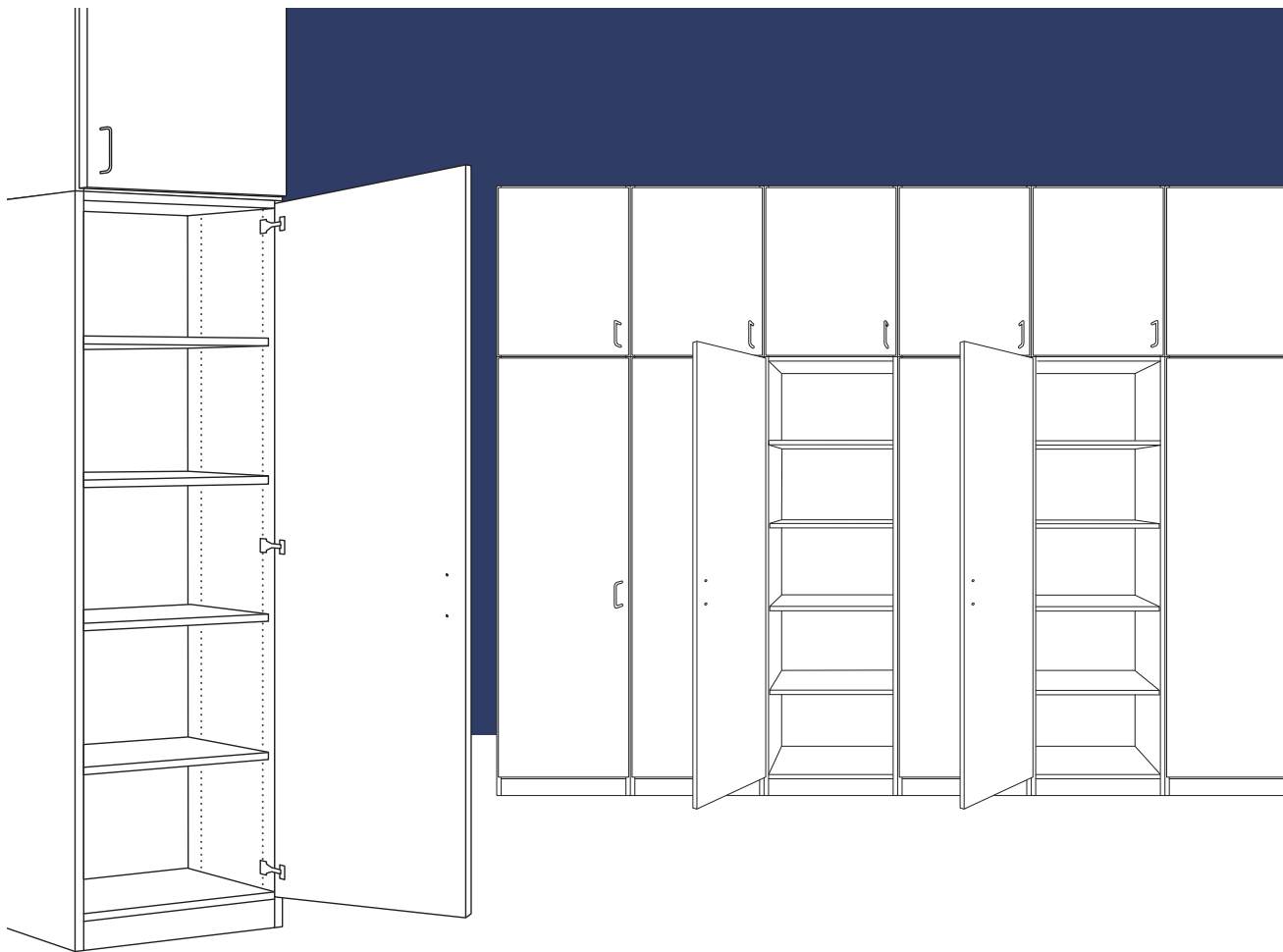

S8-FTuer50H_TY_EN - 27.11.2009 - www.vs-furniture.com

PRODUCT INFORMATION

Serie 80000
Wing door. 5 OH.

Construction: The body is either glued together or capable of being knocked-down and can be combined with other cupboards to form walls.

Body is of melamine-resin laminated LIGNOpal chipboard with glued-on (KU) plastic or (BU) beech edges as well as rows of holes or a perforated aluminium section for adjustable shelves. Body with concealed adjustable feet and optionally with a plinth of solid beech or steel and with removable back panel.

Fronts with a single wing door.

Optionally with **cylinder** or **turning knob locks**.

Bow handles of steel, wood or plastic as well as flush handles of plastic and knobs of steel.

Internal fittings: Adjustable shelves.

Following materials are available: Front LIGNOpal = L1,4,6,F1; Carcass/bases LIGNOpal = L1,4,6.

	Rows of holes: 25 mm.							
Serie 80000	d = 42		80112	80212	80312	80113	80213	80313
	d = 58		80412	80512	80612	80413	80513	80613
	w-h		40-197	50-197	60-197	40-197	50-197	60-197
	Lock (optional)		(1)	(1)	(1)	(1)	(1)	(1)



S8-FTuer60H_TY_EN - 27.11.2009 - www.vs-furniture.com

PRODUCT INFORMATION

Serie 80000
Wing door. 6 OH.

Construction: The body is capable of being knocked-down and can be combined with other cupboards to form walls.
Body is of melamine-resin laminated LIGNOpal chipboard with glued-on (KU) plastic or (BU) beech edges as well as rows of holes or a perforated aluminium section for adjustable shelves. Body with concealed adjustable feet and optionally with a plinth of solid beech or steel and with removable back panel.

Fronts with a single wing door.

Optionally with **cylinder** or **turning knob locks**.

Bow handles of steel, wood or plastic as well as flush handles of plastic and knobs of steel.

Internal fittings: Adjustable shelves.

Following materials are available: Front LIGNOpal = L1,4,6,F1; Carcass/bases LIGNOpal = L1,4,6.

	Rows of holes: 25 mm.							
Serie 80000	d = 42		80701	80708	80715	80702	80709	80716
	d = 58		80751	80758	80765	80752	80759	80766
	w-h		40-234,5	50-234,5	60-234,5	40-234,5	50-234,5	60-234,5
	Lock (optional)		(1)	(1)	(1)	(1)	(1)	(1)

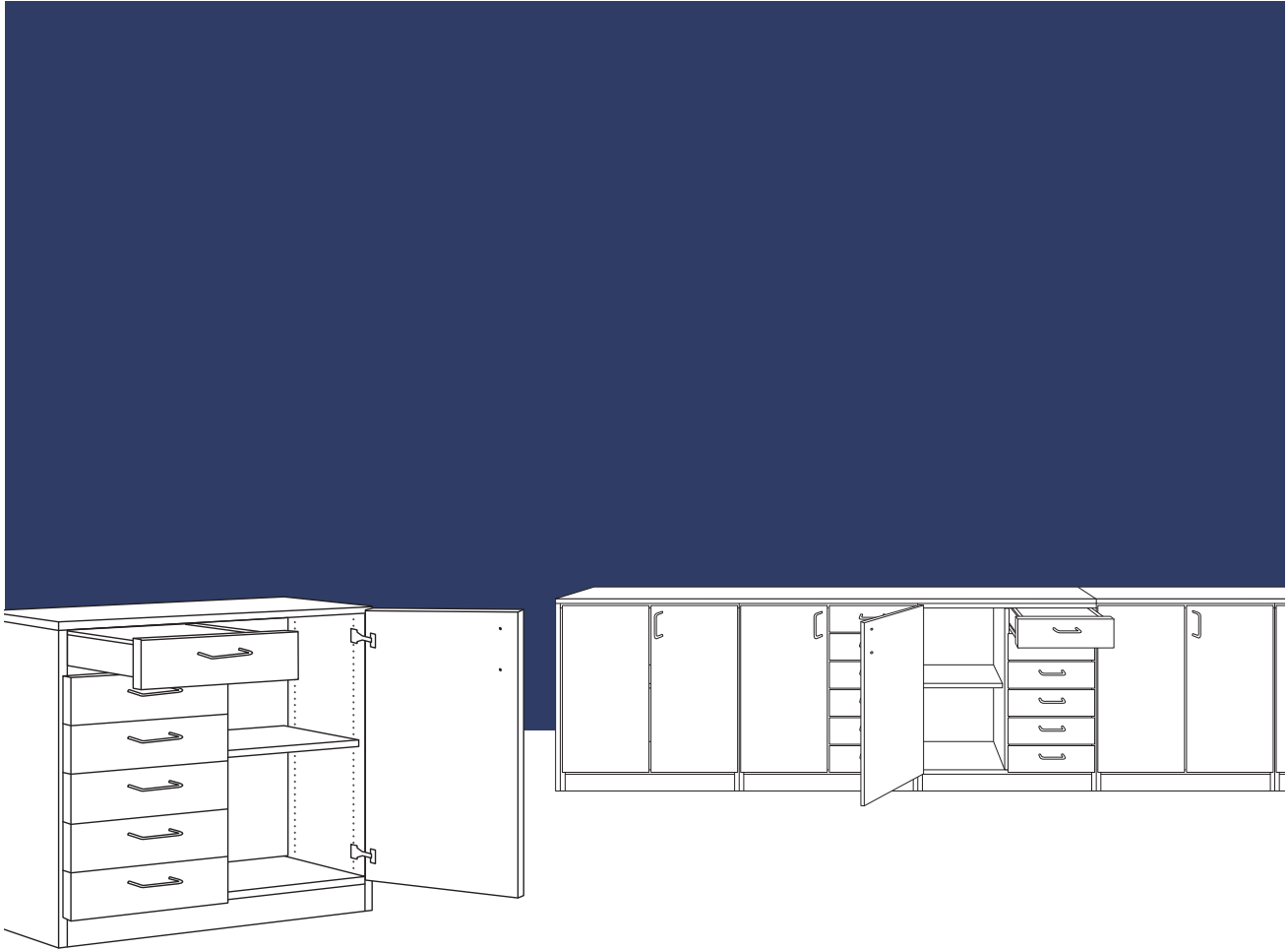

S8-FTuerSchub20H_TY_EN - 27.11.2009 - www.vs-furniture.com

PRODUCT INFORMATION

Serie 80000

Low cupboard with wing doors, drawers. 2 OH.

Construction: The body is either glued together or capable of being knocked-down and can be combined with other cupboards to form walls.

Body is of melamine-resin laminated LIGNOpal chipboard with glued-on (KU) plastic or (BU) beech edges. With glued structural shelves as well as rows of holes or a perforated aluminium section. Body with concealed adjustable feet and optionally with a plinth of solid beech or steel and with removable back panel.

Fronts with drawers and one single wing door.

Optionally with **cylinder** or **turning knob locks**.

Bow handles of steel, wood or plastic as well as flush handles of plastic and knobs of steel.

Internal fittings: Adjustable shelves.

Following materials are available: Front LIGNOpal = L1,4,6,F1; Carcass/bases LIGNOpal = L1,4,6.

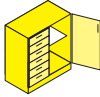
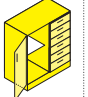
	Rows of holes: 25 mm.							
								
Serie 80000	d = 42		80131	80231	80331	80132	80232	80332
	d = 58		80431	80531	80631	80432	80532	80632
	w-h		80-84,5	100-84,5	120-84,5	80-84,5	100-84,5	120-84,5
	Lock (optional)							(2)



S8-Garderobe50H_TY_EN - 27.11.2009 - www.vs-furniture.com

PRODUCT INFORMATION

**Serie 80000
Wardrobe. 5 OH.**

Construction: The body is either glued together or capable of being knocked-down and can be combined with other cupboards to form walls.

Body is of melamine-resin laminated LIGNOpal chipboard with glued-on (KU) plastic or (BU) beech edges. With glued partition as well as rows of holes or a perforated aluminium section. Body with concealed adjustable feet and optionally with a plinth of solid beech or steel and with removable back panel.

Fronts with 1 single wing door, 1 double wing door or 2 separately-opening single wing doors in the case of a partition flush with front.

Optionally with **cylinder** or **turning knob locks**.

Bow handles of steel, wood or plastic as well as flush handles of plastic and knobs of steel.

Internal fittings: Adjustable shelves and wardrobe. Fixed hat shelf with hanging rail. Optional with dressing mirror.

Following materials are available: Front LIGNOpal = L1,4,6,F1; Carcass/bases LIGNOpal = L1,4,6.

	Rows of holes: 25 mm.											
Serie 80000	d = 42	80120	80224	80328	80121	80225	80329	80122	80221	80324	80222	80325
	d = 58	80420	80524	80628	80421	80525	80629	80422	80521	80624	80522	80625
	w-h	40-197	50-197	60-197	40-197	50-197	60-197	80-197	100-197	120-197	100-197	120-197
	Lock (optional)				(1)				(2)		(1)	(2)

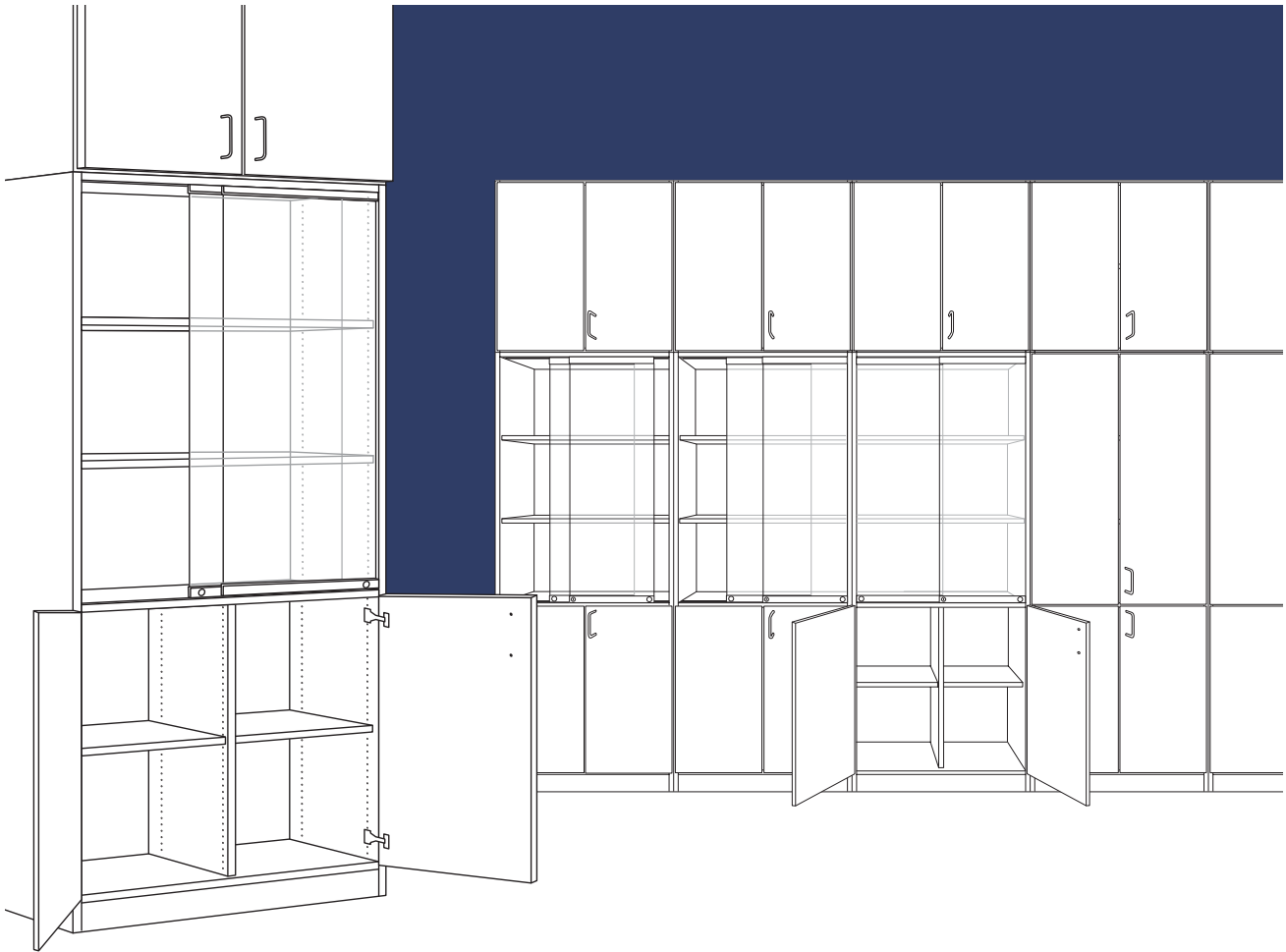

S8-GlasSchieb2+3_TY_EN - 27.11.2009 - www.vs-furniture.com

PRODUCT INFORMATION

Serie 80000
Glass sliding door. 2+3 OH.

Construction: The body is either glued together or capable of being knocked-down and can be combined with other cupboards to form walls.

Body is of melamine-resin laminated LIGNOpal chipboard with glued-on (KU) plastic or (BU) beech edges. The cupboards have glued structural shelves and partitions as well as rows of holes or a perforated aluminium section. Body with concealed adjustable feet and optionally with a plinth of solid beech or steel and with removable back panel.

Fronts with 2 glass sliding doors (at top) and 1 double wing door (at bottom).

Optionally with **cylinder** or **turning knob locks**.

Bow handles of steel, wood or plastic as well as flush handles of plastic and knobs of steel.

Internal fittings: Adjustable shelves.

Following materials are available: Front LIGNOpal = L1,4,6,F1; Carcass/bases LIGNOpal = L1,4,6.

	Rows of holes: 25 mm.				
Serie 80000	d = 42 d = 58 w-h Lock (optional)				

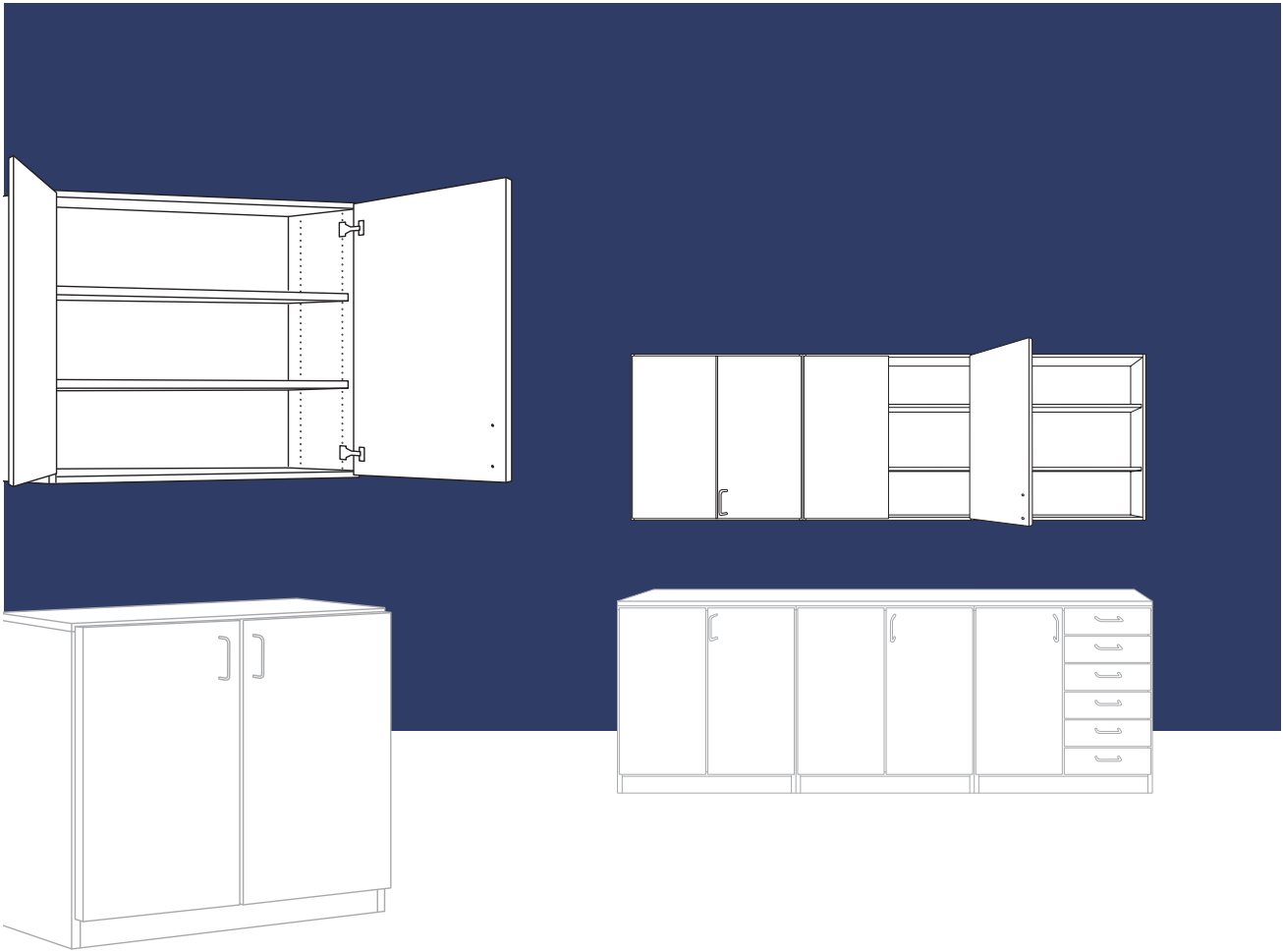

S8-Haeng_TY_EN - 27.11.2009 - www.vs-furniture.com

PRODUCT INFORMATION

Serie 80000

Hanging cupboard with open shelves or wing door. 2 OH.

Construction: The body is either glued together or capable of being knocked-down and can be combined with other cupboards to form walls.

Body is of melamine-resin laminated LIGNOpal chipboard with glued-on (KU) plastic or (BU) beech edges. Some cupboards have a glued partition as well as rows of holes or a perforated aluminium section.

Fronts with 1 double wing door or 2 separately-opening single wing doors in the case of a partition flush with front.

Optionally with **cylinder** or **turning knob locks**.

Bow handles of steel, wood or plastic as well as flush handles of plastic and knobs of steel.

Internal fittings: Adjustable shelves.

Following materials are available: Front LIGNOpal = L1,4,6,F1; Carcass/bases LIGNOpal = L1,4,6.

	Rows of holes: 25 mm.						
Serie 80000	d = 33		80820	80821	80822	80800	80801
	w-h			60-75			80-75
	Lock (optional)		-	(1)		-	(1)

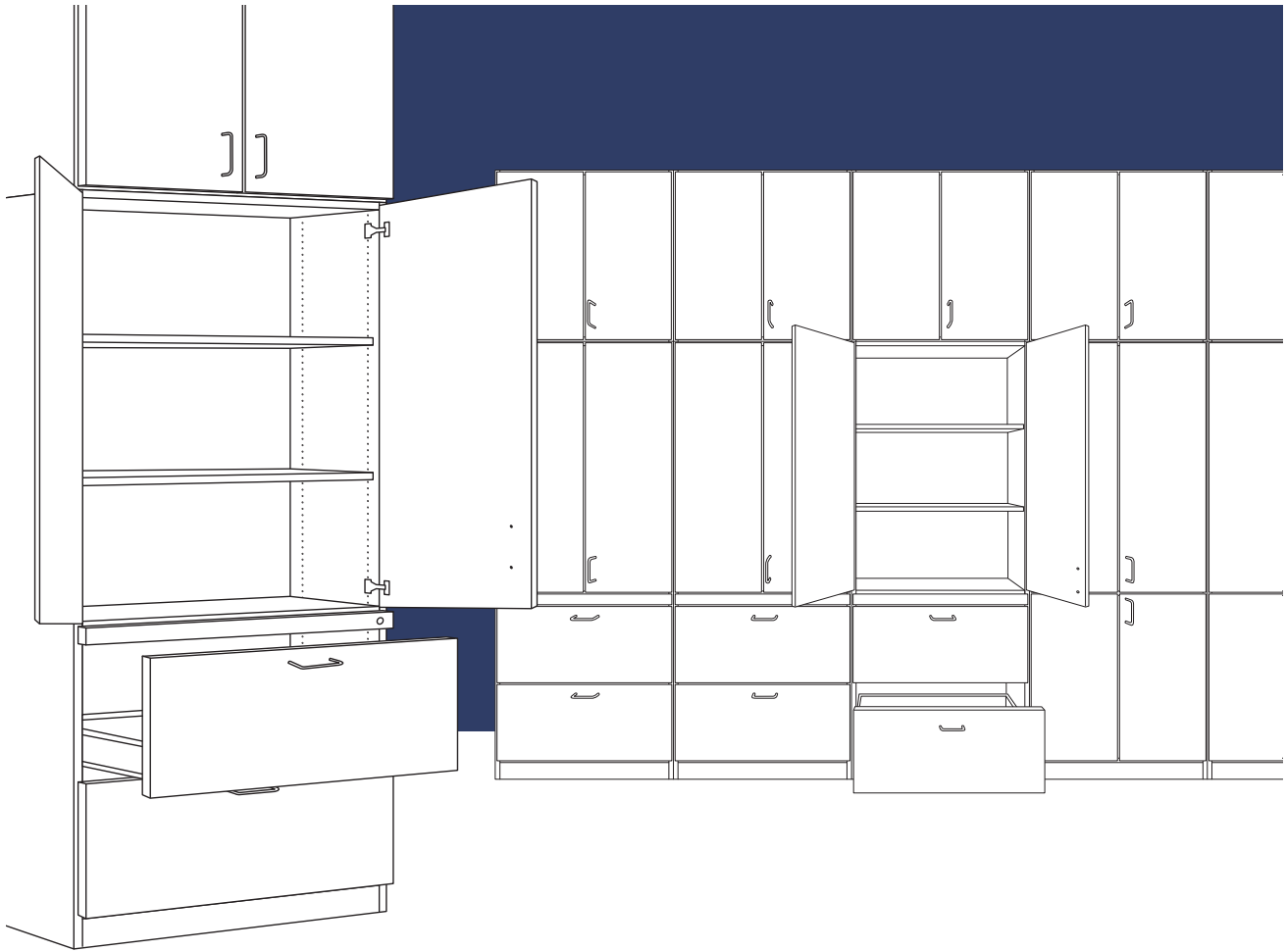

S8-HReg2+30H_TY_EN - 27.11.2009 - www.vs-furniture.com

PRODUCT INFORMATION

Serie 80000

Suspension files, wide drawer. 2+3 / 3+2 OH.

Construction: The body is either glued together or capable of being knocked-down and can be combined with other cupboards to form walls.

Body is of melamine-resin laminated LIGNOpal chipboard with glued-on (KU) plastic or (BU) beech edges. The bodies have glued structural shelves as well as rows of holes or a perforated aluminium section. Body with concealed adjustable feet and optionally with a plinth of solid beech or steel and with removable back panel.

Fronts with 1 double wing door (at top) as well as wide drawers or suspension files (at bottom).

Optionally with **cylinder** or **turning knob locks**.

Bow handles of steel, wood or plastic as well as flush handles of plastic and knobs of steel.

Internal fittings: Adjustable shelves.

Following materials are available: Front LIGNOpal = L1,4,6,F1; Carcass/bases LIGNOpal = L1,4,6.

	Rows of holes: 25 mm.					
Serie 80000	d = 42		80144	80146	80145	80147
	d = 58		80444	80446	80445	80447
	w-h			80-197		
	Lock (optional)			(2)		



S8-HReg2+40H_TY_EN - 27.11.2009 - www.vs-furniture.com

PRODUCT INFORMATION

Serie 80000

Suspension files, wide drawer. 2+4 / 3+3 OH.

Construction: The body is capable of being knocked-down and can be combined with other cupboards to form walls.

Body is of melamine-resin laminated LIGNOpal chipboard with glued-on (KU) plastic or (BU) beech edges. The cupboards have glued structural shelves as well as rows of holes or a perforated aluminium section. Body with concealed adjustable feet and optionally with a plinth of solid beech or steel and with removable back panel.

Fronts with 1 double wing door (at top) as well as wide drawers or suspension files (at bottom).

Optionally with **cylinder** or **turning knob locks**.

Bow handles of steel, wood or plastic as well as flush handles of plastic and knobs of steel.

Internal fittings: Adjustable shelves.

Following materials are available: Front LIGNOpal = L1,4,6,F1; Carcass/bases LIGNOpal = L1,4,6.

	Rows of holes: 25 mm.					
Serie 80000	d = 42 d = 58		80725 80775	80726 80776	80727 80777	80728 80778
	w-h		80-234,5			
	Lock (optional)		(2)			

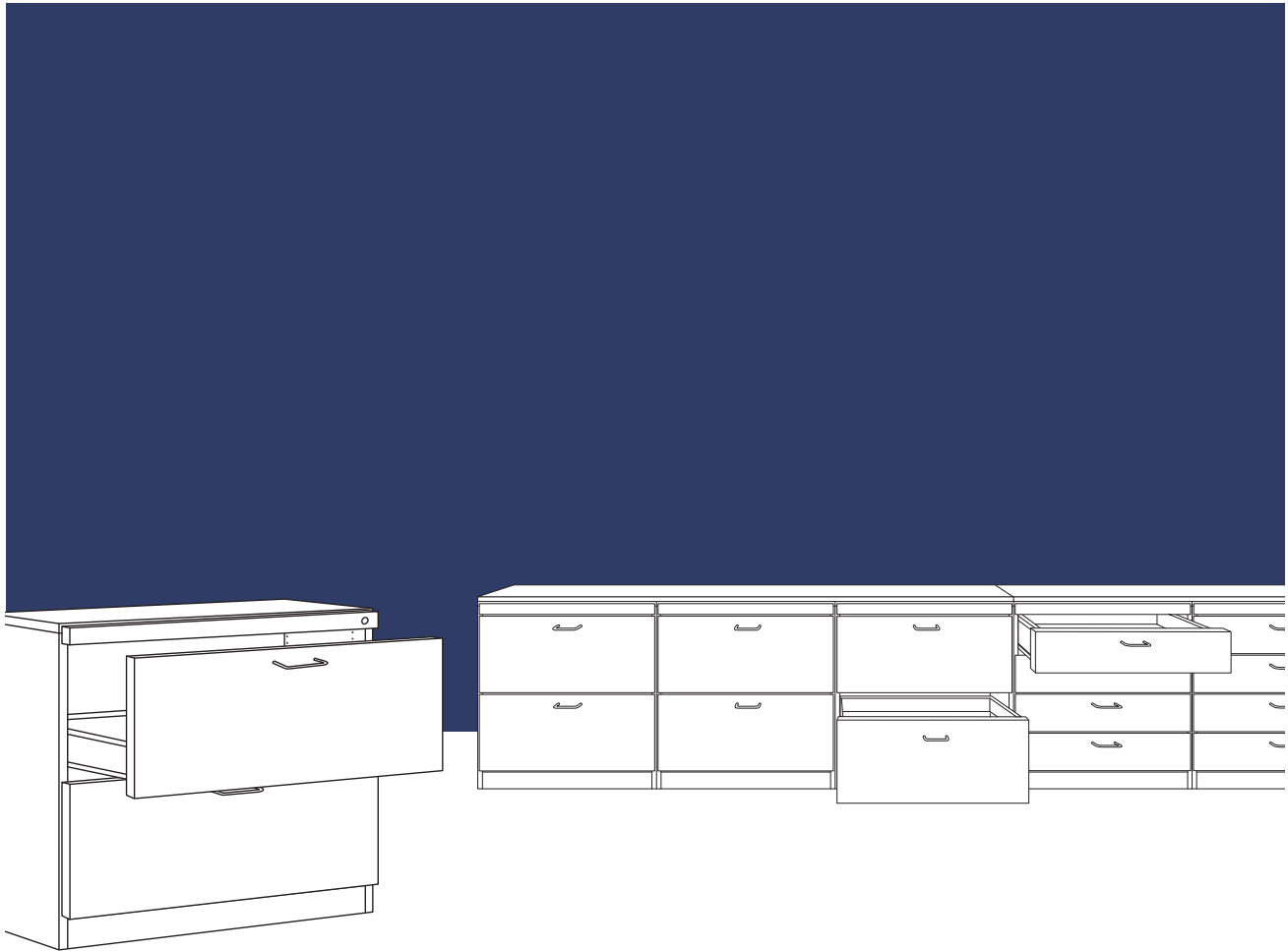

S8-HReg20H_TY_EN - 27.11.2009 - www.vs-furniture.com

PRODUCT INFORMATION

Serie 80000

Low cupboard with suspension files, wide drawers. 2 OH.

Construction: The body is either glued together or capable of being knocked-down and can be combined with other cupboards to form walls.

Body is of melamine-resin laminated LIGNOpal chipboard with glued-on (KU) plastic or (BU) beech edges. Body with concealed adjustable feet and optionally with a plinth of solid beech or steel and with removable back panel.

Fronts with wide drawers or suspension files.

Optionally with **cylinder** or **turning knob locks**.

Bow handles of steel, wood or plastic as well as flush handles of plastic and knobs of steel.

Following materials are available: Front LIGNOpal = L1,4,6,F1; Carcass/bases LIGNOpal = L1,4,6.

	Rows of holes: 25 mm.				
Serie 80000	d = 42		80140	80141	80148
	d = 58		80440	80441	80448
	w-h		80-84,5		
	Lock (optional)		(1)		



S8-HReg30H_TY_EN - 27.11.2009 - www.vs-furniture.com

PRODUCT INFORMATION

Serie 80000

Low cupboard with suspension files, wide drawers. 3 OH.

Construction: The body is either glued together or capable of being knocked-down and can be combined with other cupboards to form walls.

Body is of melamine-resin laminated LIGNOpal chipboard with glued-on (KU) plastic or (BU) beech edges. Body with concealed adjustable feet and optionally with a plinth of solid beech or steel and with removable back panel.

Fronts with wide drawers or suspension files.

Optionally with **cylinder** or **turning knob locks**.

Bow handles of steel, wood or plastic as well as flush handles of plastic and knobs of steel.

Following materials are available: Front LIGNOpal = L1,4,6,F1; Carcass/bases LIGNOpal = L1,4,6.

	Rows of holes: 25 mm.				
					
Serie 80000	d = 42 d = 58 w-h Lock (optional)		80142 80442	80143 80443	80149 80449
			80-122 (1)		



S8-Kochen50H_TY_EN - 27.11.2009 - www.vs-furniture.com

PRODUCT INFORMATION

Serie 80000

Special compartment for cooking/washing-up. 5 OH.

Construction: The body is either glued together or capable of being knocked-down and can be combined with other cupboards to form walls.

Body is of melamine-resin laminated LIGNOpal chipboard with glued-on (KU) plastic or (BU) beech edges. Some cupboards have a glued partition as well as rows of holes or a perforated aluminium section. The body has concealed adjustable feet as well as an optional plinth of solid beech. Models 80327 und 80627 with steel plinth.

Fronts with 1 double wing doors.

Optionally with **cylinder** or **turning knob locks**.

Bow handles of steel, wood or plastic as well as flush handles of plastic and knobs of steel.

Internal fittings: Adjustable shelves and special built-in facilities for cooking and washing-up.

Note: The connected load of the cabinet kitchenette can be up to 7,000 W. The customer must provide a connection of at least 3x2.5 mm² for this purpose. The connected loads of the individual appliances: hotplate=3,500 W, boiler=2,000 W, refrigerator=150 W, lamp 2x25 W, socket-outlet (in the lamp) max. 1,300 W.

Following materials are available: Front LIGNOpal = L1,4,6,F1; Carcass/bases LIGNOpal = L1,4,6.

	Rows of holes: 25 mm.					
Serie 80000	d = 42 d = 58 w-h Lock (optional)		80327 80627	80677	80678	
				120-197 (1)		

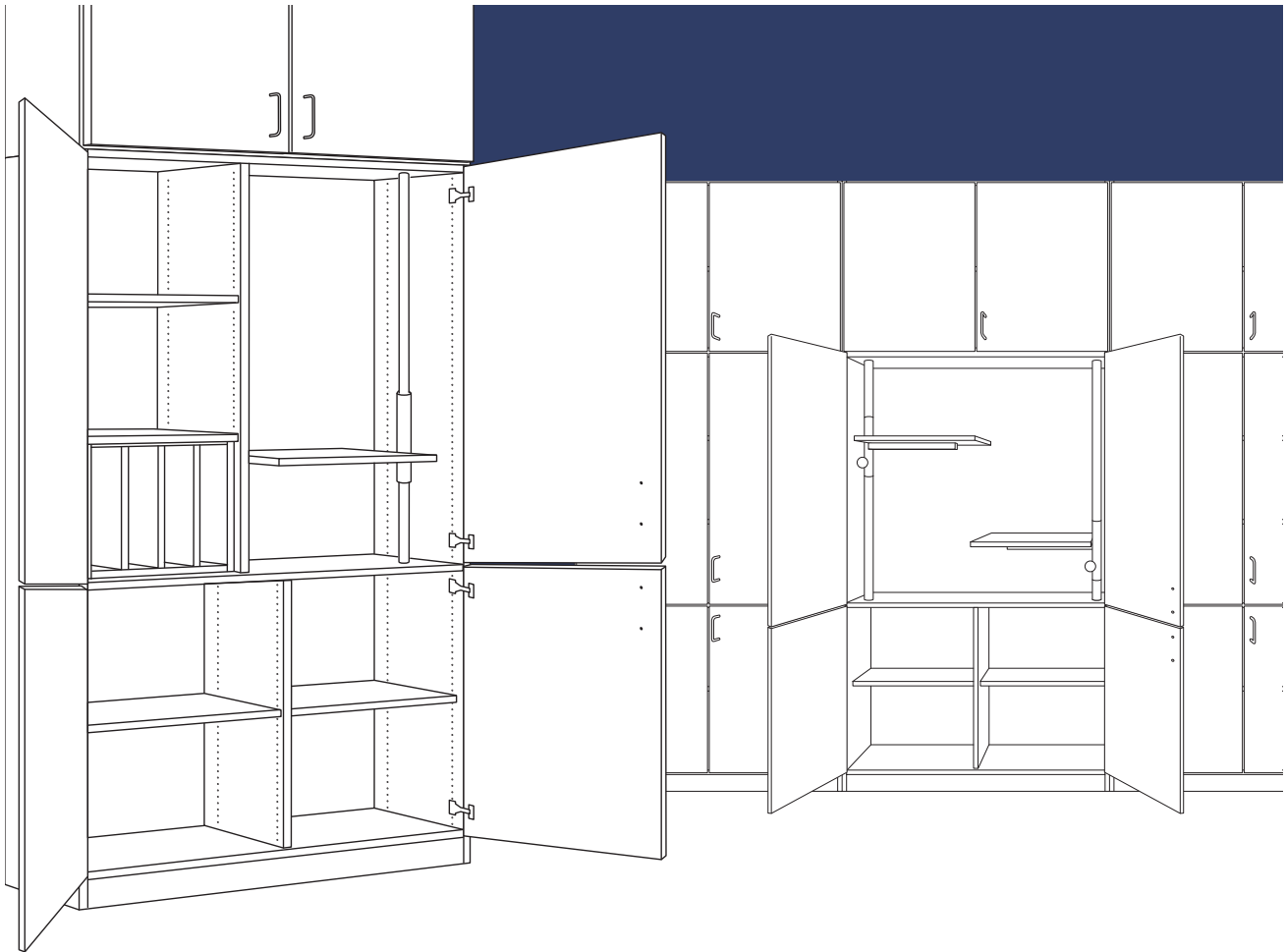

S8-Medien50H_TY_EN - 27.11.2009 - www.vs-furniture.com

PRODUCT INFORMATION

Serie 80000
Special media compartments. 5 OH.

Construction: The body is either glued together or capable of being knocked-down and can be combined with other cupboards to form walls.

Body is of melamine-resin laminated LIGNOpal chipboard with glued-on (KU) plastic or (BU) beech edges. With glued structural shelves, some with partitions and rows of holes or a perforated aluminium section. Body with concealed adjustable feet and optionally with a plinth of solid beech or steel and with removable back panel.

Fronts with 1 or 2 double wing doors.

Optionally with **cylinder** or **turning knob locks**.

Bow handles of steel, wood or plastic as well as flush handles of plastic and knobs of steel.

Internal fittings: Adjustable shelves and special facilities such as a vertical tube with a projector shelf which can be rotated and adjusted in height as well as further small compartments.

Following materials are available: Front LIGNOpal = L1,4,6,F1; Carcass/bases LIGNOpal = L1,4,6.

	Rows of holes: 25 mm.				
Serie 80000	d = 42		80367	80368	80369
	d = 58		80667	80668	80669
	w-h		120-197		
	Lock (optional)		(2)		



S8-Musik50H_TY_EN - 27.11.2009 - www.vs-furniture.com

PRODUCT INFORMATION

Serie 80000

Special compartment for musical instruments. 5 OH.

Construction: The body is either glued together or capable of being knocked-down and can be combined with other cupboards to form walls.

Body is of melamine-resin laminated LIGNOpal chipboard with glued-on (KU) plastic or (BU) beech edges. With glued structural shelves and partitions as well as rows of holes or a perforated aluminium section. Body with concealed adjustable feet and optionally with a plinth of solid beech or steel and with removable back panel.

Fronts with 1 double wing door.

Optionally with **cylinder** or **turning knob locks**.

Bow handles of steel, wood or plastic as well as flush handles of plastic and knobs of steel.

Internal fittings: Adjustable shelves and special built-in facilities for Orff musical instruments.

Following materials are available: Front LIGNOpal = L1,4,6,F1; Carcass/bases LIGNOpal = L1,4,6.

	Rows of holes: 25 mm.		
Serie 80000	d = 58		80671
	w-h		120-197
	Lock (optional)		(1)

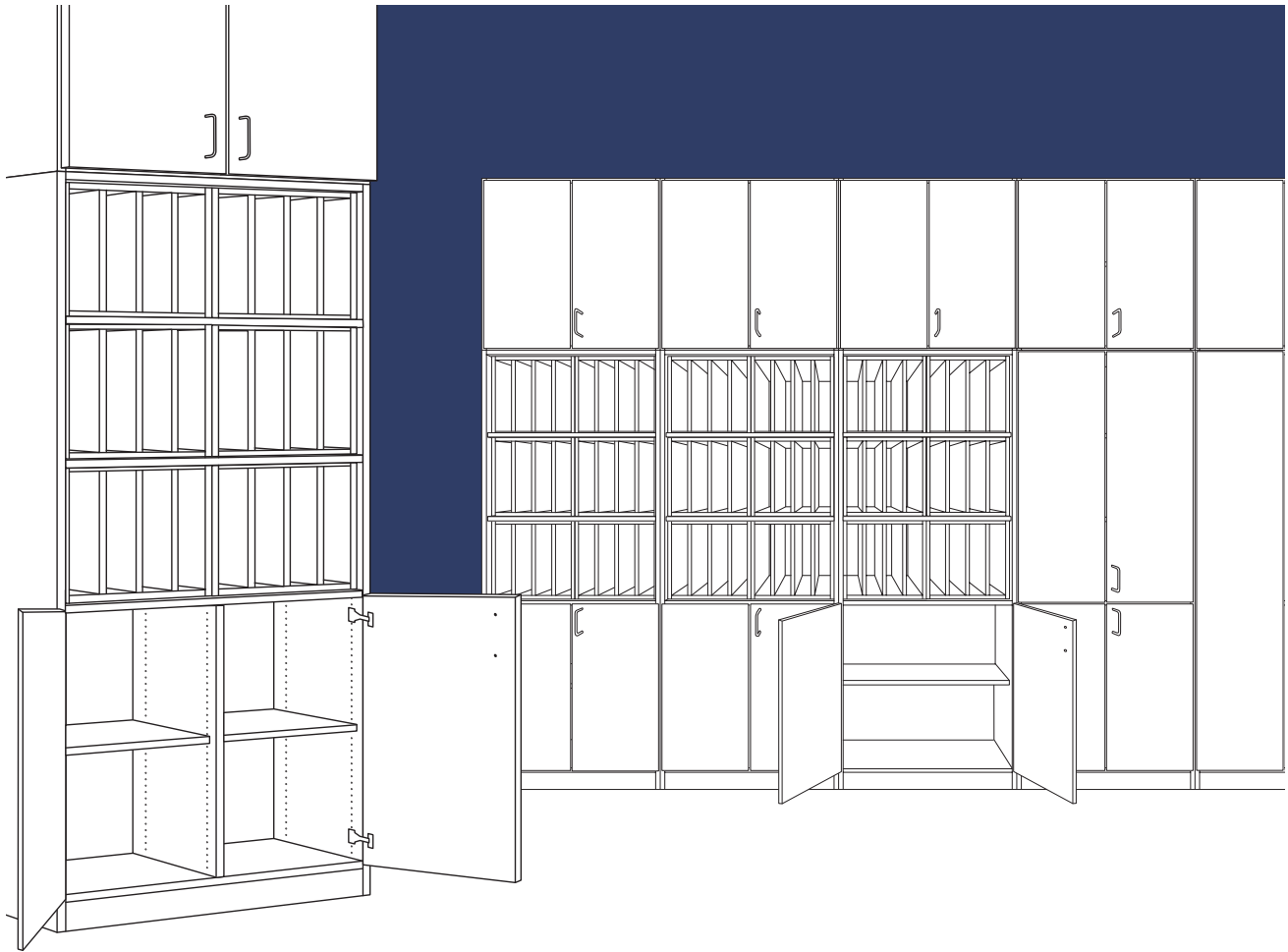

S8-Post2+3OH_TY_EN - 27.11.2009 - www.vs-furniture.com

PRODUCT INFORMATION

Serie 80000
Pigeon holes. 2+3 OH.

Construction: The body is either glued together or capable of being knocked-down and can be combined with other cupboards to form walls.

Body is of melamine-resin laminated LIGNOpal chipboard with glued-on (KU) plastic or (BU) beech edges as well as glued structural shelves and rows of holes or a perforated aluminium section. Body with concealed adjustable feet and optionally with a plinth of solid beech or steel and with removable back panel.

Fronts of vertical pigeon holes (3x1 OH) with name and number plates as well as 1 single or 1 double wing door (at the bottom). Optionally with **cylinder** or **turning knob locks**.

Bow handles of steel, wood or plastic as well as flush handles of plastic and knobs of steel.

Internal fittings: Adjustable shelves.

Following materials are available: Front LIGNOpal = L1,4,6,F1; Carcass/bases LIGNOpal = L1,4,6.

	Rows of holes: 25 mm.				
Serie 80000	d = 42		80260	80261	80262
	w-h		40-197		80-197
	Lock (optional)			(1)	

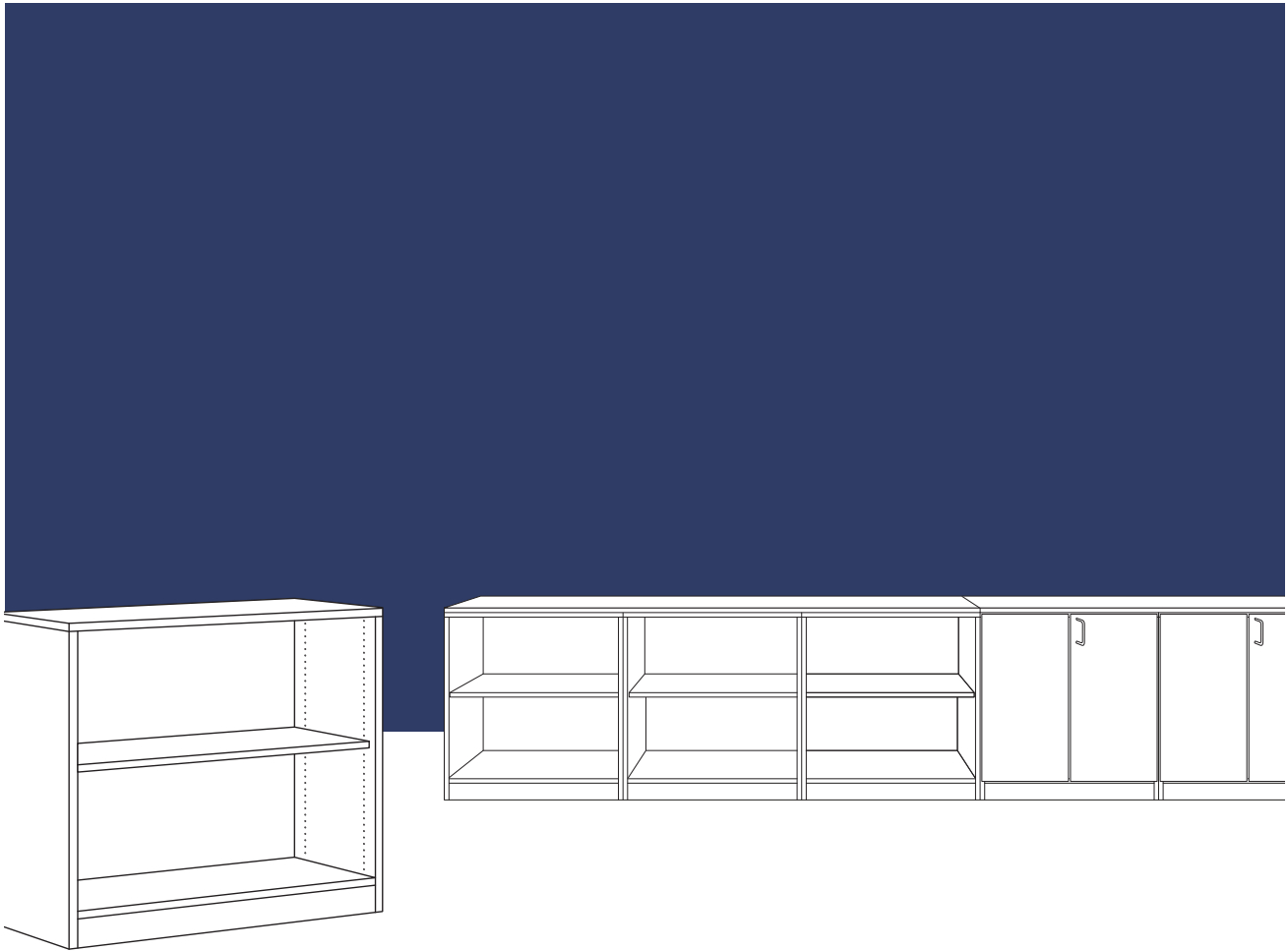

S8-Reg20H_TY_EN - 27.11.2009 - www.vs-furniture.com

PRODUCT INFORMATION

Serie 80000

Low cupboard with open shelves. 2 OH.

Construction: The body is either glued together or capable of being knocked-down and can be combined with other cupboards to form walls.

Body is of melamine-resin laminated LIGNOpal chipboard with glued-on (KU) plastic or (BU) beech edges as well as rows of holes or a perforated aluminium section. Body with concealed adjustable feet and optionally with a plinth of solid beech or steel and with removable back panel.

Internal fittings: Adjustable shelves.

Following materials are available: Carcass/bases LIGNOpal = L1,4,6.

	Rows of holes: 25 mm.							
								
Serie 80000	d = 42		80100	80200	80300	80102	80202	80302
	d = 58		80400	80500	80600	80402	80502	80602
	w-h		40-84,5	50-84,5	60-84,5	80-84,5	100-84,5	120-84,5
	Lock (optional)		-	-	-	-	-	-



S8-Reg40H_TY_EN - 27.11.2009 - www.vs-furniture.com

PRODUCT INFORMATION

Serie 80000
Open cupboard. 4 OH.

Construction: The body is either glued together or capable of being knocked-down and can be combined with other cupboards to form walls.

Body is of melamine-resin laminated LIGNOpal chipboard with glued-on (KU) plastic or (BU) beech edges as well as rows of holes or a perforated aluminium section for adjustable shelves. Body with concealed adjustable feet and optionally with a plinth of solid beech or steel and with removable back panel.

Internal fittings: Adjustable shelves.

Following materials are available: Carcass/bases LIGNOpal = L1,4,6.

	Rows of holes: 25 mm.		
Serie 80000	d = 42		80103
	d = 58		80403
	w-h		80-159,5
	Lock (optional)		-

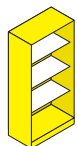

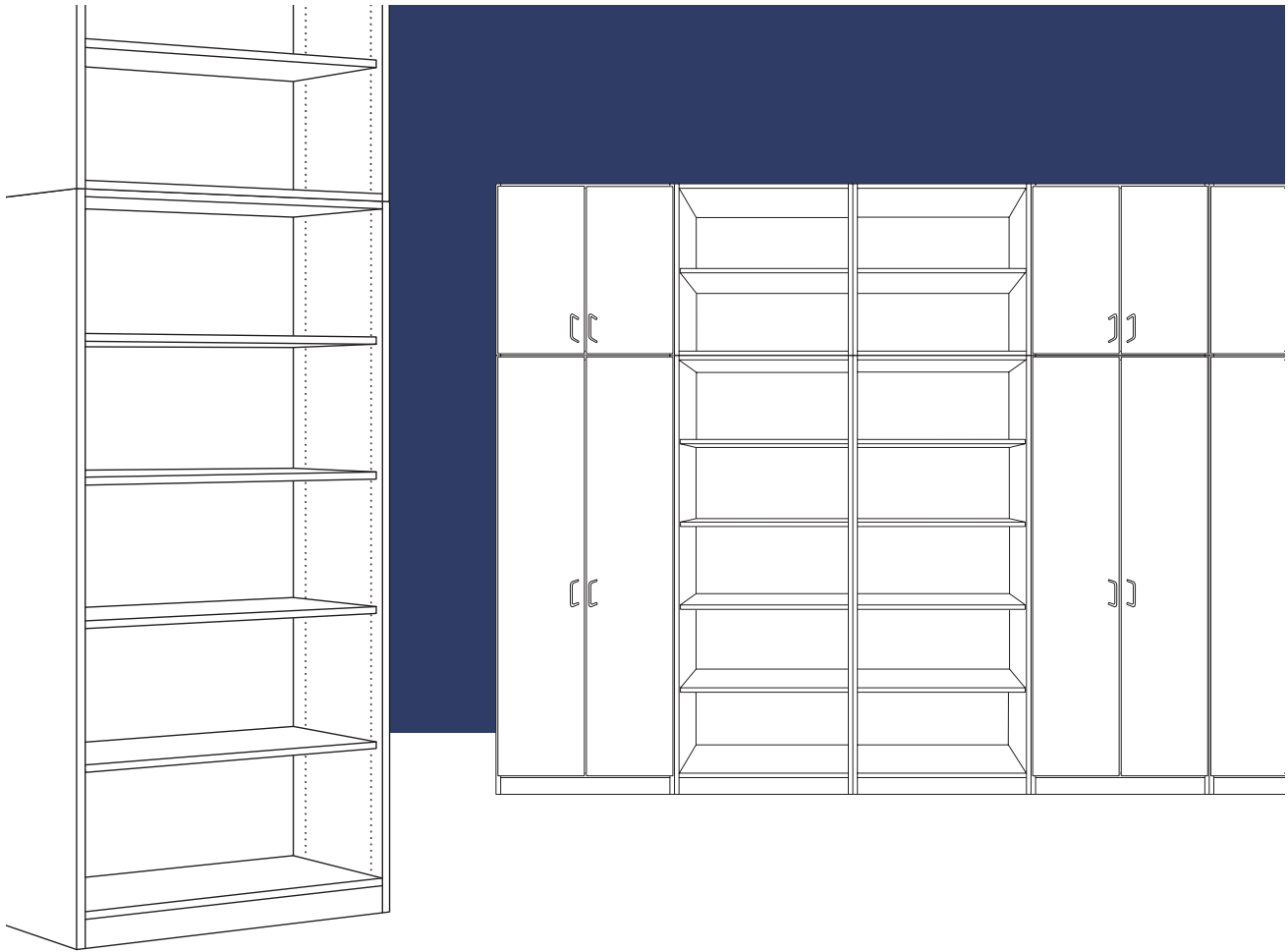

S8-Reg50H_TY_EN - 27.11.2009 - www.vs-furniture.com

PRODUCT INFORMATION

Serie 80000
Open cupboard. 5 OH.

Construction: The body is either glued together or capable of being knocked-down and can be combined with other cupboards to form walls.

Body is of melamine-resin laminated LIGNOpal chipboard with glued-on (KU) plastic or (BU) beech edges. Some cupboards have glued partition as well as rows of holes or a perforated aluminium section for adjustable shelves. Body with concealed adjustable feet and optionally with a plinth of solid beech or steel and with removable back panel.

Internal fittings: Adjustable shelves.

Following materials are available: Carcass/bases LIGNOpal = L1,4,6.

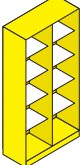
	Rows of holes: 25 mm.									
Serie 80000	d = 42		80101	80201	80301	80104	80204	80307	80205	80308
	d = 58		80401	80501	80601	80404	80504	80607	80505	80608
	w-h		40-197	50-197	60-197	80-197	100-197	120-197	100-197	120-197
	Lock (optional)		-	-	-	-	-	-	-	-



S8-Reg60H_TY_EN - 27.11.2009 - www.vs-furniture.com

PRODUCT INFORMATION

Serie 80000
Open cupboard. 6 OH.

Construction: The body is either glued together or capable of being knocked-down and can be combined with other cupboards to form walls.

Body is of melamine-resin laminated LIGNOpal chipboard with glued-on (KU) plastic or (BU) beech edges as well as rows of holes or a perforated aluminium section for adjustable shelves. Body with concealed adjustable feet and optionally with a plinth of solid beech or steel and with removable back panel.

Internal fittings: Adjustable shelves.

Following materials are available: Carcass/bases LIGNOpal = L1,4,6.

	Rows of holes: 25 mm.							
Serie 80000	d = 42		80700	80707	80714	80721	80729	80733
	d = 58		80750	80757	80764	80771	80779	80783
	w-h		40-234,5	50-234,5	60-234,5	80-234,5	100-234,5	120-234,5
	Lock (optional)		-	-	-	-	-	-



S8-Roll_TY_EN - 16.12.2007 - www.vs-furniture.com

PRODUCT INFORMATION

Serie 80000

Side opening tambour cupboard. 2 to 5 OH.

Construction: The body is glued together and can be combined with other cupboards to form walls.

Body is of melamine-resin laminated LIGNOpal chipboard with glued-on (KU) plastic or (BU) beech edges. With rows of holes or a perforated aluminium section. The body has concealed adjustable feet as well as an optional plinth of solid beech.

Fronts with side opening tambour.

Optional with **cylinder lock**.

Bow handles of steel, wood or plastic.

Internal fittings: Adjustable shelves.

Following materials and colours are available: (L) laminate colours. Body: L9 and off-white Body edges: L9, off-white, natural beech or stained. Front: off-white, anthracite. Front edges: off-white, anthracite.

Serie 80000	d = 44		80254	80255	80256	80257
	w-h		100-87	100-124,5	100-162	100-197
	Lock (optional)					(1)



S8-Roll-B90_TY_EN - 12.01.2009 - www.vs-furniture.com

PRODUCT INFORMATION

Serie 80000
Side opening tambour cupboard.

Construction: The body is glued together and can be combined with other cupboards to form walls. As cupboard, add-on cupboard or already combined with a pull-out writing surface (optional).

Body is of melamine-resin laminated LIGNOpal chipboard with glued-on (KU) plastic or (BU) beech edges. With rows of holes or a perforated aluminium section. The body has concealed adjustable feet.

Fronts with side opening tambour.

Optional with **cylinder lock**.

Bow handles of steel, wood or plastic.

Internal fittings: Adjustable shelves.

Following materials and colours are available: Body: L6 and off-white Body edges: L6, off-white, natural beech. Front: off-white, anthracite. Front edges: off-white, anthracite.

	Rows of holes: 25 mm.										
Serie 80000	d = 48	80830	80831	80832	80833	80834	80835	80836	80837	80838	80839
	w-h	90-84,5	90-122	90-159,5	90-197	90-75	90-112,5	90-159,5	90-197	90-197	90-234,5
	Lock (optional)			(1)					(2)		
		1-part cupboard				1-part attachment cupboard		2-part combination			

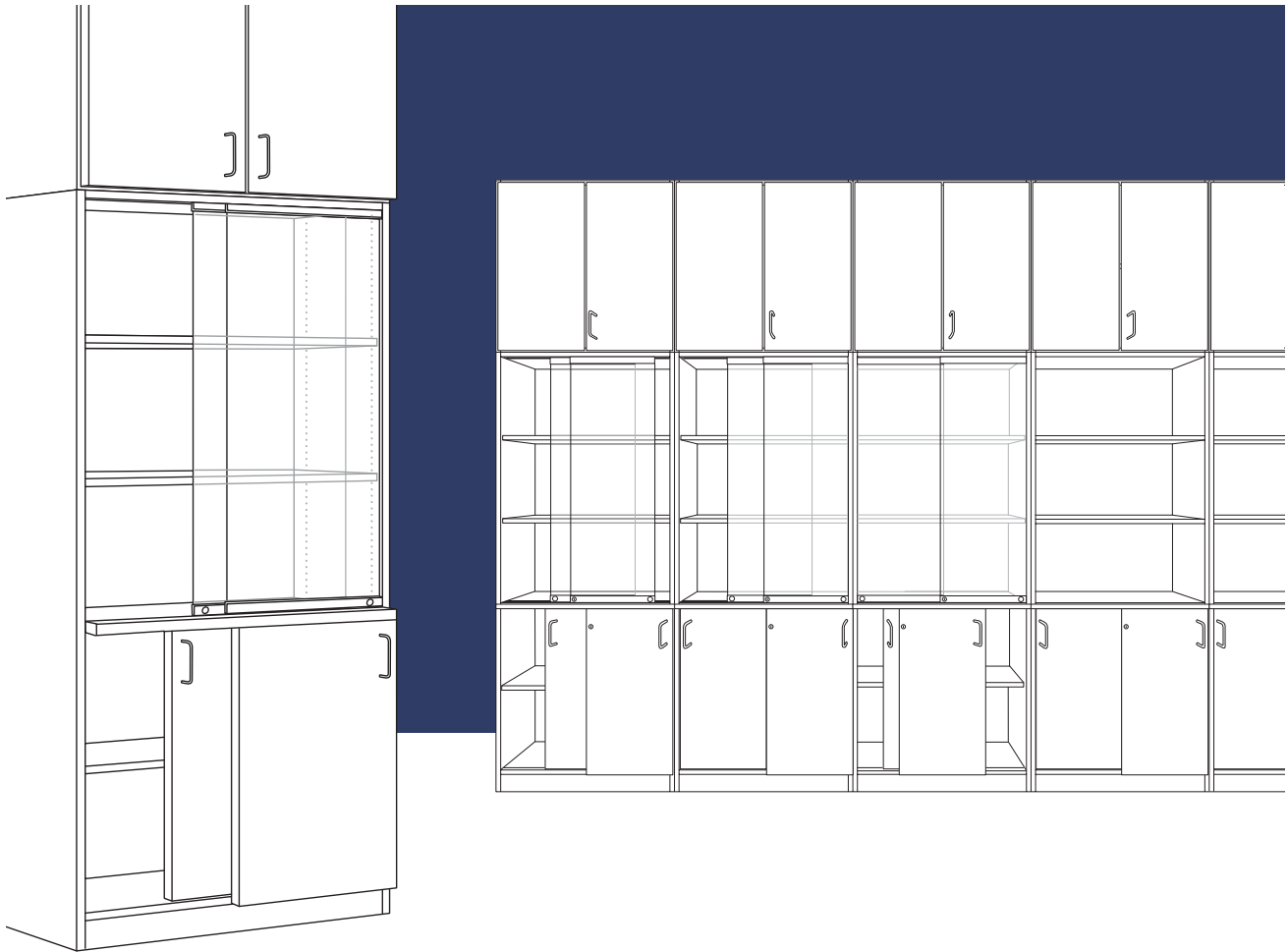

S8-Schieb2+3_TY_EN - 27.11.2009 - www.vs-furniture.com

PRODUCT INFORMATION

Serie 80000
Sliding door. 2+3 OH.

Construction: The body is either glued together or capable of being knocked-down and can be combined with other cupboards to form walls.

Body is of melamine-resin laminated LIGNOpal chipboard with glued-on (KU) plastic or (BU) beech edges. The cupboards have glued structural shelves and partitions as well as rows of holes or a perforated aluminium section. Body with concealed adjustable feet and optionally with a plinth of solid beech or steel and with removable back panel.

Fronts with open shelves and 2 glass sliding doors (at top) and 2 LIGNOpal sliding doors (at bottom).

Optionally with **cylinder** or **turning knob locks**.

Bow handles of steel, wood or plastic as well as flush handles of plastic and knobs of steel.

Internal fittings: Adjustable shelves.

Following materials are available: Front LIGNOpal = L1,4,6,F1; Carcass/bases LIGNOpal = L1,4,6.

	Rows of holes: 25 mm.					
Serie 80000	d = 42		80251	80351	80253	80353
	d = 58		80551	80651	80553	80653
	w-h		100-197	120-197	100-197	120-197
	Lock (optional)			(1)	(2)	

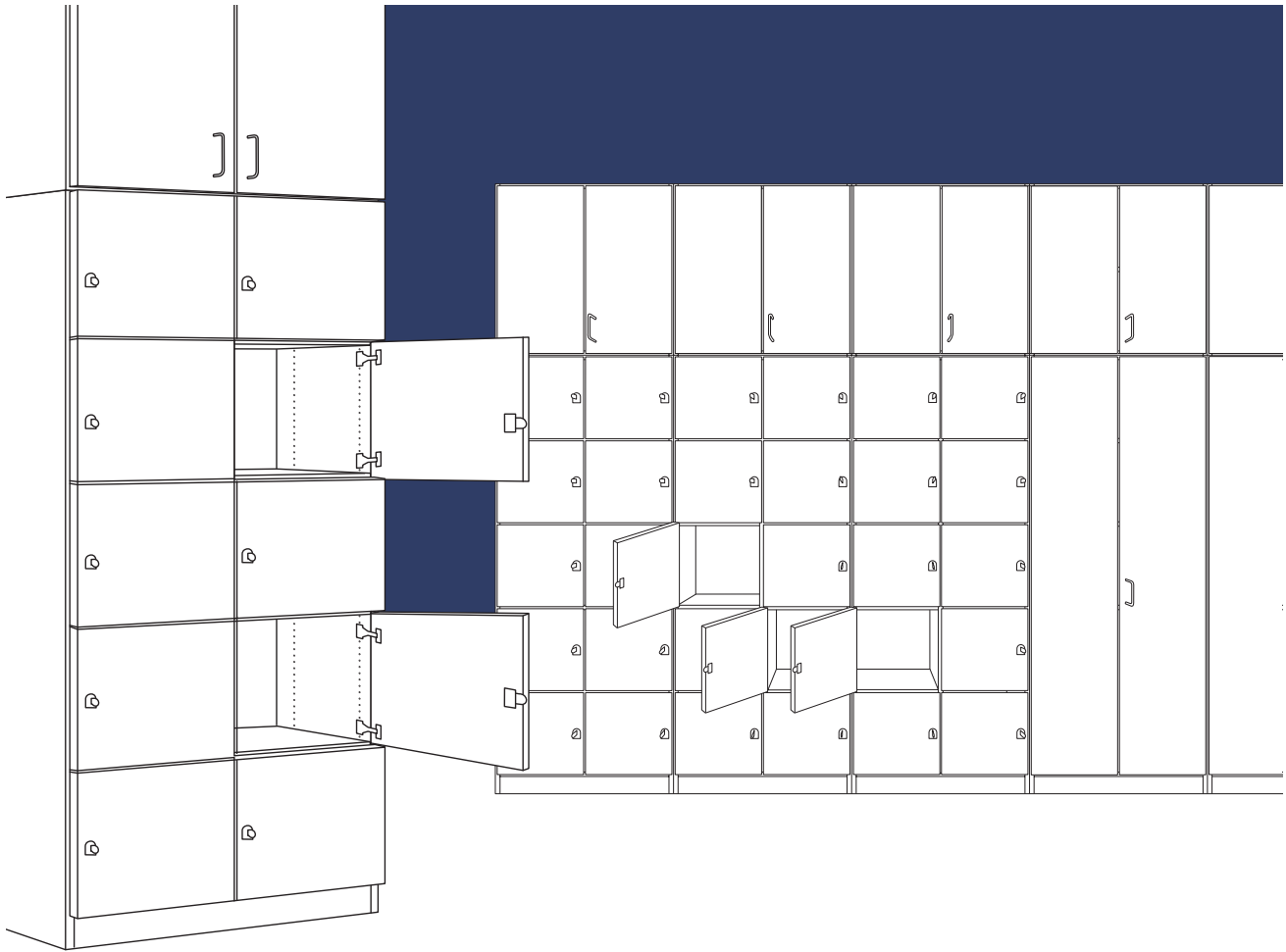

S8-Schli1+1+1+1_TY_EN - 27.11.2009 - www.vs-furniture.com

PRODUCT INFORMATION

**Serie 80000
Lockers. 1+1+1+1+1 OH.**

Construction: The body is either glued together or capable of being knocked-down and can be combined with other cupboards to form walls.

Body is of melamine-resin laminated LIGNOpal chipboard with glued-on (KU) plastic or (BU) beech edges. Some cupboards have glued structural shelves and partitions as well as rows of holes or a perforated aluminium section. Body with concealed adjustable feet and optionally with a plinth of solid beech or steel and with removable back panel.

Fronts of small lockers (1 OH) with name and number plates.

Optionally with **cylinder** or **turning knob locks**.

Internal fittings: Adjustable shelves.

Following materials are available: Front LIGNOpal = L1,4,6,F1; Carcass/bases LIGNOpal = L1,4,6.

	Rows of holes: 25 mm.					
Serie 80000	d = 42		80168	80169	80178	80179
	d = 58		80468	80469	80478	80479
	w-h		40-197		80-197	
	Lock		5		10	

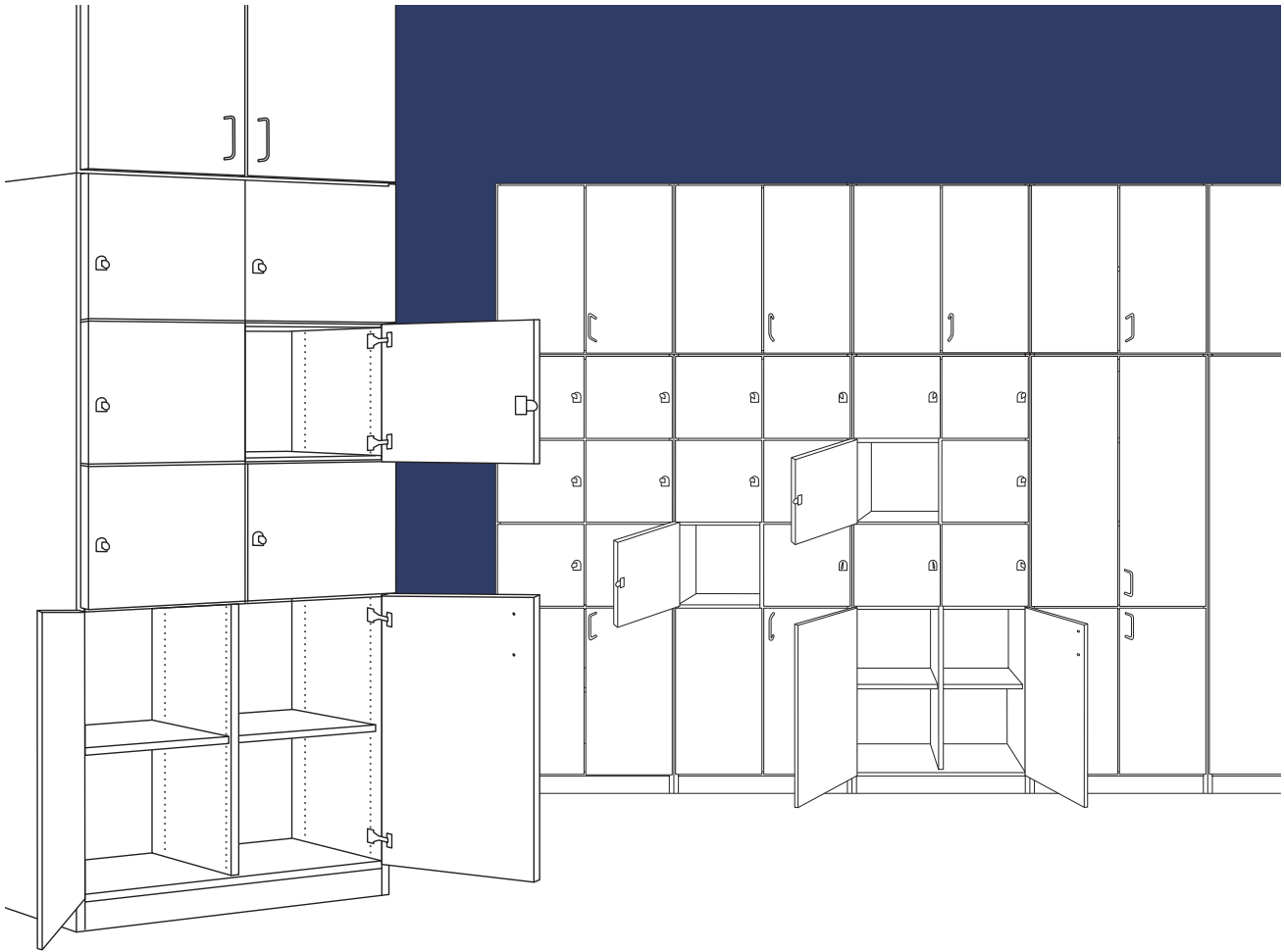

S8-Schli2+1+1+1_TY_EN - 27.11.2009 - www.vs-furniture.com

PRODUCT INFORMATION

**Serie 80000
Lockers. 2+1+1+1 OH.**

Construction: The body is either glued together or capable of being knocked-down and can be combined with other cupboards to form walls.

Body is of melamine-resin laminated LIGNOpal chipboard with glued-on (KU) plastic or (BU) beech edges. Some cupboards have glued structural shelves and partitions as well as rows of holes or a perforated aluminium section. Body with concealed adjustable feet and optionally with a plinth of solid beech or steel and with removable back panel.

Fronts of small lockers (1 OH) with name and number plates as well as 1 single or 1 double wing door (at bottom). Optionally with **cylinder** or **turning knob locks**.

Bow handles of steel, wood or plastic as well as flush handles of plastic and knobs of steel.

Internal fittings: Adjustable shelves.

Following materials are available: Front LIGNOpal = L1,4,6,F1; Carcass/bases LIGNOpal = L1,4,6.

	Rows of holes: 25 mm.					
Serie 80000	d = 42		80166	80167	80176	80177
	d = 58		80466	80467	80476	80477
	w-h		40-197		80-197	
	Lock		3		6	

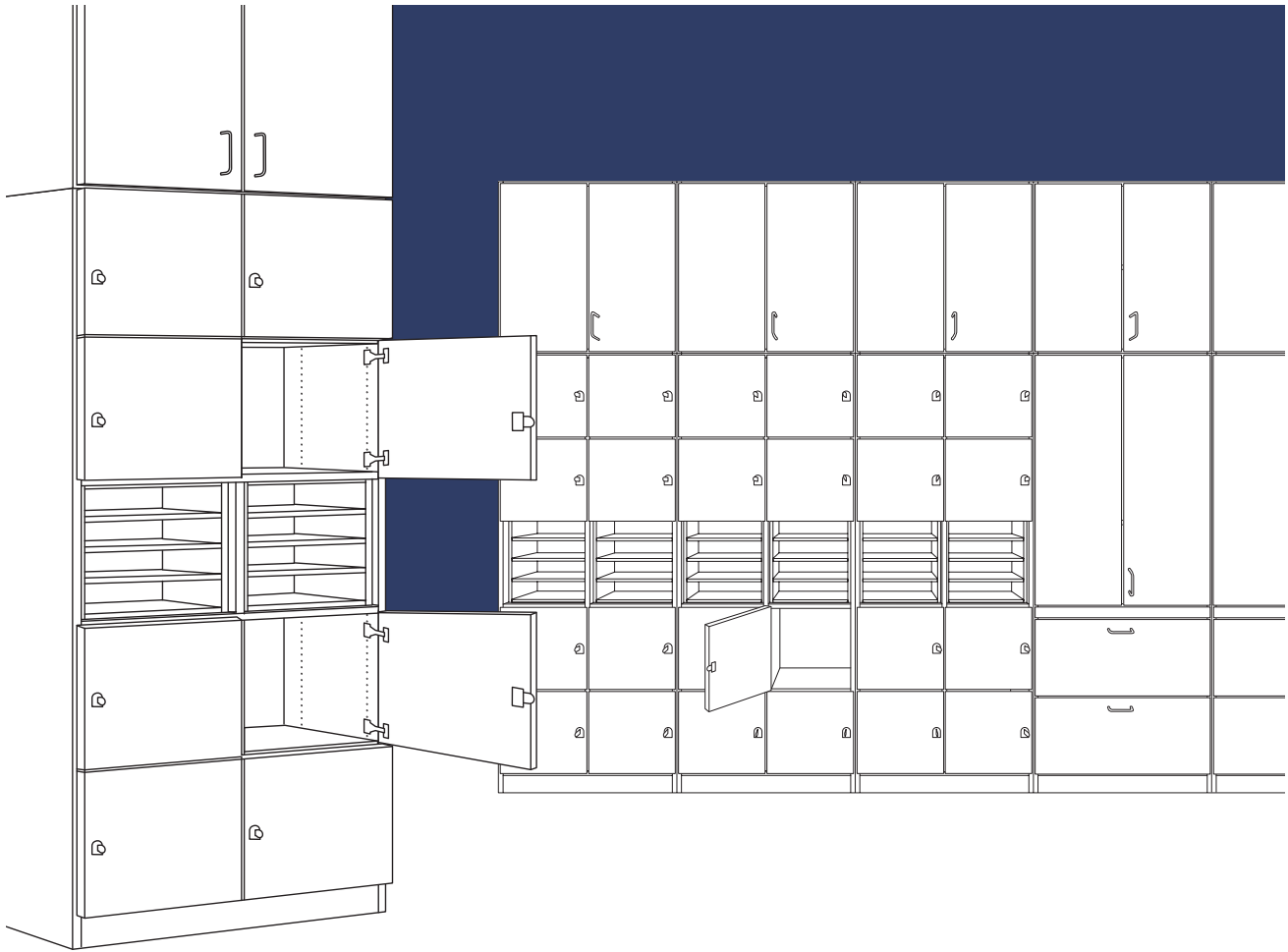

S8-SchliPo1+1+1+1+1_TY_EN - 27.11.2009 - www.vs-furniture.com

PRODUCT INFORMATION

Serie 80000
Lockers, pigeon holes. 1+1+1+1+1 OH.

Construction: The body is either glued together or capable of being knocked-down and can be combined with other cupboards to form walls.

Body is of melamine-resin laminated LIGNOpal chipboard with glued-on (KU) plastic or (BU) beech edges. Some cupboards have glued structural shelves and middle partitions as well as rows of holes or a perforated aluminium section. Body with concealed adjustable feet and optionally with a plinth of solid beech or steel and with removable back panel.

Fronts each of small lockers (1 OH) with name and number plates as well as pigeon holes (in the middle). Optionally with **cylinder** or **turning knob locks**.

Following materials are available: Front LIGNOpal = L1,4,6,F1; Carcass/bases LIGNOpal = L1,4,6.

	Rows of holes: 25 mm.					
Serie 80000	d = 42		80164	80165	80174	80175
	d = 58		80464	80465	80474	80475
	w-h		40-197		80-197	
	Lock		4		8	

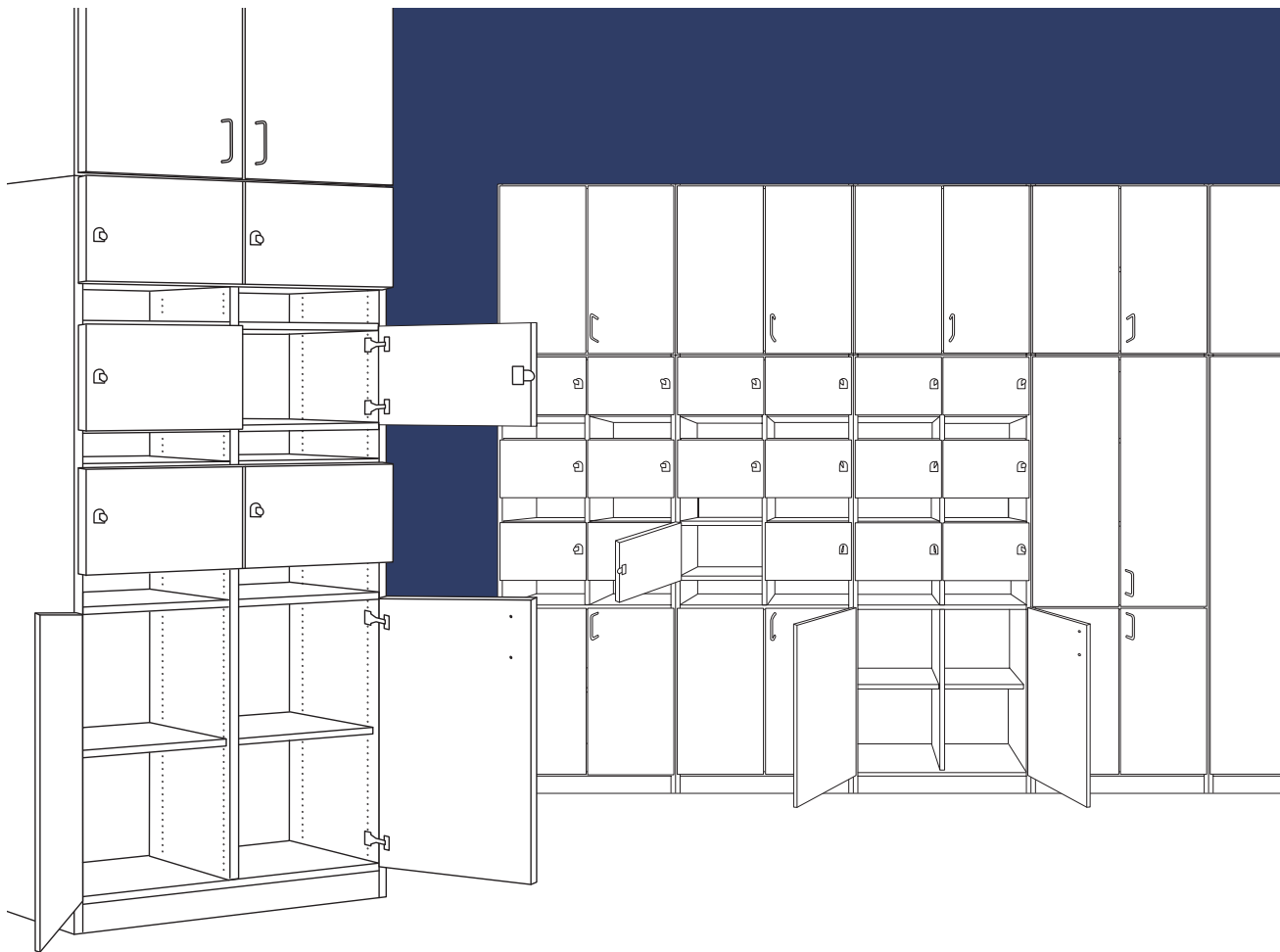

S8-SchliPo2+1+1+1_TY_EN - 27.11.2009 - www.vs-furniture.com

PRODUCT INFORMATION

Serie 80000
Lockers, pigeon holes. 2+1+1+1 OH.

Construction: The body is either glued together or capable of being knocked-down and can be combined with other cupboards to form walls.

Body is of melamine-resin laminated LIGNOpal chipboard with glued-on (KU) plastic or (BU) beech edges. Some cupboards have glued structural shelves and middle partitions as well as rows of holes or a perforated aluminium section. Body with concealed adjustable feet and optionally with a plinth of solid beech or steel and with removable back panel.

Fronts each with a small locker and pigeon hole (1 OH) with name and number plates as well as 1 single or 1 double wing door (at bottom).

Optionally with **cylinder** or **turning knob locks**.

Bow handles of steel, wood or plastic as well as flush handles of plastic and knobs of steel.

Internal fittings: Adjustable shelves.

Following materials are available: Front LIGNOpal = L1,4,6,F1; Carcass/bases LIGNOpal = L1,4,6.

	Rows of holes: 25 mm.					
Serie 80000	d = 42		80160	80161	80170	80171
	d = 58		80460	80461	80470	80471
	w-h		40-197		80-197	
	Lock		3		6	

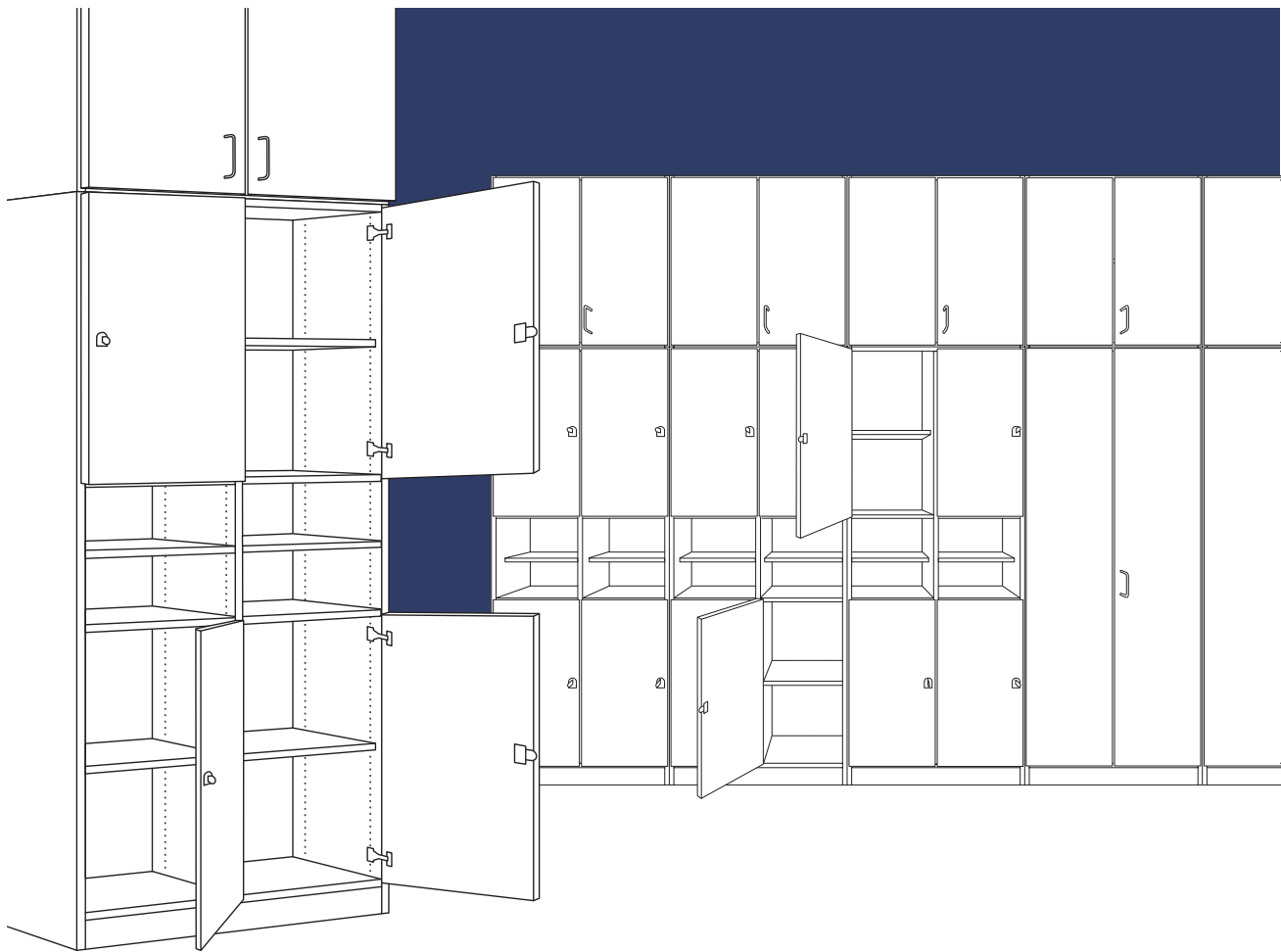

S8-SchliPo2+1+2_TY_EN - 27.11.2009 - www.vs-furniture.com

PRODUCT INFORMATION

Serie 80000
Lockers, pigeon holes. 2+1+2 OH.

Construction: The body is either glued together or capable of being knocked-down and can be combined with other cupboards to form walls.

Body is of melamine-resin laminated LIGNOpal chipboard with glued-on (KU) plastic or (BU) beech edges. Some cupboards have glued structural shelves and middle partitions as well as rows of holes or a perforated aluminium section. Body with concealed adjustable feet and optionally with a plinth of solid beech or steel and with removable back panel.

Fronts each of big lockers (2 OH) with name and number plates as well as pigeon holes (in the middle).

Optionally with **cylinder** or **turning knob locks**.

Internal fittings: Adjustable shelves.

Following materials are available: Front LIGNOpal = L1,4,6,F1; Carcass/bases LIGNOpal = L1,4,6.

	Rows of holes: 25 mm.					
Serie 80000	d = 42		80162	80163	80172	80173
	d = 58		80462	80463	80472	80473
	w-h		40-197		80-197	
	Lock		2		4	

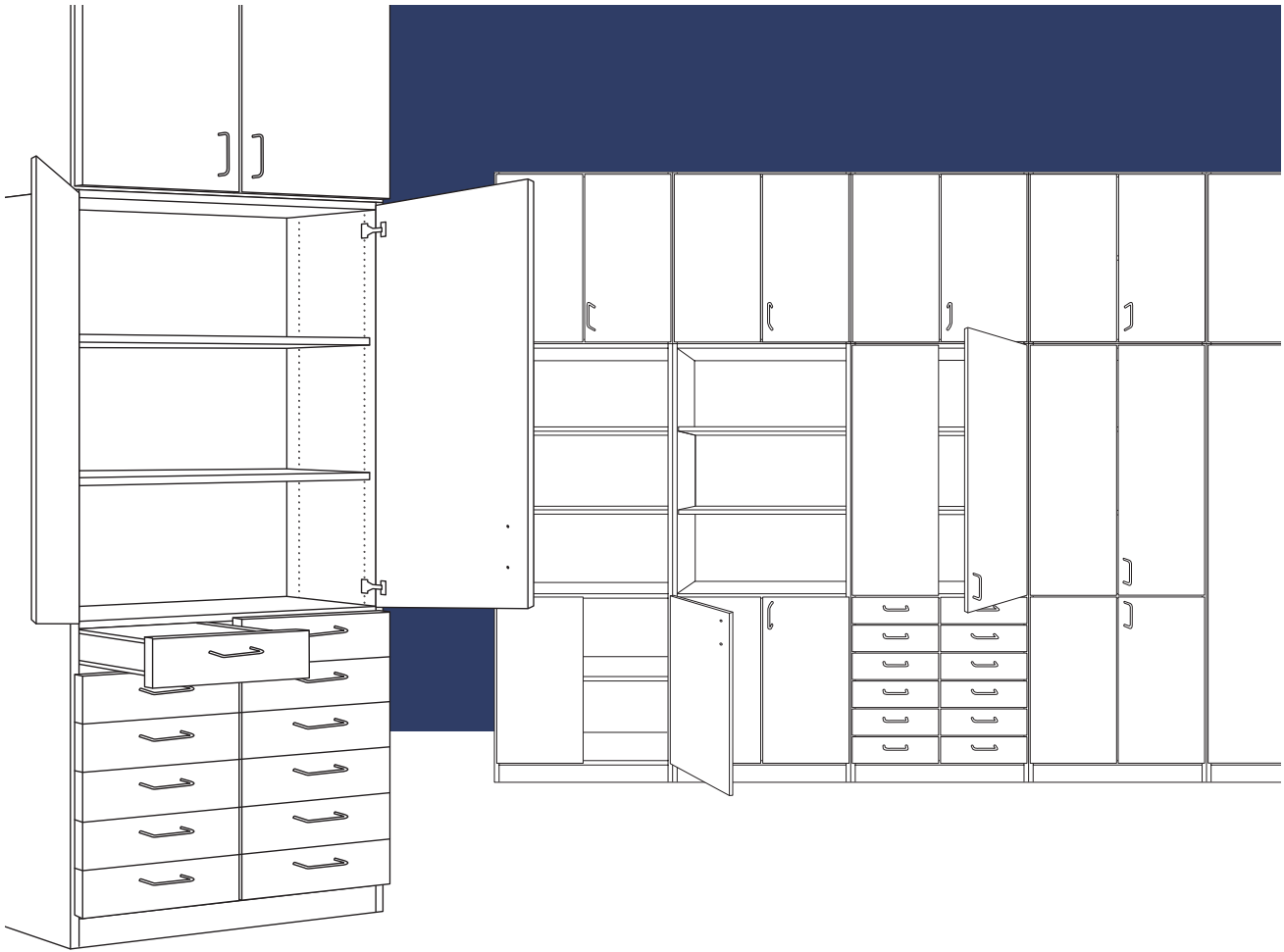

S8-Schub2+30H_TY_EN - 27.11.2009 - www.vs-furniture.com

PRODUCT INFORMATION

Serie 80000
Drawers. 2+3 OH.

Construction: The body is either glued together or capable of being knocked-down and can be combined with other cupboards to form walls.

Body is of melamine-resin laminated LIGNOpal chipboard with glued-on (KU) plastic or (BU) beech edges. The cupboards have glued structural shelves as well as rows of holes or a perforated aluminium section. Body with concealed adjustable feet and optionally with a plinth of solid beech or steel and with removable back panel.

Fronts with 1 double wing door (at top) and drawers (at bottom).

Optionally with **cylinder** or **turning knob locks**.

Bow handles of steel, wood or plastic as well as flush handles of plastic and knobs of steel.

Internal fittings: Adjustable shelves.

Following materials are available: Front LIGNOpal = L1,4,6,F1; Carcass/bases LIGNOpal = L1,4,6.

	Rows of holes: 25 mm.				
Serie 80000	d = 42		80134	80234	80334
	d = 58		80434	80534	80634
	w-h		80-197	100-197	120-197
	Lock (optional)			(3)	

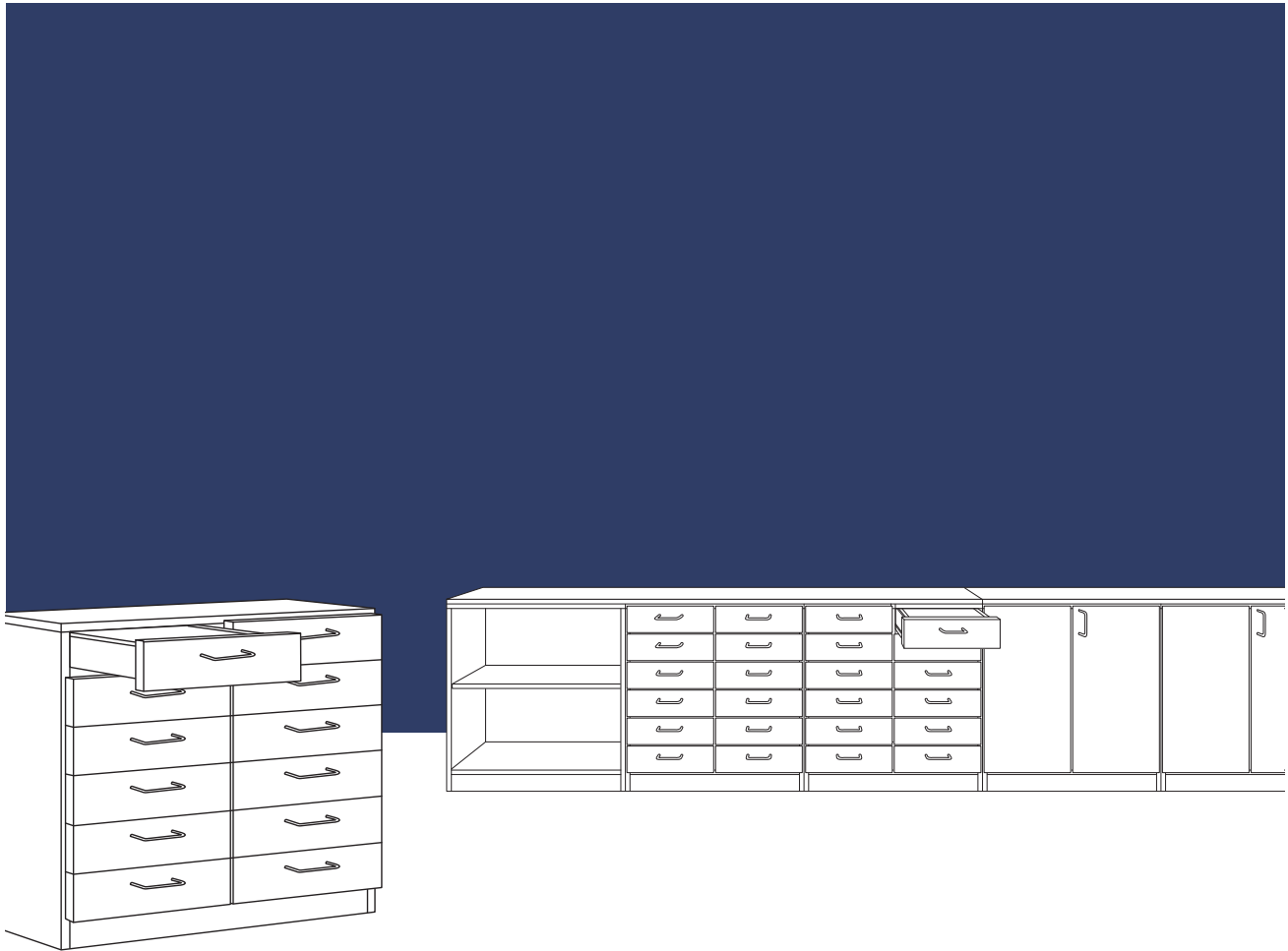

S8-Schub20H_TY_EN - 27.11.2009 - www.vs-furniture.com

PRODUCT INFORMATION

Serie 80000

Low cupboard with drawers. 2 OH.

Construction: The body is either glued together or capable of being knocked-down and can be combined with other cupboards to form walls.

Body is of melamine-resin laminated LIGNOpal chipboard with glued-on (KU) plastic or (BU) beech edges. With glued structural shelves as well as rows of holes or a perforated aluminium section. Body with concealed adjustable feet and optionally with a plinth of solid beech or steel and with removable back panel.

Fronts with drawers.

Optionally with **cylinder** or **turning knob locks**.

Bow handles of steel, wood or plastic as well as flush handles of plastic and knobs of steel.

Following materials are available: Front LIGNOpal = L1,4,6,F1; Carcass/bases LIGNOpal = L1,4,6.

	Rows of holes: 25 mm.							
Serie 80000	d = 42		80130	80230	80330	80133	80233	80333
	d = 58		80430	80530	80630	80433	80533	80633
	w-h		40-84,5	50-84,5	60-84,5	80-84,5	100-84,5	120-84,5
	Lock (optional)			(1)			(2)	

w/h 40x84,5 cm

w/h 40x197 cm



d42: 80100
d58: 80400



80110
80410



80111
80411



80130
80430



80101
80401



80112
80412

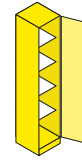

80113
80413



80120
80420

w/h 40x197 cm

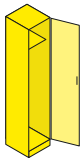

d42: 80121
d58: 80421

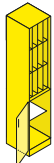

80260

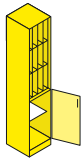

80261



80160
80460

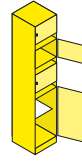

80161
80461



80162
80462

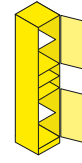

80163
80463



80164
80464

w/h 40x197 cm

w/h 40x234,5 cm

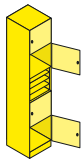

d42: 80165
d58: 80465

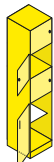

80166
80466

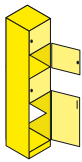

80167
80467



80168
80468

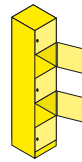

80169
80469



80700
80750



80701
80751



80702
80752

w/h 40x234,5 cm

w/h 40x75 cm

w/h 40x84 cm



d42: 80703
d58: 80753



80704
80754

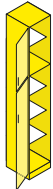

80705
80755



80706
80756

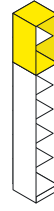

80180
80480

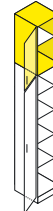

80181
80481

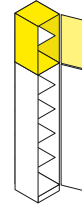

80182
80482



80190
80490

w/h 40x84 cm

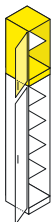

d42: 80191
d58: 80491

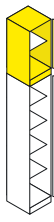

80192
80492

S8-Typen-B40_SY_EN - 16.12.2007 - www.vs-furniture.com

SYSTEM INFORMATION

Serie 80000

Cupboard types 40 cm wide.

w/h 50x84,5 cm

w/h 50x197 cm



d42: 80200
d58: 80500



80210
80510



80211
80511



80230
80530



80201
80501



80212
80512

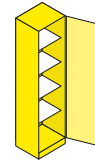

80213
80513

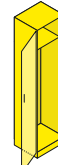

80224
80524

w/h 50x197 cm

w/h 50x234,5 cm

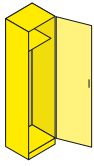

d42: 80225
d58: 80525



80707
80757



80708
80758



80709
80759



80710
80760

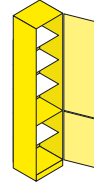

80711
80761



80712
80762

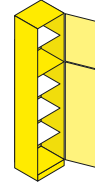

80713
80763

w/h 50x75 cm

w/h 50x84 cm

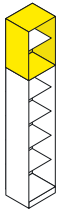

d42: 80280
d58: 80580

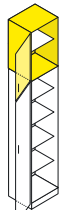

80281
80581

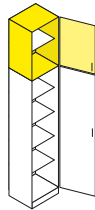

80282
80582

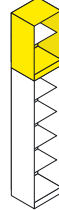

80290
80590

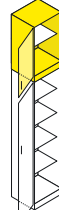

80291
80591

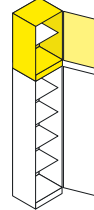

80292
80592

SYSTEM INFORMATION

Serie 80000

Cupboard types 50 cm wide.

w/h 60x84,5 cm

w/h 60x197 cm



d42: 80300
d58: 80600



80310
80610

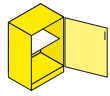

80311
80611



80330
80630



80301
80601

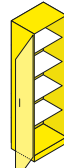

80312
80612

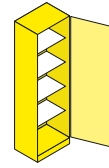

80313
80613

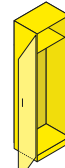

80328
80628

w/h 60x197 cm

w/h 60x234,5 cm

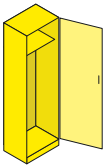

d42: 80329
d58: 80629



80714
80764

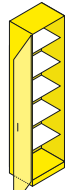

80715
80765

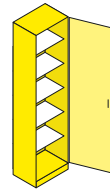

80716
80766



80717
80767

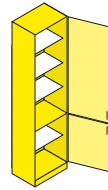

80718
80768



80719
80769

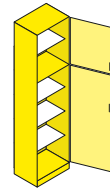

80720
80770

w/h 60x75 cm

w/h 60x84 cm

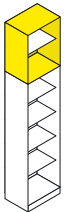

d42: 80380
d58: 80680

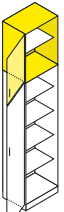

80381
80681

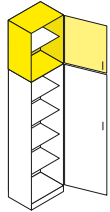

80382
80682

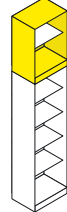

80390
80690

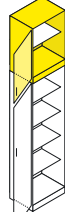

80391
80691

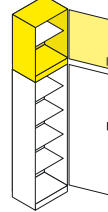

80392
80692

SYSTEM INFORMATION

Serie 80000

Cupboard types 60 cm wide.

w/h 80x84,5 cm



d42: 80102
d58: 80402

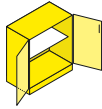

80114
80414

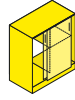

80159
80459

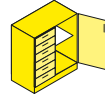

80131
80431



80132
80432



80133
80433

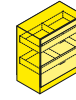

80140
80440

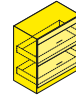

80141
80441

w/h 80x84,5 cm

w/h 80x122 cm

w/h 80x159,5 cm

w/h 80x197 cm



d42: 80148
d58: 80448

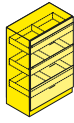

80142
80442

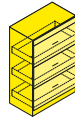

80143
80443

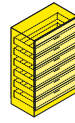

80149
80449



80103
80403

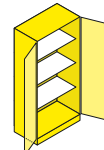

80115
80415



80104
80404

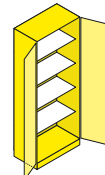

80118
80418

w/h 80x197 cm

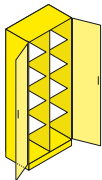

d42: 80119
d58: 80419

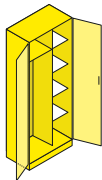

80122
80422

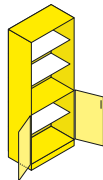

80116
80416

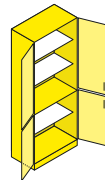

80117
80417

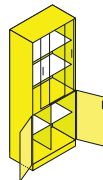

80151
80451

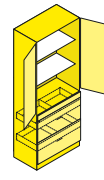

80144
80444

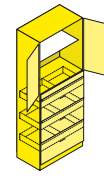

80146
80446

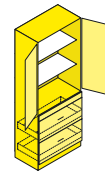

80145
80445

w/h 80x197 cm

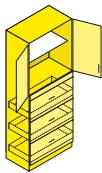

d42: 80147
d58: 80447

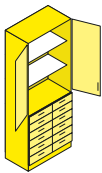

80134
80434

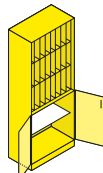

80262

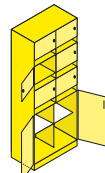

80170
80470

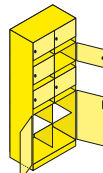

80171
80471



80172
80472

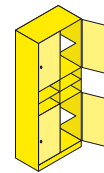

80173
80473

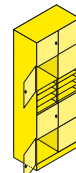

80174
80474

SYSTEM INFORMATION

Serie 80000

Cupboard types 80 cm wide (Part 1).

w/h 80x197 cm

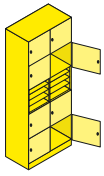

d42: 80175
d58: 80475

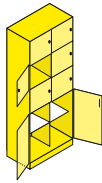

80176
80476

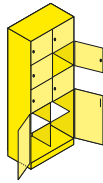

80177
80477



80178
80478

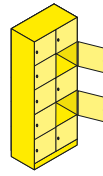

80179
80479

w/h 80x234,5 cm



80721
80771

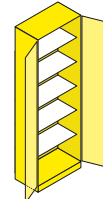

80722
80772

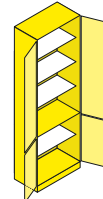

80723
80773

w/h 80x234,5 cm

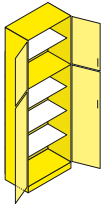

d42: 80724
d58: 80774

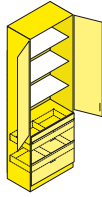

80725
80775

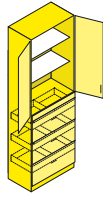

80726
80776

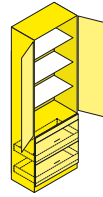

80727
80777

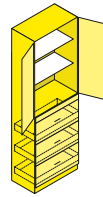

80728
80778

w/h 80x75 cm

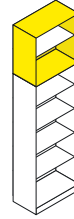

80183
80483

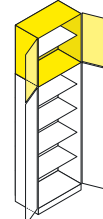

80184
80484

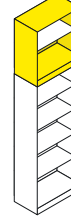

80193
80493

w/h 80x84 cm

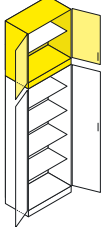

d42: 80194
d58: 80494

SYSTEM INFORMATION

Serie 80000

Cupboard types 80 cm wide (Part 2).

w/h 100x84,5 cm

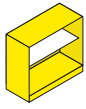

d42: 80202
d58: 80502

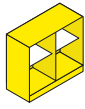

80203
80503

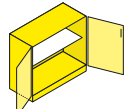

80214
80514

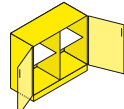

80215
80515

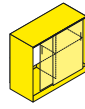

80259
80559

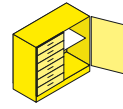

80231
80531

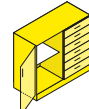

80232
80532

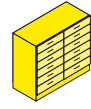

80233
80533

w/h 100x197 cm

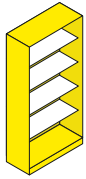

d42: 80204
d58: 80504

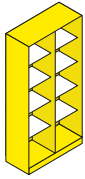

80205
80505

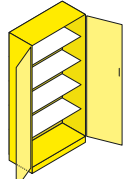

80218
80518

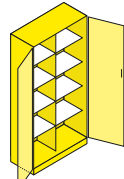

80220
80520

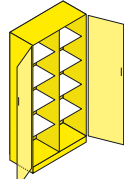

80219
80519

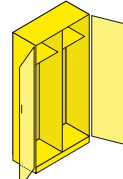

80221
80521

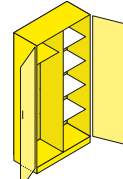

80222
80522

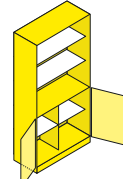

80216
80516

w/h 100x197 cm

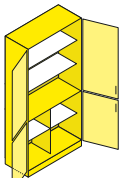

d42: 80217
d58: 80517

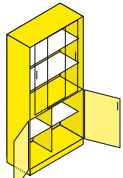

80252
80552

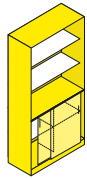

80251
80551

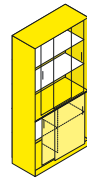

80253
80553

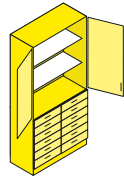

80234
80534

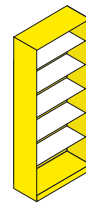

80729
80779

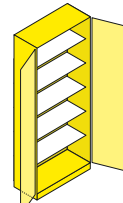

80730
80780

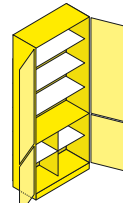

80731
80781

w/h 100x234,5 cm

w/h 100x234,5 cm w/h 100x75 cm

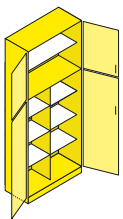

d42: 80732
d58: 80782

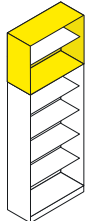

80283
80583

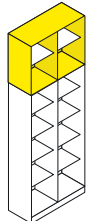

80284
80584

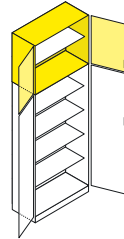

80285
80585

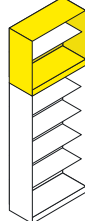

80293
80593

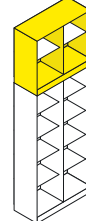

80294
80594

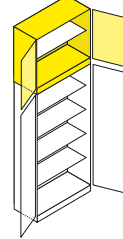

80295
80595

w/h 100x84 cm

SYSTEM INFORMATION

Serie 80000
Cupboard types 100 cm wide.

w/h 120x84,5 cm

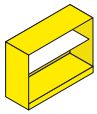

d42: 80302
d58: 80602

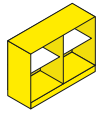

80303
80603

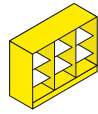

80304
80604

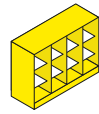

80305

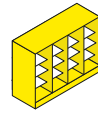

80306

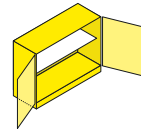

80314
80614

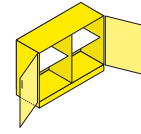

80315
80615

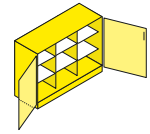

80316
80616

w/h 120x84,5 cm

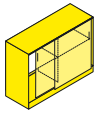

d42: 80359
d58: 80659

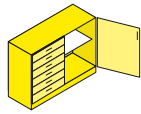

80331
80631

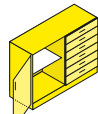

80332
80632

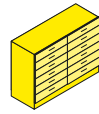

80333
80633

w/h 120x159,5 cm

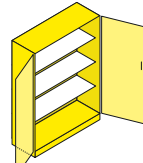

80317
80617

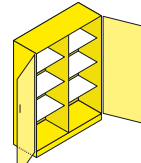

80318
80618



80307
80607

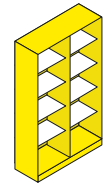

80308
80608

w/h 120x197 cm

w/h 120x197 cm

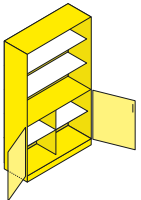

d42: 80319
d58: 80619

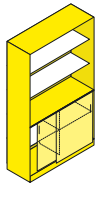

80351
80651



80320
80620

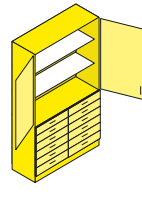

80334
80634

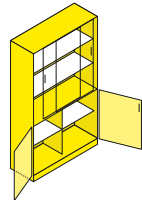

80352
80652

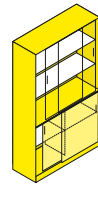

80353
80653

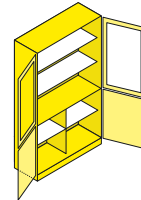

80360
80660

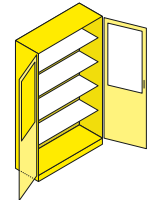

80361
80661

w/h 120x197 cm

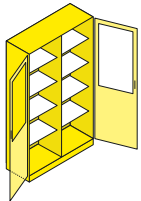

d42: 80362
d58: 80662

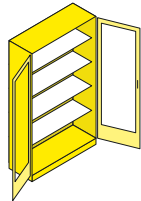

80363
80663

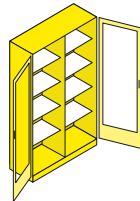

80364
80664

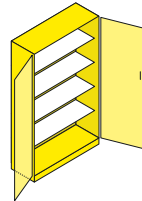

80321
80621

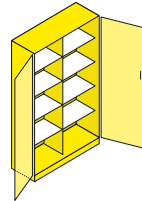

80323
80623

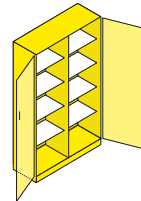

80322
80622

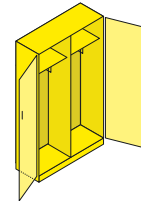

80324
80624

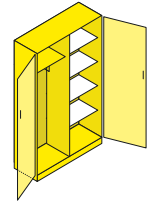

80325
80625

SYSTEM INFORMATION

Serie 80000

Cupboard types 120 cm wide (Part 1).

w/h 120x197 cm

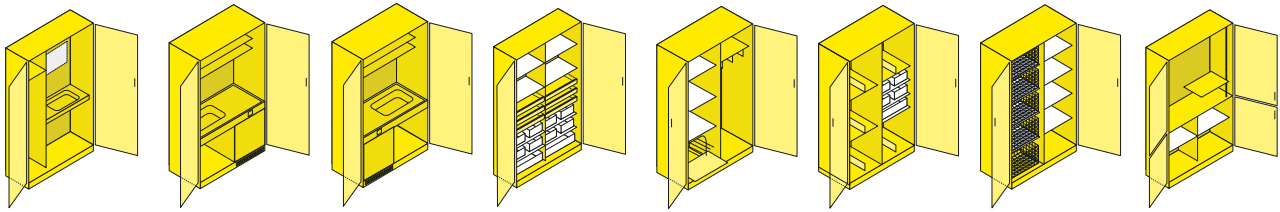

d42: 80327
d58: 80627

80677

80678

80365
80665

80673

80674

80675

80367
80667

w/h 120x197 cm

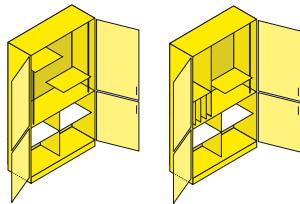

d42: 80368
d58: 80668

80369
80669

w/h 120x234,5 cm

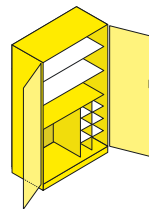

80671



80733
80783

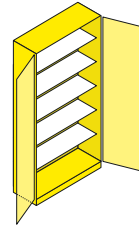

80734
80784

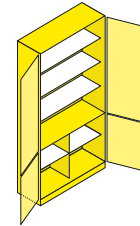

80735
80785

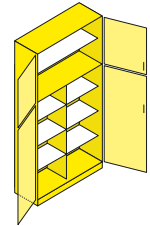

80736
80786

w/h 120x75 cm

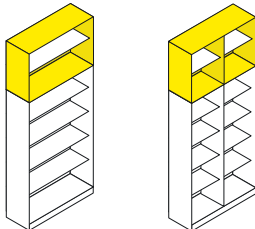

d42: 80383
d58: 80683

80384
80684

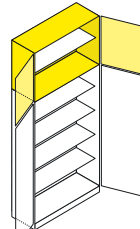

80385
80685

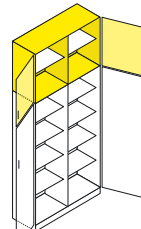

80386
80686

w/h 120x84 cm

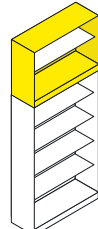

80393
80693

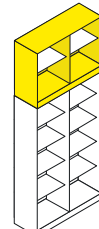

80394
80694

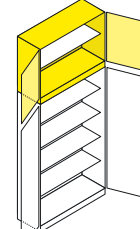

80395
80695

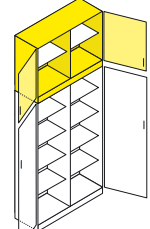

80396
80696

SYSTEM INFORMATION

Serie 80000

Cupboard types 120 cm wide (Part 2).

w/h 70x84,5 cm w/h 105x84,5 cm w/h 140x84,5 cm



d42: 80840



80841

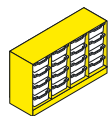

80842

w/h 60x75 cm



d33: 80820



80821

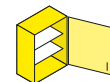

80822

w/h 80x75 cm



80800

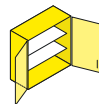

80801

SYSTEM INFORMATION

Serie 80000

Cupboard types. Special.