

# INSTALLATION INSTRUCTIONS

## Marco Acrylic Double Ended Air Bath Tub with Stainless Steel Skirt

- Install so that the security device, MANI-SD-A, is at least 2" above tub rim.

### Components List:

- BM-TWP Ball Check Valve Jets
- MANI-SD-A Security Device
- MAN-A-4-AC Manifold
- Silver SLS+ Variable Speed Blower

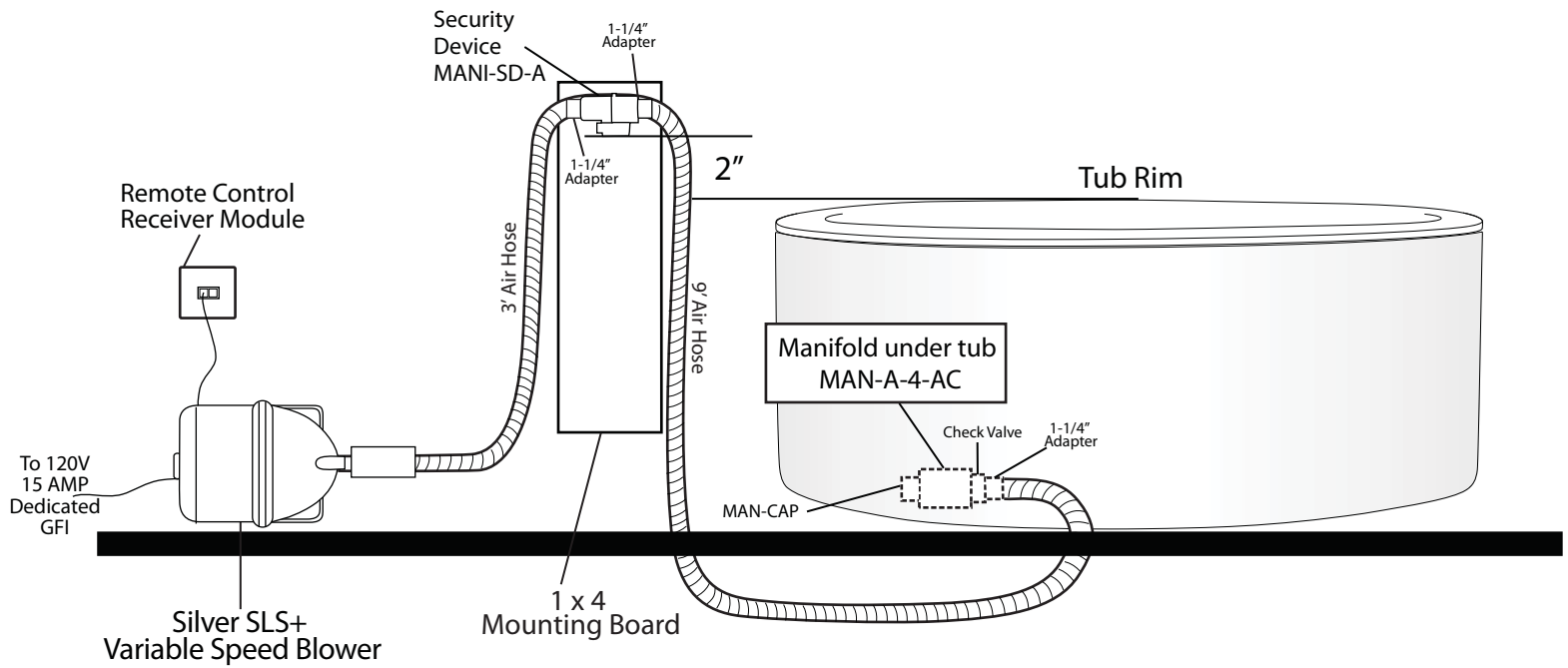

### Inside of Bath

#### Features:

- (12) Maxi Air Jets with 24 openings



Elbows for air jets



Tees for air jets

- Remote Control CG+/RTC-SENSOR-WP



12-15 year battery life

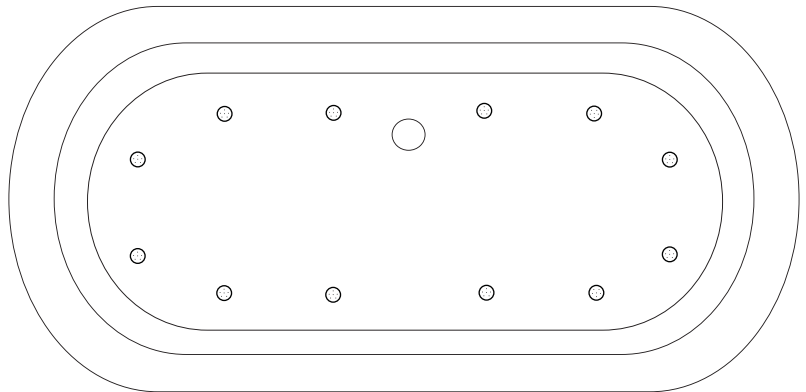

# Marco Acrylic Double Ended Air Bath Tub with Stainless Steel Skirt

Tub Dimensions: 66-1/2" L x 31-3/4" W x 24-3/4" H.

Tub Water Capacity: 58 gallons (to top of tub)

Tub Weight Uncrated: 200 lbs. Tub Weight Crated: 425 lbs

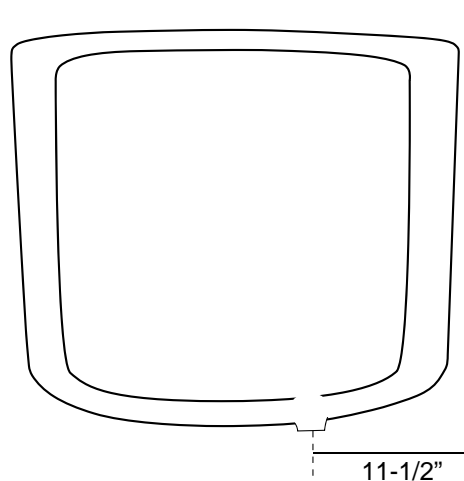
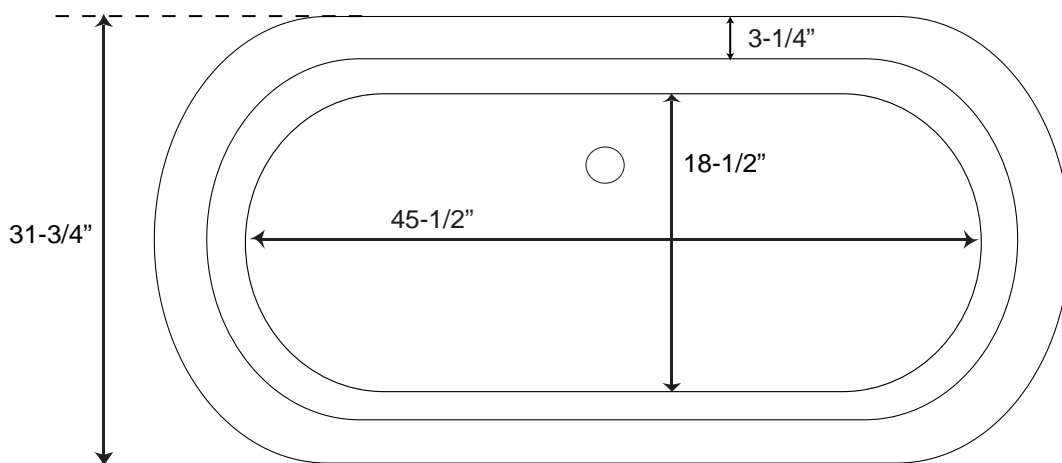
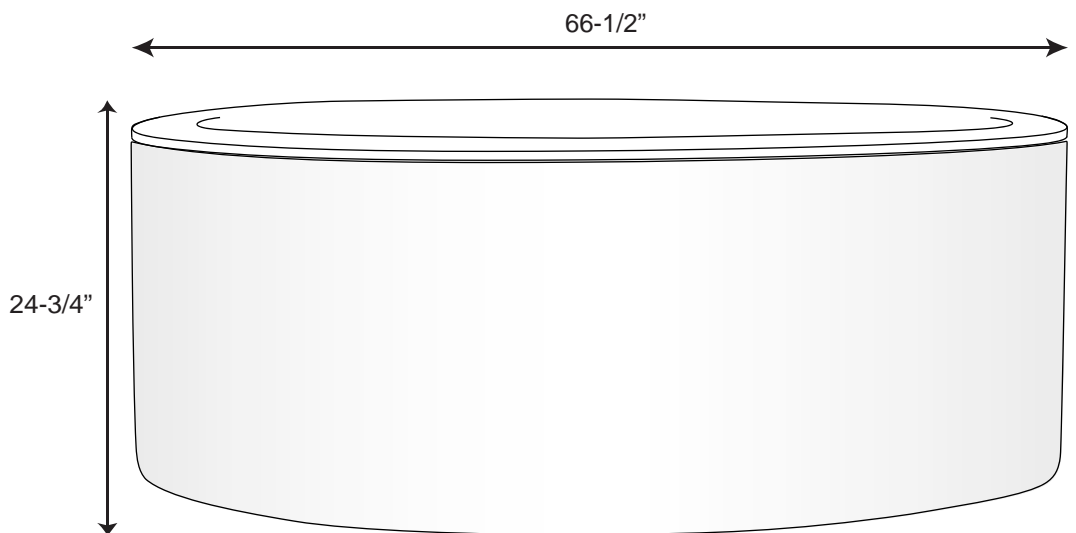

Water depth is 16" H to top of tub.  
All measurements are approximate.  
Measurements may vary +/- 1/2".