

wall mount  
**wmr™**



### features

Designed for use in Magnetic Resonance Imaging rooms (MRI).

Housing and diffuser constructed with non-ferrous aluminum.

Perforated lamp shield detaches easily for relamping.

All luminaires are provided with a 75 watt, T10 halogen frosted lamp.

T10 halogen lamp design is a proven solution to lamp breakage which commonly occurs in incandescent lamps due to filament vibration in the magnetic field.

ADA compliant wall sconce that compliments entire MRI family.

### dimensional data

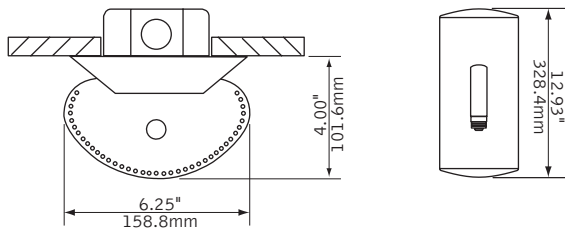

### lamping options



75W T10 HALOGEN LAMP

### performance

1-Lamp T10 Halogen  
69% Efficiency  
150 cd @ 0°

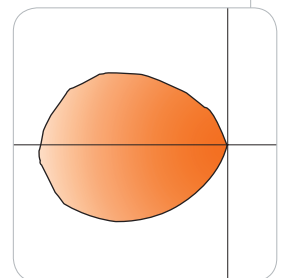

Visit [focalpointlights.com](http://focalpointlights.com) for complete photometric data.

July 2008

fixture:  
project:

### mounting information

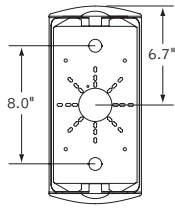

### specifications

#### construction

One-piece 20 Ga. aluminum reflector and housing.  
Lamps are shielded by detachable 22 Ga. aluminum perforated lamp shield with Valox® lens insert.  
Die-cast aluminum end caps complete shield assembly.

1' unit weight: 4 lbs.

#### optic

20 Ga. aluminum reflector finished in High Temperature Matte White powder coat.

#### electrical

Porcelain body lamp holder with aluminum and copper components.  
Thermal protector included.  
UL and cUL listed.

#### finish

Polyester powder coat applied over a 5-stage pre-treatment.  
Standard luminaire housing finished in High Temperature Matte White.

### ordering

luminaire series		<u>FWMR</u>
WMR Sconce	FWMR	
<b>profile</b>		<u>1</u>
1' Length	1	
<b>material</b>		<u>A</u>
Aluminum (Non-ferrous components)	A	
<b>lamp quantity</b>		<u>1</u>
One Lamp	1	
<b>lamp type</b>		<u>75T10</u>
75W T10 (Includes frosted 75w T10 halogen lamp. 75 watt max.)	75T10	
<b>voltage</b>		<u>120</u>
120 Volt	120	
<b>mounting</b>		<u>WM</u>
Wall Mount	WM	
<b>shielding</b>		<u>PS</u>
Perforated Shield	PS	
<b>finish</b>		<u>WT</u>
High Temperature Matte White	WT	

\* for more information see Reference section.

wmr™

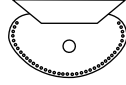

Filename: FWMR1175T10.IES  
 Catalog #: FWMR-1-A-75T10-120-WM-WT  
 Efficiency: 69%  
 Test #: 12016.2

CANDLEPOWER DISTRIBUTION

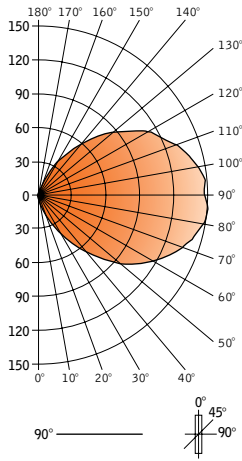

Vertical Angle	Horizontal Angle				Zonal Lumens
	0°	22.5°	45°	67.5°	
0°	0	0	0	0	0
5°	0	0	0	0	0
15°	8	8	7	7	5
25°	25	23	20	17	15
35°	53	50	42	33	27
45°	80	77	63	50	42
55°	105	102	85	68	53
65°	127	122	105	80	65
75°	142	135	117	92	73
85°	150	145	123	98	77
90°	147	143	122	95	77
95°	148	142	122	94	75
105°	137	133	113	90	70
115°	120	117	100	80	63
125°	98	95	80	62	53
135°	73	70	58	48	40
145°	43	45	38	32	28
155°	23	23	20	17	17
165°	8	8	7	8	8
175°	0	0	2	0	0
180°	0	0	0	0	0

LUMEN SUMMARY

	Zone Lumens	% Lamp	% Fixt
	0°-30°	8	1.2
	0°-90°	364	50
	90°-130°	301	41.3
	90°-180°	364	50
<b>Total Luminaire</b>	<b>0°-180°</b>	<b>728</b>	<b>100.0</b>