



DF 260 760

fully integrated

Appliance height 32 1/16"

DF 261 760

fully integrated

Appliance height 34 1/16"

Included accessories

1 baking tray spray head

Optional accessories

DA 020 010

Stainless steel trim kit for DF 260

DA 020 110

Stainless steel trim kit for DF 261

DA 021 000

Folding hinge for all fully integrated dishwashers

DA 041 060

Flex Plus drawers for 14 place settings, include pull-out rails

DA 042 030

Sterling silver cutlery cassette

DA 043 060

Long stemware basket

DA 231 010

Stainless steel-backed full glass door as door panel for DF 260 dishwasher, handle included

DA 231 030

Aluminum-backed full glass door as door panel for DF 260 dishwasher, handle included

DA 231 110

Stainless steel-backed full glass door as door panel for DF 261 dishwasher, handle included

DA 231 130

Aluminum-backed full glass door as door panel for DF 261 dishwasher, handle included

GH 045 010

Handle bar with 2 mounts, stainless steel, for custom panel length 17 11/16", drilling distance 16 13/16"

GH 045 030

Handle bar with 2 mounts, aluminium, for custom panel length 17 11/16", drilling distance 16 13/16"

GZ 010 011

Aqua stop extension (19" long) for all dishwashers

Dishwasher

DF 260/DF 261

- **Power dishwasher:** dishes clean and dry in 59 minutes
- **Six programs with Aqua sensor and two additional program options**
- **Flex Plus basket system, extra extendable and smooth running**
- **Glasscare technology**
- **Very quiet: 41 dB**
- **Energy Star® qualified**
- **Aqua stop**

Handling

Touch key operation.

Display with time remaining indicator.

Electronic refill indicator for rinsing agent in the control panel.

Inflow water indicator.

Info-Light.

End of program indicator.

Time delay up to 24 hours.

Features

Glass care technology.

Aqua sensor.

Load sensor.

Aqua stop.

Dosage Assist.

Automatic detergent function.

Water softener.

Flow-through water heater.

Soft lock.

Triple filter system, self-cleaning.

Child lock.

Programs

6 programs:

Auto 149°F - 167°F

Auto 113°F - 149°F

Auto 95°F - 113°F

Standard Eco 122°F

Quick wash 113°F (29 min)

Rinse and hold

2 Options:

Power Boost

Intensive Wash

Features

Flex Plus drawer:

For 14 place settings

Flex Plus upper basket:

Extra-extendable.

Smooth running.

Rackmatic with 3 levels, adjustable in height up to 2".

6 folding tines.

4 folding racks.

2 long stemware support bars.

Flex Plus lower basket:

Dividable glass support.

6 folding tines.

2 folding racks.

Cutlery basket.

Maximum dish sizes

(upper/lower basket)

10 5/8"/9 13/16", 9 5/8"/10 13/16"

resp. 22/30 cm.

13 place setting capacity.

Planning notes

Height-adjustable feet.

Rear toe kick protrusion 3 15/16".

Rear feet adjustable at front.

Door weight up to 21 lbs.

Door panel dimension dependant on toe kick height of kitchen cabinets.

Installation possible in tall unit.

Connecting cable plugable.

Water connection with 3/4" screw joint.

Length of connection cable, water in- and outlet see detailed drawing, page 139.

Please read further planning notes on pages 136–138.

Product rating

usage: 2.6 gallons of water.

min. consumption: 0.97 kwh.

Noise level 41 dB

Total connected load 2.3 kW.

120 V / 60 Hz

Total Amps: 12

Euro Tub dishwasher

DF 260

Toe kick height

- $3 \frac{9}{16}" - 6 \frac{5}{16}"$ for a height of $32 \frac{1}{16}"$
- $5 \frac{7}{8}" - 8 \frac{11}{16}"$ for a height of $34 \frac{7}{16}"$

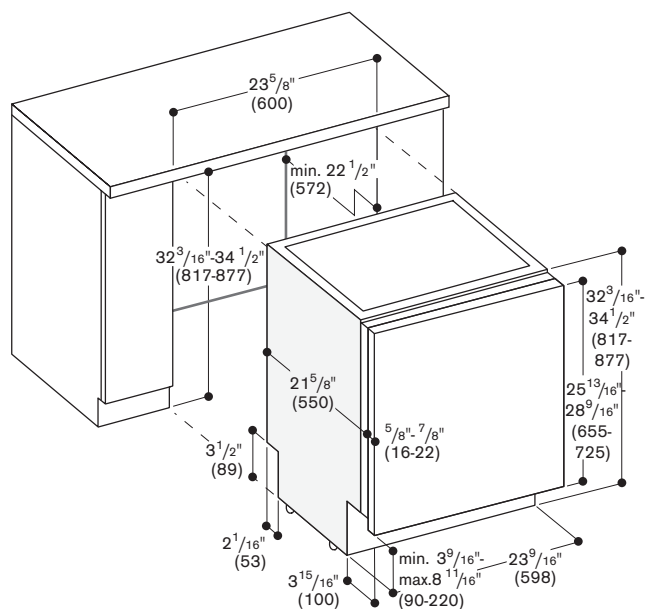

Tall Tub dishwasher

DF 261

Toe kick height

- $3 \frac{9}{16}" - 6 \frac{5}{16}"$ for a height of $34 \frac{1}{16}"$
- $5 \frac{7}{8}" - 8 \frac{11}{16}"$ for a height of $36 \frac{9}{16}"$

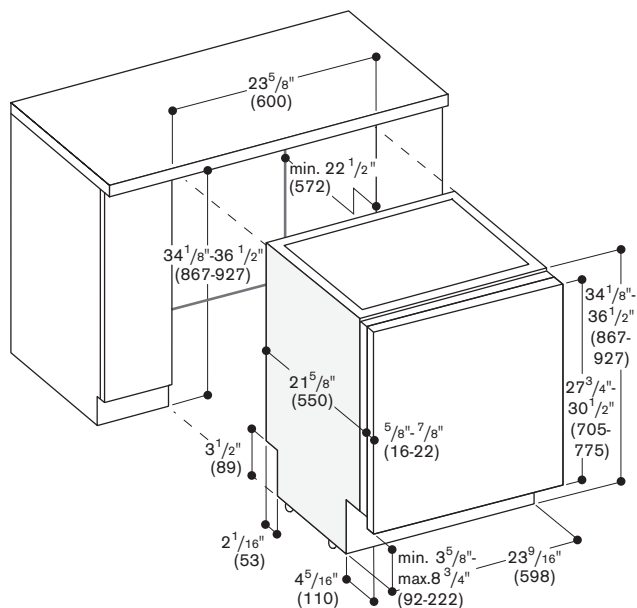

Numbers indicated
inside parenthesis () = mm



Dishwasher cut-out combinations

When under-counter height of 31 7/8" to 33 7/16"
always plan a Euro tub dishwasher, regardless of the toe kick height.

When under-counter height of 34 5/8" to 36 1/4"
always plan a tall tub dishwasher, regardless of the toe kick height.

When under-counter height of 33 7/8" to 34 1/4"
please note: whether to plan a Euro tub or tall tub dishwasher depends on the toe kick height.

See table below.

Example with 34 1/4" cut-out height:

When toe kick height is between 6 11/16" and 8 11/16" always plan a Euro tub dishwasher (DF 260).

When toe kick height of 3 15/16" to 5 7/8", always plan a tall tub dishwasher (DF 261, DF 251).

When toe kick height is between 5 7/8" to 6 11/16", both heights of the dishwasher can be planned alternatively.

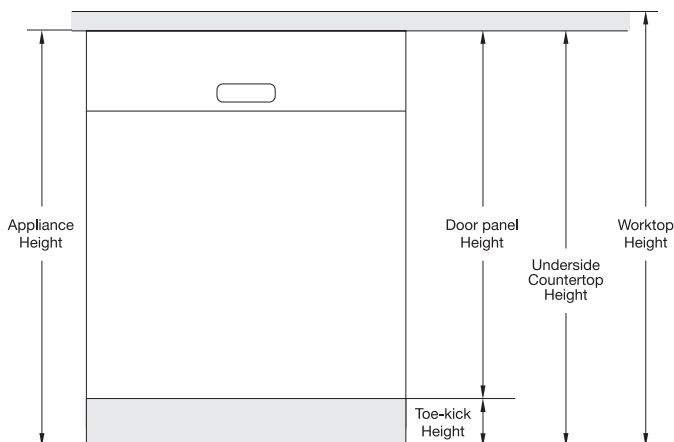

Toe kick height in inches	Underside countertop height											
	32 1/16"	32 1/2"	32 7/8"	33 1/4"	33 11/16"	34 1/16"	34 7/16"	34 13/16"	35 1/4"	35 5/8"	36"	36 7/16"
<3 9/16"	1 (S)	1 (S)	1 (S)	1 (S)	1 (S)	1 6	1 6 (S)	6 (S)	6 (S)	6 (S)	6 (S)	6 (S)
3 9/16"	1	1 (S/D)	1 (S)	1 (S)	1 (S)	1 (S) 6	1 (S) 6 (S/D)	6 (S)	6 (S)	6 (S)	6 (S)	6 (S)
3 15/16"	1	1	1 (S/D)	1 (S)	1 (S)	1 (S) 6	1 (S) 6	6 (S/D)	6 (S)	6 (S)	6 (S)	6 (S)
4 5/16"	1	1	1	1 (S/D)	1 (S)	1 (S) 6	1 (S) 6	6	6 (S/D)	6 (S)	6 (S)	6 (S)
4 3/4"	1	1	1	1	1 (S/D)	1 (S) 6	1 (S) 6	6	6	6 (S/D)	6 (S)	6 (S)
5 1/8"	1	1	1	1	1	1 (S/D) 6	1 (S) 6	6	6	6	6 (S/D)	6 (S)
5 1/2"	1	1	1	1	1	1 (S) 6	1 (S/D) 6	6	6	6	6	6 (S/D)
5 7/8"	1	1	1	1	1	1 (S) 6	1 (S) 6	6	6	6	6	6
6 5/16"	1	1	1	1	1	1 (S) 6	1 (S) 6	6	6	6	6	6
6 11/16"		1	1	1	1	1	1 (S) 6	6	6	6	6	6
7 1/16"			1	1	1	1	1	6	6	6	6	6
7 1/2"				1	1	1	1		6	6	6	6
7 7/8"					1	1	1			6	6	6
8 1/4"						1	1				6	6
8 11/16"							1					6

1 = Euro tub dishwasher DF 260, (S) = special solution

6 = Tall tub dishwasher DF 251, DF 261, (S) = special solution

(S) = special solution with folding hinge (DA 021 000) / divided kitchen cabinet door

(D) = special solution with 3/8" gap from the worktop → Spacer batten / child lock not possible

Installation chart for door panel DA 231

Cabinet height 26 3/8" – 28 3/8" 1

Cabinet height 28 3/8" – 30 5/16" 6

Note:

The door panel is continuously variable for height over a range of 2".

Toe kick height in inches	Underside countertop height											
	32 1/16"	32 1/2"	32 7/8"	33 1/4"	33 11/16"	34 1/16"	34 7/16"	34 13/16"	35 1/4"	35 5/8"	36"	36 7/16"
3 3/4"	1						6					
4 1/8"	1	1					6	6				
4 1/2"	1	1	1				6	6	6			
4 15/16"	1	1	1	1			6	6	6			
5 5/16"	1	1	1	1	1		6	6	6	6		
5 11/16"	1	1	1	1	1	1 6	6	6	6	6	6	
6 1/8"		1	1	1	1	1	1 6	6	6	6	6	6
6 1/2"			1	1	1	1	6	6	6	6	6	6
6 7/8"				1	1	1	6		6	6	6	6
7 5/16"					1	1	6			6	6	6
7 11/16"						1	6				6	6
8 1/16"							6					6
8 7/16"												
8 7/8"												

1 = Euro tub dishwasher, door panels DA 231 010/030

6 = Tall tub dishwasher, door panels DA 231 110/130

Dishwasher installation above countertop level
without a slanted drawer panel

The table indicates the necessary gap size D (inches) between the cabinet front and the drawer panel in relation to the niche height, toe kick height and panel thickness when using standard cabinetry for built-under dishwashers.

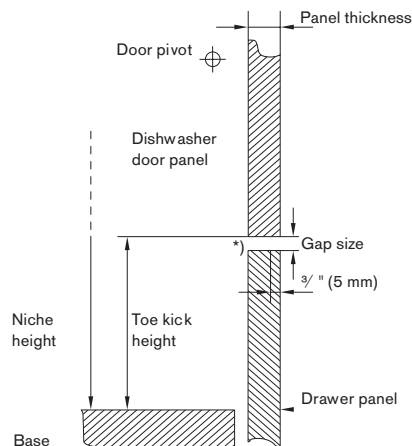

* The pivot area of the door should be at least 3/8" (4 mm) .

Niche height A (inches)	Panel thickness (inches)	Toe kick C (inches)									
		3 9/16"	3 15/16"	4 5/16"	4 3/4"	5 1/8"	5 1/2"	5 7/8"	6 5/16"	6 11/16"	
31 7/8"	5/8"	3/8"	3/8"	3/8"	7/16"	1/2"	9/16"	5/8"	13/16"		
	3/4"	3/8"	7/16"	7/16"	1/2"	9/16"	5/8"	3/4"	7/8"		
	7/8"	7/16"	1/2"	1/2"	9/16"	5/8"	11/16"	13/16"	1"		
32 5/16"	5/8"	3/8"	3/8"	3/8"	7/16"	1/2"	9/16"	5/8"	13/16"		
	3/4"	3/8"	7/16"	7/16"	1/2"	9/16"	5/8"	3/4"	7/8"		
	7/8"	7/16"	1/2"	1/2"	9/16"	5/8"	11/16"	13/16"	1"		
32 11/16"	5/8"	3/8"	3/8"	3/8"	7/16"	1/2"	9/16"	5/8"	13/16"		
	3/4"	3/8"	7/16"	7/16"	1/2"	9/16"	5/8"	3/4"	7/8"		
	7/8"	7/16"	1/2"	1/2"	9/16"	5/8"	11/16"	13/16"	1"		
33 1/16"	5/8"	3/8"	3/8"	3/8"	7/16"	1/2"	9/16"	5/8"	13/16"		
	3/4"	3/8"	7/16"	7/16"	1/2"	9/16"	5/8"	3/4"	7/8"		
	7/8"	7/16"	1/2"	1/2"	9/16"	5/8"	11/16"	13/16"	1"		
33 7/16"	5/8"	3/8"	3/8"	3/8"	7/16"	1/2"	9/16"	5/8"	13/16"		
	3/4"	3/8"	7/16"	7/16"	1/2"	9/16"	5/8"	3/4"	7/8"		
	7/8"	7/16"	1/2"	1/2"	9/16"	5/8"	11/16"	13/16"	1"		
33 7/8"	5/8"	3/8"	3/8"	3/8"	7/16"	1/2"	9/16"	5/8"	13/16"		
	3/4"	3/8"	7/16"	7/16"	1/2"	9/16"	5/8"	3/4"	7/8"		
	7/8"	7/16"	1/2"	1/2"	9/16"	5/8"	11/16"	13/16"	1"		
34 1/4"	5/8"	3/8"	3/8"	3/8"	7/16"	1/2"	9/16"	5/8"	13/16"		
	3/4"	3/8"	7/16"	7/16"	1/2"	9/16"	5/8"	3/4"	7/8"		
	7/8"	7/16"	1/2"	1/2"	9/16"	5/8"	11/16"	13/16"	1"		
34 5/8"	5/8"	3/8"	3/8"	3/8"	7/16"	1/2"	9/16"	5/8"	13/16"		
	3/4"	3/8"	7/16"	7/16"	1/2"	9/16"	5/8"	3/4"	7/8"		
	7/8"	7/16"	1/2"	1/2"	9/16"	5/8"	11/16"	13/16"	1"		
35 1/16"	5/8"	3/8"	3/8"	3/8"	7/16"	1/2"	9/16"	5/8"	13/16"		
	3/4"	3/8"	7/16"	7/16"	1/2"	9/16"	5/8"	3/4"	7/8"		
	7/8"	7/16"	1/2"	1/2"	9/16"	5/8"	11/16"	13/16"	1"		
35 7/16"	5/8"	3/8"	3/8"	3/8"	7/16"	1/2"	9/16"	5/8"	13/16"		
	3/4"	3/8"	7/16"	7/16"	1/2"	9/16"	5/8"	3/4"	7/8"		
	7/8"	7/16"	1/2"	1/2"	9/16"	5/8"	11/16"	13/16"	1"		
35 13/16"	5/8"	3/8"	3/8"	3/8"	7/16"	1/2"	9/16"	5/8"	13/16"		
	3/4"	3/8"	7/16"	7/16"	1/2"	9/16"	5/8"	3/4"	7/8"		
	7/8"	7/16"	1/2"	1/2"	9/16"	5/8"	11/16"	13/16"	1"		
36 1/4"	5/8"	3/8"	3/8"	3/8"	7/16"	1/2"	9/16"	5/8"	13/16"		
	3/4"	3/8"	7/16"	7/16"	1/2"	9/16"	5/8"	3/4"	7/8"		
	7/8"	7/16"	1/2"	1/2"	9/16"	5/8"	11/16"	13/16"	1"		

Dishwasher cut-out combinations

Dishwasher installation above countertop level with slanted drawer panel

The table indicates the necessary gap size D (inches) between the cabinet front and the drawer panel in relation to the niche height, toe kick height and panel thickness when using standard cabinetry for built-under dishwashers.

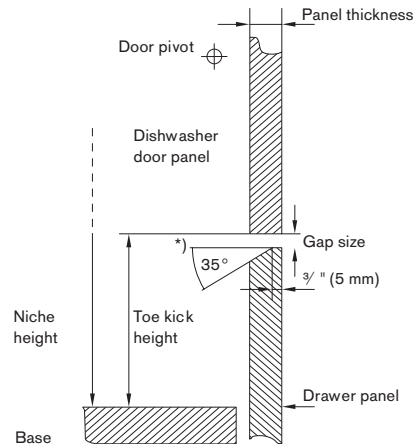

* The pivot area of the door should be at least $\frac{3}{8}$ " (4 mm).

Niche height A (inches)	Panel thickness (inches)	Toe kick height C (inches)									
		$\frac{3^9}{16}$ "	$\frac{3^{15}}{16}$ "	$\frac{4^5}{16}$ "	$\frac{4^3}{4}$ "	$\frac{5^1}{8}$ "	$\frac{5^1}{2}$ "	$\frac{5^7}{8}$ "	$\frac{6^5}{16}$ "	$\frac{6^{11}}{16}$ "	
$31\frac{7}{8}$ "	$\frac{5}{8}$ "	$\frac{1}{4}$ "	$\frac{1}{4}$ "	$\frac{1}{4}$ "	$\frac{1}{4}$ "	$\frac{5}{16}$ "	$\frac{5}{16}$ "	$\frac{3}{8}$ "	$\frac{1}{2}$ "		
	$\frac{3}{4}$ "	$\frac{1}{4}$ "	$\frac{1}{4}$ "	$\frac{1}{4}$ "	$\frac{5}{16}$ "	$\frac{5}{16}$ "	$\frac{3}{8}$ "	$\frac{7}{16}$ "	$\frac{9}{16}$ "		
	$\frac{7}{8}$ "	$\frac{1}{4}$ "	$\frac{1}{4}$ "	$\frac{1}{4}$ "	$\frac{5}{16}$ "	$\frac{5}{16}$ "	$\frac{3}{8}$ "	$\frac{7}{16}$ "	$\frac{9}{16}$ "		
$32\frac{5}{16}$ "	$\frac{5}{8}$ "		$\frac{1}{4}$ "	$\frac{1}{4}$ "	$\frac{1}{4}$ "	$\frac{1}{4}$ "	$\frac{5}{16}$ "	$\frac{5}{16}$ "	$\frac{3}{8}$ "	$\frac{1}{2}$ "	
	$\frac{3}{4}$ "		$\frac{1}{4}$ "	$\frac{1}{4}$ "	$\frac{1}{4}$ "	$\frac{5}{16}$ "	$\frac{5}{16}$ "	$\frac{3}{8}$ "	$\frac{7}{16}$ "	$\frac{9}{16}$ "	
	$\frac{7}{8}$ "		$\frac{1}{4}$ "	$\frac{1}{4}$ "	$\frac{1}{4}$ "	$\frac{5}{16}$ "	$\frac{5}{16}$ "	$\frac{3}{8}$ "	$\frac{7}{16}$ "	$\frac{9}{16}$ "	
$32\frac{11}{16}$ "	$\frac{5}{8}$ "			$\frac{1}{4}$ "	$\frac{1}{4}$ "	$\frac{1}{4}$ "	$\frac{1}{4}$ "	$\frac{5}{16}$ "	$\frac{5}{16}$ "	$\frac{3}{8}$ "	$\frac{1}{2}$ "
	$\frac{3}{4}$ "			$\frac{1}{4}$ "	$\frac{1}{4}$ "	$\frac{1}{4}$ "	$\frac{5}{16}$ "	$\frac{5}{16}$ "	$\frac{3}{8}$ "	$\frac{7}{16}$ "	$\frac{9}{16}$ "
	$\frac{7}{8}$ "			$\frac{1}{4}$ "	$\frac{1}{4}$ "	$\frac{1}{4}$ "	$\frac{5}{16}$ "	$\frac{5}{16}$ "	$\frac{3}{8}$ "	$\frac{7}{16}$ "	$\frac{9}{16}$ "
$33\frac{1}{16}$ "	$\frac{5}{8}$ "				$\frac{1}{4}$ "	$\frac{1}{4}$ "	$\frac{1}{4}$ "	$\frac{1}{4}$ "	$\frac{5}{16}$ "	$\frac{5}{16}$ "	$\frac{3}{8}$ "
	$\frac{3}{4}$ "				$\frac{1}{4}$ "	$\frac{1}{4}$ "	$\frac{1}{4}$ "	$\frac{1}{4}$ "	$\frac{5}{16}$ "	$\frac{5}{16}$ "	$\frac{3}{8}$ "
	$\frac{7}{8}$ "				$\frac{1}{4}$ "	$\frac{1}{4}$ "	$\frac{1}{4}$ "	$\frac{1}{4}$ "	$\frac{5}{16}$ "	$\frac{5}{16}$ "	$\frac{3}{8}$ "
$33\frac{7}{16}$ "	$\frac{5}{8}$ "					$\frac{1}{4}$ "	$\frac{1}{4}$ "	$\frac{1}{4}$ "	$\frac{1}{4}$ "	$\frac{5}{16}$ "	$\frac{3}{8}$ "
	$\frac{3}{4}$ "					$\frac{1}{4}$ "	$\frac{1}{4}$ "	$\frac{1}{4}$ "	$\frac{1}{4}$ "	$\frac{5}{16}$ "	$\frac{3}{8}$ "
	$\frac{7}{8}$ "					$\frac{1}{4}$ "	$\frac{1}{4}$ "	$\frac{1}{4}$ "	$\frac{1}{4}$ "	$\frac{5}{16}$ "	$\frac{3}{8}$ "
$33\frac{7}{8}$ "	$\frac{5}{8}$ "	$\frac{1}{4}$ "	$\frac{1}{4}$ "	$\frac{1}{4}$ "	$\frac{1}{4}$ "	$\frac{5}{16}$ "	$\frac{5}{16}$ "	$\frac{3}{8}$ "	$\frac{1}{2}$ "		
	$\frac{3}{4}$ "	$\frac{1}{4}$ "	$\frac{1}{4}$ "	$\frac{1}{4}$ "	$\frac{5}{16}$ "	$\frac{5}{16}$ "	$\frac{3}{8}$ "	$\frac{7}{16}$ "	$\frac{9}{16}$ "		
	$\frac{7}{8}$ "	$\frac{1}{4}$ "	$\frac{1}{4}$ "	$\frac{1}{4}$ "	$\frac{5}{16}$ "	$\frac{5}{16}$ "	$\frac{3}{8}$ "	$\frac{7}{16}$ "	$\frac{9}{16}$ "		
$34\frac{1}{4}$ "	$\frac{5}{8}$ "		$\frac{1}{4}$ "	$\frac{1}{4}$ "	$\frac{1}{4}$ "	$\frac{1}{4}$ "	$\frac{5}{16}$ "	$\frac{5}{16}$ "	$\frac{3}{8}$ "	$\frac{1}{2}$ "	
	$\frac{3}{4}$ "		$\frac{1}{4}$ "	$\frac{1}{4}$ "	$\frac{1}{4}$ "	$\frac{5}{16}$ "	$\frac{5}{16}$ "	$\frac{3}{8}$ "	$\frac{7}{16}$ "	$\frac{9}{16}$ "	
	$\frac{7}{8}$ "		$\frac{1}{4}$ "	$\frac{1}{4}$ "	$\frac{1}{4}$ "	$\frac{5}{16}$ "	$\frac{5}{16}$ "	$\frac{3}{8}$ "	$\frac{7}{16}$ "	$\frac{9}{16}$ "	
$34\frac{5}{8}$ "	$\frac{5}{8}$ "			$\frac{1}{4}$ "	$\frac{1}{4}$ "	$\frac{1}{4}$ "	$\frac{1}{4}$ "	$\frac{5}{16}$ "	$\frac{5}{16}$ "	$\frac{3}{8}$ "	$\frac{1}{2}$ "
	$\frac{3}{4}$ "			$\frac{1}{4}$ "	$\frac{1}{4}$ "	$\frac{1}{4}$ "	$\frac{5}{16}$ "	$\frac{5}{16}$ "	$\frac{3}{8}$ "	$\frac{7}{16}$ "	$\frac{9}{16}$ "
	$\frac{7}{8}$ "			$\frac{1}{4}$ "	$\frac{1}{4}$ "	$\frac{1}{4}$ "	$\frac{5}{16}$ "	$\frac{5}{16}$ "	$\frac{3}{8}$ "	$\frac{7}{16}$ "	$\frac{9}{16}$ "
$35\frac{1}{16}$ "	$\frac{5}{8}$ "				$\frac{1}{4}$ "	$\frac{1}{4}$ "	$\frac{1}{4}$ "	$\frac{1}{4}$ "	$\frac{5}{16}$ "	$\frac{5}{16}$ "	$\frac{3}{8}$ "
	$\frac{3}{4}$ "				$\frac{1}{4}$ "	$\frac{1}{4}$ "	$\frac{1}{4}$ "	$\frac{1}{4}$ "	$\frac{5}{16}$ "	$\frac{5}{16}$ "	$\frac{3}{8}$ "
	$\frac{7}{8}$ "				$\frac{1}{4}$ "	$\frac{1}{4}$ "	$\frac{1}{4}$ "	$\frac{5}{16}$ "	$\frac{5}{16}$ "	$\frac{3}{8}$ "	$\frac{1}{2}$ "
$35\frac{7}{16}$ "	$\frac{5}{8}$ "					$\frac{1}{4}$ "	$\frac{1}{4}$ "	$\frac{1}{4}$ "	$\frac{1}{4}$ "	$\frac{5}{16}$ "	$\frac{3}{8}$ "
	$\frac{3}{4}$ "					$\frac{1}{4}$ "	$\frac{1}{4}$ "	$\frac{1}{4}$ "	$\frac{1}{4}$ "	$\frac{5}{16}$ "	$\frac{3}{8}$ "
	$\frac{7}{8}$ "					$\frac{1}{4}$ "	$\frac{1}{4}$ "	$\frac{1}{4}$ "	$\frac{1}{4}$ "	$\frac{5}{16}$ "	$\frac{3}{8}$ "
$35\frac{13}{16}$ "	$\frac{5}{8}$ "						$\frac{1}{4}$ "	$\frac{1}{4}$ "	$\frac{1}{4}$ "	$\frac{1}{4}$ "	$\frac{5}{16}$ "
	$\frac{3}{4}$ "						$\frac{1}{4}$ "	$\frac{1}{4}$ "	$\frac{1}{4}$ "	$\frac{1}{4}$ "	$\frac{5}{16}$ "
	$\frac{7}{8}$ "						$\frac{1}{4}$ "	$\frac{1}{4}$ "	$\frac{1}{4}$ "	$\frac{1}{4}$ "	$\frac{5}{16}$ "
$36\frac{1}{4}$ "	$\frac{5}{8}$ "							$\frac{1}{4}$ "	$\frac{1}{4}$ "	$\frac{1}{4}$ "	$\frac{5}{16}$ "
	$\frac{3}{4}$ "							$\frac{1}{4}$ "	$\frac{1}{4}$ "	$\frac{1}{4}$ "	$\frac{5}{16}$ "
	$\frac{7}{8}$ "							$\frac{1}{4}$ "	$\frac{1}{4}$ "	$\frac{1}{4}$ "	$\frac{5}{16}$ "

Flex Plus baskets

Included in all automatic dishwashers.

Flex Plus upper basket

Flex Plus upper and bottom basket for more flexibility and convenience while loading and unloading the dishwasher.

Two dividable folding tines, two foldable glass holders, and two foldable knife holders. With smooth running fully extendable pull-out rack, and Rackmatic (adjustable height 2") plus basket handle for easier movement of top basket.

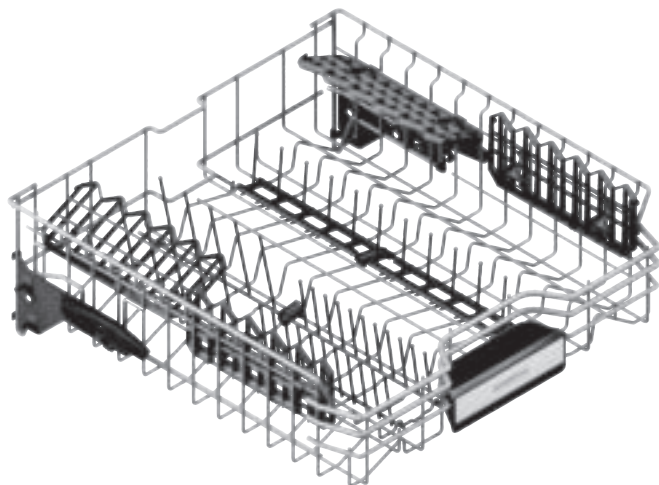

Flex Plus lower basket

Two folding tines in the front. In the back two dividable glass holders. Dividable duo cutlery basket, flexible to be placed in top or bottom basket. Basket handle for easier movement of bottom basket.



Flex Plus drawer

Additional third loading level above the Flex Plus top basket. Also suitable for large pieces of cutlery, cooking utensils and espresso cups. 14 place setting capacity with all 3 levels.



DA 043 060
Long stemware basket



DA 043 060
Special glass basket to prevent tipping of cups or long stemmed glasses in 24" deep dishwashers. Fold the folding tines in the bottom basket down to place glass basket.

Holds max. 12 long stemmed glasses or 24 cups.

Glass basket in silver with four cup holders.

W x H x D in inches:
19 5/16" x 13 3/8" x 10 1/4"

DA 042 030
Sterling silver cutlery cassette.



DA 042 030
Aluminum silver care cassette to protect corrosion of silver cutlery. Easy placement of cartridge in the cutlery basket.

W x H x D in inches:
2 1/16" x 8 9/16" x 1 7/8"

DA 231 010
Stainless steel-backed full glass door panel with handle as door panel for Euro tub dishwasher.
Height-adjustable by 2".

DA 231 110
Stainless steel-backed full glass door panel with handle as door panel for tall tub dishwasher.
Height-adjustable by 2".

DA 231 030
Aluminum-backed full glass door as door panel with handle for Euro tub dishwasher.
Height-adjustable by 2".

DA 231 130
Aluminum-backed full glass door as door panel with handle for tall tub dishwasher.
Height-adjustable by 2".



DA 231 010/110/030/130
W x D : 23 1/4" x 3/4"
Handle:
W x D x diameter:
17 11/16" x 1 15/16" x 9/16"
DA 231 010 and DA 231 030:
Height 26 3/8" x 28 5/16"
DA 231 110 and DA 231 030:
Height 28 3/8" – 30 1/4"

DA 020 010
Stainless steel trim kit
Euro tub dishwasher
DA 020 110
Stainless steel trim kit
Tall tub dishwasher

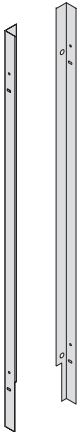

DA 020 010/DA 020 110
Trim kit with two stainless steel connection strips to cover the gap between niche and adjacent furniture and to mount the dishwasher in the niche.

The white corner support is replaced by a stainless steel trim kit.

Two connection strips, one each for both right and left.

W x D in inches: 7/8" x 13/16"
DA 020 010:
24 3/16" height.
DA 020 110:
26 3/16" height.

Numbers indicated
inside parenthesis () = mm

Optional accessories

DA 021 000
Folding hinge
For all fully integrated dishwashers.

DA 021 000

Installation solution for dishwashers with a niche height of up to 36 1/4".

The hinge is fastened to the base of the appliance. The lower part of the split cabinet door panel is mounted onto it.

GZ 010 011
Aqua stop extension (79" long)
For all models

GZ 010 011

Extends the water supply and waste hose up to 11' 9".

Necessary if distance from water connection to dishwasher is more than 47 1/4" or 55 1/2" (please refer to drawing).

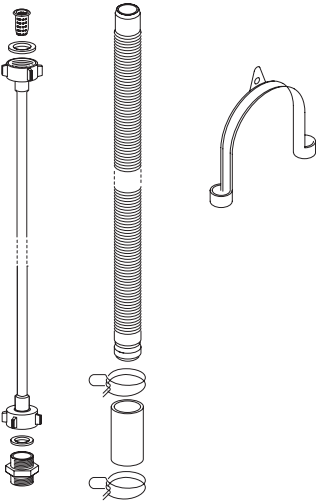

Connection dimensions
Data in brackets () refers to Aqua stop extension GZ 010 011.

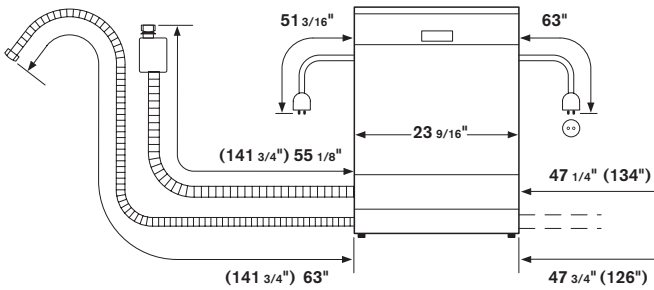

Numbers indicated inside parenthesis () = mm