



© 2001 Fire Farm, Inc.  
Elkader, IA  
Made in the USA

## Assembly Instructions

### TAO SCONCE

Item 9E-S-H

Designed by Boris Jeanrenaud

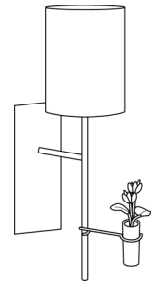

#### Parts Included: (pictures not to scale)

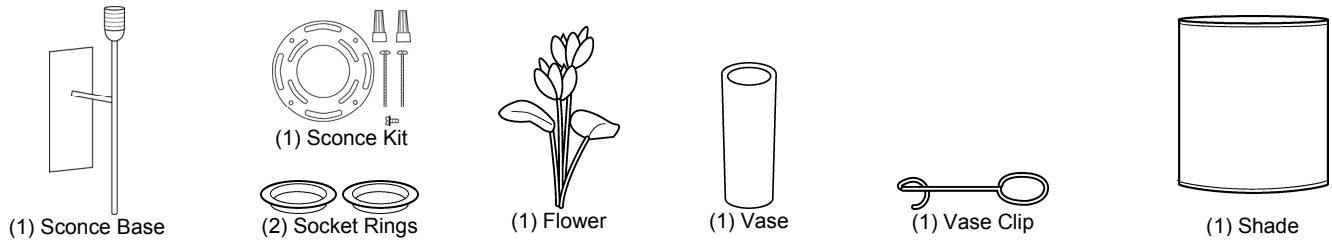

#### Assembly:

**WARNING: RISK OF FIRE AND ELECTRIC SHOCK. THIS PRODUCT IS TO BE INSTALLED BY A QUALIFIED ELECTRICIAN ONLY.**

1. Shade is assembled to base upside down for shipping. Begin assembly by disconnecting the Shade from the Sconce Base; unscrew the top Socket Ring and lift the shade off.
2. Install the Sconce Base. Please see separately enclosed sconce kit for installation instructions.
3. **(figure 1)** Replace the Shade in an upright position on the socket. Secure the shade with the second Socket Ring.
4. **(figure 2)** Slide the Vase Clip up the pole of the frame. Set the Vase Clip at the desired height.
5. Place the Vase into the Vase Clip. Add silk flower provided or fresh flower & water.
6. Install Bulb, turn on, and enjoy!

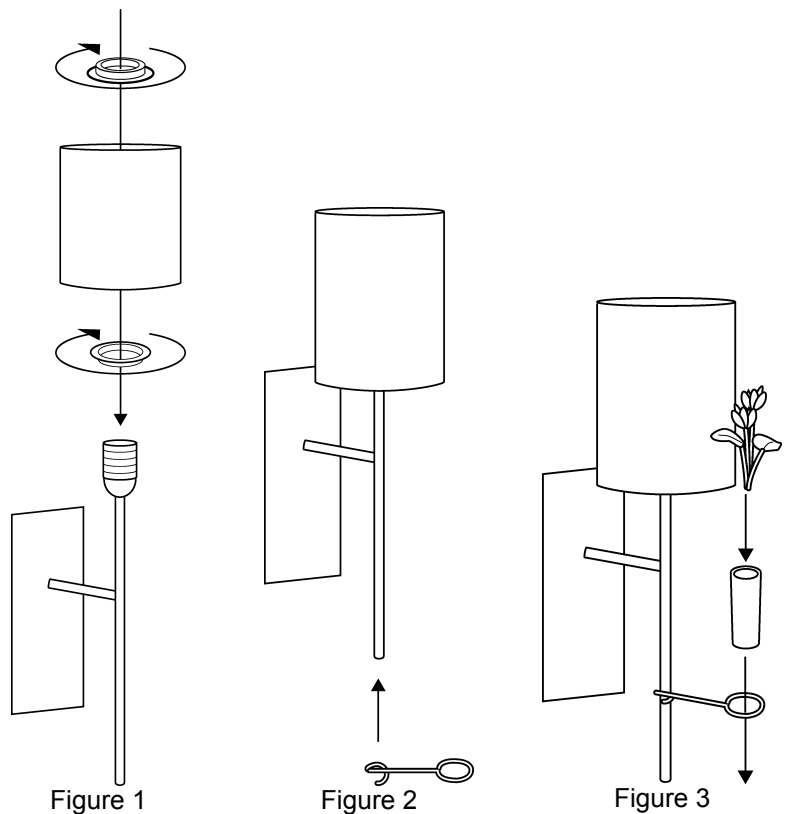

**You may use a maximum 100-watt bulb**

#### SAFETY INFORMATION

##### SAFETY

We have designed your lamp to meet the highest **UL and CUL** safety standards.

**WARNING:** RISK OF FIRE AND ELECTRIC SHOCK. THIS PRODUCT IS TO BE INSTALLED ONLY BY A QUALIFIED ELECTRICIAN.