

# SLUN

## Vertical Swing Lift Up Mechanism

Please read this instruction sheet carefully for proper installation and operation. Incorrect installation and improper use of the product may cause damage to the unit, and also cause injury. This instruction sheet should be kept by the user after installation.

### ■ Parts description

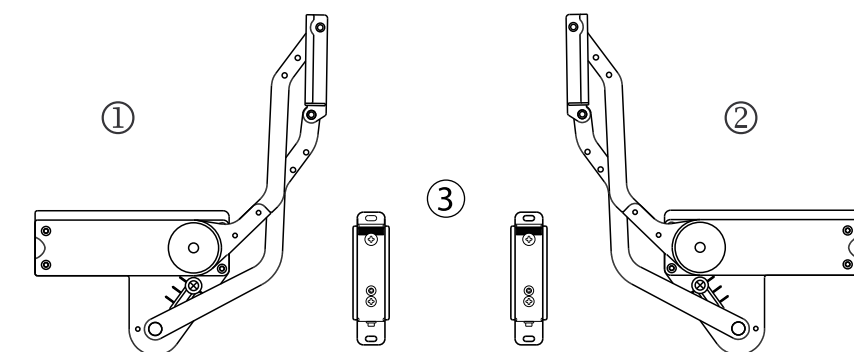

① SLUN - R right-hand side body	1
② SLUN - L left-hand side body	1
③ Mounting Plate	2
④ Screws for mounting bodies and mounting plates	16
⑤ Screws for mounting guide bar	4
⑥ Guide bar	1
5 mm Hex L - Key (optional parts)	1

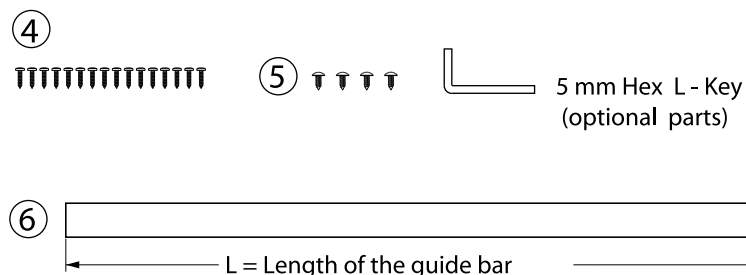

Fig. 1

Table 1 Guide Bar Length

	Cabinet width =600mm (24)	Cabinet width =900mm (36)
Solid wood Door (A)	535mm	835mm
Frame Door (B)	551mm	851mm

\*When ordering, specify the length you require.

### ■ Type Selection

Select suitable type considering the weight of the door, including a door handle.

The applicable cabinet height is from 392 to 450mm (15.5- 17.7), with top/bottom board of 19mm.

The standard length of aluminum guide bar in stock is for 600 or 900mm wide cabinet as per Table 1. Cut the guide bar to the suitable length in using the following formula in case the side-board is thicker than 15 - 16mm.

Bar Length for solid wood door : For (A) - holes  
Cabinet width - (sideboard thickness X 2) - 35

Bar Length for frame door : For (B) - holes  
Cabinet width - (sideboard thickness~2) - 19

Frame width of frame door must be 75mm or wider.

Contact us in case you need other length bars.

Table 2 Type and Suitable Door Weight.

Type	Door weight
SLUN-3	2.5~3.5kg (5.5~7.7lbs)
SLUN-4	3.6~4.5kg (8~10lbs)
SLUN-5	4.6~5.2kg (10.2~11.5lbs)

## ■ Mounting Dimensions and method

\*The drawing shows the application for the cabinet with 3 mm thick seal gasket on front edge.

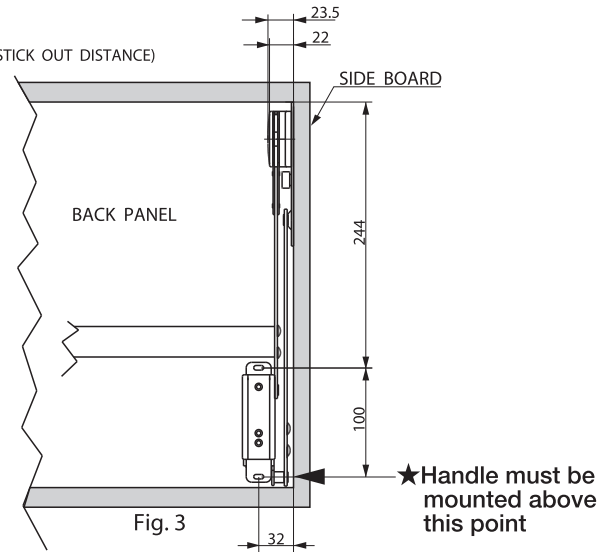
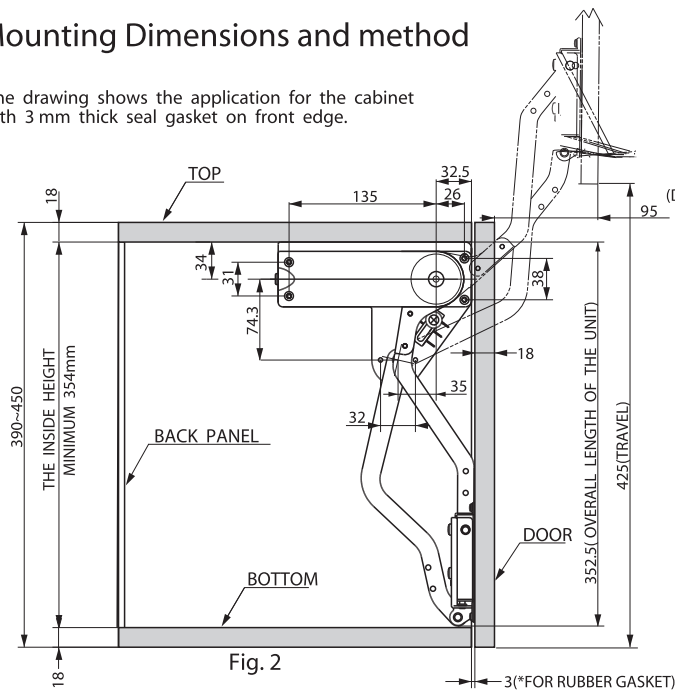

Step 1. Apply SLUN body to the upper corner of the cabinet. The position of the front edge of the body is open position to the front edge of the cabinet for 5mm gasket application. Note: \*1 Move the body 5 mm to the back panel side for no rubber gasket application. Fix both bodies firmly to the side boards with supplied screws.

Step 2. Mount guide bar to the arms with supplied screws. Position (A) is for the solid wood door application and position (B) is for the frame door application (Fig.4). Length of the guide bar is different depending on the door system. Cut and adjust the length of the guide bar, if required.

Step 3. Mount the mounting plates to the backside of the door with supplied screws to the position as per shown in Fig.3.

Step 4. Slide on the arm brackets to the mounting plates and fix with the screws on the mounting plates as per shown in Fig.6.

Step 5. Mounting plate has three direction door adjusting function. Adjust the door position horizontally, vertically and incline of the door. Fix mounting screws firmly after adjustment.

Step 6. Loosen the screw of arm stopper and adjust by moving to get required door opening height as per shown in Fig 5.

Step 7. Adjust opening speed by the speed adjusting screw on the rear of the bodies. 5 mm Hex L - Key is necessary. Fix the arms to the mounting plates with screws firmly. Opening speed will be faster when the adjusting screw is turned clockwise and slower when the adjusting screw is turned counter - clockwise.

Turn the speed adjusting screw carefully. Too much force or torque to the speed adjusting screws may cause damage and loose speed slow down function of SLUN.

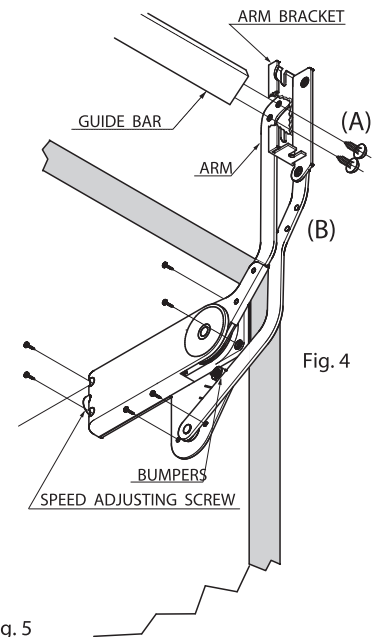
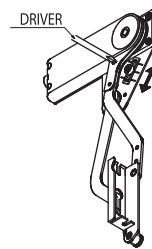

Fig. 4

Fig. 5

## ■ Three Direction Door Adjusting Function

- ①② Mounting plate fixing screws
- ③ Incline adjustment screw
- ④ Vertical adjustment screw
- ⑤ Horizontal adjustment Screws (Mounting plate fixing screws)

1. Loosen mounting plate fixing screws ①&②.
2. Incline of the door can be adjusted +4 mm by screw ③.
3. Vertical position of the door can be adjusted ±3mm by screw ④.
4. Horizontal position of the door can be adjusted ±3mm by screw ⑤.
5. Fix screws ①&② firmly after adjustment.

[Attention]  
Make door with the material and structure that will not cause warp. check mounting screws occasionally. Fasten again if the screws are loose.

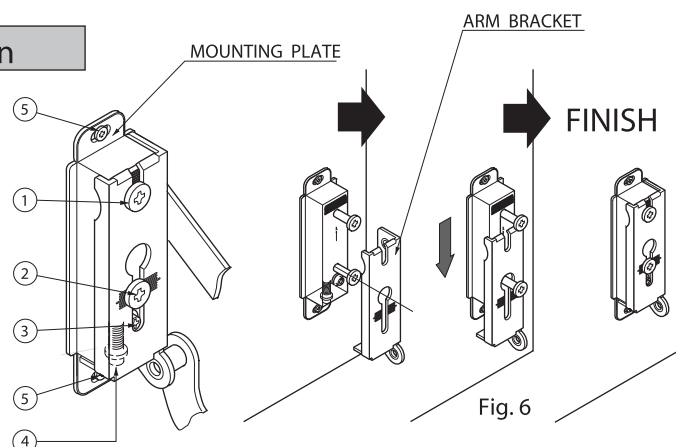

Fig. 6

\*The shapes of arms are omitted because of limited space.

Important Notice regarding handle position

The pull handle mounted on the SLUN door must be positioned above the bottom pivot of the mounting plate on the door. See illustration below.

The door may not open, or may experience difficulty opening the door if the handle position is below this point.

