

INSTALLATION INSTRUCTIONS PEDESTAL LAVATORIES



Thank you for selecting the Crane Plumbing pedestal lavatory. To insure this product is installed properly, please read these instructions carefully before you begin. This high quality, vitreous china fixture is meant to provide many years of service, but can be damaged by improper handling and/or installation. Be sure your installation conforms to local codes.

PRE INSTALLATION

Unpack the lavatory and pedestal. Take a moment to check the fixtures to make sure there is no damage. Verify that you have all the necessary tools, fittings, and connection hardware to complete the installation.

INSTALLATION

- 1 Provide suitable structural support behind the finished wall for the hanger lag screws.

The wall, or whatever material the screws are attached to, must be of sufficient strength to fully support the lavatory.

It may be necessary to install a 2 x 6 board behind the finished wall. Position the board between two studs, and above the floor so the mounting screws will be installed at the centerline of the 2 x 6. (See Figure 1).

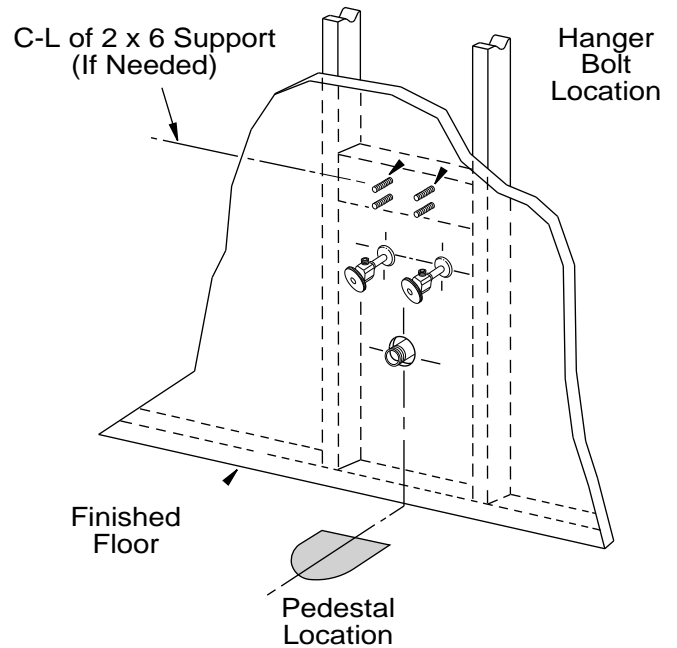

Figure 1

- 2 Set the lavatory on the pedestal base and position it against the wall in its final installed location.

Use a level to assure that the lavatory top is level front to back and side to side. Verify that there is proper clearance and fit for the supply fittings, waste outlet, drain pop up, etc. (See Figure 2).

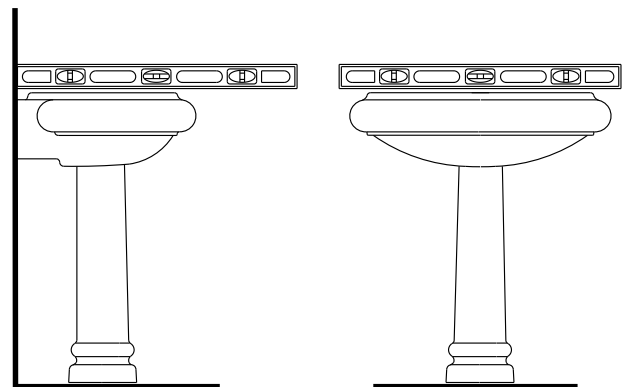

Figure 2

- 3 Reach up under the back of the lavatory and position the hanger so that it is making proper contact with the wall and the angled surface that is molded into the underside of the lavatory. The hanger should also be centered in relation to the centerline of the lavatory and the pedestal. Mark the location of the hanger on the wall.

- 4 Remove the lavatory and pedestal. Position the hanger, aligned with the marked location on the wall, and securely fasten it to the wall. A minimum of four 8 x 1-1/2" wood or lag screws should be used to attach the hanger to the wall. (See Figure 3)

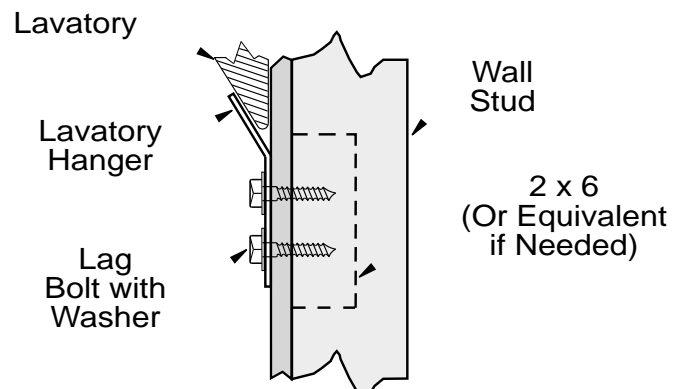

Figure 3

5 Assemble the faucet(s) and pop up to the lavatory.
(See Figure 4)

6 Hang the lavatory on the wall hanger. Position the pedestal under the lavatory - lift the front of the lavatory as necessary to place the pedestal the proper position.
(See Figure 5)

7 Connect and tighten the water supply fittings, waste piping, and pop up. (See Figure 6)

Install the hold down clips or screws to secure the lavatory top to the wall.
(not applicable to all lavatory models).

8 Install an 8 x 1" wood or lag screw in the bottom of the pedestal to secure it to the floor (Figure 7) and prevent lateral movement. (Not applicable to all models).

Do Not overtighten the screws as this can crack the china.

This fixture is virtually maintenance free. Clean it with any non-abrasive household cleaner and a soft cloth. Avoid striking it with metal objects, as they tend to mar the surface. These marks, or heavy soil, can be removed with a soft cleaner meant for glazed surfaces.

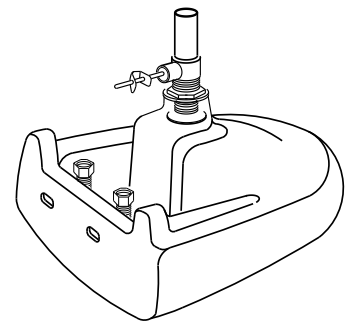

Figure 4

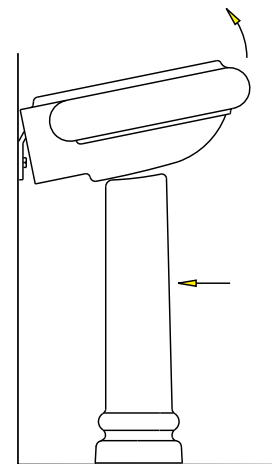

Figure 5

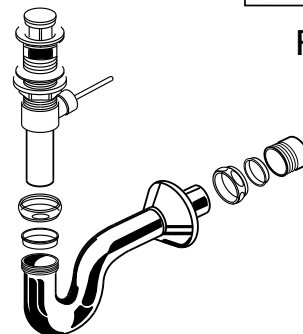

Figure 6

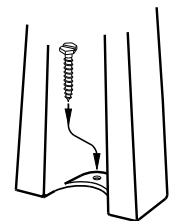

Figure 7

CR/PL 1235 Hartrey Avenue Evanston, IL. 60202

Limited Five Year Warranty

Subject to the "Exclusions" set forth below, CR/PL promises to the consumer to repair, or at the option of CR/PL, to replace any part of this plumbing product which proves to be defective in workmanship or materials under normal use for five years from the date of purchase. All costs of removal, transportation and reinstallation to obtain warranty service shall be paid by the consumer. During this five year period, CR/PL will provide, subject to the "Exclusions" section set forth below, all parts free of charge, necessary to correct such defects if this plumbing product has been installed and maintained in accordance with written instructions furnished by CR/PL with this plumbing product.

Exclusions: CR/PL PRODUCTS SHALL NOT BE LIABLE FOR INCIDENTAL OR CONSEQUENTIAL DAMAGES, INCLUDING COSTS OF INSTALLATION

OR WATER DAMAGE, OR FOR DAMAGES RESULTING FROM ABUSE OR MISUSE OR FROM FAILURE TO INSTALL OR MAINTAIN THIS PLUMBING PRODUCT IN ACCORDANCE WITH THE WRITTEN INSTRUCTIONS FURNISHED BY CR/PL PRODUCTS. USE OF CLEANING PRODUCTS CONTAINING CALCIUM HYPOCHLORITE (CHLORINE) SHALL CONSTITUTE IMPROPER MAINTENANCE. SOME STATES DO NOT ALLOW THE EXCLUSION OR LIMITATION OF INCIDENTAL OR CONSEQUENTIAL DAMAGES, SO THE ABOVE LIMITATION MAY NOT APPLY TO THE CONSUMER. THE ONLY WARRANTY MADE BY CR/PL PRODUCTS IS SET FORTH ABOVE AND ALL IMPLIED WARRANTIES WHICH MIGHT ARISE, INCLUDING THE IMPLIED WARRANTIES OF MERCHANTABILITY OR FITNESS FOR A

PARTICULAR PURPOSE ARE HEREBY EXCLUDED.

Warranty Service: In order to obtain warranty service or adjustments, contact the builder, dealer or plumber from whom the product was purchased, or the Customer Service Department, CR/PL Products, 201 East Fifth Street, Mansfield, OH 44901 (419/522-4211). In obtaining warranty service, all transportation, shipping and freight charges connected with transporting any part of this plumbing product must be prepaid by the consumer. It is the responsibility of the consumer to establish the warranty period by verifying the original purchase date. A bill of sale, cancelled check or some other appropriate payment record may be kept for this purpose. This warranty gives you specific legal rights. You may also have other rights which vary from state to state.