

**NEU SAN MARCOS™ ARMORPLUS®  
5' RECESS ENAMELED BATH**

- ☐ **2724** Right hand outlet  
☐ **2725** Left hand outlet

**Product Features:**

- Armorplus®, acid resisting, porcelain enamel, reinforced with a RIM spray process forming a polymeric foam/steel structural composite
- One-piece recess bath
- Heavy duty, slip-resistant bottom
- Fully bonded, sound deadening foam pad
- Capacity: 41 Gallons
- Shipping weight: 109 lbs.

**Nominal Dimensions:**

1524 x 762 x 362mm  
(60" x 30" x 14¼")

**Compliance Certifications –**

**Conforms to the Following Specifications:**

- ANSI A112.19.4M
- ASTM F-462 Slip-Resistance
- IAPMO (UPC)

**To Be Specified:**

- ☐ Trim\*:  
☐ Waste:  
☐ Color:

\* See faucet section for additional models available

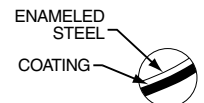
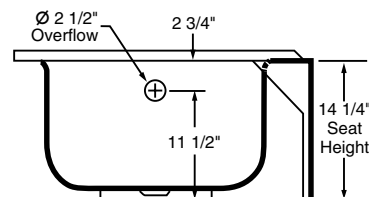
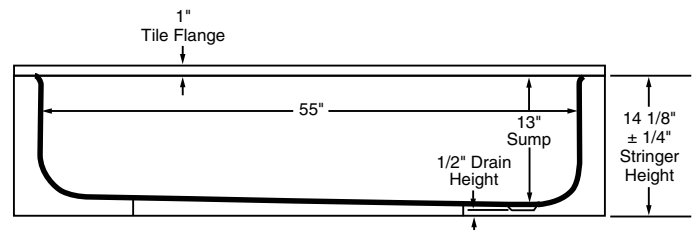
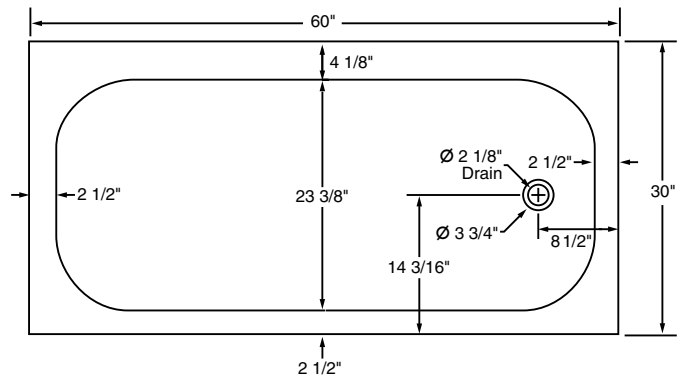
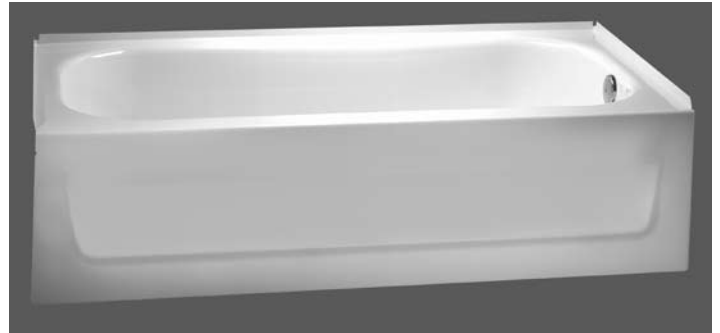

MEETS THE AMERICANS WITH DISABILITIES ACT GUIDELINES  
AND ANSI A117.1 REQUIREMENTS FOR ACCESSIBLE AND  
USEABLE BUILDING FACILITIES-CHECK LOCAL CODES.  
INSTALL WITH SEAT AT HEAD END.

**NOTE:**

FIXTURE SHOW WITH RIGHT HAND OUTLET. FOR BATH WITH LEFT HAND  
OUTLET REVERSE DIMENSIONS.

**IMPORTANT:** Rough-in dimensions may vary within the range of tolerances  
established by ASME A112.19.4.