

**NEU SAN ANGELO™ ARMORPLUS®**  
**4½' ENAMELED RECESS BATHTUB**

- ☐ **2722** Right hand outlet  
☐ **2723** Left hand outlet

**Product Features:**

- Armorplus®, acid resisting, porcelain enamel, reinforced with a RIM spray process forming a polymeric foam/steel structural composite
- One-piece recess bath
- Heavy duty, slip-resistant bottom
- Fully bonded, sound deadening foam pad
- Capacity: 36 Gallons
- Shipping weight: 100 lbs.

**Nominal Dimensions:**

1372 x 762 x 387mm  
(54" x 30" x 15¼")

**Compliance Certifications –**

**Conforms to the Following Specifications:**

- ANSI A112.19.4M
- ASTM F-462 Slip-Resistance
- IAPMO (UPC)

**To Be Specified:**

- ☐ Trim\*:  
☐ Waste:  
☐ Color:

\* See faucet section for additional models available

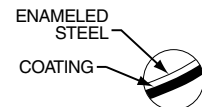
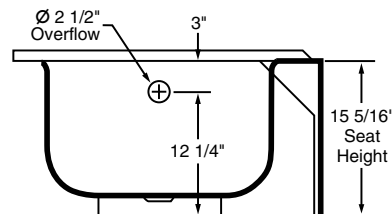
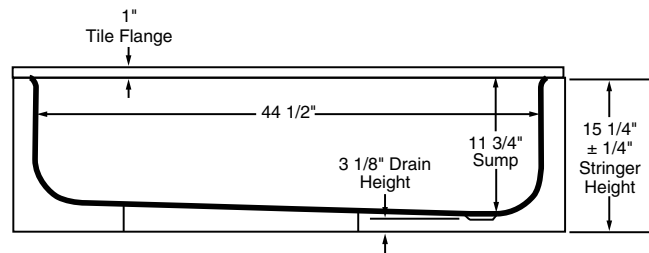
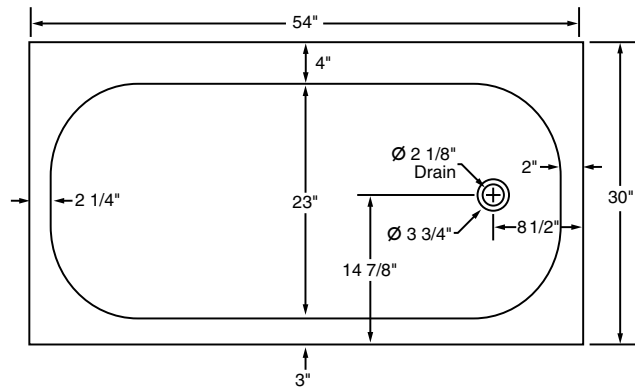

**NOTE:**

FIXTURE SHOW WITH RIGHT HAND OUTLET. FOR BATH WITH LEFT HAND OUTLET REVERSE DIMENSIONS.

**IMPORTANT:** Rough-in dimensions may vary within the range of tolerances established by ASME A112.19.4.