

COVERED

- EATU01** (CROSS HANDLE)
- EATU02-K** (METAL LEVER HANDLE)
- EATU03-K** (WHITE PORCELAIN LEVER HANDLE)
- EATU04-K** (BLACK PORCELAIN LEVER HANDLE)
- EATU05-K** (OAK LEVER HANDLE)

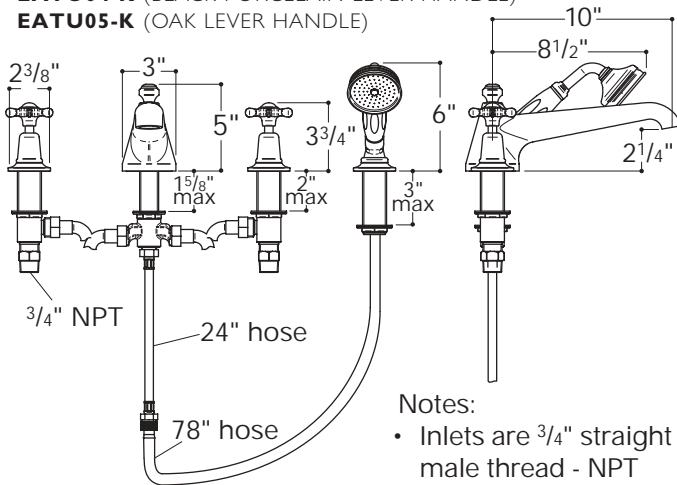

Notes:

- Inlets are 3/4" straight male thread - NPT adaptors provided
- Drilling hole size: 1 1/2"
- Must have access panel for servicing.
- Consult your local building codes for anti-scald requirements.

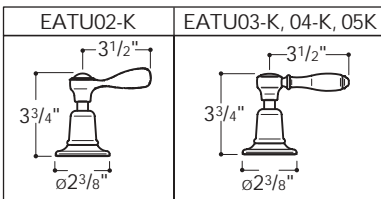

INSTALLATION GUIDELINES:

IMPORTANT:

- To ensure this product is installed properly, you must read and follow these guidelines.
- The owner/user of the faucet must keep this information for future reference.
- Be sure your installation conforms to local codes. It is the responsibility of the plumber to provide anti-scald protection.
- Accessible shut-off valves, which will facilitate servicing, are recommended for the hot and cold feed lines.
- An access panel is necessary for future servicing.
- Inspect this product to assure you have all parts required for proper installation.
- Use only a strap wrench or protected/smooth-jaw wrench on any finished surface.
- Run 3/4" supply lines for maximum water flow.
- Do NOT use putty during this installation.
- Refer to the specification and assembly drawings attached. Faucet is sold partially assembled but shown fully disassembled for illustrative and service purposes only.

SIDE VALVE INSTALLATION:

1. With the lock nut (15) and lower sealing gasket (14) installed on the side valve (13), insert the side valve into the hole in the mounting surface so at least 1" of threads are exposed above the deck surface.
2. Place the upper sealing gasket (11) onto the side valve then thread the base escutcheon (10) onto the side valve.
3. Thread the handle assembly (1-9) onto the side valve until it stops. Hand tight is adequate; if this assembly is too tight, the handle will bind.
4. Unthread the base escutcheon until it contacts the gland nut (6), which will assure proper side valve height.
5. Tighten the lock nut up against the underside of the mounting surface to secure the side valve.
6. Repeat these steps to install the second side valve.

SPOUT INSTALLATION:

7. Unthread the diverter tee (32), locking nut (30) and lower washer (29) from the spout (19).
8. Insert the spout assembly (17-28) through the hole in the mounting surface with the upper washer (20) positioned under the spout.
9. Reinstall the lower washer and tighten the locking nut to secure the spout to the mounting surface.
10. Reattach the tee to the spout and fully tighten to prevent leaks.

HAND SHOWER INSTALLATION:

11. Unscrew the locking nut (37) from the all-thread (42) and remove the lower washer (38).
12. Unscrew the cover ring (44) from the all-thread and pull out the plastic guide (43).
13. Insert the all-thread through the mounting surface, leaving the escutcheon (41) and upper washer (40) in place.
14. Re-attach the lower washer and locking nut to the all-thread. Fully tighten the locking nut to secure the assembly.
15. Slide the cover ring (44) over the conical end of the hose (36) and insert the hose into the plastic guide (43). Now pass the knurled end of the hose (36) through the all thread (42) until the plastic guide is fully seated inside of the all-thread. Finally, re-attach the cover ring to the all-thread.
16. Connect the conical end of the hose to the hand shower. Note: The combination flow restrictor/non-return valve (45) is located in the end of the hand shower. Final Connections and Inspection

12/24 These guidelines have been prepared for the professional contractor to aid in the installation of: **EASTON® CONCEALED TUB FILLER WITH HAND SHOWER (COVERED) (EATU01, 02-K, 03-K, 04-K, 05-K)**
 All dimensions are based on original specifications and are subject to change and variation. Please consult your Design Associate for current specifications.

FINAL CONNECTIONS AND INSPECTION:

- 17. Connect each of the supply hoses (33) to the adjacent side valve making sure the hoses are not kinked.
 - 18. Connect the female end of the flexible hose (35) to the tee junction (32) using the washer (34).
 - 19. Connect the knurled end of the hand shower hose (36) to the male end of the flex hose (35).
 - 20. Connect the side valves (13) to the water supplies (not provided).
 - 21. Carefully open the hot and cold valves to flush out any debris in the supply lines before transferring the flow of water to the hand shower.
 - 22. Carefully inspect all connections for leaks and check for proper operation prior to enclosing the unit.
 - 23. For servicing the valve stem (12), unscrew the cover (6) and pull off the handle assembly (1-9).
- If further assistance is required, please contact Product Support at 1-800-927-2120 (8am-7pm EST).

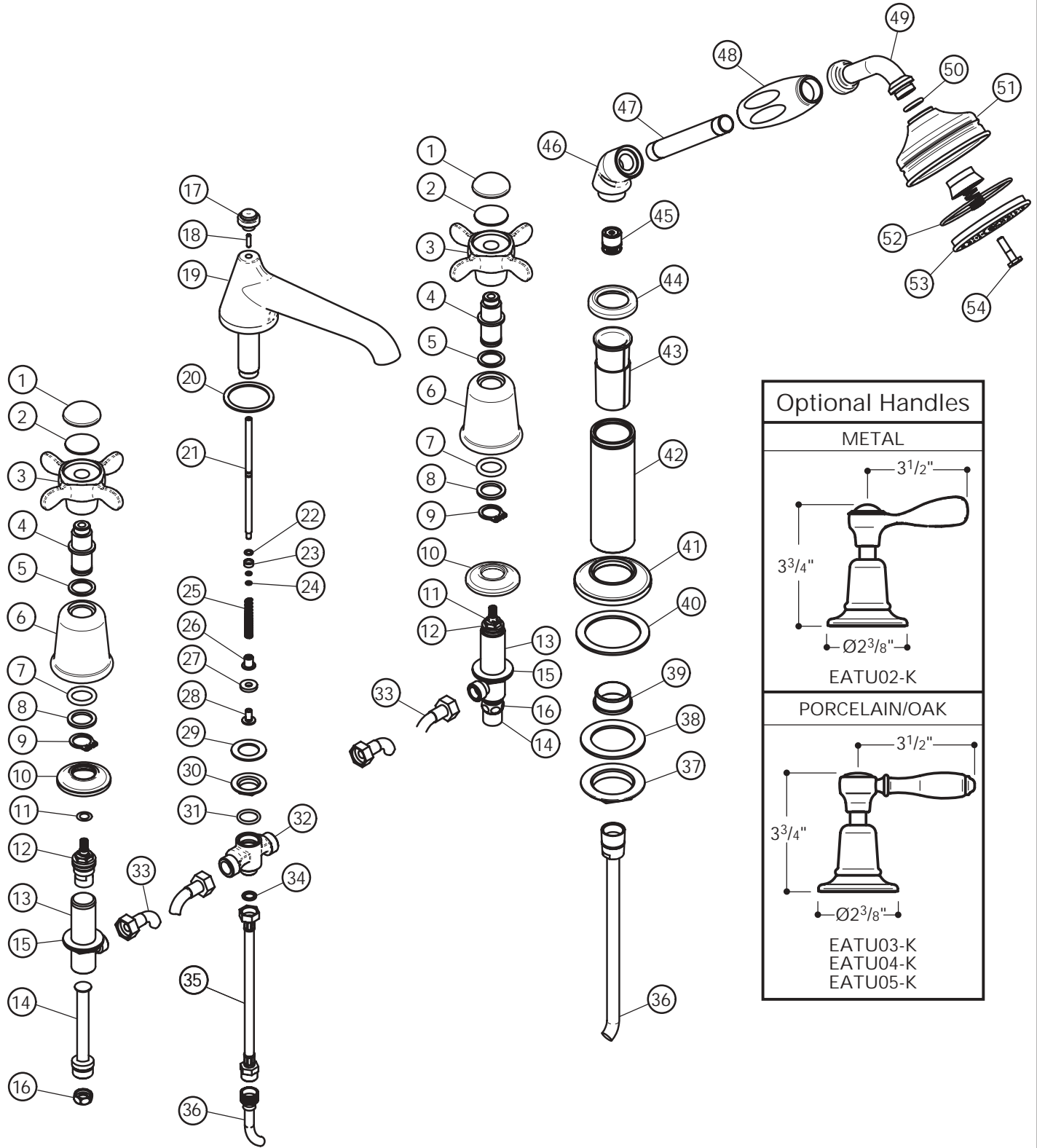

Optional Handles	
METAL	
EATU02-K	
PORCELAIN/OAK	
EATU03-K EATU04-K EATU05-K	

12/24 These guidelines have been prepared for the professional contractor to aid in the installation of: **EASTON® CONCEALED TUB FILLER WITH HAND SHOWER (COVERED)** (EATU01, 02-K, 03-K, 04-K, 05-K)
 All dimensions are based on original specifications and are subject to change and variation. Please consult your Design Associate for current specifications.

CARE AND CLEANING

The lustrous finish on your fitting should be treated with care. Improper handling or cleaning can damage the surface of any metal finish.

To clean the finish, wipe gently with a soft damp cloth and wipe dry with a soft towel. Use only a mild soap solution if required. THE USE OF POLISH, ABRASIVE CLEANERS, SOLVENTS, AMMONIA-BASED PRODUCTS, OR ACID CLEANERS WILL DAMAGE THE FINISH AND VOID THE WARRANTY.

Water contains lime and other minerals that will be left on the surface after the water has evaporated. You can prevent deposits from forming by always wiping the fitting dry immediately after use.

If you desire additional protection, the use of a pure carnauba automotive wax that does not contain cleaning agents will help to protect the surface finish from mineral deposits present in your water supply. This can be reapplied as necessary to continue protection.

Please note: In addition to the aforementioned care instructions, the following points are specific to certain finishes only. Select Waterworks faucets and basins are offered in finishes that have been pre-weathered, creating a patina that will continue to develop with age. In addition, items purchased in the unlacquered brass and copper finishes will change over time and may be polished using appropriate polishing compounds. Fittings offered in a silver-plated finish will tarnish with age. This finish may be restored to its original luster by using a non-abrasive silver polish. Be sure to read and follow the polish manufacturer's instructions for all applications.

WARRANTY**LIMITED LIFETIME MECHANICAL WARRANTY:**

Waterworks warrants to the initial purchaser all plumbing and accessory products sold by Waterworks, which are installed in a residence to be used in a residential application, to be free from manufacturing defects in materials and workmanship for as long as the purchaser continues to own and maintain the residence where the products are initially installed.

FIVE-YEAR FINISH WARRANTY:

Waterworks warrants to the purchaser the finish of all plumbing and accessory products sold by Waterworks, which are installed in a residence to be used in a residential application, to be free from manufacturing defects in materials and workmanship for a period of five years from installation of the products. Waterworks must receive notice of any warranty claim within the five-year warranty period.

REPAIR OR REPLACEMENT:

If within the applicable warranty period the covered products shall be proved to the satisfaction of Waterworks to be defective, Waterworks will repair or replace such products, at its expense (provided that such repair or replacement shall not include installation costs). Waterworks' obligation shall be limited to such repair and replacement and shall be conditioned upon Waterworks' receiving notice of any alleged defect within the applicable warranty period. Purchaser shall be responsible for all shipping charges for returned products.

LIMITATIONS ON WARRANTY COVERAGE:

The warranties set forth above shall be extended only to the purchaser and do not apply to any purchaser where the products are used for commercial applications and usage. Furthermore, the warranties do not cover installation or any other labor charges and do not apply to:

- (i) products which have been repaired, altered or modified in any way by purchaser or any person other than Waterworks or not using original Waterworks spare parts, unless previously authorized in writing by Waterworks;
- (ii) products which have not been installed, used, maintained or stored in accordance with the instructions provided to purchaser by Waterworks;
- (iii) products which have been used for purposes other than or in a manner contrary to their intended and normal use;
- (iv) products which have been damaged as a result of misuse, negligence, freezing, accident or faulty installation or maintenance; and
- (v) products damaged by the effects of dirt, salt water air, hard water, limescale, or abrasive or aggressive cleaners. If the normal life span of any product is shorter than the applicable warranty period, the warranty shall apply only during the period of such shorter life span.

NOTICE OF WARRANTY CLAIMS:

For all warranty claims please call Waterworks Product Support at 800-927-2120, or write to Waterworks Product Support at 60 Backus Avenue, Danbury, Connecticut 06810.

The warranties provided herein are conveyed only to the purchaser of products sold by Waterworks after January 1, 2000, and installed in a residential application.

Except as specifically set forth above, Waterworks does not make any other warranty, express or implied, including without limitation, any implied warranty of merchantability or fitness for a particular purpose. In no event shall Waterworks be liable to any person or entity for any indirect, special, incidental or consequential damages or loss (including damages for loss of business, loss of profits, or the like), whether based on breach of contract, tort (including negligence), product liability or otherwise, even if it has been advised of the possibility of such damages.

Waterworks' liability on any claim of any kind, including negligence, shall in no case exceed the contract price paid by the purchaser for the product claimed to be defective or unsuitable.