

WALL VALVE TRIM WITH CROSS HANDLES

PTSV47 (trim) & **GUSVI6R** (rough)

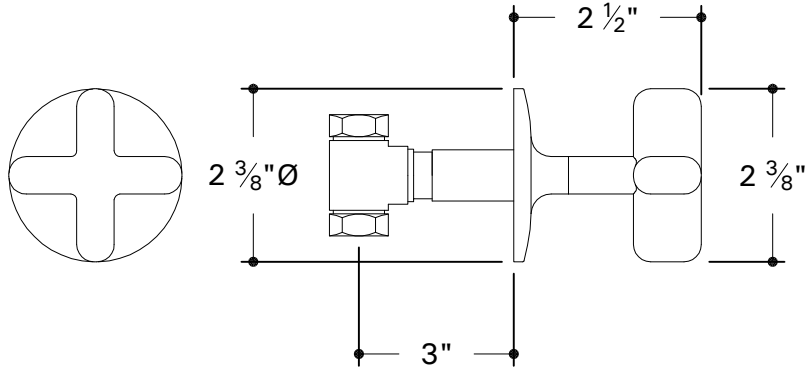
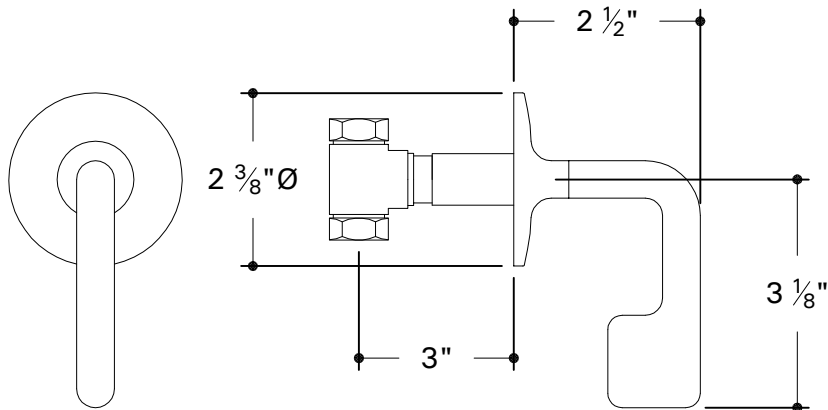

WALL VALVE TRIM WITH LEVER HANDLES

PTSV48 (trim) & **GUSVI6R/17R** (rough)



All dimensions are based on original specifications and are subject to change and variation. Please consult your Design Associate for current specification.

Notes:

- Rough In Depth: 3" from centerline of inlets to face of finished wall.
- Inlet/Outlet: 3/4" female NPT
- GUSV16R clockwise close, GUSV17R counter clockwise close.