

EALS41 (Cross Handles) & **GUSV27R** (Rough)

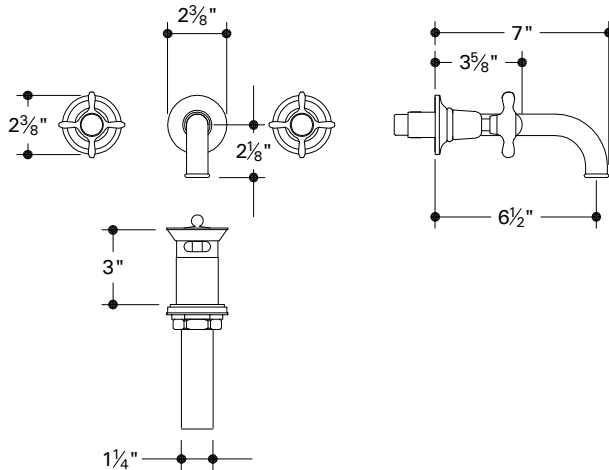

- Refer to the specification and assembly drawings attached. Faucet is sold partially assembled but shown fully disassembled for illustrative and service purposes only.
- Check countertop and sink measurements to assure the spout projects far enough into the sink.
- Inspect this product to assure you have all parts required for proper installation.
- Use only a strap wrench or protected/smooth-jaw wrench on any finished surface.
- Do NOT use putty during this installation.

EALS42 (Metal Lever Handles) & **GUSV25R** (Rough)
EALS43 (White Porcelain Lever Handles) & **GUSV25R** (Rough)
EALS44 (Black Porcelain Lever Handles) & **GUSV25R** (Rough)
EALS45 (Oak Lever Handles) & **GUSV25R** (Rough)

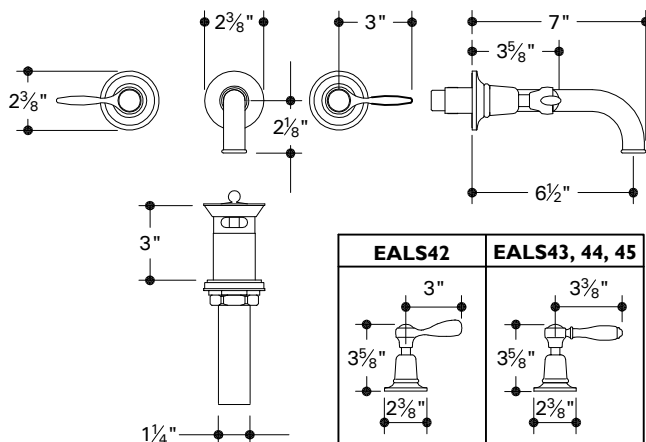

ROUGH-IN:

Rough in Depth: 3" from center of inlets to surface of the finished wall.

Rough in Height: 3 3/4" minimum from center of cartridge stem to surface of counter top to allow for lever handle clearance in the open position.

1. Run 1/2" hot and cold supply lines. The spread between supplies is 8" on center and is NOT adjustable.
2. Install a well supported 1/2" sweat x 1/2" female IPS adapter onto each supply line.
3. Verify the supplies are secure, level, at the proper spread of 8" and equal depths.
4. Remove the nuts (6) from the faucet body inlets then pull out the inlet adapters (6a,6b).
5. Slide the nut over the inlet adapter and thread them into the supplies. Use a 10 mm hex wrench to tighten the adapters.
6. Align the faucet body onto the supplies making sure that the o-ring (6b) does not get pinched then tighten the nuts (6) to secure the faucet.
7. Verify the supplies and faucet body are secure then turn on the supplies and check for leaks.

IMPORTANT

- **To ensure this product is installed properly, you must read and follow these guidelines.**
- **The owner/user of the faucet must keep this information for future reference.**
- This faucet must be on-site prior to rough in and allows the installer to visualize the installation and match the 8" center spread.
- Be sure your installation conforms to local codes.

8. Install 1/2" brass nipple and cap into spout tee (6g); this will be removed after wall is finished.

HANDLE INSTALLATION:

9. Pull the tile shield off the threaded sleeve (5) then thread the handle trim connector assembly (3-3d) onto the threaded sleeve until it stops.

10. Slide the escutcheon (2,2a) onto the handle trim connector assembly then thread on the handle assembly (1-1h).

11. Slide the escutcheon (2-2a) back until it contacts the gland nut (1e).

12. Measure the distance from the face of the finished wall to the back side of the escutcheon. This measurement will be the length of threaded sleeve that will be cut off in step 14.

13. Remove the handle assembly (1-1h), handle trim connector assembly (3-3d) and threaded sleeve (5).

14. Mark then cut the threaded sleeve the amount equal to what was measured in step 12. Do NOT cut the end of the threaded sleeve (5) that has internal threads or the handle trim connector assembly (3,3d).

15. Thread the threaded sleeve back onto the valve stem (4) and mark the stem at a point that is flush with the end of the threaded sleeve.

16. Remove the threaded sleeve and valve stem then cut the valve stem 1/2" BEYOND the mark made in step 15.

17. Reinstall the valve stem then the threaded sleeve and make sure the stem tip is 1/2" beyond the end of the sleeve.

18. Attach the handle trim connector and handle assembly to the threaded sleeve. Do not over-tighten the trim connector or the handle may bind.

19. Slide the escutcheon back against the nut. Adjust the handle trim connector to make sure there are no gaps between the escutcheon (2,2a) and nut (1e). If gaps remain, cut the threaded sleeve and/or the valve stem.

20. Remove the handle assembly (1-1h) and escutcheon (2,2a) then apply a bead of silicone to the back side of the escutcheon to create a seal against the wall. Reinstall the escutcheon and handle assembly.

SPOUT INSTALLATION:

21. To extend spout projection, install a 1/2" IPS brass nipple (7) (not supplied) of appropriate length and coupling (7a) (not supplied) into the spout tee (6g).

22. Wrap the nipple and spout adapter (7b) with Teflon tape.

23. Make sure the washer (7c) is fully inserted into the spout adapter (7b) then thread the spout adapter onto the coupling. The adapter can be tightened using a 3/8" hex wrench.

24. Slide the escutcheon (8,8a,8b) onto the spout then thread the spout onto the spout adapter.

DRAIN INSTALLATION

Note: This faucet does not use a lift rod to operate the drain stopper. Instead, it uses a lift and turn drain.

25. Disassemble the drain assembly and discard the upper gasket (12).

26. Set the upper collar (11) in the lavatory drain opening using a clear adhesive silicone.

27. Re-attach the lower drain assembly using the hardware provided then tighten until fully secured. A clear adhesive silicone may be used to ensure a water-tight seal between the upper gasket and lavatory.

28. Attach the tail piece using the gasket (17) provided. Do NOT over-tighten the tailpiece nut (16); hand tight is adequate.

INSPECT THE INSTALLATION

29. Remove the flow restrictor assembly (8d,8e) from the spout using the tool (9) provided. Carefully open the hot and cold valves to flush out any debris in the supply lines.

30. Inspect all connections for leaks. Reinstall the flow restrictor assembly.

➤ If further assistance is required, please contact Product Support at 1-800-927-2120 (8am-7pm EST)

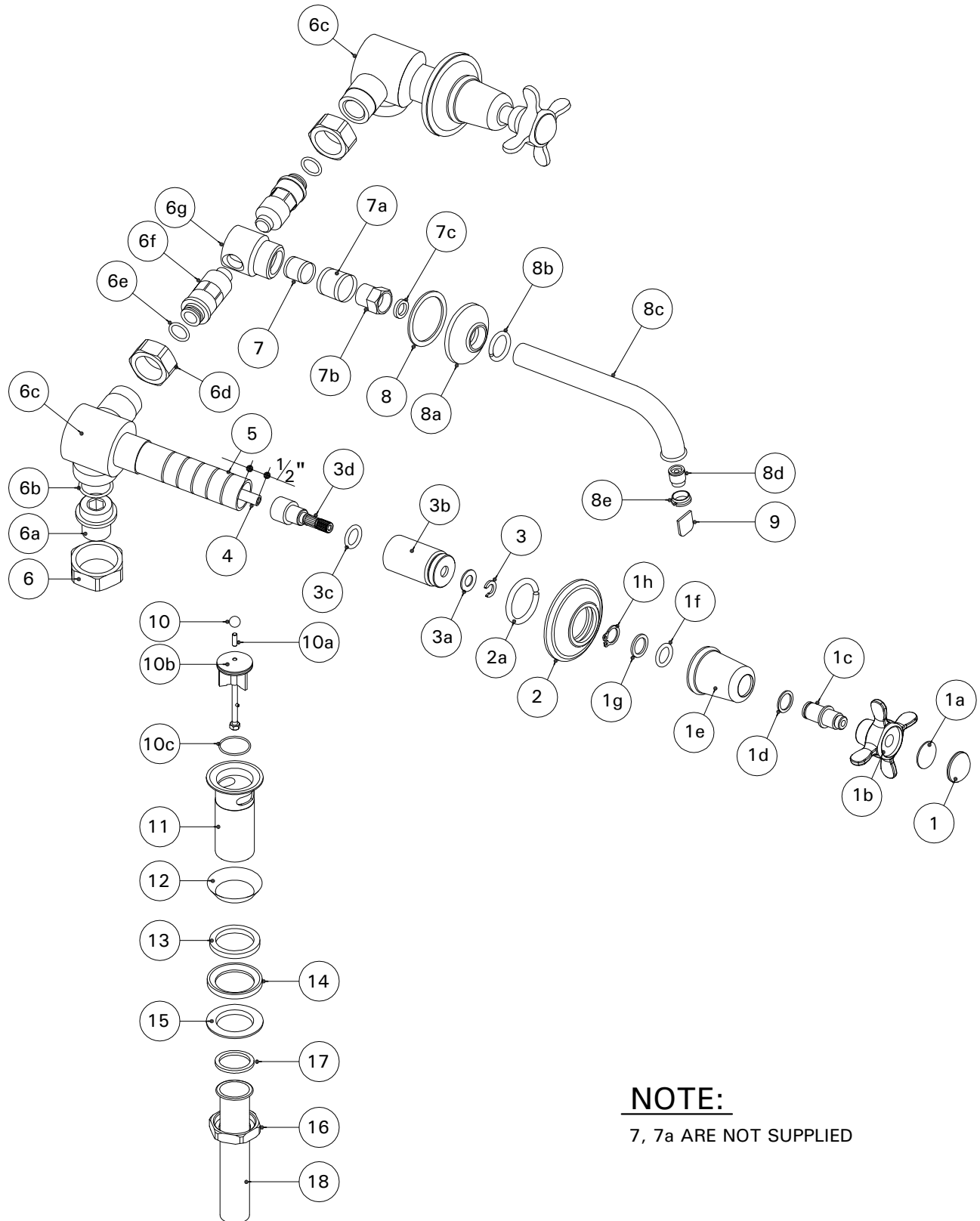

NOTE:
7, 7a ARE NOT SUPPLIED

PARTS TABLE		
ITEM NO.	DESCRIPTION	QTY.
1	INDICE	2
1a	INDICE TAPE	2
1b	HANDLE	2
1c	HANDLE STEM	2
1d	WASHER	2
1e	GLAND NUT	2
1f	O-RING	2
1g	WASHER	2
1h	CLIP	2
2	ESCUTCHEON	2
2a	O-RING	2
3	CLIP	2
3a	WASHER	2
3b	HANDLE TRIM CONNECTOR	2
3c	O-RING	2
3d	SPLINE ADAPTER	2
4	VALVE STEM	2
5	THREADED SLEEVE	2
6	NUT	2
6a	INLET ADAPTER	2
6b	O-RING	2
6c	VALVE BODY	2
6d	UNION	2
6e	O-RING	2
6f	COUPLING	2
6g	SPOUT TEE	1
7	NIPPLE (NOT SUPPLIED)	1
7a	COUPLING (NOT SUPPLIED)	1
7b	SPOUT ADAPTER	1
7c	WASHER	1
8	GASKET	1
8a	ESCUTCHEON	1
8b	O-RING	1
8c	SPOUT	1
8d	FLOW RESTRICTOR	1
8e	RESTRICTOR HOUSING	1
9	HOUSING TOOL	1
10	POP-UP HANDLE	1
10a	SCREW	1
10b	POP-UP	1
10c	O-RING	1
11	DRAIN COLLAR	1
12	GASKET	1
13	BOTTOM GASKET	1
14	COLLAR	1
15	DRAIN NUT	1
16	TAILPIECE NUT	1
17	TAILPIECE WASHER	1
18	TAILPIECE	1

2/06

These guidelines have been prepared for the professional contractor to aid in the installation of:
EASTON WALL MOUNTED LAVATORY FAUCET WITH CROSS HANDLES (EALS41 & GUSV27R) & LEVER HANDLES (EALS42, 43, 44, 45 & GUSV25R) All dimensions are based on original specification and are subject to change and variation. Please consult your Design Associate for current specifications.

W A T E R W O R K S®

CARE AND CLEANING

The lustrous finish on your fitting or fixture should be treated with care. Improper handling or cleaning can damage the surface of any finish and void the warranty.

To clean the finish, wipe gently with a soft, damp cloth and then with a soft, dry towel. A mild soap solution can be used for daily cleaning. THE USE OF UNAUTHORIZED POLISHES, ABRASIVE CLEANERS, SOLVENTS, AMMONIA-BASED PRODUCTS, OR ACID BASE CLEANERS MAY DAMAGE THE FINISH AND WILL VOID THE WARRANTY.

Water contains lime and other minerals that are deposited after the water has evaporated. You can prevent deposits from forming by always wiping the fitting dry after use.

In addition to the aforementioned care instructions, the following points are specific to certain finishes or products only. Always read and follow the instructions when using any cleaning or polishing products.

NON-METAL TUBS

In addition to mild soap and water, a non-abrasive basin tub and tile cleaner is recommended for regular cleaning and disinfecting. The use of any other cleaners or disinfectants may alter the surface finish and void the warranty.

WHIRLPOOL AND AIRTUB SYSTEMS

Jet Fresh whirlpool cleaning solution is recommended for maintaining waterways.

ANTIQUED COPPER AND BRASS

Select Waterworks fittings and basins are offered in finishes that have been chemically weathered, creating a patina that will develop and change with time. In addition to mild soap and water, a natural citrus-based product may be used for regular cleaning. The use of any other cleaners or disinfectants may alter the surface finish and void the warranty. Please note that prolonged contact with certain items such as toothpaste, acidic fruits and vegetables, and wines will alter the surface finish. Also, the use of polishing agents will remove the patina and restore the metal to its original shine. Once removed, the patina will naturally redevelop with time.

ARCHITECTURAL BRONZE

In addition to mild soap and water, a natural citrus-based product may be used for regular cleaning. The use of any other cleaners or disinfectants may alter the surface finish and void the warranty. Please note that prolonged contact with certain items such as toothpaste, acidic fruits and vegetables, and wines will alter the surface finish. Also, the use of polishing agents will remove the finish.

CHINA, CERAMIC AND PORCELAIN

Do not use abrasive cleaners, as this will dull the surface finish. A non-abrasive basin tub and tile cleaner is recommended for regular cleaning and disinfecting. The use of any other cleaners or disinfectants may alter the surface finish and void the warranty.

CHROME

In addition to mild soap and water, a non-abrasive basin tub and tile cleaner is recommended for regular cleaning and disinfecting. The use of any other cleaners or disinfectants may alter the surface finish and void the warranty. Cape Cod Polishing Cloths may be used for the occasional polishing. If you desire additional protection, the use of Faucet Brite will aid in protecting the surface finish from mineral deposits present in your water supply. This should be reapplied as necessary to continue protection.

MATTE NICKEL, LUMIN AND GOLD

In addition to mild soap and water, a non-abrasive basin tub and tile cleaner is recommended for regular cleaning and disinfecting. The use of any other cleaners or disinfectants may alter the surface finish and void the warranty. Also, the use of polishing agents will remove the finish. If you desire additional protection, the use of Faucet Brite will aid in protecting the surface finish from mineral deposits present in your water supply. This should be reapplied as necessary to continue protection.

NICKEL

In addition to mild soap and water, a non-abrasive basin tub and tile cleaner is recommended for regular cleaning and disinfecting. The use of any other cleaners or disinfectants may alter the surface finish and void the warranty. Cape Cod Polishing Cloths may be used for the occasional polishing. The use of any other polishing agents will remove the finish and void the warranty. If you desire additional protection, the use of Faucet Brite will aid in protecting the surface finish from mineral deposits present in your water supply. This should be reapplied as necessary to continue protection.

SILVER

Fittings offered in a silver finish will tarnish with age. This finish may be restored to its original luster by using Faucet Brite or a non-abrasive silver polish. This should be reapplied as necessary to continue protection. Faucet Brite will also help to prolong the time between regular polishing.

UNLACQUERED BRASS AND COPPER

Items purchased in the unlacquered brass and copper finishes will change with time as they develop a natural patina. The original shine can be restored using Faucet Brite or an appropriate polishing compound. If you desire additional protection, the use of Faucet Brite will aid in protecting the surface finish from mineral deposits present in your water supply and prolong the time between regular polishing. This should be reapplied as necessary to continue protection.

WARRANTY

LIMITED LIFETIME MECHANICAL WARRANTY:

Waterworks warrants to the initial purchaser all plumbing and accessory products sold by Waterworks, which are installed in a residence to be used in a residential application, to be free from manufacturing defects in materials and workmanship for as long as the purchaser continues to own and maintain the residence where the products are initially installed.

FIVE-YEAR FINISH WARRANTY:

Waterworks warrants to the purchaser the finish of all plumbing and accessory products sold by Waterworks, which are installed in a residence to be used in a residential application, to be free from manufacturing defects in materials and workmanship for a period of five years from installation of the products. Waterworks must receive notice of any warranty claim within the five-year warranty period.

REPAIR OR REPLACEMENT:

If within the applicable warranty period the covered products shall be proved to the satisfaction of Waterworks to be defective, Waterworks will repair or replace such products, at its expense (provided that such repair or replacement shall not include installation costs). Waterworks' obligation shall be limited to such repair and replacement and shall be conditioned upon Waterworks' receiving notice of any alleged defect within the applicable warranty period. [Purchaser shall be responsible for all shipping charges for returned products.]

LIMITATIONS ON WARRANTY COVERAGE:

The warranties set forth above shall be extended only to the purchaser and do not apply to any purchaser where the products are used for commercial applications and usage. Furthermore, the warranties do not cover installation or any other labor charges and do not apply to:

- (i) products which have been repaired, altered or modified in any way by purchaser or any person other than Waterworks or not using original Waterworks spare parts, unless previously authorized in writing by Waterworks;
- (ii) products which have not been installed, used, maintained or stored in accordance with the instructions provided to purchaser by Waterworks;
- (iii) products which have been used for purposes other than or in a manner contrary to their intended and normal use;
- (iv) products which have been damaged as a result of misuse, negligence, freezing, accident or faulty installation or maintenance; and
- (v) products damaged by the effects of dirt, salt water air, hard water, limescale, or abrasive or aggressive cleaners. If the normal life span of any product is shorter than the applicable warranty period, the warranty shall apply only during the period of such shorter life span.

NOTICE OF WARRANTY CLAIMS:

For all warranty claims please call Waterworks Product Support at 800-927-2120, or write to Waterworks Product Support at 60 Backus Avenue, Danbury, Connecticut 06810.

The warranties provided herein are conveyed only to the purchaser of products sold by Waterworks after January 1, 2000, and installed in a residential application.

Except as specifically set forth above, Waterworks does not make any other warranty, express or implied, including without limitation, any implied warranty of merchantability or fitness for a particular purpose. In no event shall Waterworks be liable to any person or entity for any indirect, special, incidental or consequential damages or loss (including damages for loss of business, loss of profits, or the like), whether based on breach of contract, tort (including negligence), product liability or otherwise, even if it has been advised of the possibility of such damages. Waterworks' liability on any claim of any kind, including negligence, shall in no case exceed the contract price paid by the purchaser for the product claimed to be defective or unsuitable.