

REVISIONS

LETTER:	DESCRIPTION:	DATE:	BY:
B	REVISED FOR 601 CAR FRAME	3/31/04	MK.

12 1/4"      12 1/4"  
 17"      34"

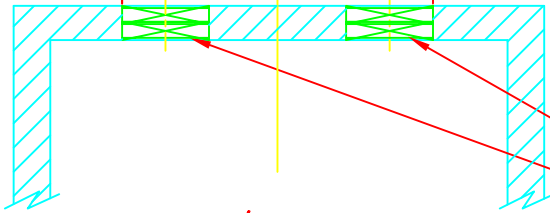

C/L RAIL

(4) 1 3/4" x 9 1/2"  
 LAMINATED VENEER LUMBER (LVL)  
 HEIGHT OF HOISTWAY IS USED  
 TO ANCHOR RAIL BRACKETS

**NOTE:**

THIS DRAWING DEPICTS SAMPLE CONSTRUCTION ONLY. IT IS THE RESPONSIBILITY OF THE INSTALLER/ CONTRACTOR OR ENGINEER TO DESIGN AND SPECIFY STRUCTURAL SUPPORTS.  
 ALL CONSTRUCTION TO BE IN COMPLIANCE WITH LOCAL CODES.

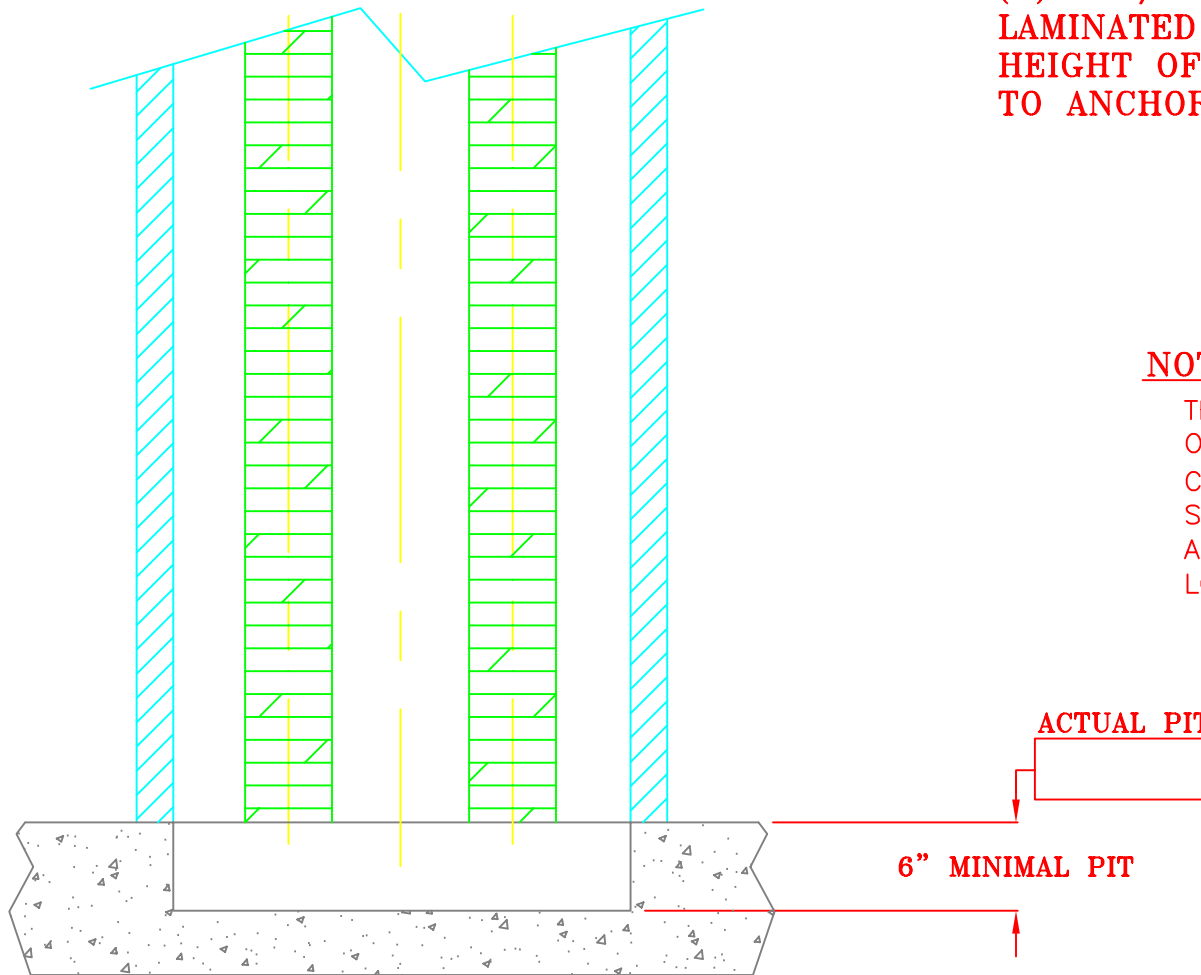

WAUPACA ELEVATOR CO., INC.		1726 North Ballard Road Appleton, WI 54911 Phone: 800-238-8739	
		Residential Elevators * Wheelchair-Compatible Elevators RESIDENTIAL AND COMMERCIAL DUMBWAITERS	
CUSTOMER:			
CONTRACTOR:			
TITLE:		PACA GLIDE TRAVEL <= 25' RAIL WALL REINFORCEMENT	
QUOTE NUMBER:			
DRAWN BY:	SCALE:	DWG. NO.	
APPD:	DATE:	C-002069	