

# MISSION COLLECTION

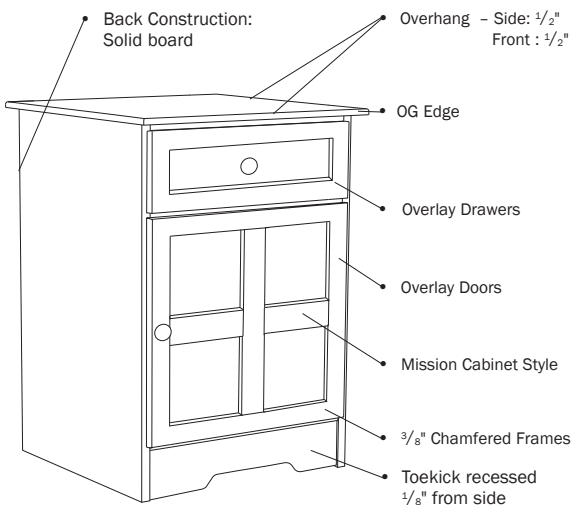

Our Mission collection of casegoods provides you with a coordinated look for your entire facility. At home in modern interiors or more traditional settings, the Mission collection does not compromise on strength or quality. The overlay doors and drawers, together with the OG edging on the top and softly rounded corners offer the quiet subtlety of perfection. The high-impact resistant polymer finish ensures that Mission casegoods are hard-wearing, and promise a scuff-resistant

surface that can be repaired within seconds – no messy sanding and refinishing. The Mission collection is fire-retardant, as we share your concerns with residents' safety. These products do not release VOC's, preserving the internal air quality of your facility. These low-maintenance products carry a 10-year warranty on the construction and finish, guaranteeing that their unassuming elegance will be appreciated day in, day out.



### Available Options (See pp. 262-264)

- Dozens of hardware styles, including soft pulls (Hardware Limitation: Cannot specify H/KNOB/002/BRASS on doors)
- Many wood-grained colors
- Contrasting edging options



Kwalu's full Environmental Statement, Technology Information and Available Options are available on our web site or contact us toll free at 1-877-695-9258.

### Primary Market

Healthcare – Long Term Care

### Cabinet Style

Mission

### Tops

- Edge Type: OG Edge
- Edge Thickness:  $\frac{3}{8}$ "
- Top Overhang: sides:  $\frac{1}{2}$ "; front:  $\frac{1}{2}$ "; back: 0"
- Corner Radius:  $\frac{1}{2}$ "

### Doors

- Door Style: Overlay
- Door Hinge: 100° self closing Euro hinge; Armoire doors: 270° non self-closing hinge
- Edge Thickness:  $\frac{1}{16}$ "

### Drawers

- Drawer Style: Overlay
- Drawer Slide: 100lb. bottom mounted Euro epoxy coated nylon rollers
- Drawer Box Sides and Back:  $\frac{5}{8}$ " board
- Drawer Bottom:  $\frac{1}{4}$ " board
- Drawer Construction: 3-piece construction; dowel and mechanical fasteners
- Drawer Pulls: ADA Compliant available
- Edge Thickness:  $\frac{1}{16}$ "

### Back Construction

Solid board

### Desk Construction

$\frac{1}{4}$ " plywood

### Joining System

Dowel and mechanical fasteners

### Screws

$\frac{1}{4}$ " nickel plated Euro-screws

### Venting

Venting on back of Bedside Cabinet with one drawer, one door only

### Levelers

4 levelers in cabinets over 30" wide and/or 48" high