

# LANCASTER COLLECTION



• Bedside Cabinet shown with optional contrasting color inserts, additional upcharge applies.

The Lancaster collection of casegoods offers the final word in subtle shaker design. Unobtrusive refinement and skilled crafting form the perfect balance between function and beauty. These notable products create a graceful environment through rich OG detailing on the tops and recessed insert panels set into chamfered frames on doors and drawers. The designer flush toe kick and gently radiused corners make this product ideally suited to healthcare. The high-impact resistant polymer finish promises a hard-

wearing, scuff-resistant surface that can be repaired in seconds – no messy sanding and refinishing. The Lancaster collection is fire-retardant, as we share your concern for resident's safety. These products do not release VOC's, preserving the internal air quality of your facility. These low-maintenance products carry a 10-year warranty on construction and finish, guaranteeing that their modest elegance will be appreciated day in, day out.

### Available Options (See pp. 262-264)

- Choose color of cabinet, edging, chamfered frames and/or inserts
- Dozens of hardware styles, including soft pulls (Hardware Limitation: Cannot specify H/KNOB/002/BRASS on doors)
- Many wood-grained colors
- Inlays – choose from existing designs or create your own
- Inserts – create your own design, or select one of ours
- Monograms or logos

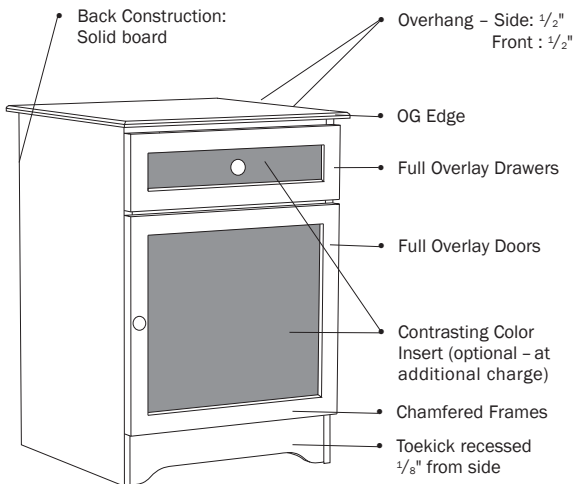

• Shown with optional contrasting insert

### Primary Market

Healthcare – Long Term Care

### Cabinet Style

Shaker

### Tops

- Edge Type: OG Edge
- Edge Thickness:  $\frac{3}{8}$ "
- Top Overhang: sides:  $\frac{1}{2}$ "; front:  $\frac{1}{2}$ "; back: 0"
- Corner Radius:  $\frac{1}{2}$ "

### Doors

- Door Style: Overlay
- Door Hinge: 100° self closing Euro hinge; Armoire doors: 270° non self closing hinge; Piano hinge also available
- Edge Thickness:  $\frac{1}{16}$ "
- Contrasting color inserts available

### Drawers

- Drawer Style: Overlay
- Drawer Slide: 100lb. bottom mounted Euro epoxy coated nylon rollers
- Drawer Box Sides and Back:  $\frac{5}{8}$ " board
- Drawer Bottom:  $\frac{1}{4}$ " Board
- Drawer Construction: 3-piece construction; dowel and mechanical fasteners
- Drawer Pulls: ADA Compliant pulls available
- Edge Thickness:  $\frac{1}{16}$ "
- Contrasting color inserts available

### Back Construction

Solid board

### Desk Construction

$\frac{1}{4}$ " plywood

### Joining System

Dowel and mechanical fasteners

### Screws

$\frac{1}{4}$ " nickel plated Euro-screws

### Venting

Venting on back of Bedside Cabinet with one drawer, one door only

### Levelers

4 levelers in cabinets over 30" wide and/or 48" high



Kwalu's full Environmental Statement, Technology Information and Available Options are available on our web site or contact us toll free at 1-877-695-9258.