

# AUBURN COLLECTION



The Auburn line of acute care furniture demonstrates the flawless blend of form and function. The gently rounded corners and waterfall edging ensures the safety of your patients. The high-impact resistant polymer finish promises a hard-wearing, scuff-resistant surface that can be repaired within seconds – no messy sanding and refinishing. The Auburn collection is fire-retardant, as we share your concerns with patient safety. These products do not release VOC's, preserving the internal air quality of your

facility. They carry a 10-year warranty on the construction and finish, making them ideal for healthcare environments.

### Available Options (See pp. 262–264)

- Dozens of hardware styles, including soft pulls
- Many wood-grained colors
- Contrasting edging options

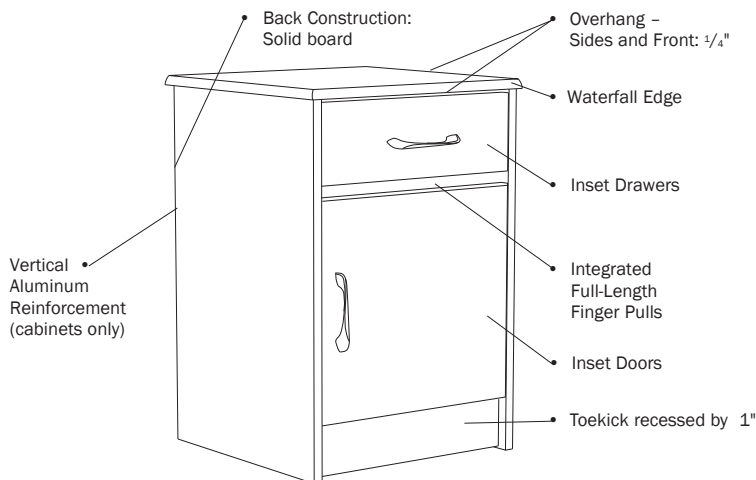

• Premium hardware shown



Kwalu's full Environmental Statement, Technology Information and Available Options are available on our web site or contact us toll free at 1-877-695-9258.

### Primary Market

Healthcare –  
Acute / Sub-Acute Care

### Cabinet Style

Transitional

### Tops

- Edge type: Waterfall
- Edge thickness:  $\frac{3}{8}$ "
- Top Overhang: sides:  $\frac{1}{4}$ "; front:  $\frac{1}{4}$ "; back: 0"
- Corner Radius:  $\frac{1}{2}$ "

### Doors

- Door style: Inset
- Door hinge: 100° self closing Euro hinge; Armoire doors: 270° non self-closing hinge
- Edge thickness:  $\frac{1}{16}$ "

### Drawers

- Drawer style: Inset
- Drawer slide: 100lb. nickel plated, side mounted full extension, ball bearing, removable slides
- Drawer box sides and back:  $\frac{5}{8}$ " board
- Drawer bottom:  $\frac{1}{4}$ " board
- Drawer construction: 3-piece construction; dowel and mechanical fasteners
- Drawer pulls: Full-length finger pulls
- Edge thickness:  $\frac{1}{16}$ "

### Back Construction

Solid board

### Joining System

Dowel and mechanical fasteners

### Vertical Aluminum Reinforcement

On all cabinets in this collection

### Screws

$\frac{1}{4}$ " nickel plated Euro-screws

### Venting

Venting on back of Bedside Cabinet with one drawer, one door only

### Levelers

4 levelers in cabinets over 30" wide and/or 48" high