

PHOENIX COLLECTION

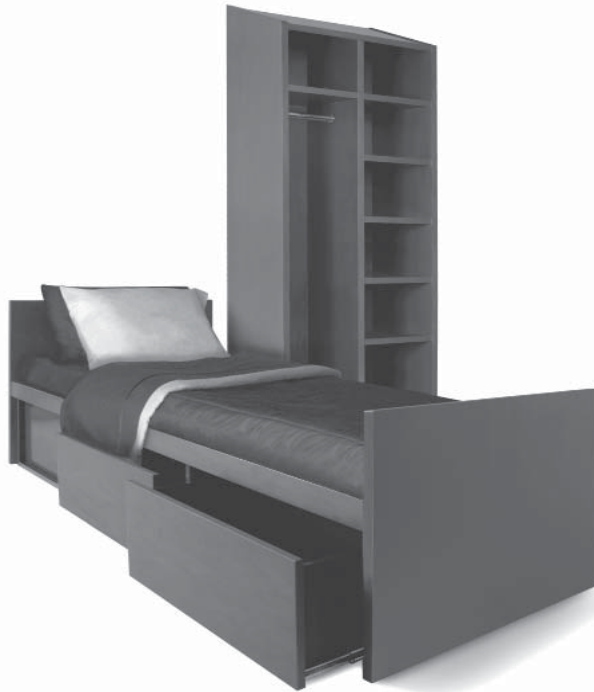

The transitional Phoenix collection is a sophisticated combination of rugged strength and refined elegance. Special features include 0.75" plywood construction for extra strength and rigidity, aluminum-reinforcement, non-removable drawers, tamper-proof screws and integrated finger pulls. Softly rounded edges on all corners and waterfall detailing make these products ideal for facilities with hard-use needs. The high-impact resistant polymer finish ensures a hard-wearing, scuff-resistant surface that can be repaired within seconds – no messy sanding and refinishing.

The Phoenix collection is fire-retardant, as we share your concern for residents' safety. These products do not release VOC's, preserving the internal air quality of your facility. They carry a 10-year warranty on the construction and finish and can be made to order, customized to suit your individual needs.

Available Options (See pp. 262–264)

- Many wood-grained colors
- Contrasting edging options

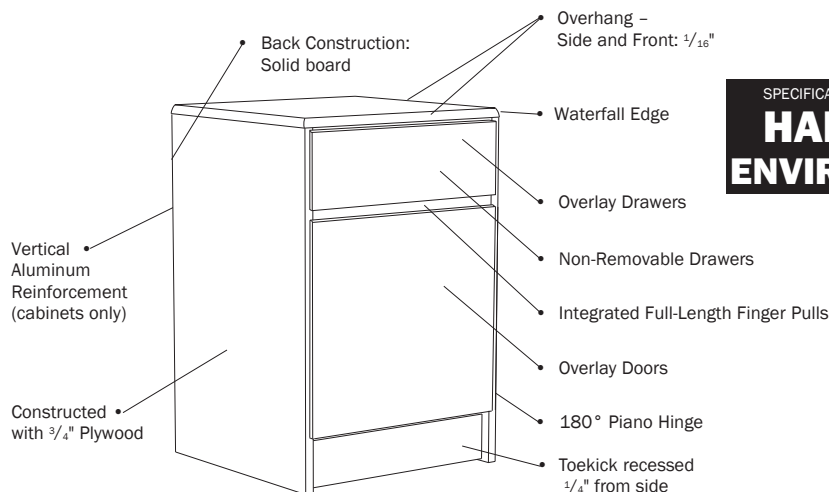

SPECIFICALLY ENGINEERED FOR
**HARD USE
ENVIRONMENTS**



Kwalu's full Environmental Statement, Technology Information and Available Options are available on our web site or contact us toll free at 1-877-695-9258.

Primary Market

Hard Use

Cabinet Style

Transitional

Tops

- Edge type: Waterfall
- Edge thickness: $\frac{3}{8}$ "
- Top overhang: sides: $\frac{1}{16}$ "; front: $\frac{1}{16}$ "; back: 0"
- Corner radius: $\frac{1}{16}$ "

Doors

- Door style: Overlay
- Door hinge: 180° piano hinge
- Door Pulls: Recessed pulls standard on wardrobes and armoires
- Edge thickness: $\frac{1}{16}$ "

Drawers

- Drawer style: Overlay
- Drawer slide: 100lb. nickel plated, side mounted full extension, ball bearing, non-removable slides
- Drawer box sides and back: $\frac{5}{8}$ " board
- Drawer bottom: $\frac{1}{4}$ " board
- Drawer construction: 3-piece construction; dowel and mechanical fasteners
- Drawer pulls: Full-length finger pulls
- Edge thickness: $\frac{1}{16}$ "

Back Construction

Solid board

Joining System

Dowel and mechanical fasteners

Vertical Aluminum Reinforcement

Aluminum support on all cabinets in this collection

Screws

$\frac{1}{4}$ " nickel plated tamper proof screws

Venting

Venting on back of Bedside Cabinet with one drawer, one door only

Levelers

4 levelers in cabinets over 30" wide and/or 48" high