

AD1

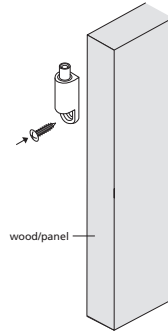

°AD1

AD1 is designed to be screwed into frames, signs or similar with a #6 screw.

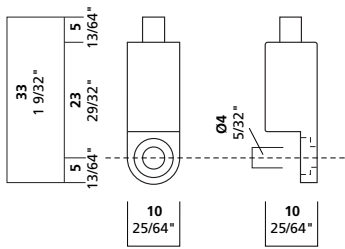

° Product Information

cable size

3/64" 1.2 mm

maximum weight

3/64": 40 lbs. 18 kg

function

midway: wood, plexiglass, metal

installation instructions

Attach to side of panel or frame with #6 screw (predrill as necessary based on material). Insert cable into gripper.

1

Arakawa Hanging Systems

2505 SE 11th Avenue, Suite 122

Portland, Oregon 97202

phone: 503.236.0440

fax: 503.236.0427

toll free: 888.272.5292

www.arakawagrip.com

Copyright © 2007 Arakawa & Co., Ltd. All rights reserved.
Arakawa products are covered by U.S. and foreign patents, issued and pending. Specification and price change privileges reserved.

