

# ELKAY® SPECIFICATIONS

## Lustertone® Single Bowl Classroom Sink and Sink Packages Single Ledge – Models DRKR2217 and DRKRQ2217 Series Models DRKAD2217 and DRKADQ2217 Series – ADA Compliant

### GENERAL

Highest quality sink bowl seamlessly formed of #18 gauge, type 304 (18-8) nickel bearing stainless steel. Self-rimming.

### CLASSROOM/INSTITUTIONAL SINK PACKAGE

Models DRKR(Q)2217LC and DRKR(Q)2217RC feature a scratch and crack resistant stainless steel sink, single handle gooseneck faucet and No Lead Flexi-Guard® Bubbler. Package includes:

- (1) LK208513L or LK208513 Single Wing Handle faucet with fixed 13" high spout and aerator. Outlet height: 9-3/8", Reach: 4-3/4".
- (1) LK1141A No Lead Flexi-Guard® Bubbler. Pushbutton valve design bubbler meets ANSI and ADA requirements. Designed so that water never comes in contact with lead-containing materials. Flexi-Guard safety bubbler flexes on impact to prevent accidental injury when getting a drink. Built-in adjustable water volume control.
- (1) LK35 Duo strainer.

DRKR(Q)2217LVRC or DRKR(Q)2217RVRC Package includes:

- (1) LKVR208513L or LKVR208513. Same as LK208513L or LK208513 faucet, except with vandal-resistant aerator and handle screw and anti-rotation feature.
- (1) LKVR1141A Same as LK1141A except vandal-resistant, with metal bubbler guard and anti-rotation feature.
- (1) LKVR18 Drain fitting with vandal-resistant 3" perforated grid strainer.

### OTHER

Drain Opening: 3-1/2".

Suffix "L" (left) or "R" (right) designates the side of the faucet that the wing handle is mounted.

Slotted holes allow for vandal-resistant faucet and bubbler.

NOTE: Unless otherwise specified, sink is furnished with 2 faucet holes as shown (see back page).

These sinks comply with ANSI Standard A112.19.3M.



Both the faucet and the bubbler are classified by Underwriters Laboratories Inc. to NSF/ANSI61 for residential use.

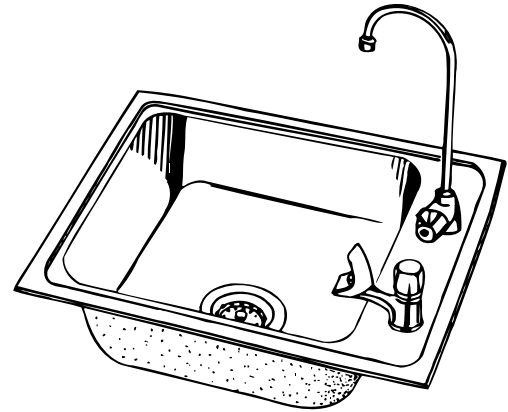

Model DRKRQ2217RC

### SINK DIMENSIONS (INCHES)\*

U-Channel Model Number	Quick-Clip® Model Number	Overall		Inside Bowl			3/2" Drain Location	Cutout in Countertop (1 1/2" Radius Corners)		No. of Faucet Holes (see back page)	Minimum Cabinet Size	Ship. Wt. Lbs.
		L	W	L	W	D		L	W			
†DRKR2217	†DRKRQ2217	22	17	16	13 1/2	7 5/8	Centered	21 3/8	16 3/8	1 or 2	27	12 3/4
DRKR2217LC	DRKRQ2217LC	22	17	16	13 1/2	7 5/8	Centered	21 3/8	16 3/8	2	27	19
DRKR2217LVRC	DRKRQ2217LVRC	22	17	16	13 1/2	7 5/8	Centered	21 3/8	16 3/8	2	27	19
DRKR2217RC	DRKRQ2217RC	22	17	16	13 1/2	7 5/8	Centered	21 3/8	16 3/8	2	27	19
DRKR2217RVRC	DRKRQ2217RVRC	22	17	16	13 1/2	7 5/8	Centered	21 3/8	16 3/8	2	27	19
†DRKAD2217	†DRKADQ2217	22	17	16	13 1/2	**	Centered	21 3/8	16 3/8	1 or 2	27	12 3/4

\* Length is left to right. Width is front to back.

\*\* Available in 5-1/2", 6" and 6-1/2" depths. Please consult your sales representative for other depths or modifications.

† Unless otherwise specified, all sinks which do not have suffix "C" are **less fittings** (no faucet, bubbler or drain), but are drilled for faucet, bubbler and drain as illustrated.

SEE OTHER SIDE FOR PRODUCT DIMENSIONS.

THIS PRODUCT, AS CONSTRUCTED IS SUBJECT TO INTERPRETATION OF A.D.A. REQUIREMENTS.  
THE UNOBSTRUCTED KNEE SPACE REQUIRED TO SATISFY A.D.A. STANDARDS MAY NOT BE DESIRABLE.

ALL DIMENSIONS IN INCHES, TO CONVERT TO MILLIMETERS MULTIPLY BY 25.4.

In keeping with our policy of continuing product improvement, Elkay reserves the right to change product specifications without notice.

This specification describes an Elkay product with design, quality and functional benefits to the user. When making a comparison of other producers' offerings, be certain these features are not overlooked.

Elkay

www.elkayusa.com

2222 Camden Court  
Oak Brook, IL 60523

Printed in U.S.A.  
©2004 Elkay

(Rev. 3/04) 1-20G

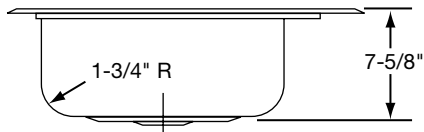
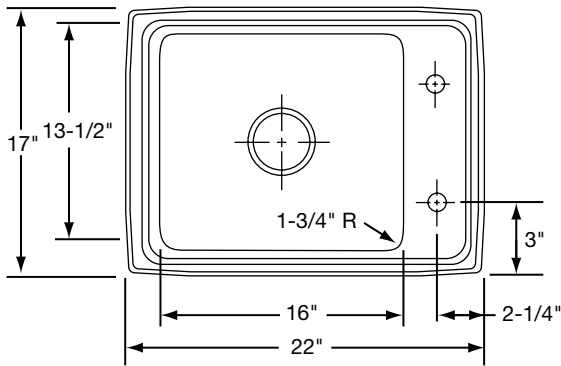

Model DRKRQ22172 Illustrated

**HOLE DRILLING CONFIGURATIONS**

**1 HOLE CONFIGURATION**

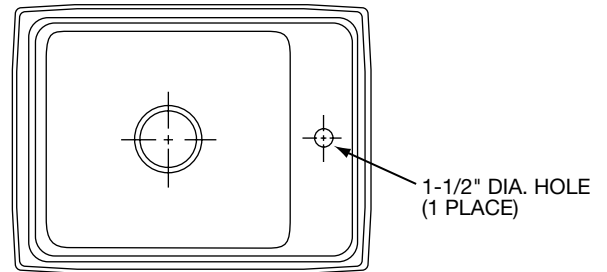

**2 HOLE CONFIGURATION**

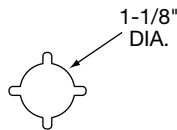
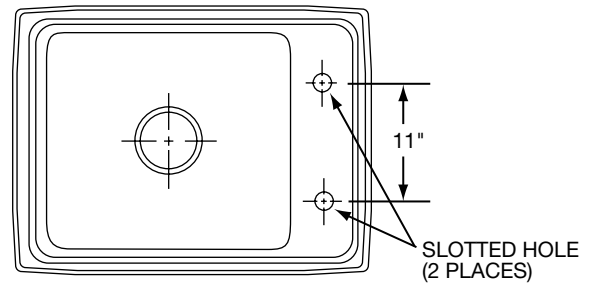

Slotted Hole

**U-Channel Type Mounting System**

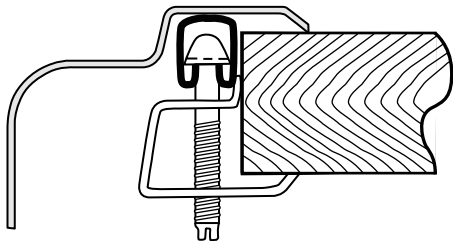

**Quick-Clip® Mounting System**

