

mini quiet ceiling
mini accurus

small aperture trimless and
flanged recessed fixtures

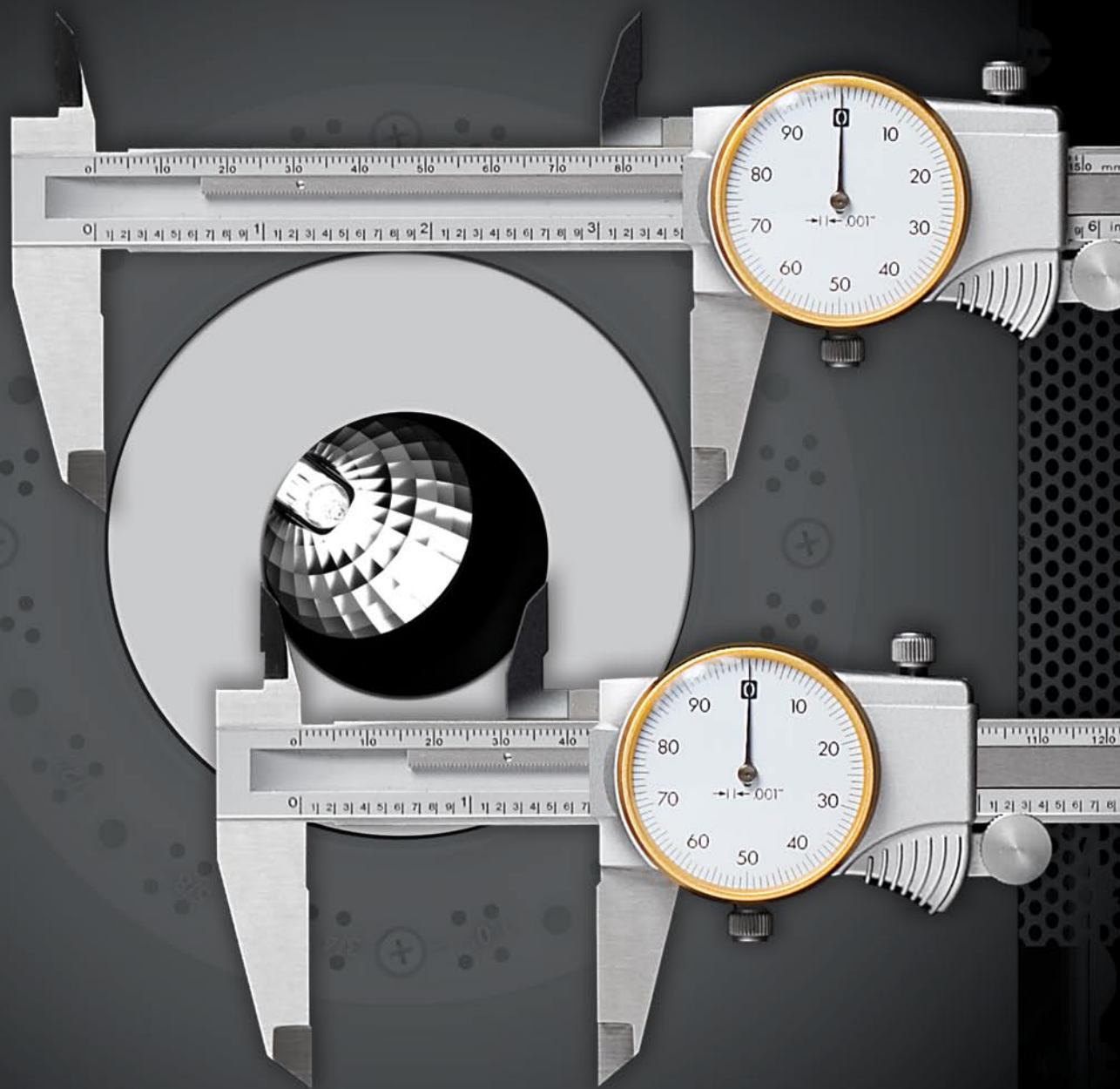

mini

The Minis offer the same high quality design and construction and many of the same features as their larger siblings in Quiet Ceiling and Accurus. What sets the Minis apart is the small aperture and overall smaller size.

These specs qualify Mini Quiet Ceiling and Mini Accurus as being among the smallest recessed MR16 trims in the industry.

Fixtures are offered in both TRIMLESS (Mini Quiet Ceiling) and FLANGED (Mini Accurus) versions. Both versions are available in round or square shapes in four styles:

- **FIXED DOWNLIGHT**
- **FIXED SHOWERLIGHT**
- **WALL WASH**
- **ADJUSTABLE DOWNLIGHT/ACCENT**

Lamps are 12V MR16 50W max, CMHMR16 Ceramic Metal Halide 20W, or ES16MH Enhanced Quartz Metal Halide 39W.

Housings for new construction, AirTite I.C., remodel and special ceiling applications are available.

FIXED DOWNLIGHT / WALL WASH / SHOWERLIGHT

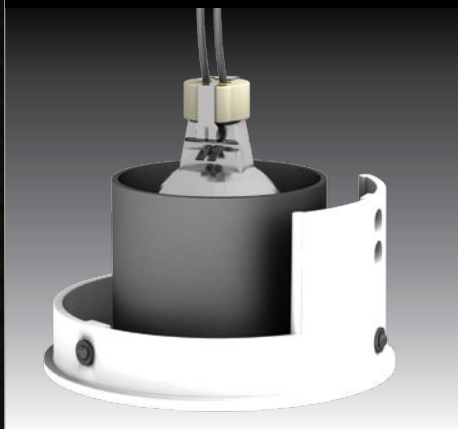

ADJUSTABLE DOWNLIGHT / ACCENT



Internal
tilt locking
mechanism



mini quiet ceiling - page 4 - 9

mini accurus - page 10 - 15



Small Aperture Trimless and Flanged Recessed Fixtures
3.5"/ 3.9" o.d. with 1.7" Aperture

MINI QUIET CEILING / MINI ACCURUS



Now available for use with three different lamp types:



12V MR16 50W max.



CMHMR16 20W*



ES16MH 39W*

* Consult factory for ballast and trim compatibility with metal halide lamps.

RSA
LIGHTING

MINI QUIET CEILING - 12V MR16 / CMHMR16 / ES16MH LAMP

Trimless

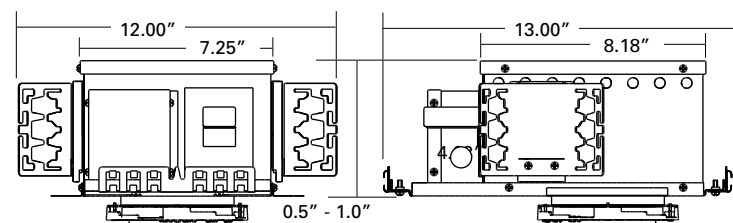

MINI QUIET CEILING NEW CONSTRUCTION HOUSING

Item #	
QCM500	New Construction for Round Trim - 12V MR16 50W max.
QCM510	New Construction for Square Trim - 12V MR16 50W max.
QCM500MH	New Construction for Round Trim - CMHMR16 / ES16MH
QCM510MH	New Construction for Square Trim - CMHMR16 / ES16MH

Low Voltage Transformer (QCM500 or QCM510 only)

ELC	12V 50W Electronic Transformer
MAG	12V 50W Magnetic Transformer

Metal Halide Ballast (QCM500MH or QCM510MH only)

20	20W Electronic Ballast for CMHMR16
39	39W Electronic Ballast ES16MH

Transformer / Ballast Primary Voltage

120	120V (Standard)
277	277V (Consult factory for 277V metal halide ballast availability)

New Construction Ordering Examples

QCM500-ELC-120 - For round trim, 12V MR16, Electronic Xfmr., 120V
QCM510MH-20-120 - For square trim, 20W CMHMR16, 120V

- For new construction applications
- Adjustable mudding ring with ceiling thickness indicators
- Perforated screw-down brackets for secure installation to drywall ceilings
- Housing includes low voltage transformer or electronic metal halide ballast and j-box.
- 120V/277V input. U.L. listed for through branch wiring.
- Housing and plaster frame constructed of 18 gauge CRS with durable powder coat finish.
- Thermal protection provided to guard against overheating and misuse of insulation. Vent holes in housing provide cooler operation.
- Includes butterfly brackets and adjustable 16 ga. steel hanger bars.
- **POSI-GRIP** GU5.3 bi-pin socket included with low voltage housings.
- **GX10** twist-lock socket included with metal halide housings.

Ceiling Cut-Out: 5.50"

Trimless

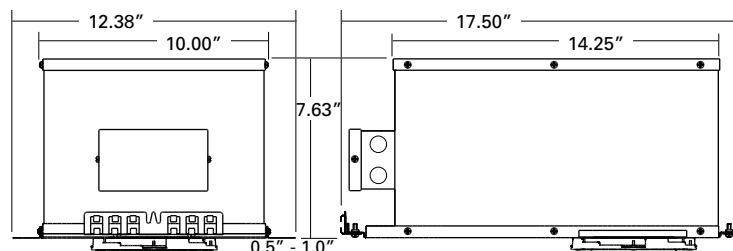

MINI QUIET CEILING INSULATED CEILING HOUSING

Item #	
QCM502IC	AirTite I.C. for Round Trim - 12V MR16 50W max.
QCM512IC	AirTite I.C. for Square Trim - 12V MR16 50W max.
QCM502ICMH	AirTite I.C. for Round Trim - CMHMR16 / ES16MH
QCM512ICMH	AirTite I.C. for Square Trim - CMHMR16 / ES16MH

Low Voltage Transformer (QCM502 or QCM512 only)

ELC	Electronic Transformer
MAG	Magnetic Transformer

Metal Halide Ballast (QCM502MH or QCM512MH only)

20	20W Electronic Ballast for CMHMR16
39	39W Electronic Ballast ES16MH

Transformer / Ballast Primary Voltage

120	120V (Standard)
277	277V (Consult factory for 277V metal halide ballast availability)

AirTite I.C. Housing Ordering Examples

QCM502IC-ELC-120 - For round trim, 12V MR16, Electronic Xfmr., 120V
QCM512ICMH-20-120 - For square trim, 20W CMHMR16, 120V

- For new construction applications with insulated ceilings
- Adjustable mudding ring with ceiling thickness indicators
- Perforated screw-down brackets for secure installation to drywall ceilings
- Housing includes low voltage transformer or electronic metal halide ballast and j-box.
- 120V/277V input. U.L. listed for through branch wiring.
- Housing and plaster frame constructed of 18 gauge CRS with durable powder coat finish.
- Thermal protection provided
- Includes adjustable 16 ga. steel hanger bars.
- **POSI-GRIP** GU5.3 bi-pin socket included with low voltage housings.
- **GX10** twist-lock socket included with metal halide housings.

Ceiling Cut-Out: 5.50"

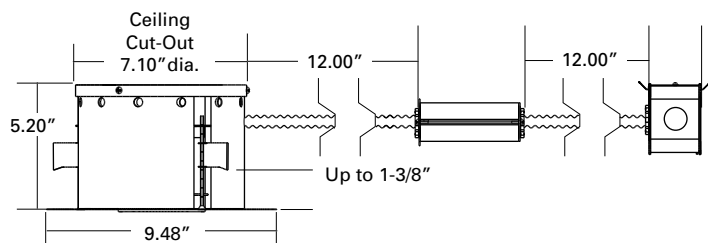
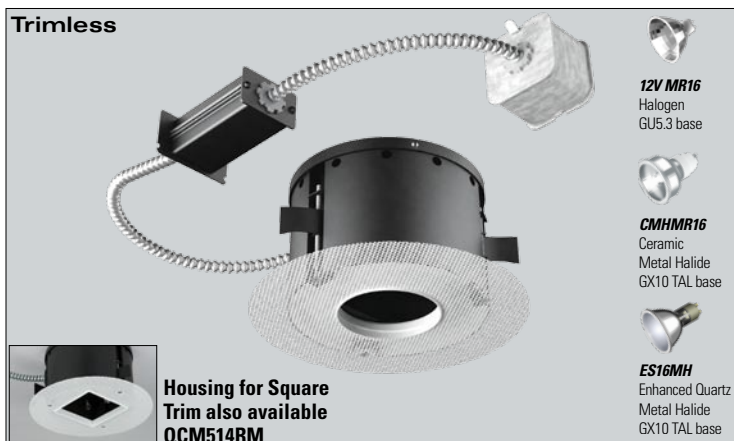

MINI QUIET CEILING REMODEL HOUSING

Item

QCM504RM	New Construction for Round Trim - 12V MR16 50W max.
QCM514RM	New Construction for Square Trim - 12V MR16 50W max.
QCM504RMMH	New Construction for Round Trim - CMHMR16/ES16MH
QCM514RMMH	New Construction for Square Trim - CMHMR16/ES16MH

Low Voltage Transformer (QCM504RM or QCM514RM only)

ELC	12V 50W Electronic Transformer
MAG	12V 50W Magnetic Transformer

Metal Halide Ballast (QCM504RMMH or QCM514RMMH only)

20	20W Electronic Ballast for CMHMR16
39	39W Electronic Ballast ES16MH

Transformer / Ballast Primary Voltage

120	120V (Standard)
277	277V (Consult factory for 277V metal halide ballast availability)

Remodel Ordering Example

QCM504RMMH-ELC-120 - For round trim, 12V MR16, Electronic Xfmr., 120V
QCM514RMMH-20-120 - For square trim, 20W CMHMR16, 120V

- For remodel applications
- Perforated flap for secure installation to drywall ceilings
- Low voltage transformer or electronic metal halide ballast is attached to housing via 12" flexible conduit. J-box is attached to transformer enclosure via 12" flexible conduit.
- 120V input. U.L. listed for through branch wiring.
- Thermal protection provided to guard against overheating and misuse of insulation.
- Adjustable "swing-out" retainer clips allow the housing to accommodate up to 1.38" ceiling thickness.
- **POSI-GRIP** GU5.3 bi-pin socket included with low voltage housings.
- **GX10** twist-lock socket included with metal halide housings.

Ceiling Cut-Out: 7.10"

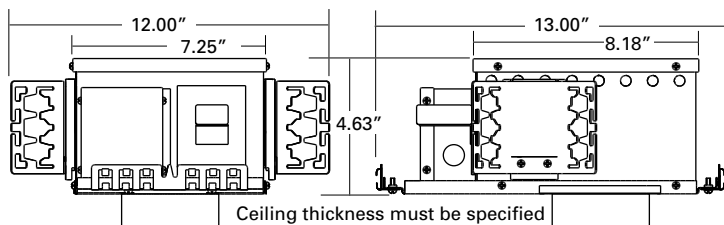

MINI QUIET CEILING SPECIAL CEILING HOUSING

Item

QCM506SP	Special Ceiling for Round Trim - 12V MR16 50W max.
QCM516SP	Special Ceiling for Square Trim - 12V MR16 50W max.
QCM506SPMH	Special Ceiling for Round Trim - CMHMR16 / ES16MH
QCM516SPMH	Special Ceiling for Square Trim - CMHMR16 / ES16MH

Low Voltage Transformer (QCM506SP or QCM516SP only)

ELC	12V 50W Electronic Transformer
MAG	12V 50W Magnetic Transformer

Metal Halide Ballast (QCM506SPMH or QCM516SPMH only)

20	20W Electronic Ballast for CMHMR16
39	39W Electronic Ballast ES16MH

Transformer / Ballast Primary Voltage

120	120V (Standard)
277	277V (Consult factory for 277V metal halide ballast availability)

Ceiling Thickness

Specify

Special Ceiling Ordering Examples

QCM506SP-ELC-120 - For round trim, 12V MR16, Electronic Xfmr., 120V
QCM516SPMH-20-120 - For square trim, 20W CMHMR16, 120V

- Suitable for special non-drywall ceiling types such as wood, marble, etc...
- Aperture ring depth is factory configured to accommodate specified ceiling thickness.
- Housing requires precise 3.641" diameter ceiling cut-out for round trim or 3.641" x 3.641" ceiling cut-out for square trim.
- Housing includes low voltage transformer or electronic metal halide ballast and j-box.
- 120V/277V input. U.L. listed for through branch wiring.
- Thermal protection provided to guard against overheating and misuse of insulation. Vent holes in housing provide cooler operation.
- Includes butterfly brackets and adjustable 16 ga. steel hanger bars.
- **POSI-GRIP** GU5.3 bi-pin socket included with low voltage housings.
- **GX10** twist-lock socket included with metal halide housings.

Ceiling Cut-Out: 3.641"

MINI QUIET CEILING - 12V MR16 / CMHMR16 / ES16MH LAMP

MINI QUIET CEILING TRIMLESS FIXTURES

Trimless

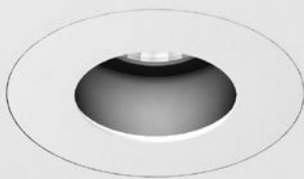

3.50" Round / 1.70" Aperture

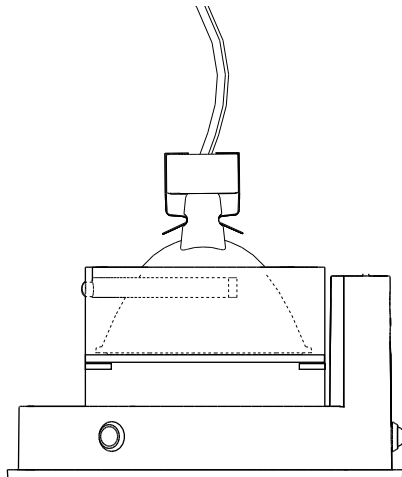
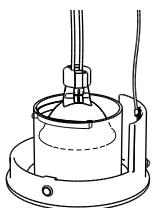

MINI QUIET CEILING - DOWNLIGHT

Item #

QCM5001 3.50" Round Fixed Downlight

Finish

WH White
BK Black
S Industrial Silver
SS Stainless Steel (painted)
PM Primer

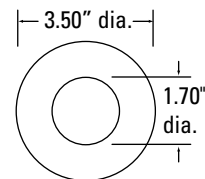

- **SMALL APERTURE** Fixed position downlight.
- Flat black powder coated internal finish reduces visibility of components from below the ceiling.
- Includes steel safety cable.
- Includes Solite™ soft focus lens. Can accept up to two (2) optical accessories. Lenses must be removed when used with metal halide lamps.
- Compatible with 12V MR16, CMHMR16 or ES16MH lamps.
- **POSI-GRIP** bi-pin lamp socket included with 12V MR16 housings.
GX10 twist-lock socket included with Metal Halide housings.

Trimless

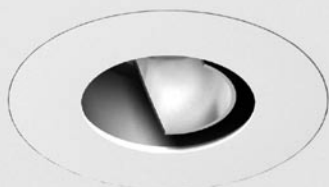

3.50" Round / 1.70" Aperture

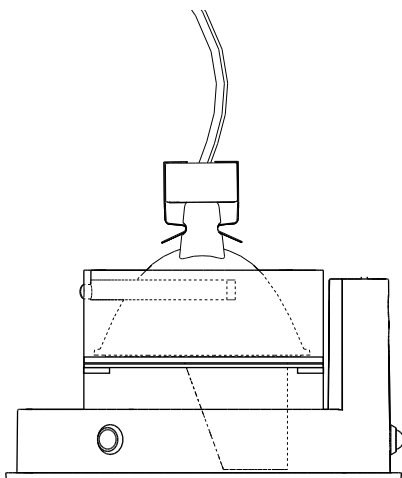
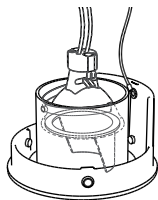

MINI QUIET CEILING - WALL WASH

Item #

QCM5002 3.50" Round Wall Wash

Finish

WH White
BK Black
S Industrial Silver
SS Stainless Steel (painted)
PM Primer

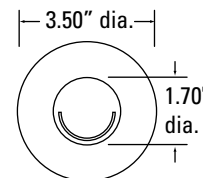

- **SMALL APERTURE** wall wash.
- Includes internal "Kicker" reflector and frosted lens for even distribution of light on a vertical surface.
- Locking alignment plate (in housing) provides 360° rotational adjustment and ensures original orientation of trim even after re-lamping.
- Flat black powder coated internal finish reduces visibility of components from below the ceiling.
- Includes steel safety cable.
- Can accept up to two (2) optical accessories.
- Compatible with 12V MR16. *Consult factory for metal halide lamps.*
- **POSI-GRIP** bi-pin lamp socket included with 12V MR16 housings.
GX10 twist-lock socket included with Metal Halide housings.

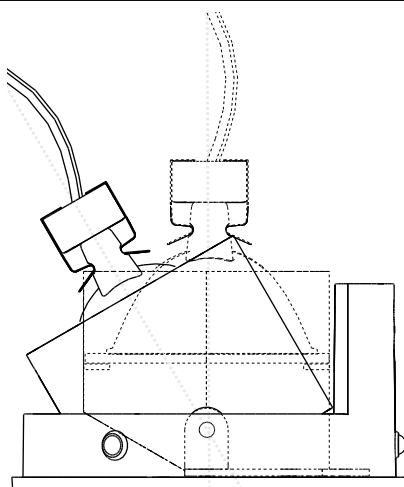
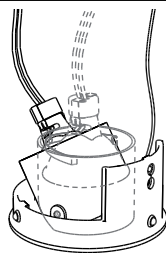

0°-30°
Tilt

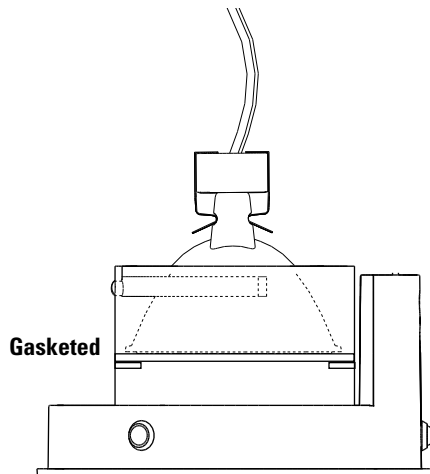
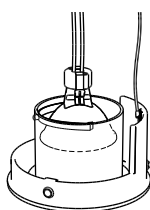
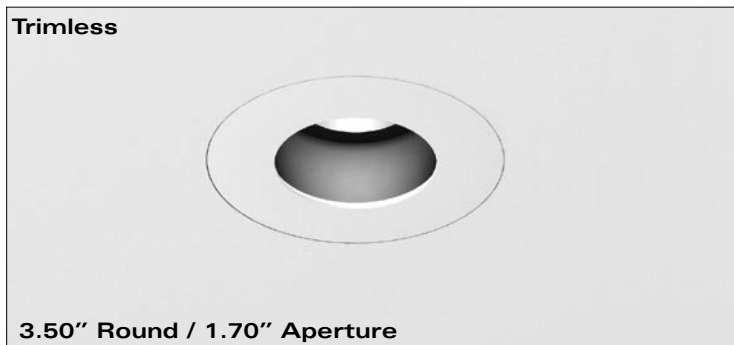

MINI QUIET CEILING - ADJUSTABLE

Item #

QCM5003 3.50" Round Adjustable

Finish

WH White
BK Black
S Industrial Silver
SS Stainless Steel (painted)
PM Primer

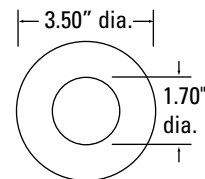

- **SMALL APERTURE** Adjustable - 0° - 30° tilt.
- Locking alignment plate (in housing) provides 360° rotational adjustment and ensures original orientation of trim even after re-lamping.
- Flat black powder coated internal finish reduces visibility of components from below the ceiling.
- Includes steel safety cable.
- Includes Solite™ soft focus lens. Can accept up to two (2) optical accessories. Lenses must be removed when used with metal halide lamps.
- Compatible with 12V MR16, CMHMR16 or ES16MH lamps.
- **POSI-GRIP** bi-pin lamp socket included with 12V MR16 housings.
GX10 twist-lock socket included with Metal Halide housings.
- Internal tilt mechanism locks with standard hex key.

MINI QUIET CEILING - SHOWERLIGHT

Item #

QCM5004 3.50" Round Fixed Showerlight

Finish

WH White
BK Black
S Industrial Silver
SS Stainless Steel (painted)
PM Primer

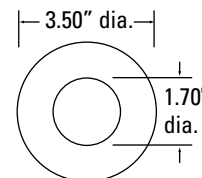

- **SMALL APERTURE** showerlight. Fixture is assembled with 1/16" closed cell silicone foam gasket for shower location installations.
- Flat black powder coated internal finish reduces visibility of components from below the ceiling.
- Includes steel safety cable.
- Solite™ soft focus lens with silicone gasket included. Can hold one (1) optical accessory total.
- Compatible with 12V MR16. Consult factory for metal halide lamps.
- **POSI-GRIP** bi-pin lamp socket included with 12V MR16 housings.
GX10 twist-lock socket included with Metal Halide housings.
- U.L. Listed for Wet Location.

MINI QUIET CEILING - 12V MR16 / CMHMR16 / ES16MH LAMP

Trimless

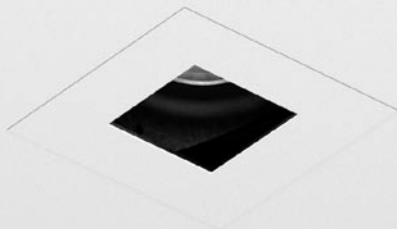

3.50" Square / 1.70" Aperture

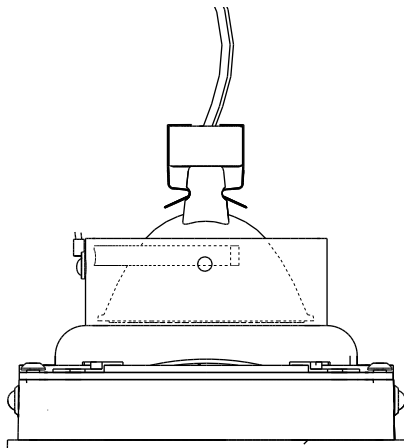
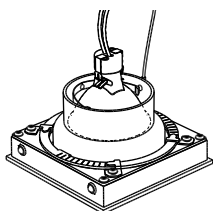

MINI QUIET CEILING - DOWNLIGHT

Item

QCM5101 3.50" Square Fixed Downlight

Finish

WH White
BK Black
S Industrial Silver
SS Stainless Steel (painted)
PM Primer

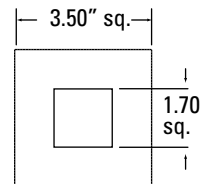

- **SMALL APERTURE** Fixed position downlight.
- Flat black powder coated internal finish reduces visibility of components from below the ceiling.
- Includes steel safety cable.
- Includes Solite™ soft focus lens. Can accept up to two (2) optical accessories. Lenses must be removed when used with metal halide lamps.
- Compatible with 12V MR16, CMHMR16 or ES16MH lamps.
- **POSI-GRIP** bi-pin lamp socket included with 12V MR16 housings.
GX10 twist-lock socket included with Metal Halide housings.

Trimless

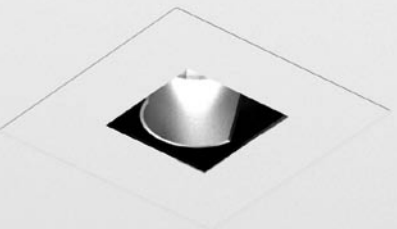

3.50" Square / 1.70" Aperture

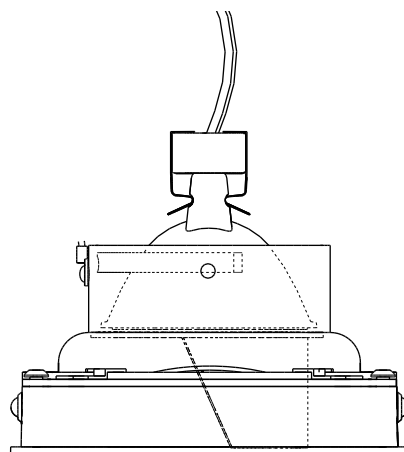
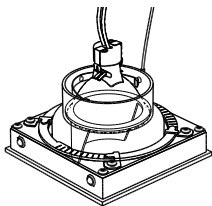

MINI QUIET CEILING - WALL WASH

Item

QCM5102 3.50" Square Wall Wash

Finish

WH White
BK Black
S Industrial Silver
SS Stainless Steel (painted)
PM Primer

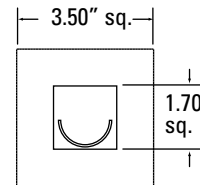

- **SMALL APERTURE** wall wash.
- Includes internal "Kicker" reflector and frosted lens for even distribution of light on a vertical surface.
- Flat black powder coated internal finish reduces visibility of components from below the ceiling.
- Includes steel safety cable.
- Can accept up to two (2) optical accessories.
- Compatible with 12V MR16. *Consult factory for metal halide lamps.*
- **POSI-GRIP** bi-pin lamp socket included with 12V MR16 housings.
GX10 twist-lock socket included with Metal Halide housings.

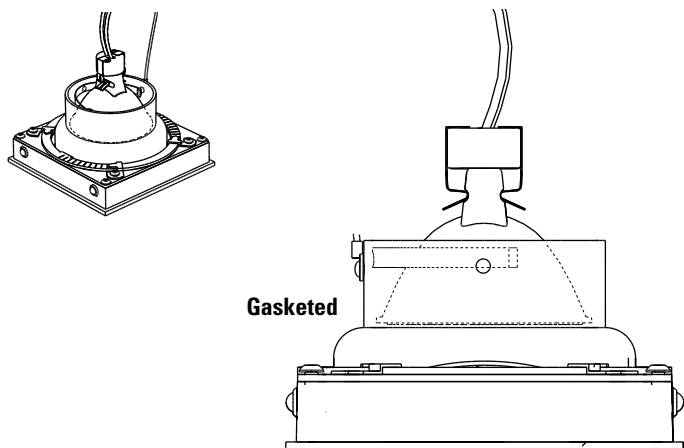
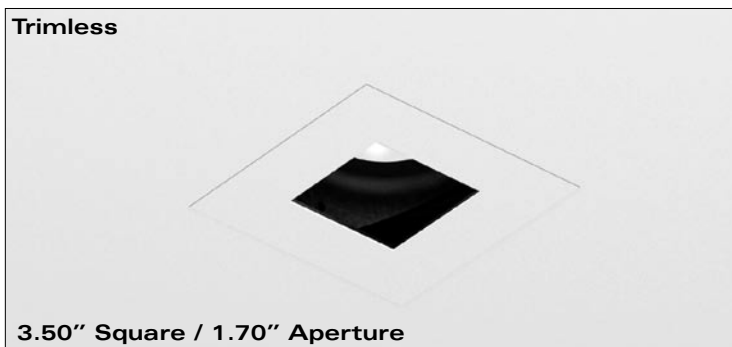
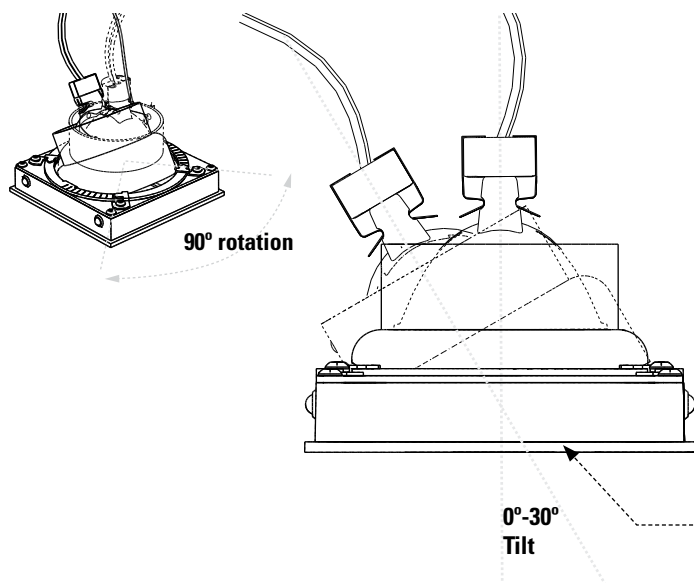
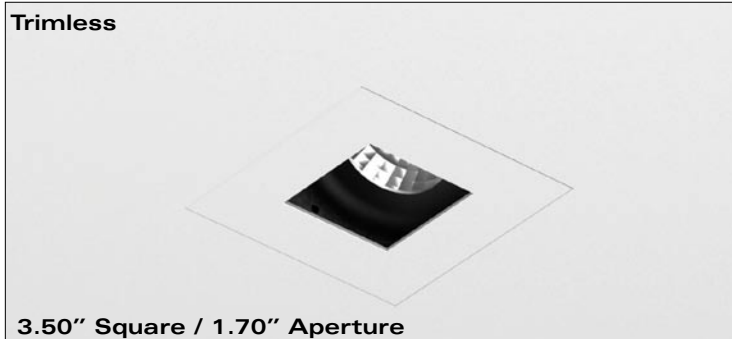

MINI QUIET CEILING - ADJUSTABLE

Item #

QCM5103 3.50" Square Adjustable

Finish

WH White
BK Black
S Industrial Silver
SS Stainless Steel (painted)
PM Primer

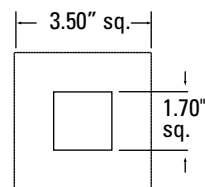

- **SMALL APERTURE** Adjustable - 0° - 30° tilt.
- Internal rotation ring with **INCREMENTAL ANGLE INDICATORS** provides 90° adjustment on the vertical axis making it possible to illuminate corners and other areas not possible with a traditional square trim.
- Flat black powder coated internal finish reduces visibility of components from below the ceiling.
- Includes steel safety cable.
- Includes Solite™ soft focus lens. Can accept up to two (2) optical accessories. Lenses must be removed when used with metal halide lamps.
- Compatible with 12V MR16, CMHMR16 or ES16MH lamps.
- **POSI-GRIP** bi-pin lamp socket included with 12V MR16 housings. **GX10** twist-lock socket included with Metal Halide housings.
- Internal tilt mechanism locks with standard hex key.

MINI QUIET CEILING - SHOWERLIGHT

Item #

QCM5104 3.50" Square Fixed Showerlight

Finish

WH White
BK Black
S Industrial Silver
SS Stainless Steel (painted)
PM Primer

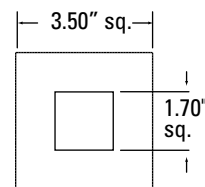

- **SMALL APERTURE** showerlight. Fixture is assembled with 1/16" closed cell silicone foam gasket for shower location installations.
- Flat black powder coated internal finish reduces visibility of components from below the ceiling.
- Includes steel safety cable.
- Solite™ soft focus lens with silicone gasket included. Can hold one (1) optical accessory total.
- Compatible with 12V MR16. Consult factory for metal halide lamps.
- **POSI-GRIP** bi-pin lamp socket included with 12V MR16 housings. **GX10** twist-lock socket included with Metal Halide housings.
- U.L. Listed for Wet Location.

MINI ACCURUS - 12V MR16 / CMHMR16 / ES16MH LAMP

MINI ACCURUS HOUSINGS

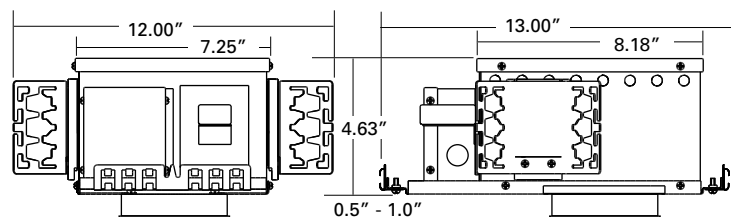

MINI ACCURUS NEW CONSTRUCTION HOUSING

Item #	
ACM500	New Construction for Round Trim - 12V MR16 50W max.
ACM510	New Construction for Square Trim - 12V MR16 50W max.
ACM500MH	New Construction for Round Trim - CMHMR16 / ES16MH
ACM510MH	New Construction for Square Trim - CMHMR16 / ES16MH

Low Voltage Transformer (ACM500 or ACM510 only)

ELC	12V 50W Electronic Transformer
MAG	12V 50W Magnetic Transformer

Metal Halide Ballast (ACM500MH or ACM510MH only)

20	20W Electronic Ballast for CMHMR16
39	39W Electronic Ballast ES16MH

Transformer / Ballast Primary Voltage

120	120V (Standard)
277	277V (Consult factory for 277V metal halide ballast availability)

New Construction Ordering Examples

ACM500-ELC-120 - For round trim, 12V MR16, Electronic Xfmr., 120V
ACM510MH-20-120 - For square trim, 20W CMHMR16, 120V

- For new construction applications
- Housing includes low voltage transformer or electronic metal halide ballast and j-box.
- 120V/277V input. U.L. listed for through branch wiring.
- Housing and plaster frame constructed of 18 gauge CRS with durable powder coat finish.
- Thermal protection provided to guard against overheating and misuse of insulation. Vent holes in housing provide cooler operation.
- Includes butterfly brackets and adjustable 16 ga. steel hanger bars.
- **POSI-GRIP** GU5.3 bi-pin socket included with low voltage housings.
- **GX10** twist-lock socket included with metal halide housings.

Ceiling Cut-Out: 3.63"

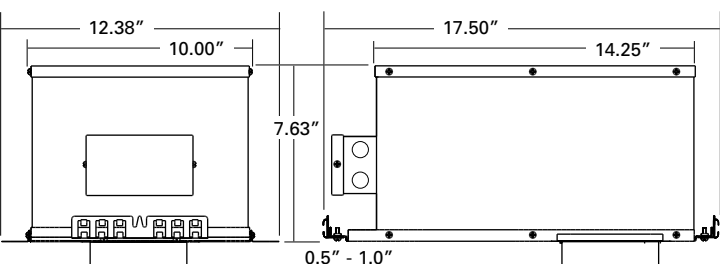

MINI ACCURUS INSULATED CEILING HOUSING

Item #	
ACM502IC	AirTite I.C. for Round Trim - 12V MR16 50W max.
ACM512IC	AirTite I.C. for Square Trim - 12V MR16 50W max.
ACM502ICMH	AirTite I.C. for Round Trim - CMHMR16 / ES16MH
ACM512ICMH	AirTite I.C. for Square Trim - CMHMR16 / ES16MH

Low Voltage Transformer (ACM502 or ACM512 only)

ELC	Electronic Transformer
MAG	Magnetic Transformer

Metal Halide Ballast (ACM502MH or ACM512MH only)

20	20W Electronic Ballast for CMHMR16
39	39W Electronic Ballast ES16MH

Transformer / Ballast Primary Voltage

120	120V (Standard)
277	277V (Consult factory for 277V metal halide ballast availability)

AirTite I.C. Housing Ordering Examples

ACM502IC-ELC-120 - For round trim, 12V MR16, Electronic Xfmr., 120V
ACM512ICMH-20-120 - For square trim, 20W CMHMR16, 120V

- For new construction applications with insulated ceilings
- Housing includes low voltage transformer or electronic metal halide ballast and j-box.
- 120V/277V input. U.L. listed for through branch wiring.
- Housing and plaster frame constructed of 18 gauge CRS with durable powder coat finish.
- Thermal protection provided
- Includes adjustable 16 ga. steel hanger bars.
- **POSI-GRIP** GU5.3 bi-pin socket included with low voltage housings.
- **GX10** twist-lock socket included with metal halide housings.

Ceiling Cut-Out: 3.63"

Flanged

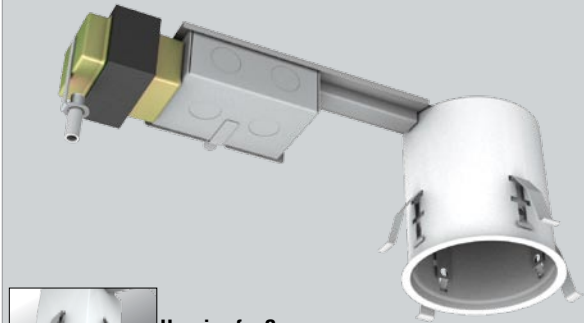

12V MR16
Halogen
GU5.3 base



CMHMR16
Ceramic
Metal Halide
GX10 TAL base



ES16MH
Enhanced Quartz
Metal Halide
GX10 TAL base



**Housing for Square
Trim also available
ACM514RM**

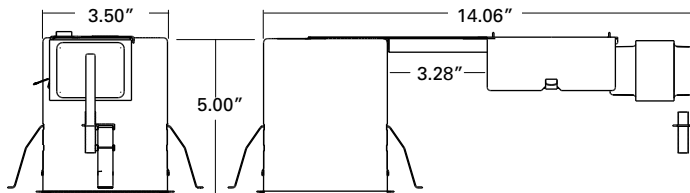

MINI ACCURUS REMODEL HOUSING

Item

ACM504RM	New Construction for Round Trim - 12V MR16 50W max.
ACM514RM	New Construction for Square Trim - 12V MR16 50W max.
ACM504RMMH	New Construction for Round Trim - CMHMR16/ES16MH
ACM514RMMH	New Construction for Square Trim - CMHMR16/ES16MH

Low Voltage Transformer (ACM504RM or ACM514RM only)

ELC	12V 50W Electronic Transformer
MAG	12V 50W Magnetic Transformer

Metal Halide Ballast (ACM504RMMH or ACM514RMMH only)

20	20W Electronic Ballast for CMHMR16
39	39W Electronic Ballast ES16MH

Transformer / Ballast Primary Voltage

120	120V (Standard)
277	277V (Consult factory for 277V metal halide ballast availability)

Remodel Ordering Examples

ACM504-ELC-120	- For round trim, 12V MR16, Electronic Xfmr., 120V
ACM514MH-20-120	- For square trim, 20W CMHMR16, 120V

- For remodel applications
- Housing adjusts vertically 1.5" to accommodate various ceiling thicknesses.
- Mechanical height adjustment for level installation
- Access above ceiling not required
- Housing includes integral low voltage transformer or electronic metal halide ballast and junction box.
- 14GA steel junction box is U.L. listed for through branch wiring for 5 #12, 90°C supply wires or 60°C supply wires for end of run
- 120V input. U.L. listed for through branch wiring.
- Housing constructed of 18 gauge CRS with durable powder coat finish.
- Thermal protection provided to guard against overheating and misuse of insulation.
- **POSI-GRIP** GU5.3 bi-pin socket included with low voltage housings.
- **GX10** twist-lock socket included with metal halide housings.

Ceiling Cut-Out: 3.68"

MINI ACCURUS - 12V MR16 / CMHMR16 / ES16MH LAMP

MINI ACCURUS TRIMS

Flanged

3.90" Round / 1.70" Aperture

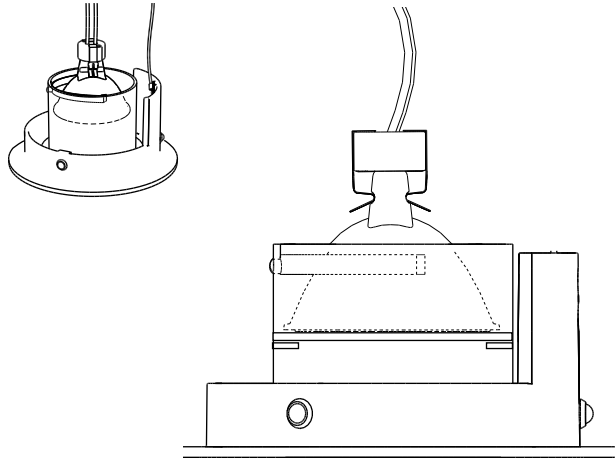

MINI ACCURUS - DOWNLIGHT

Item #

ACM5001 3.90" Round Fixed Downlight

Finish

WH White
BK Black
S Industrial Silver
SS Stainless Steel (painted)
PM Primer

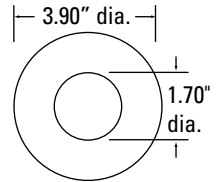

- **SMALL APERTURE** Fixed position downlight.
- Flat black powder coated internal finish reduces visibility of components from below the ceiling.
- Includes steel safety cable.
- Includes Solite™ soft focus lens. Can accept up to two (2) optical accessories. Lenses must be removed when used with metal halide lamps.
- Compatible with 12V MR16, CMHMR16 or ES16MH lamps.
- **POSI-GRIP** bi-pin lamp socket included with 12V MR16 housings.
GX10 twist-lock socket included with Metal Halide housings.

Flanged

3.90" Round / 1.70" Aperture

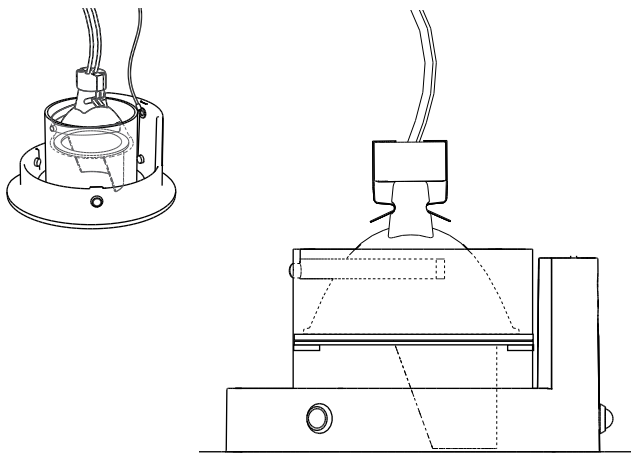

MINI ACCURUS - WALL WASH

Item #

ACM5002 3.90" Round Wall Wash

Finish

WH White
BK Black
S Industrial Silver
SS Stainless Steel (painted)
PM Primer

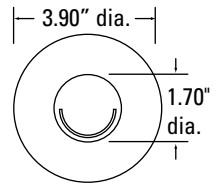

- **SMALL APERTURE** wall wash.
- Includes internal "Kicker" reflector and frosted lens for even distribution of light on a vertical surface.
- Locking alignment plate provides 360° rotational adjustment and ensures original orientation of trim even after re-lamping.
- Flat black powder coated internal finish reduces visibility of components from below the ceiling.
- Includes steel safety cable.
- Can accept up to two (2) optical accessories.
- Compatible with 12V MR16. *Consult factory for metal halide lamps.*
- **POSI-GRIP** bi-pin lamp socket included with 12V MR16 housings.
GX10 twist-lock socket included with Metal Halide housings.

Patented

Flanged



3.90" Round / 1.70" Aperture

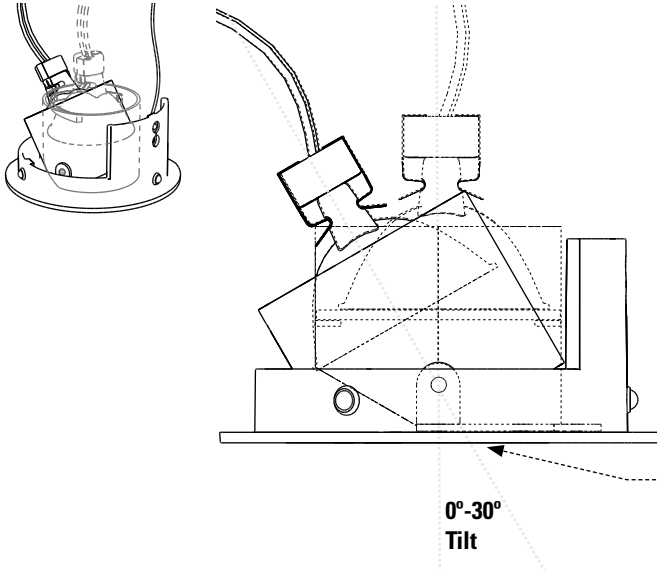

0°-30°
Tilt

MINI ACCURUS - ADJUSTABLE

Item #

ACM5003 3.90" Round Adjustable

Finish

WH White
BK Black
S Industrial Silver
SS Stainless Steel (painted)
PM Primer

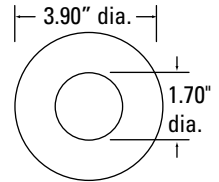

- **SMALL APERTURE** Adjustable - 0° - 30° tilt.
- Locking alignment plate provides 360° rotational adjustment and ensures original orientation of trim even after re-lamping.
- Flat black powder coated internal finish reduces visibility of components from below the ceiling.
- Includes steel safety cable.
- Includes Solite™ soft focus lens. Can accept up to two (2) optical accessories. Lenses must be removed when used with metal halide lamps.
- Compatible with 12V MR16, CMHMR16 or ES16MH lamps.
- **POSI-GRIP** bi-pin lamp socket included with 12V MR16 housings.
GX10 twist-lock socket included with Metal Halide housings.
- Internal tilt mechanism locks with standard hex key.

Flanged



3.90" Round / 1.70" Aperture

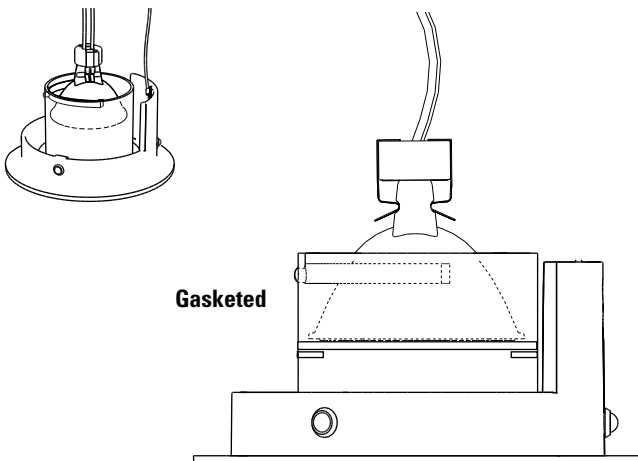

Gasketed

MINI ACCURUS - SHOWERLIGHT

Item #

ACM5004 3.90" Round Fixed Showerlight

Finish

WH White
BK Black
S Industrial Silver
SS Stainless Steel (painted)
PM Primer

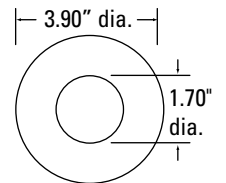

- **SMALL APERTURE** showerlight. Fixture is assembled with 1/16" closed cell silicone foam gasket for shower location installations.
- Flat black powder coated internal finish reduces visibility of components from below the ceiling.
- Includes steel safety cable.
- Solite™ soft focus lens with silicone gasket included. Can hold one (1) optical accessory total.
- Compatible with 12V MR16. Consult factory for metal halide lamps.
- **POSI-GRIP** bi-pin lamp socket included with 12V MR16 housings.
GX10 twist-lock socket included with Metal Halide housings.
- U.L. Listed for Wet Location.

Patented

MINI ACCURUS - 12V MR16 / CMHMR16 / ES16MH LAMP

MINI ACCURUS TRIMS

Flanged

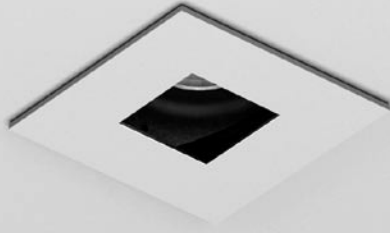

3.90" Square / 1.70" Aperture

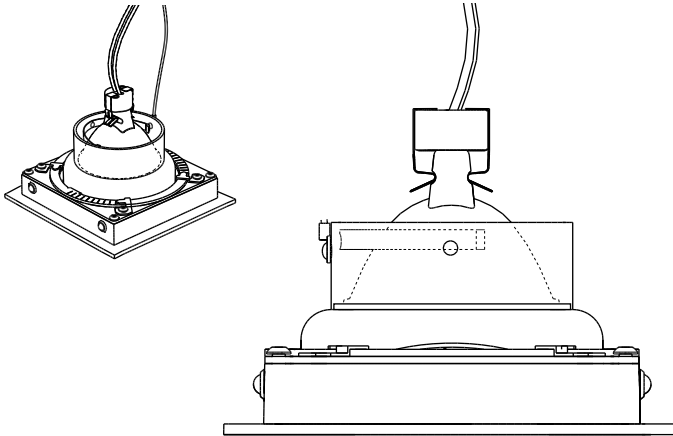

MINI ACCURUS - DOWNLIGHT

Item #

ACM5101 3.90" Square Fixed Downlight

Finish

WH White
BK Black
S Industrial Silver
SS Stainless Steel (painted)
PM Primer

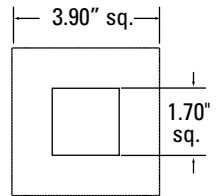

- **SMALL APERTURE** Fixed position downlight.
- Flat black powder coated internal finish reduces visibility of components from below the ceiling.
- Includes steel safety cable.
- Includes Solite™ soft focus lens. Can accept up to two (2) optical accessories. Lenses must be removed when used with metal halide lamps.
- Compatible with 12V MR16, CMHMR16 or ES16MH lamps.
- **POSI-GRIP** bi-pin lamp socket included with 12V MR16 housings.
GX10 twist-lock socket included with Metal Halide housings.

Flanged



3.90" Square / 1.70" Aperture

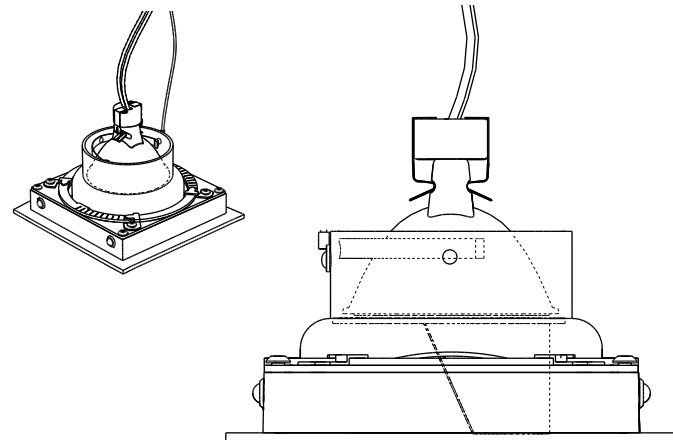

MINI ACCURUS - WALL WASH

Item #

ACM5102 3.90" Square Wall Wash

Finish

WH White
BK Black
S Industrial Silver
SS Stainless Steel (painted)
PM Primer

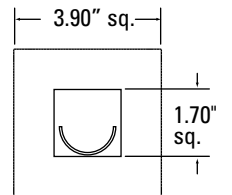

- **SMALL APERTURE** wall wash.
- Includes internal "Kicker" reflector and frosted lens for even distribution of light on a vertical surface.
- Flat black powder coated internal finish reduces visibility of components from below the ceiling.
- Includes steel safety cable.
- Can accept up to two (2) optical accessories.
- Compatible with 12V MR16. *Consult factory for metal halide lamps.*
- **POSI-GRIP** bi-pin lamp socket included with 12V MR16 housings.
GX10 twist-lock socket included with Metal Halide housings.

Patented

Flanged

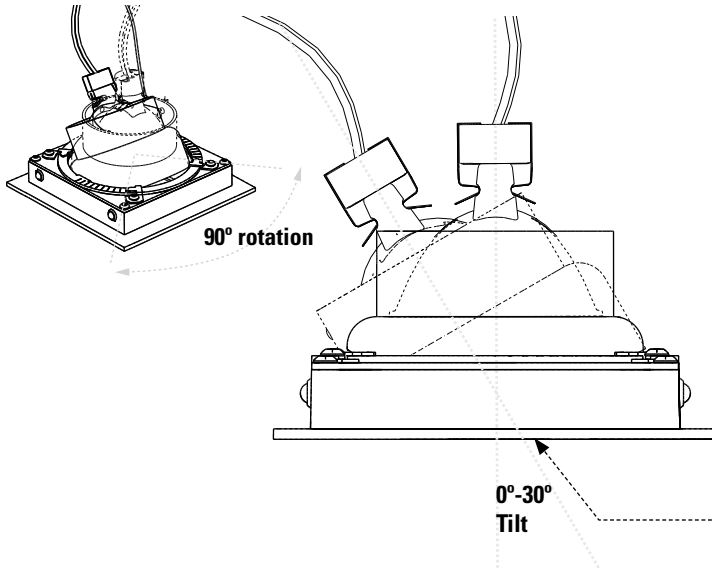
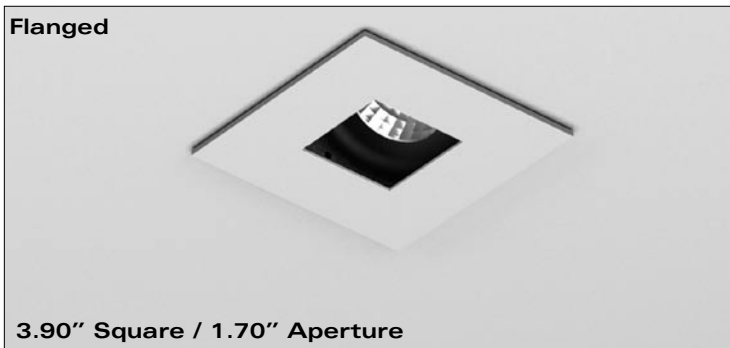

MINI ACCURUS - ADJUSTABLE

Item #

ACM5103 3.90" Square Adjustable

Finish

WH White
BK Black
S Industrial Silver
SS Stainless Steel (painted)
PM Primer

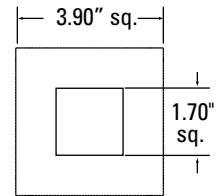

- **SMALL APERTURE** Adjustable - 0° - 30° tilt.
- Internal rotation ring with **INCREMENTAL ANGLE INDICATORS** provides 90° adjustment on the vertical axis making it possible to illuminate corners and other areas not possible with a traditional square trim.
- Flat black powder coated internal finish reduces visibility of components from below the ceiling.
- Includes steel safety cable.
- Includes Solite™ soft focus lens. Can accept up to two (2) optical accessories. Lenses must be removed when used with metal halide lamps.
- Compatible with 12V MR16, CMHMR16 or ES16MH lamps.
- **POSI-GRIP** bi-pin lamp socket included with 12V MR16 housings. **GX10** twist-lock socket included with Metal Halide housings.
- Internal tilt mechanism locks with standard hex key.

Flanged

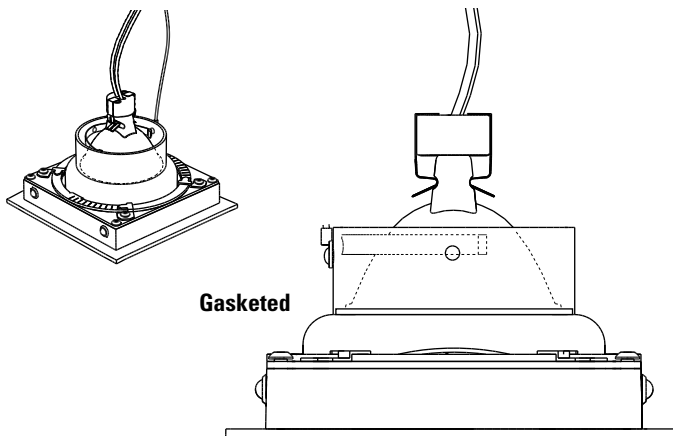
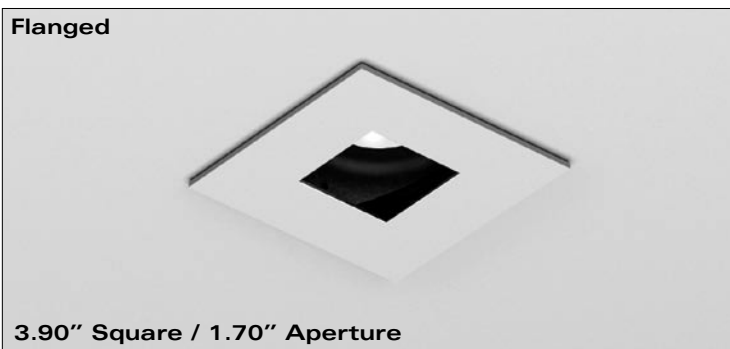

MINI ACCURUS - SHOWERLIGHT

Item #

ACM5104 3.90" Square Fixed Showerlight

Finish

WH White
BK Black
S Industrial Silver
SS Stainless Steel (painted)
PM Primer

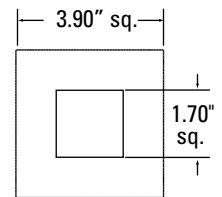

- **SMALL APERTURE** showerlight. Fixture is assembled with 1/16" closed cell silicone foam gasket for shower location installations.
- Flat black powder coated internal finish reduces visibility of components from below the ceiling.
- Includes steel safety cable.
- Solite™ soft focus lens with silicone gasket included. Can hold one (1) optical accessory total.
- Compatible with 12V MR16. Consult factory for metal halide lamps.
- **POSI-GRIP** bi-pin lamp socket included with 12V MR16 housings. **GX10** twist-lock socket included with Metal Halide housings.
- U.L. Listed for Wet Location.

**RSA LIGHTING**

7945 Orion Ave.
Van Nuys, California 91406
818 349 3030
818 349 3031 Fax

CUSTOMER FIRST CENTER

1121 Highway 74 South
Peachtree City, Georgia 30269
770 486 4800
770 486 4801 Fax

Domestic Facilities, USA

Cranbury, New Jersey
Elk Grove Village, Illinois
Irving, Texas
Ontario, California
Peachtree City, Georgia

International Sales, USA

Peachtree City, Georgia

CANADA

Cooper Lighting
5925 McLaughlin Road
Mississauga, Ontario L5R 1B8
905 507 4000
905 568 7049 Fax

Domestic Facilities, Canada

Calgary, Alberta
Chomedey, Laval P.Q.

Cooper Lighting, Inc.
All rights reserved

Specifications and dimensions subject
to change without notice.

Printed in USA.

The Cooper Lighting Family

Halo
Cooper Lighting-Metalux
Cooper Lighting-Lumark
Cooper Lighting-Sure Lites
Neo-Ray
Corelite
Portfolio
Iris
Shaper
Lumière
Invue
McGraw-Edison
Fail-Safe
MWS
DLS
RSA
Ametrix



www.cooperlighting.com
www.rsalighting.com

