

### ACCURUS SLOT APERTURE

#### Item #

**ACT1685** 5" 45° adjustable slot aperture - MR16 71W max.

**ACT1685MH** 5" 45° adjustable slot aperture - ES16MH

#### Finish

**WH** White  
**BK** Black  
**S** Industrial Silver  
**SS** Stainless Steel (painted)  
**PM** Primer

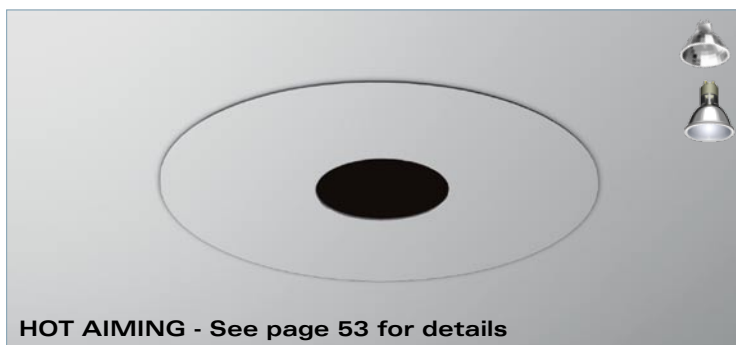

### ACCURUS PINHOLE

#### Item #

**ACT1785** 5" 45° adjustable pinhole - MR16 71W max.

**ACT1785MH** 5" 45° adjustable pinhole - ES16MH

#### Finish

**WH** White  
**BK** Black  
**S** Industrial Silver  
**SS** Stainless Steel (painted)  
**PM** Primer



### ACCURUS DOWNLIGHT

#### Item #

**ACT1985** 5" 15° adjustable downlight - MR16 71W max.

**ACT1985MH** 5" 15° adjustable downlight - ES16MH

#### Finish

**WH** White  
**BK** Black  
**S** Industrial Silver  
**SS** Stainless Steel (painted)  
**PM** Primer

#### Reflector Finish

**Clear Alzak®**



### ACCURUS TRUNCATED CONE

#### Item #

**ACT2085** 5" adjustable truncated cone - MR16 71W max.

**ACT2085MH** 5" adjustable truncated cone - ES16MH

#### Finish

**WH** White  
**BK** Black  
**S** Industrial Silver  
**SS** Stainless Steel (painted)  
**PM** Primer

#### Reflector Finish

**Etched Aluminum**



### ACCURUS ADJUSTABLE SQUARE

#### Item #

**ACT1885** 5" 45° adjustable square - MR16 71W max.

**ACT1885MH** 5" 45° adjustable square - ES16MH

#### Finish

**WH** White  
**BK** Black  
**S** Industrial Silver  
**SS** Stainless Steel (painted)  
**PM** Primer

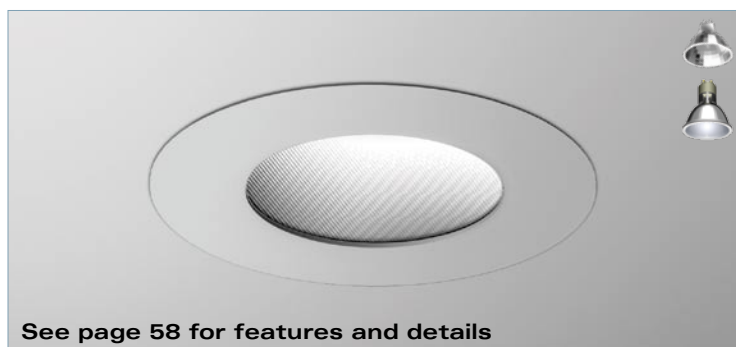

## ACCURUS ROUND SHOWERLIGHT

### Item #

**ACT1986** 5" adjustable round showerlight - MR16 37W max.

**ACT1986MH** 5" adjustable round showerlight - ES16MH

### Finish

**WH** White  
**BK** Black  
**S** Industrial Silver  
**SS** Stainless Steel (painted)  
**PM** Primer

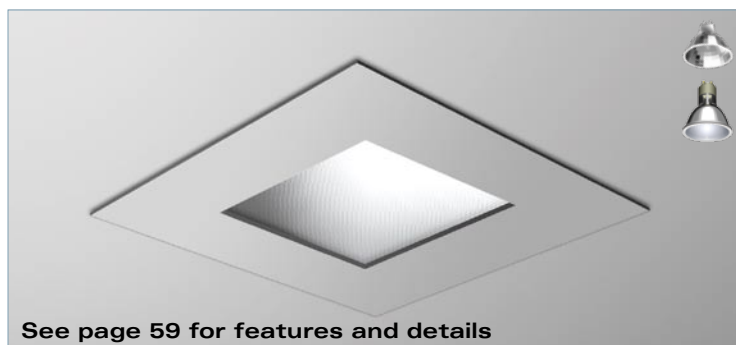

## ACCURUS SQUARE SHOWERLIGHT

### Item #

**ACT1886** 5" adjustable square showerlight - MR16 37W max.

**ACT1886MH** 5" adjustable square showerlight - ES16MH

### Finish

**WH** White  
**BK** Black  
**S** Industrial Silver  
**SS** Stainless Steel (painted)  
**PM** Primer

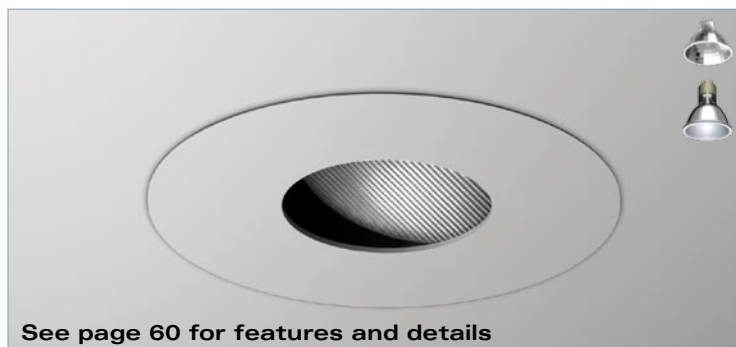

## ACCURUS ROUND WALLWASHER

### Item #

**ACT2185** 5" lensed round wallwasher - MR16 50W max.

**ACT2185MH** 5" lensed round wallwasher - ES16MH

### Finish

**WH** White  
**BK** Black  
**S** Industrial Silver  
**SS** Stainless Steel (painted)  
**PM** Primer

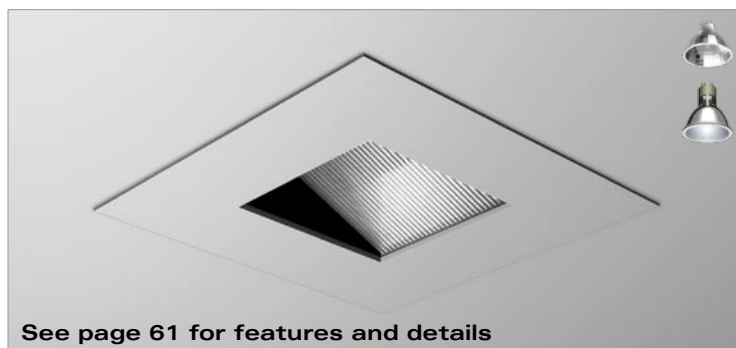

## ACCURUS SQUARE WALLWASHER

### Item #

**ACT2285** 5" lensed square wallwasher - MR16 50W max.

**ACT2285MH** 5" lensed square wallwasher - ES16MH

### Finish

**WH** White  
**BK** Black  
**S** Industrial Silver  
**SS** Stainless Steel (painted)  
**PM** Primer



## ACCURUS ROUND ADJUSTABLE - AR70

### Item #

**ACT2385** 5" 35° adjustable round - AR70 50W max.

### Finish

**WH** White  
**BK** Black  
**S** Industrial Silver  
**SS** Stainless Steel (painted)  
**PM** Primer

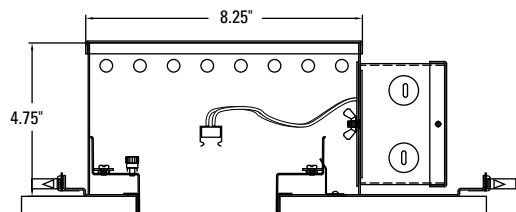
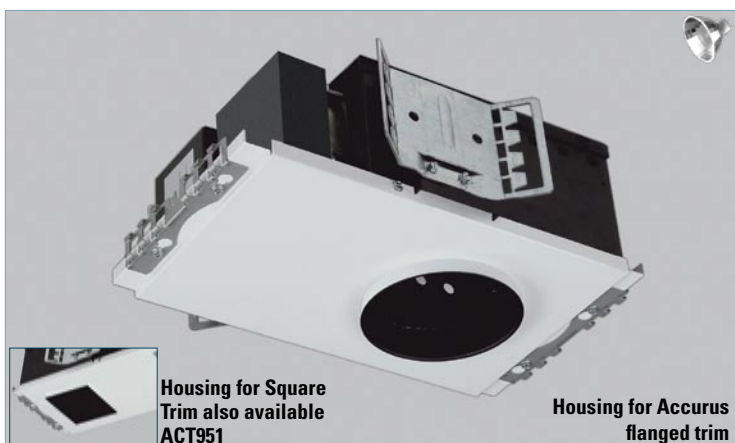

Housing adjusts in plaster frame to accommodate various ceiling thicknesses.

### NEW CONSTRUCTION HOUSING DIMENSIONS

HEIGHT	LENGTH	WIDTH	CEILING CUT-OUT
4.75"	13.75"	9.75"	4.50" dia. or sq.

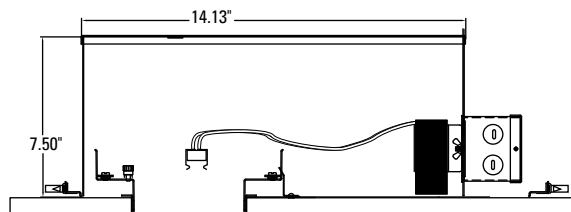

Housing adjusts in plaster frame to accommodate varying ceiling thicknesses.

### INSULATED CEILING HOUSING DIMENSIONS

HEIGHT	LENGTH	WIDTH	CEILING CUT-OUT
7.50"	17.13"	10.75"	4.50" dia. or sq.

### ACCURUS NEW CONSTRUCTION HOUSING

#### Item #

- ACT950** New Construction Housing for Round Trim - for MR16 Lamp 71 watts max.
- ACT951** New Construction Housing for Square Trim - for MR16 Lamp 71 watts max.

#### Voltage

- 120** 120V (Standard)
- 277** 277V

#### Ordering Example

#### ACT950-120

Accurus new construction housing for MR16, 120 volts

- For new construction applications
- Housing includes integral transformer and junction box.
- 120V input. U.L. listed for through branch wiring.
- Housing and plaster frame constructed of 18 gauge CRS with durable powder coat finish.
- Thermal protection provided to guard against overheating and misuse of insulation. Vent holes in housing provide cooler operation.
- Sound attenuator on magnetic transformer reduces hum.
- Includes butterfly brackets and adjustable 16 ga. steel hanger bars.

**MAGNETIC TRANSFORMER IS STANDARD. ELECTRONIC AND Q-TRAN TRANSFORMERS ARE AVAILABLE UPON REQUEST.**

### ACCURUS INSULATED CEILING HOUSING

#### Item #

- ACT952IC** IC Housing for Round Trim - for MR16 Lamp 50 watts max.
- ACT953IC** IC Housing for Square Trim - for MR16 Lamp 50 watts max.

#### Voltage

- 120** 120V (Standard)
- 277** 277V

#### Ordering Example

#### ACT952IC-120

Accurus Insulated Ceiling housing for MR16, 120 volts

- For new construction applications with insulated ceilings
- Housing includes integral transformer and junction box.
- 120V input. U.L. listed for through branch wiring.
- Housing and plaster frame constructed of 18 gauge CRS with durable powder coat finish.
- Thermal protection provided.
- Includes adjustable 16 ga. steel hanger bars.
- Sound attenuator on magnetic transformer reduces hum.

**MAGNETIC TRANSFORMER IS STANDARD. ELECTRONIC AND Q-TRAN TRANSFORMERS ARE AVAILABLE UPON REQUEST.**

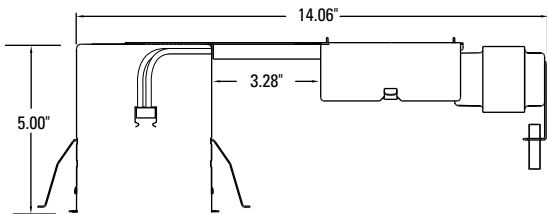
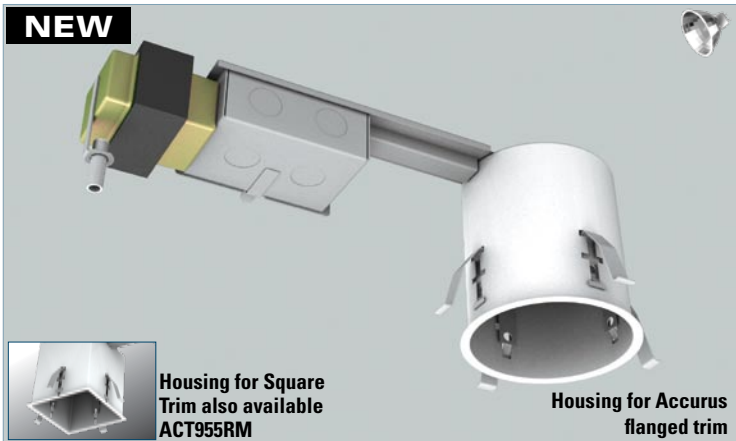

Housing adjusts to accommodate various ceiling thicknesses.

REMODEL HOUSING DIMENSIONS			
HEIGHT	LENGTH	WIDTH	CEILING CUT-OUT
5.00" (4.50" required above ceiling)	14.06"	2.73" (j-box)	4.18" (dia. or sq.)

ACCURUS REMODEL HOUSING - MR16

Item #	
<b>ACT954RM</b>	Remodel Housing for Round Trim - for MR16 Lamp 50 watts max.
<b>ACT955RM</b>	Remodel Housing for Square Trim - for MR16 Lamp 50 watts max.
Voltage	
<b>120</b>	120V (Standard)
<b>277</b>	277V
Ordering Example	
<b>ACT954RM-120</b>	
Accurus remodel housing for MR16, 120 volts	

- For remodel applications
- Housing adjusts vertically 1.5" to accommodate various ceiling thicknesses.
- Mechanical height adjustment for level installation
- Access above ceiling not required
- Housing includes integral transformer and junction box.
- 14GA steel junction box is U.L. listed for through branch wiring for 5 #12, 90°C supply wires or 60°C supply wires for end of run
- 120V input. U.L. listed for through branch wiring.
- Housing constructed of 18 gauge CRS with durable powder coat finish.
- Thermal protection provided to guard against overheating and misuse of insulation.
- Sound attenuator on magnetic transformer reduces hum.
- Includes butterfly brackets and adjustable 16 ga. steel hanger bars.

MAGNETIC TRANSFORMER IS STANDARD. ELECTRONIC AND Q-TRAN TRANSFORMERS ARE AVAILABLE UPON REQUEST.

# ACCURUS - 12V AR70 LAMP

**NEW**

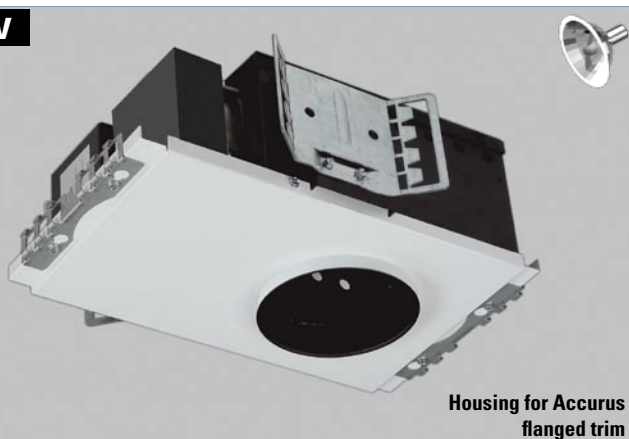

Housing for Accurus flanged trim

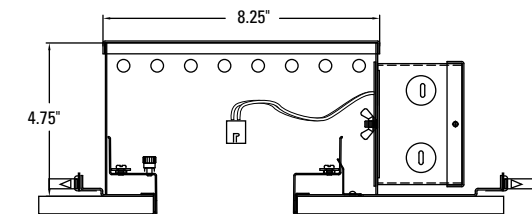

Housing adjusts in plaster frame to accommodate various ceiling thicknesses.

## NEW CONSTRUCTION HOUSING DIMENSIONS

HEIGHT	LENGTH	WIDTH	CEILING CUT-OUT
4.75"	13.75"	9.75"	4.50" dia.

**NEW**



Housing for Accurus flanged trim

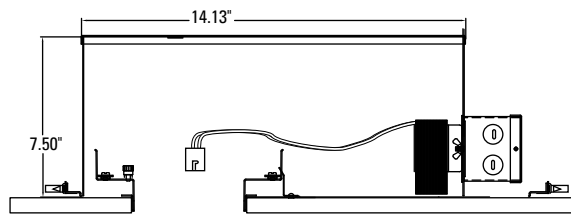

Housing adjusts in plaster frame to accommodate varying ceiling thicknesses.

## INSULATED CEILING HOUSING DIMENSIONS

HEIGHT	LENGTH	WIDTH	CEILING CUT-OUT
7.50"	17.13"	10.75"	4.50" dia.

## ACCURUS NEW CONSTRUCTION HOUSING

Item #

**ACT960** New Construction Housing for Round Trim - for AR70 Lamp 50 watts max.

Voltage

**120** 120V (Standard)

**277** 277V

Ordering Example

**ACT960-120**

Accurus new construction housing for AR70, 120 volts

- For new construction applications
- Housing includes integral transformer and junction box.
- 120V input. U.L. listed for through branch wiring.
- Housing and plaster frame constructed of 18 gauge CRS with durable powder coat finish.
- Thermal protection provided to guard against overheating and misuse of insulation. Vent holes in housing provide cooler operation.
- Sound attenuator on magnetic transformer reduces hum.
- Includes butterfly brackets and adjustable 16 ga. steel hanger bars.

**MAGNETIC TRANSFORMER IS STANDARD. ELECTRONIC AND Q-TRAN TRANSFORMERS ARE AVAILABLE UPON REQUEST.**

## ACCURUS INSULATED CEILING HOUSING

Item #

**ACT962IC** IC Housing for Round Trim - for AR70 Lamp 50 watts max.

Voltage

**120** 120V (Standard)

**277** 277V

Ordering Example

**ACT962IC-120**

Accurus Insulated Ceiling housing for AR70, 120 volts

- For new construction applications with insulated ceilings
- Housing includes integral transformer and junction box.
- 120V input. U.L. listed for through branch wiring.
- Housing and plaster frame constructed of 18 gauge CRS with durable powder coat finish.
- Thermal protection provided.
- Includes adjustable 16 ga. steel hanger bars.
- Sound attenuator on magnetic transformer reduces hum.

**MAGNETIC TRANSFORMER IS STANDARD. ELECTRONIC AND Q-TRAN TRANSFORMERS ARE AVAILABLE UPON REQUEST.**

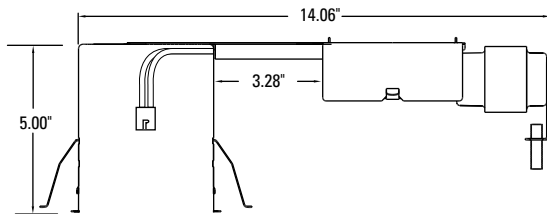
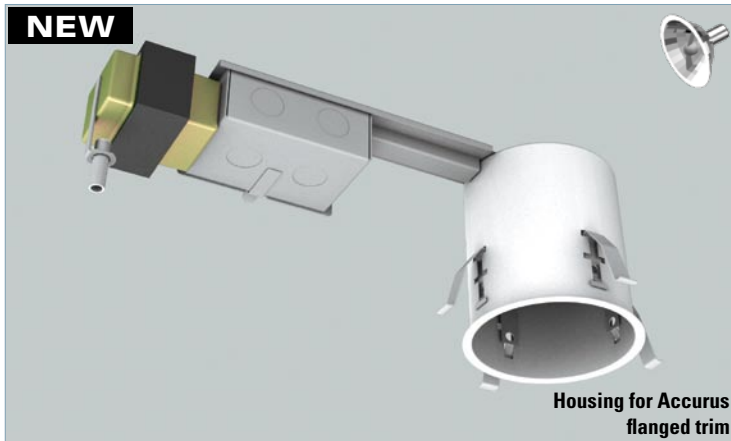

Housing adjusts to accommodate various ceiling thicknesses.

### REMODEL HOUSING DIMENSIONS

HEIGHT	LENGTH	WIDTH	CEILING CUT-OUT
5.00" (4.50" required above ceiling)	14.06"	2.73" (j-box)	4.18" dia.

### ACCURUS REMODEL HOUSING - AR70

#### Item #

**ACT964RM** Remodel Housing for Round Trim - for AR70 Lamp 50 watts max.

#### Voltage

**120** 120V (Standard)

**277** 277V

#### Ordering Example

**ACT964RM-120**

Accurus remodel housing for AR70, 120 volts

- For remodel applications
- Housing adjusts vertically 1.5" to accommodate various ceiling thicknesses.
- Mechanical height adjustment for level installation
- Access above ceiling not required
- Housing includes integral transformer and junction box.
- 14GA steel junction box is U.L. listed for through branch wiring for 5 #12, 90°C supply wires or 60°C supply wires for end of run
- 120V input. U.L. listed for through branch wiring.
- Housing constructed of 18 gauge CRS with durable powder coat finish.
- Thermal protection provided to guard against overheating and misuse of insulation.
- Sound attenuator on magnetic transformer reduces hum.

**MAGNETIC TRANSFORMER IS STANDARD. ELECTRONIC AND Q-TRAN TRANSFORMERS ARE AVAILABLE UPON REQUEST.**



**NEW**

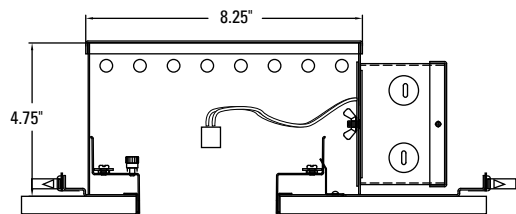
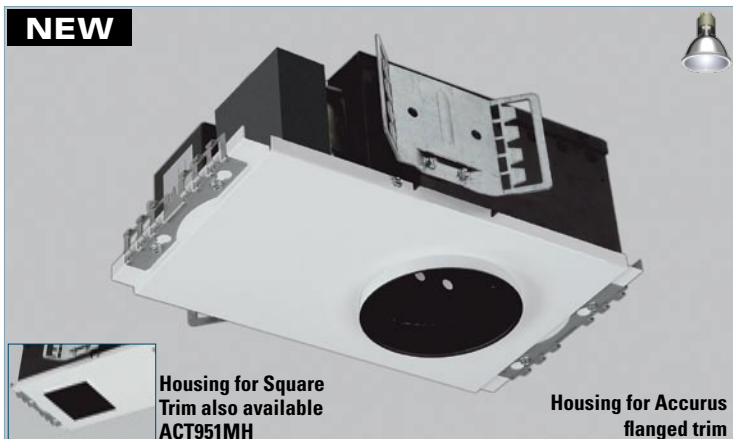

Housing adjusts in plaster frame to accommodate various ceiling thicknesses.

• Configured with integral electronic metal halide ballasts

### NEW CONSTRUCTION HOUSING DIMENSIONS

HEIGHT	LENGTH	WIDTH	CEILING CUT-OUT
4.75"	13.75"	9.75"	4.50" dia. or sq.

**NEW**

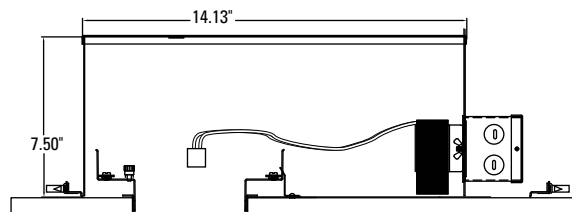

Housing adjusts in plaster frame to accommodate varying ceiling thicknesses.

• Configured with integral electronic metal halide ballasts

### INSULATED CEILING HOUSING DIMENSIONS

HEIGHT	LENGTH	WIDTH	CEILING CUT-OUT
7.50"	17.13"	10.75"	4.50" dia. or sq.

### ACCURUS NEW CONSTRUCTION HOUSING

Item #

**ACT950MH** New Construction Housing for Round Trim - for ES16MH Lamp

**ACT951MH** New Construction Housing for Square Trim - for ES16MH Lamp

Wattage

**20** 20 Watt ES16 Metal Halide

**39** 39 Watt ES16 Metal Halide

Voltage

**120** 120V (Standard)

**277** 277V

Ordering Example

**ACT950MH-39-120**

Accurus new construction housing, Ballast for 39 Watt ES16 metal halide lamp, 120 volts

- For new construction applications
- Housing includes metal halide ballast and junction box.
- 120V input. U.L. listed for through branch wiring.
- Housing and plaster frame constructed of 18 gauge CRS with durable powder coat finish.
- Thermal protection provided to guard against overheating and misuse of insulation. Vent holes in housing provide cooler operation.
- Includes butterfly brackets and adjustable 16 ga. steel hanger bars.

### ACCURUS INSULATED CEILING HOUSING

Item #

**ACT952ICMH** IC Housing for Round Trim - for ES16MH Lamp

**ACT953ICMH** IC Housing for Square Trim - for ES16MH Lamp

Wattage

**20** 20 Watt ES16 Metal Halide

**39** 39 Watt ES16 Metal Halide

Voltage

**120** 120V (Standard)

**277** 277V

Ordering Example

**ACT952ICMH-39-120**

Accurus Insulated Ceiling housing, Ballast for 39 Watt ES16 metal halide lamp, 120 volts

- For new construction applications with insulated ceilings
- Housing includes metal halide ballast and junction box.
- 120V input. U.L. listed for through branch wiring.
- Housing and plaster frame constructed of 18 gauge CRS with durable powder coat finish.
- Thermal protection provided.
- Includes adjustable 16 ga. steel hanger bars.

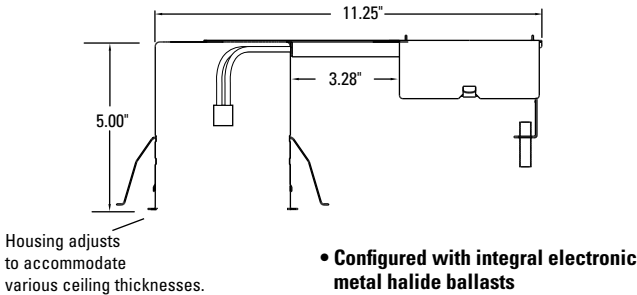

REMODEL HOUSING DIMENSIONS			
HEIGHT	LENGTH	WIDTH	CEILING CUT-OUT
5.00" (4.50" required above ceiling)	11.25"	3.75" (j-box & ballast)	4.18" dia.

ACCURUS REMODEL HOUSING - Metal Halide

Item #	
ACT954RMMH	Remodel Housing for Round Trim - for ES16MH Lamp
ACT955RMMH	Remodel Housing for Square Trim - for ES16MH Lamp

Wattage	
20	20 Watt ES16 Metal Halide
39	39 Watt ES16 Metal Halide

Voltage	
120	120V (Standard)
277	277V

Ordering Example  
**ACT954RMMH-39-120**  
Accurus remodel housing, Ballast for 39 Watt ES16 metal halide lamp, 120 volts

- For remodel applications
- Housing adjusts vertically 1.5" to accommodate various ceiling thicknesses.
- Mechanical height adjustment for level installation
- Access above ceiling not required
- Housing includes electronic metal halide ballast and junction box.
- 14GA steel junction box is U.L. listed for through branch wiring for 5 #12, 90°C supply wires or 60°C supply wires for end of run
- 120V input. U.L. listed for through branch wiring.
- Housing constructed of 18 gauge CRS with durable powder coat finish.
- Thermal protection provided to guard against overheating and misuse of insulation.



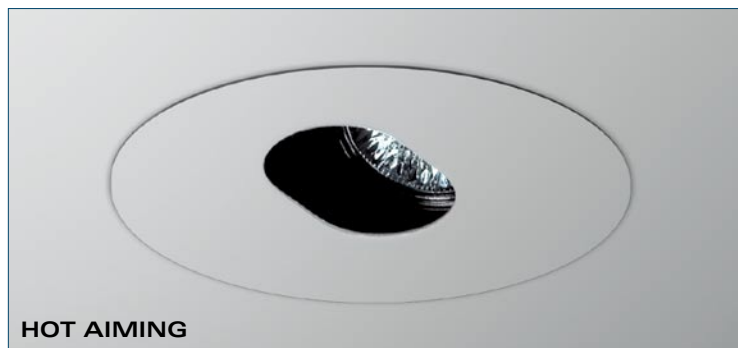

### ACCURUS - SLOT APERTURE

#### Item #

**ACT1685** 5" 45° adjustable slot aperture - MR16 71W max.

**ACT1685MH** 5" 45° adjustable slot aperture - ES16MH

#### Finish

<b>WH</b>	White
<b>BK</b>	Black
<b>S</b>	Industrial Silver
<b>SS</b>	Stainless Steel (painted)
<b>PM</b>	Primer

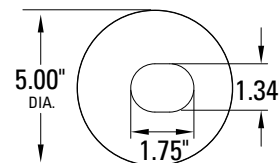

### Feature

- 1) Thin, 0.04" faceplate provides a virtually flush installation.
- 2) Alignment plate ensures original orientation of trim even after re-lamping.
- 3) 45° locking rack-and-pinion angle adjustment mechanism with hot aiming feature.
- 4) Can accommodate up to 3 optical accessories.
- 5) Flat black powder coated internal finish reduces visibility of components from below the ceiling.
- 6) "POSI-GRIP" bi-pin lamp socket for firm, mechanical lamp connection. (included with MR16 housings)
- 7) Includes steel safety cable

- Hot Aiming enables the lamp to be adjusted with an ordinary phillips screw-driver while the power is on.

### ACCURUS HOUSINGS



**ACT950 - (MR16)**  
**ACT950MH - (ES16MH)**  
NEW CONSTRUCTION

see page 46-51 for details



**ACT952IC - (MR16)**  
**ACT952ICMH - (ES16MH)**  
INSULATED CEILING

see page 46-51 for details

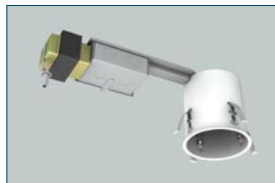

**ACT954RM - (MR16)**  
**ACT954RMMH - (ES16MH)**  
REMODEL

see page 46-51 for details

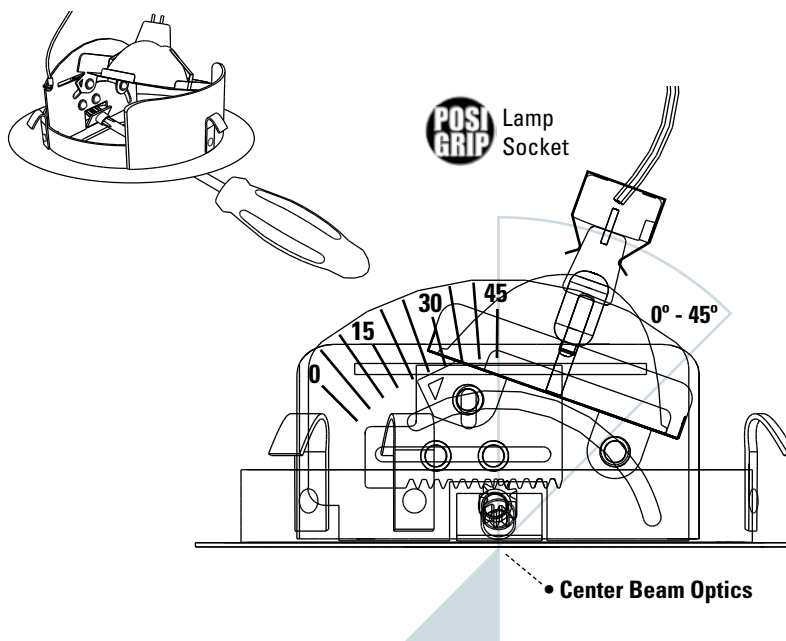

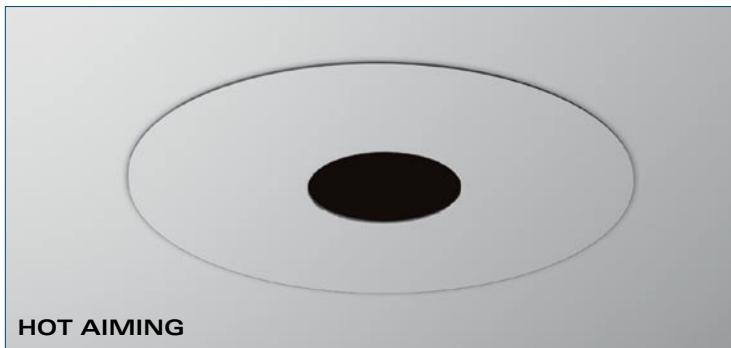

## ACCURUS - PINHOLE

### Item #

**ACT1785** 5" 45° adjustable pinhole - MR16 71W max.

**ACT1785MH** 5" 45° adjustable pinhole - ES16MH

### Finish

<b>WH</b>	White
<b>BK</b>	Black
<b>S</b>	Industrial Silver
<b>SS</b>	Stainless Steel (painted)
<b>PM</b>	Primer

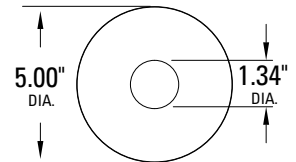

## Features

- 1) Thin, 0.04" faceplate provides a virtually flush installation.
- 2) Alignment plate ensures original orientation of trim even after re-lamping.
- 3) 45° locking rack-and-pinion angle adjustment mechanism with hot aiming feature.
- 4) Can accommodate up to 3 optical accessories.
- 5) Flat black powder coated internal finish reduces visibility of components from below the ceiling.
- 6) "POSI-GRIP" bi-pin lamp socket for firm, mechanical lamp connection. (included with MR16 housings)
- 7) Includes steel safety cable



- Hot Aiming enables the lamp to be adjusted with an ordinary phillips screw-driver while the power is on.

## ACCURUS HOUSINGS

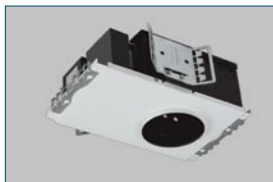

**ACT950 - (MR16)**  
**ACT950MH - (ES16MH)**  
NEW CONSTRUCTION

see page 46-51 for details



**ACT952IC - (MR16)**  
**ACT952ICMH - (ES16MH)**  
INSULATED CEILING

see page 46-51 for details

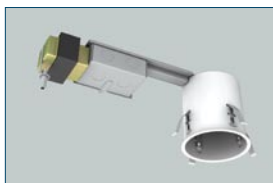

**ACT954RM - (MR16)**  
**ACT954RMMH - (ES16MH)**  
REMODEL

see page 46-51 for details

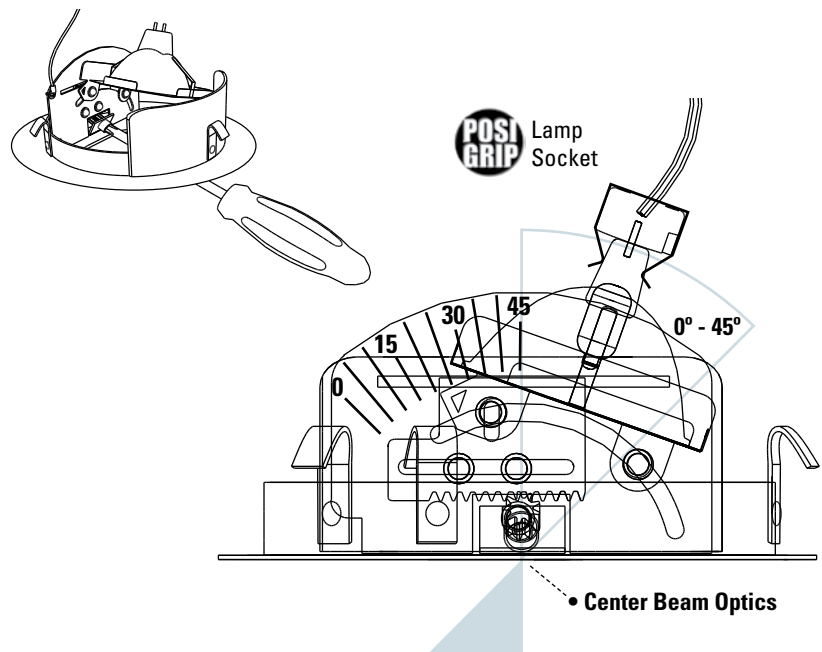



## ACCURUS - DOWNLIGHT

### Item #

**ACT1985** 5" 15° adjustable downlight - MR16 71W max.

**ACT1985MH** 5" 15° adjustable downlight - ES16MH

### Finish

<b>WH</b>	White
<b>BK</b>	Black
<b>S</b>	Industrial Silver
<b>SS</b>	Stainless Steel (painted)
<b>PM</b>	Primer

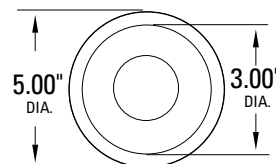

## Features

- 1) Thin, 0.04" faceplate provides a virtually flush installation.
- 2) Locking alignment plate provides 360° rotational adjustment and ensures original orientation of trim even after re-lamping.
- 3) Locking adjustment knob with angle indicators allows +/- 15° adjustability
- 4) Clear Alzak® reflector
- 5) Can accommodate up to 3 optical accessories.
- 6) Flat black powder coated internal finish reduces visibility of components from below the ceiling.
- 7) "POSI-GRIP" bi-pin lamp socket for firm, mechanical lamp connection. (included with MR16 housings)
- 8) Includes steel safety cable

## ACCURUS HOUSINGS

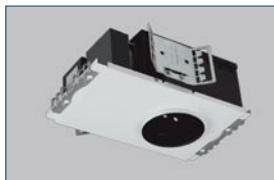

**ACT950 - (MR16)**  
**ACT950MH - (ES16MH)**  
NEW CONSTRUCTION

see page 46-51 for details



**ACT952IC - (MR16)**  
**ACT952ICMH - (ES16MH)**  
INSULATED CEILING

see page 46-51 for details

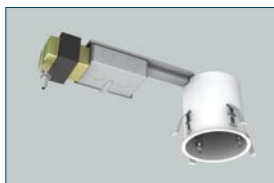

**ACT954RM - (MR16)**  
**ACT954RMMH - (ES16MH)**  
REMODEL

see page 46-51 for details

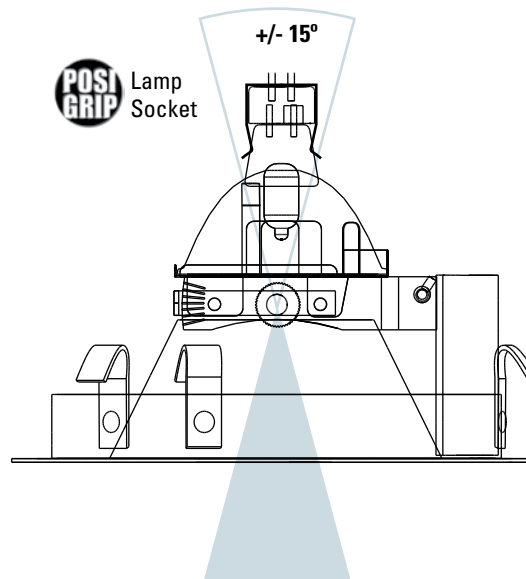



## ACCURUS - TRUNCATED CONE

### Item #

**ACT2085** 5" adjustable truncated cone - MR16 71W max.

**ACT2085MH** 5" adjustable truncated cone - ES16MH

### Finish

<b>WH</b>	White
<b>BK</b>	Black
<b>S</b>	Industrial Silver
<b>SS</b>	Stainless Steel (painted)
<b>PM</b>	Primer

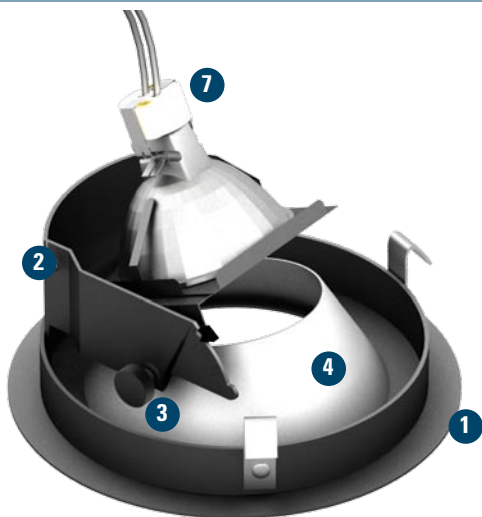
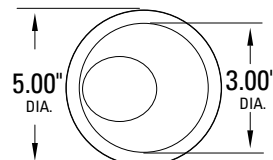

## Features

- 1) Thin, 0.04" faceplate provides a virtually flush installation.
- 2) Locking alignment plate provides 360° rotational adjustment and ensures original orientation of trim even after re-lamping.
- 3) Locking adjustment knob with angle indicators allows +/- 15° adjustability
- 4) Etched aluminum reflector is cut at a 35° angle.
- 5) Can accommodate up to 3 optical accessories.
- 6) Flat black powder coated internal finish reduces visibility of components from below the ceiling.
- 7) "POSI-GRIP" bi-pin lamp socket for firm, mechanical lamp connection. (included with MR16 housings)
- 8) Includes steel safety cable

## ACCURUS HOUSINGS

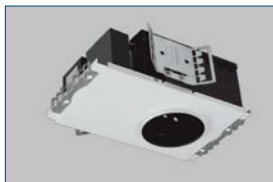

**ACT950 - (MR16)**  
**ACT950MH - (ES16MH)**  
NEW CONSTRUCTION

see page 46-51 for details



**ACT952IC - (MR16)**  
**ACT952ICMH - (ES16MH)**  
INSULATED CEILING

see page 46-51 for details

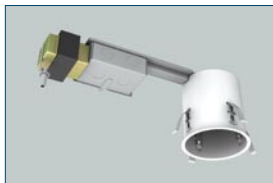

**ACT954RM - (MR16)**  
**ACT954RMMH - (ES16MH)**  
REMODEL

see page 46-51 for details

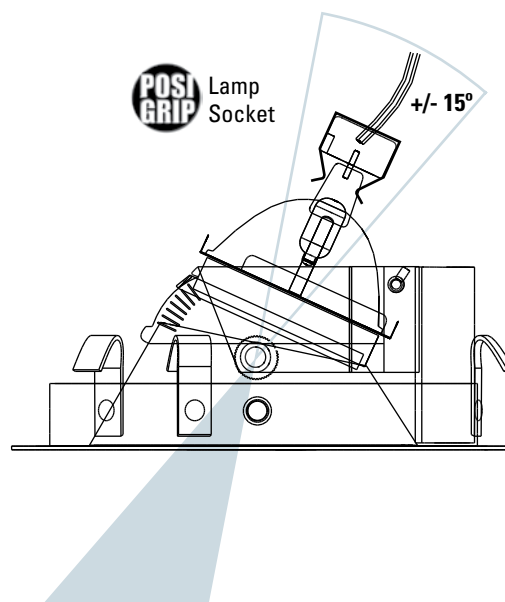

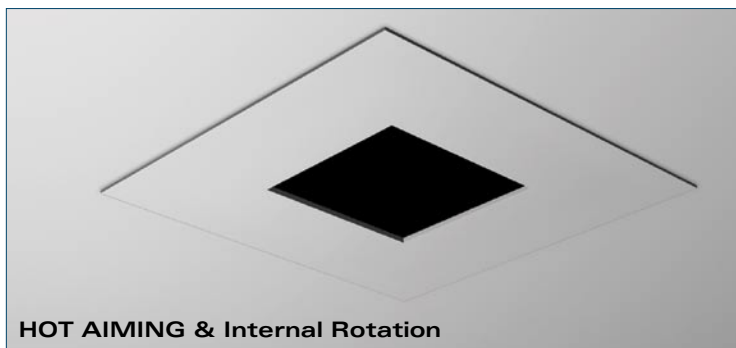

## ACCURUS - ADJUSTABLE SQUARE

### Item #

**ACT1885** 5" 45° adjustable square - MR16 71W max.

**ACT1885MH** 5" 45° adjustable square - ES16MH

### Finish

<b>WH</b>	White
<b>BK</b>	Black
<b>S</b>	Industrial Silver
<b>SS</b>	Stainless Steel (painted)
<b>PM</b>	Primer

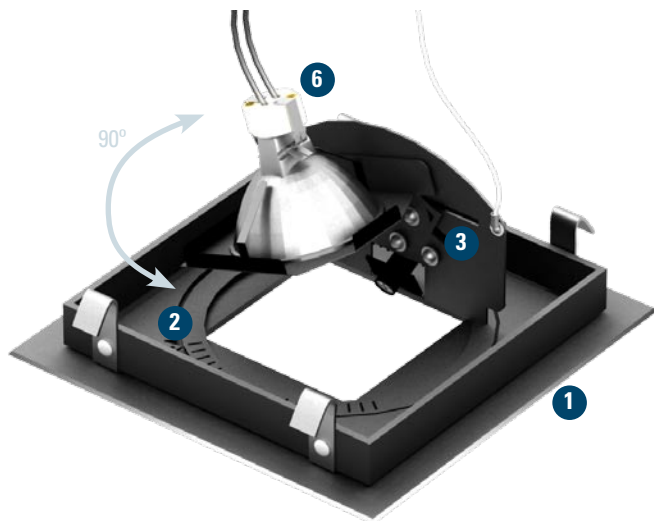
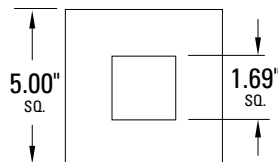

## Features

- 1) Thin, 0.04" faceplate provides a virtually flush installation.
- 2) Internal rotation ring with **INCREMENTAL ANGLE INDICATORS** provides 90° adjustment on the vertical axis making it possible to illuminate corners and other areas not possible with a traditional square trim.
- 3) 45° locking rack-and-pinion angle adjustment mechanism with hot aiming feature.
- 4) Can accommodate up to 3 optical accessories.
- 5) Flat black powder coated internal finish reduces visibility of components from below the ceiling.
- 6) "POSI-GRIP" bi-pin lamp socket for firm, mechanical lamp connection. (included with MR16 housings)
- 7) Includes steel safety cable

## ACCURUS HOUSINGS

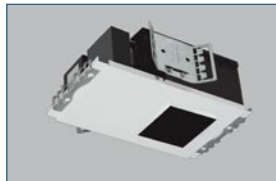

**ACT951 - (MR16)**  
**ACT951MH - (ES16MH)**  
NEW CONSTRUCTION

see page 46-51 for details



**ACT953IC - (MR16)**  
**ACT953ICMH - (ES16MH)**  
INSULATED CEILING

see page 46-51 for details

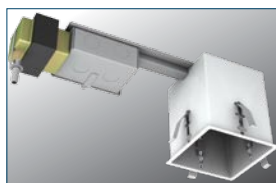

**ACT955RM - (MR16)**  
**ACT955RMMH - (ES16MH)**  
REMODEL

see page 46-51 for details

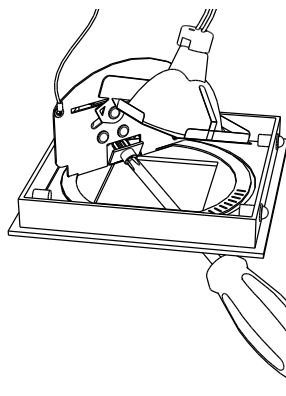

- Hot Aiming enables the lamp to be adjusted with an ordinary phillips screwdriver while the power is on.

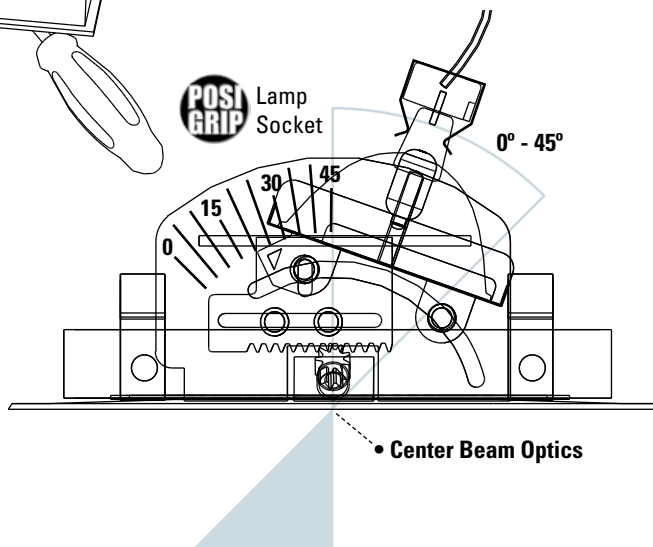





# ACCURUS - ROUND SHOWERLIGHT

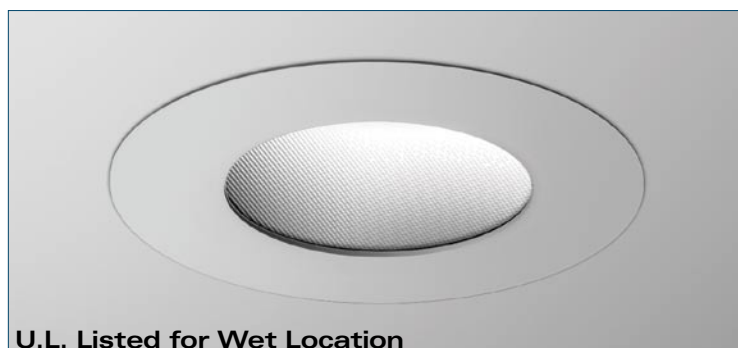

## ACCURUS - ROUND SHOWERLIGHT

### Item #

**ACT1986** 5" adjustable round showerlight - MR16 37W max.

**ACT1986MH** 5" adjustable round showerlight - ES16MH

### Finish

<b>WH</b>	White
<b>BK</b>	Black
<b>S</b>	Industrial Silver
<b>SS</b>	Stainless Steel (painted)
<b>PM</b>	Primer

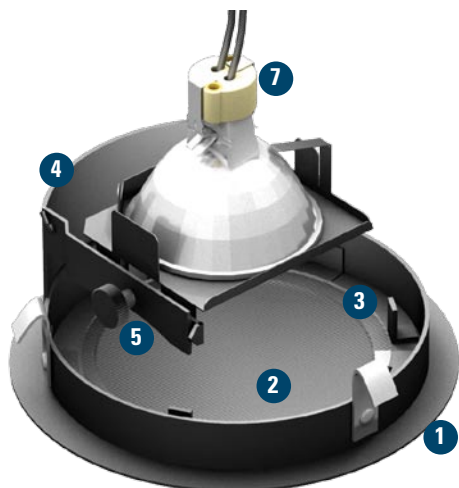
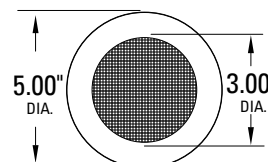

## Features

- 1) Thin, 0.04" faceplate provides a virtually flush installation.
- 2) Solite™ soft focus lens for even distribution of light.
- 3) Lens is gasketed for 100% moisture seal.
- 4) Locking alignment plate provides 360° rotational adjustment and ensures original orientation of trim even after re-lamping.
- 5) Locking adjustment knob with angle indicators.
- 6) Flat black powder coated internal finish reduces visibility of components from below the ceiling.
- 7) "POSI-GRIP" bi-pin lamp socket for firm, mechanical lamp connection. (included with MR16 housings)
- 8) Includes steel safety cable.

## ACCURUS HOUSINGS



**ACT950 - (MR16)**  
**ACT950MH - (ES16MH)**  
NEW CONSTRUCTION

see page 46-51 for details



**ACT952IC - (MR16)**  
**ACT952ICMH - (ES16MH)**  
INSULATED CEILING

see page 46-51 for details

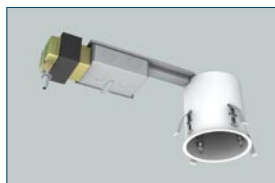

**ACT954 - (MR16)**  
**ACT954MH - (ES16MH)**  
REMODEL

see page 46-51 for details

## EASY TRIM REMOVAL

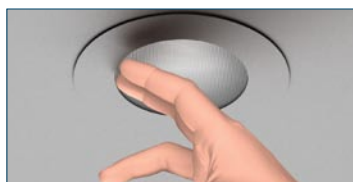

Trim removal for relamping is easily achieved by pressing up on the lens.

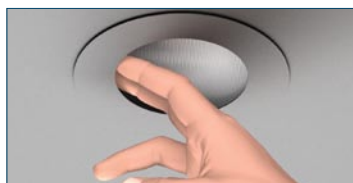

The gasket seal will temporarily separate to allow leverage.



Simply grab the trim and pull downward. Lens snaps back in to place.

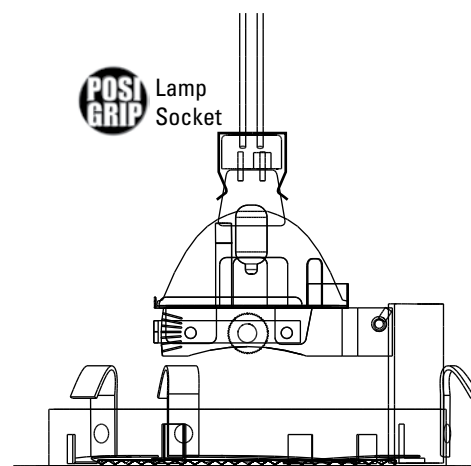





## ACCURUS - SQUARE SHOWERLIGHT

### Item #

**ACT1886** 5" adjustable square showerlight - MR16 37W max.  
**ACT1886MH** 5" adjustable square showerlight - ES16MH

### Finish

**WH** White  
**BK** Black  
**S** Industrial Silver  
**SS** Stainless Steel (painted)  
**PM** Primer

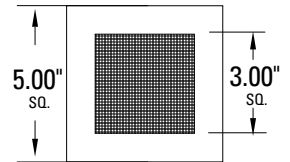

## Features

- 1) Thin, 0.04" faceplate provides a virtually flush installation.
- 2) Solite™ soft focus lens for even distribution of light.
- 3) Lens is gasketed for 100% moisture seal.
- 4) Locking adjustment knob with angle indicators.
- 5) Flat black powder coated internal finish reduces visibility of components from below the ceiling.
- 6) "POSI-GRIP" bi-pin lamp socket for firm, mechanical lamp connection. (included with MR16 housings)
- 7) Includes steel safety cable.

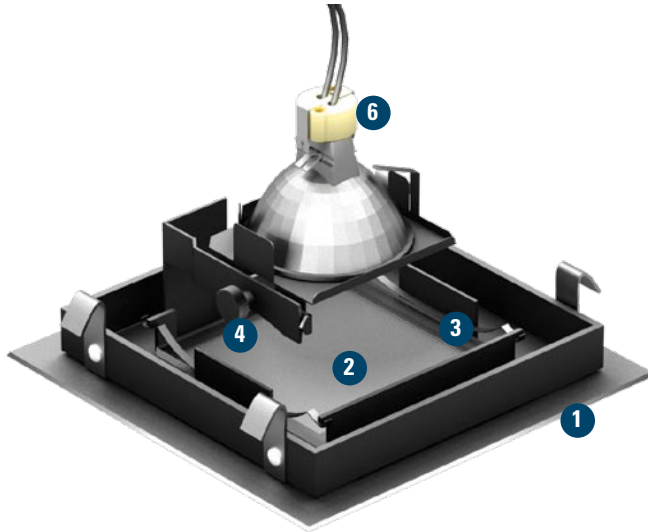

## EASY TRIM REMOVAL

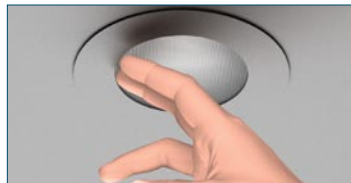

Trim removal for relamping is easily achieved by pressing up on the lens.

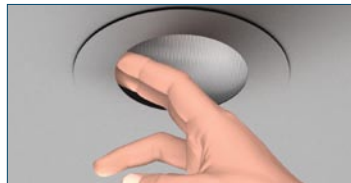

The gasket seal will temporarily separate to allow leverage.



Simply grab the trim and pull downward. Lens snaps back in to place.

## ACCURUS HOUSINGS

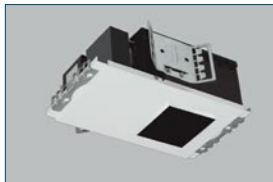

**ACT951 - (MR16)**  
**ACT951MH - (ES16MH)**  
 NEW CONSTRUCTION

see page 46-51 for details



**ACT953IC - (MR16)**  
**ACT953ICMH - (ES16MH)**  
 INSULATED CEILING

see page 46-51 for details

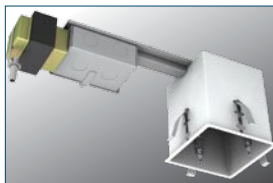

**ACT955RM - (MR16)**  
**ACT955RMMH - (ES16MH)**  
 REMODEL

see page 46-51 for details

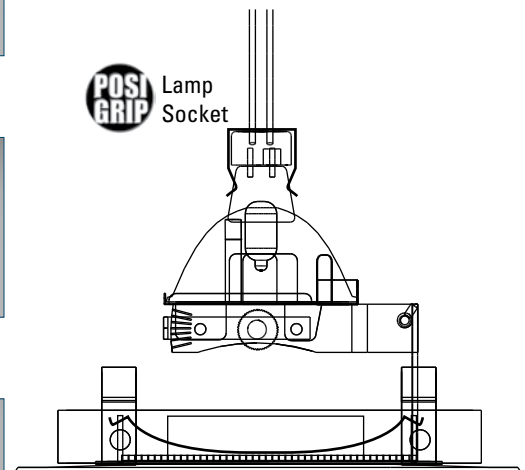

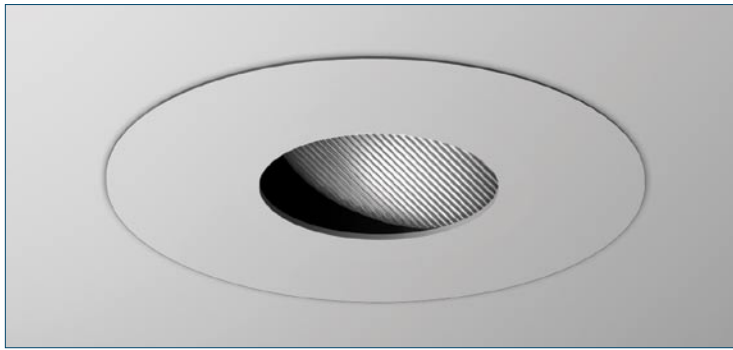

### ACCURUS - ROUND WALLWASH

#### Item #

**ACT2185** 5" round wallwash - MR16 50W max.

**ACT2185MH** 5" round wallwash - ES16MH

#### Finish

<b>WH</b>	White
<b>BK</b>	Black
<b>S</b>	Industrial Silver
<b>SS</b>	Stainless Steel (painted)
<b>PM</b>	Primer

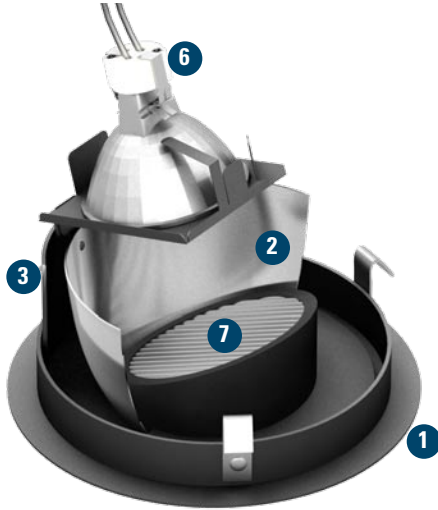
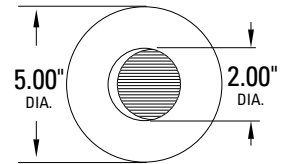

### Feature

- 1) Thin, 0.04" faceplate provides a virtually flush installation.
- 2) Clear Alzak® "kicker" reflector provides enhanced light output.
- 3) Locking alignment plate provides 360° rotational adjustment and ensures original orientation of trim even after re-lamping.
- 4) Flat black powder coated internal finish reduces visibility of components from below the ceiling.
- 5) Includes steel safety cable.
- 6) "POSI-GRIP" bi-pin lamp socket for firm, mechanical lamp connection. (included with MR16 housings)
- 7) Frosted linear spread lens provides a wider distribution of light.

### ACCURUS HOUSINGS

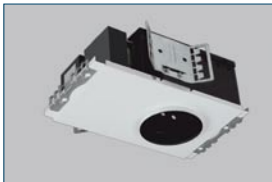

**ACT950 - (MR16)**  
**ACT950MH - (ES16MH)**  
NEW CONSTRUCTION

see page 46-51 for details



**ACT952IC - (MR16)**  
**ACT952ICMH - (ES16MH)**  
INSULATED CEILING

see page 46-51 for details

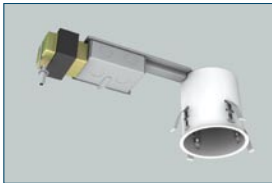

**ACT954 - (MR16)**  
**ACT954MH - (ES16MH)**  
REMODEL

see page 46-51 for details

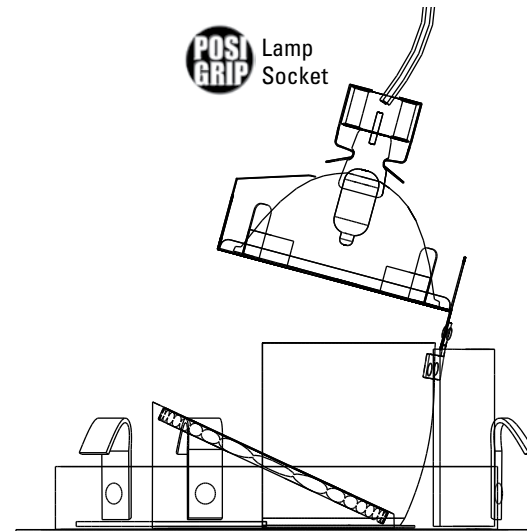

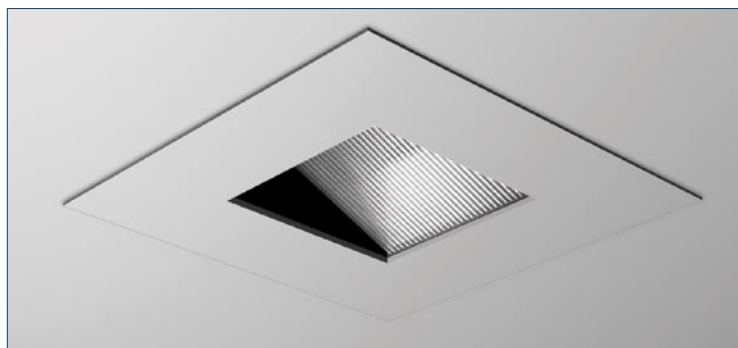

## ACCURUS - SQUARE WALLWASH

### Item #

**ACT2285** 5" square wallwash - MR16 50W max.

**ACT2285MH** 5" square wallwash - ES16MH

### Finish

<b>WH</b>	White
<b>BK</b>	Black
<b>S</b>	Industrial Silver
<b>SS</b>	Stainless Steel (painted)
<b>PM</b>	Primer

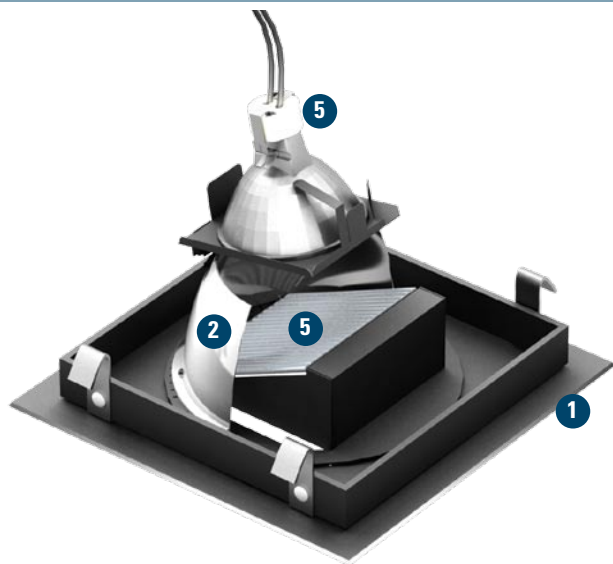
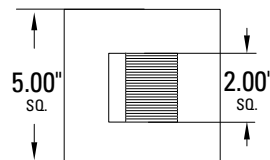

## Feature

- 1) Thin, 0.04" faceplate provides a virtually flush installation.
- 2) Clear Alzak® "kicker" reflector provides enhanced light output.
- 3) Flat black powder coated internal finish reduces visibility of components from below the ceiling.
- 4) Includes steel safety cable.
- 5) "POSI-GRIP" bi-pin lamp socket for firm, mechanical lamp connection. (included with MR16 housings)
- 6) Frosted linear spread lens provides a wider distribution of light.

## ACCURUS HOUSINGS

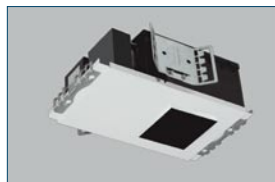

**ACT951 - (MR16)**  
**ACT951MH - (ES16MH)**  
NEW CONSTRUCTION

see page 46-51 for details



**ACT953IC - (MR16)**  
**ACT953ICMH - (ES16MH)**  
INSULATED CEILING

see page 46-51 for details

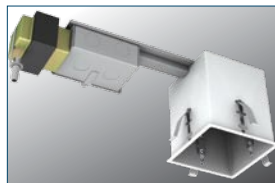

**ACT955RM - (MR16)**  
**ACT955RMMH - (ES16MH)**  
REMODEL

see page 46-51 for details

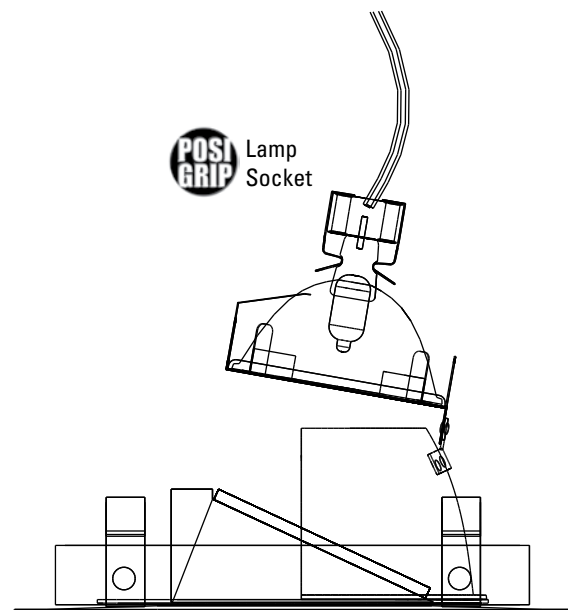

# ACCURUS - ROUND ADJUSTABLE FOR AR70

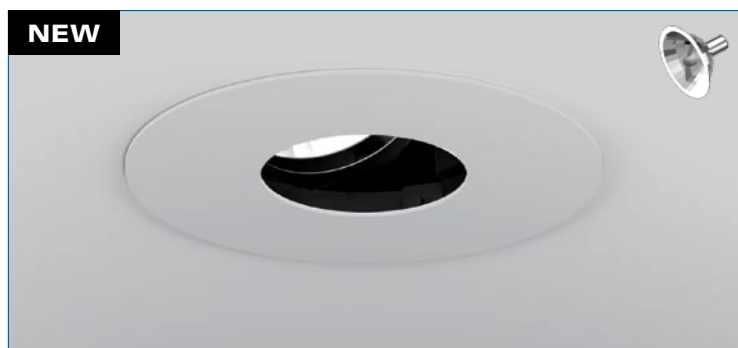

## ACCURUS - ROUND ADJUSTABLE

Item #

**ACT2385** 5" 35° adjustable round - AR70 50W max.

Finish

**WH** White  
**BK** Black  
**S** Industrial Silver  
**SS** Stainless Steel (painted)  
**PM** Primer

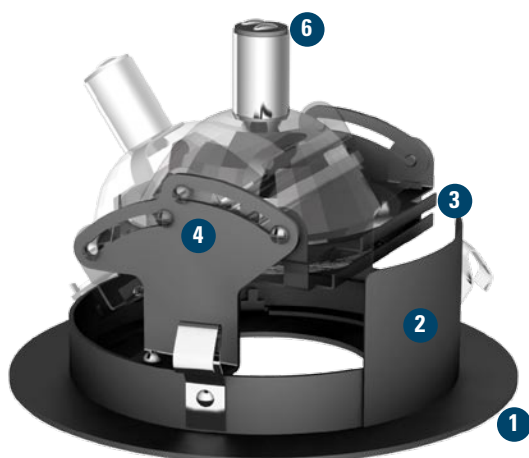
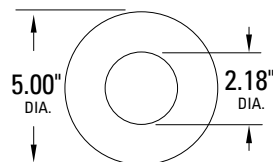

## Features

- 1) Thin, 0.04" faceplate provides a virtually flush installation.
- 2) Locking alignment plate provides 360° rotational adjustment and ensures original orientation of trim even after re-lamping.
- 3) Accommodates one (1) optical accessory. Lens tray allows optical accessory to be replaced without removing the lamp from the trim.
- 4) 35° locking angle adjustment mechanism feature.
- 5) Flat black powder coated internal finish reduces visibility of components from below the ceiling.
- 6) For use with AR70 double contact lamp. Housing includes bayonet socket.
- 7) Includes steel safety cable



Exclusive Lens Tray enables easy insertion and removal of optical accessories

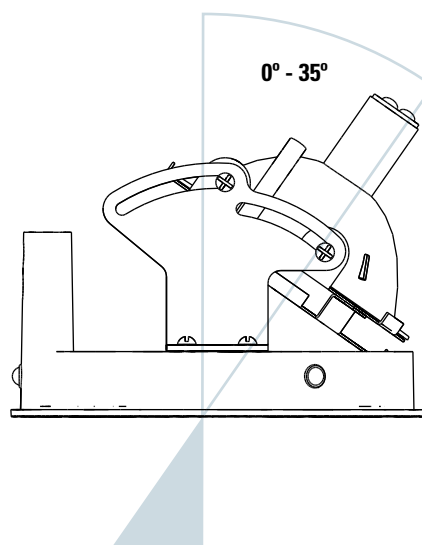

## ACCURUS HOUSINGS



**ACT960 - (AR70)**  
NEW CONSTRUCTION

see page 48-49 for details



**ACT962IC - (AR70)**  
INSULATED CEILING

see page 48-49 for details

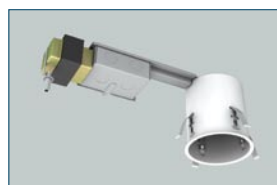

**ACT964 - (AR70)**  
REMODEL

see page 48-49 for details

