



# **DV SERIES PLANNING GUIDE**

## **CONTENTS**

Introduction	<b>3</b>
Before You Begin	<b>3</b>
What's in the Box	<b>3</b>
What's Optional	<b>4</b>
Placing a DV Series Fireplace	<b>4</b>
Venting a DV Series Fireplace	<b>5</b>
Facing a DV Series Fireplace	<b>6</b>
Conclusion	<b>11</b>

**Introduction** This Planning Guide is intended to assist the architect, designer, builder and homeowner when choosing the most appropriate installation type and location for a new European Home DV Series fireplace. It is not intended to substitute for the Installation, Operation and Maintenance Manual which comes with the fireplace and must be followed faithfully.

This Guide can function as a check list so a check box is shown throughout to assist your planning.



**Before You Begin** The DV Series fireplaces are vented gas appliances. They *must be installed by a qualified installer*. If you have not yet contracted with an installer this would be a good time to do so.

**What's a 'Direct Vent'?** The DV Series fireplaces are listed as 'direct vent' fireplaces. This means that all air for combustion comes directly from the outside atmosphere and all flue gases are discharged directly to the outside atmosphere. Conditioned air from your room is not used for combustion.

**What's in the Box?** Each DV Series fireplace currently ships with: one set of ceramic stones, one set of glass beads, one nailing flange extension, one pull rod (for opening the glass front) and one remote control (alternatively, they can be turned on and off via a switch supplied by the installer.)

Vent pipe must be ordered separately through your retailer or European Home.

**What's Optional?** There are several optional accessories for your DV Series fireplace: a fan kit with a flame-adjusting remote, a surround and an overlay trim kit.

☐ The fan kit requires switched 110 volts AC to operate and should be installed in the fireplace ***before the fireplace is installed in the building***. It can be controlled by the flame-adjusting remote.

☐ Surrounds are decorative. They serve the function of framing the fireplace opening. European Home offers surrounds in concrete and brushed stainless steel. The customer may also choose to design their own using other materials such as stone or tile.

☐ European Home surrounds are available in two sizes: 54"L x 32"H x 1½"D and 48"L x 34"H x 1½"D. Please contact us for size and color availability. More on the overlay trim kit later.

**Placing a DV Series Fireplace** A DV Series fireplace is a zero-clearance fireplace which can be set in a variety of locations. For example, you could install it against an outside wall and the unit could be vented out the rear (12" maximum pipe length.) It can be installed along inside walls as well. The vent pipe would run vertically, horizontally or a combination of both.

Although the industry term zero-clearance is used to describe the DV Series fireplace there are some limitations and restrictions to the placement. Now let's begin...at the bottom.

☐ A DV Series fireplace weighs at least 165 pounds *without the vent pipe* and can sit on any material that provides a level and solid support for a fireplace of this weight and size.

☐ The DV Series fireplaces burn either natural gas (NG) **or** liquefied petroleum gas (LP) but not both. You must specify your preference at the time of order.

☐ The gas connection is accommodated through a cutout located at the bottom of the left side wall of the fireplace (see the Installation Manual.) Your plumber/gas fitter will have to bring your gas supply through this hole.

Unless the optional fan kit is installed, no external electrical power is required.

**Venting a  
DV Series  
Fireplace**

Currently, the DV Series fireplace is listed for use with European Home vent pipe *only*. This vent pipe is generally available from European Home or your local retailer approximately two to four weeks after European Home receives the vent pipe order.

☐ The installation of the DV Series fireplace venting is critical to its safe operation and **MUST** be performed by qualified personnel.

The fireplace is vented through the top or, in some cases, the rear of the cabinet but not both. When venting out of the rear of the cabinet, vent pipe can be no longer than twelve inches when it has no rise. In a vertical vent configuration the maximum height is model-dependent. Generally speaking, the more rise in your vent configuration the more run you're allowed.

In all configurations, the vent graphs in the appropriate Installation, Operation and Maintenance Manual are the final authority for vent pipe runs and **MUST** be followed. Only one fireplace is allowed on each vent run.

A powered vent option is also available which adds even more flexibility and changes the above limits.

## Facing a DV Series Fireplace

A DV Series fireplace is intended to be covered with common building materials. As described in the Installation Manual, these materials must be non-combustible when placed close to the fireplace opening.



Your DV Series fireplace can be sheathed in one of three styles: **Overlay, Standard, or High**. Your choice of style is important because it affects the finished look of your fireplace and the wall in which it is set.

Both the Overlay and Standard styles REQUIRE NON-COMBUSTIBLE SHEATHING AND FACING as well as a change to the normal installation. The High style leaves the most metal trim exposed, Overlay the least and the Standard is between the two. Table 1 shows some of the important differences between the three styles.

### ***What is Non-combustible?***

*A given material is said to be non-combustible when it cannot catch fire and burn. For example, materials made entirely, or in combinations, of, stone, brick, concrete, tile, steel, plaster or glass are considered non-combustible.*

*The combustibility of a material can be tested per "ASTM E136-04 Standard Test Method for Behavior of Materials in a Vertical Tube Furnace at 750 Degrees C".*

*Note that 'fire-resistant' does NOT mean non-combustible. Type X wallboard IS COMBUSTIBLE!*

*For the purposes of the installation described in this Guide, those materials that have passed the ASTM E136-04 tests are considered to be non-combustible.*

*As of this writing, examples of wall materials that are reported by their manufacturers to be non-combustible (in accordance with ASTM E136-04) are:*

- *Hardibacker - James Hardie Building Products, Inc.*
- *Versaroc - U.S. Architectural Products, Inc.*
- *Durock - U. S. Gypsum Company*

<i>Installation Change</i>	<i>Wall Sheathing Style</i>		
	Overlay	Standard	High
Requires NON-combustible sheathing and facing	<b>Yes</b>	<b>Yes</b>	No
Standard size surrounds hide all metal trim	Yes	<b>No</b>	<b>No</b>
Requires a deeper (+5/8") rough opening	<b>Yes</b>	No	No
Requires a change to the standard installation	<b>Yes</b>	No	No

Table 1

1) The most popular method of finishing your installation is the **Overlay** style (Figure 2.) As the name implies, your **NON-combustible material** *lays* over the metal fireplace trim creating a clean, minimalist look.

This style requires that you set the fireplace  $\frac{5}{8}$ " back from the face of the framing so that the **fireplace face is flush with the framing**. This is most easily accomplished by moving the jack studs (or trimmers) rearward  $\frac{5}{8}$ " in relation to the king stud (Figure 1.)

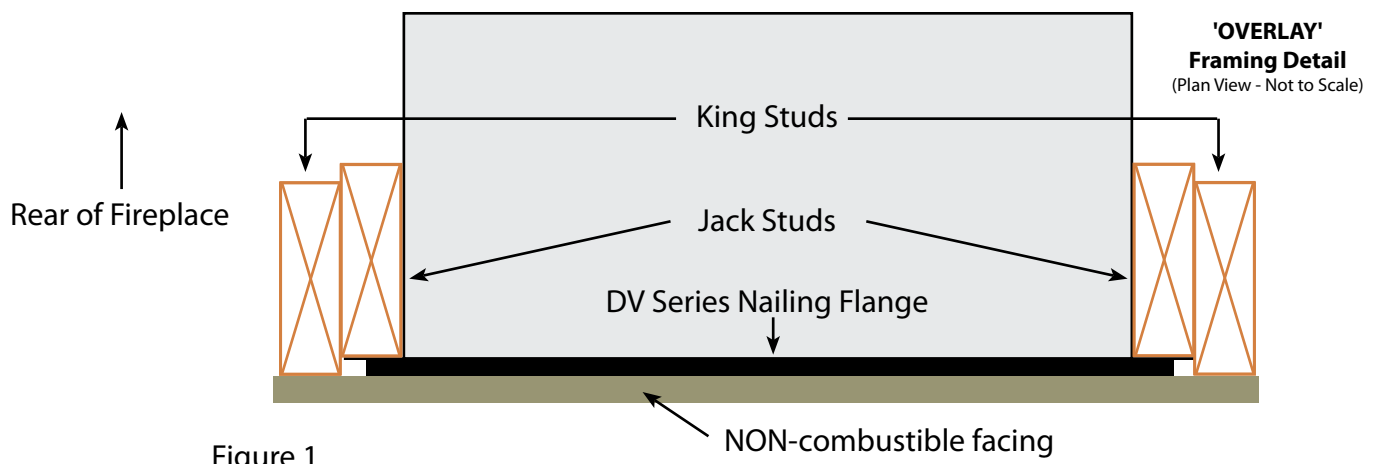

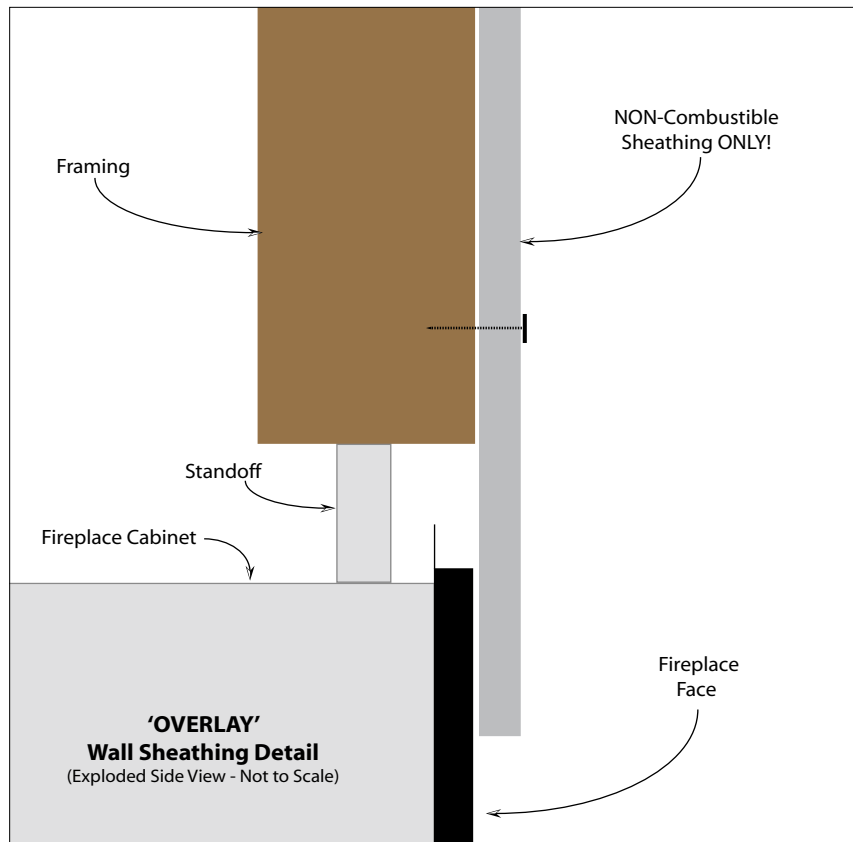

Figure 2

As shown in the top view of Figure 1 and the side view of Figure 2, NON-combustible facing is placed to cover the black metal trim of the cabinet. On all four sides of the fireplace opening, this NON-combustible facing can be brought up to, *but not beyond*, the edges of the fireplace opening.

If desired, the optional Overlay Trim Kit can be placed into this opening thereby finishing the rough cut, non-combustible edges with a 1/2" face, see below.





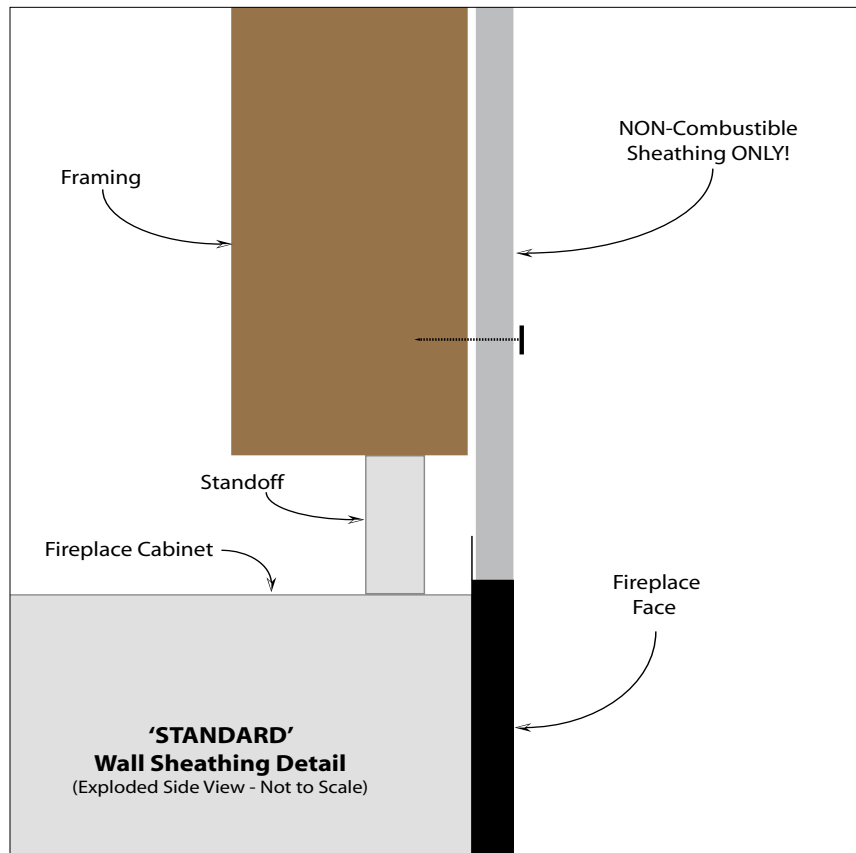
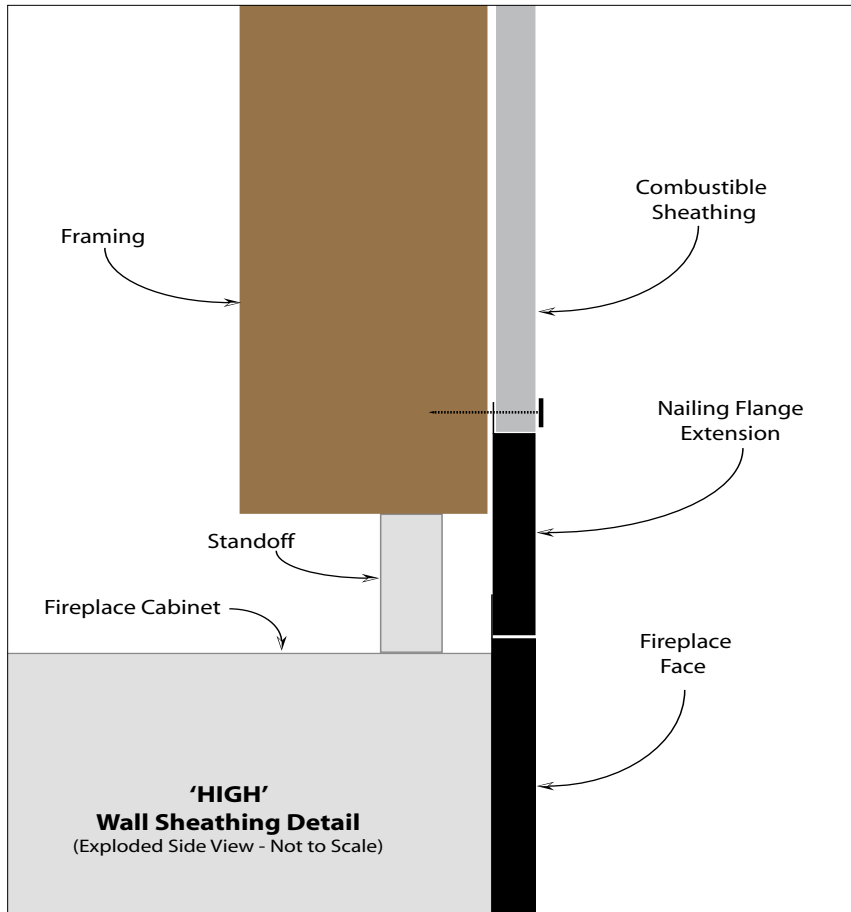

Figure 3

2) When using the **Standard** style (Figure 3) the nailing flange extension is omitted and ONLY NON-COMBUSTIBLE MATERIALS MAY BE BROUGHT TO THE CABINET NAILING FLANGE. With the **Standard** style, all of the black metal fireplace trim can be covered with any of the standard European Home surrounds.



3) With the **High** style of sheathing, the enclosed nailing flange extension **MUST** be used and **COMBUSTIBLE MATERIAL MUST NOT EXTEND BELOW THE NAILING FLANGE EXTENSION** (see Figure 4). This method, while perfectly acceptable, exposes about ten inches of black metal trim above the glass door. Only part of this trim can be covered by the optional European Home surround. This is the least popular method of sheathing because it exposes the largest surface area of black trim.

**Conclusion**

No matter the facing style, the DV Series fireplaces get HOT. Make certain that your installation is safe.

Call us if you have any questions or are uncertain about any aspect of your installation!

This Planning Guide must be used in conjunction with the DV Series Installation, Operation and Maintenance Manual.

Together, they provide a wealth of information for the typical installation.

## **EUROPEAN HOME**

a division of Europa Ja, Inc.

376 Washington St.  
Suite 203  
Malden, MA 02148

tel: 781/324-8383

fax: 781/324-8384

[www.europeanhome.com](http://www.europeanhome.com)