

MF2041 Extenda Bench Add-On Seat

ASSEMBLY DIAGRAM,
INSTRUCTIONS AND
PARTS LIST FOR
MF2041 EXTENDA
BENCH ADD-ON SEAT.

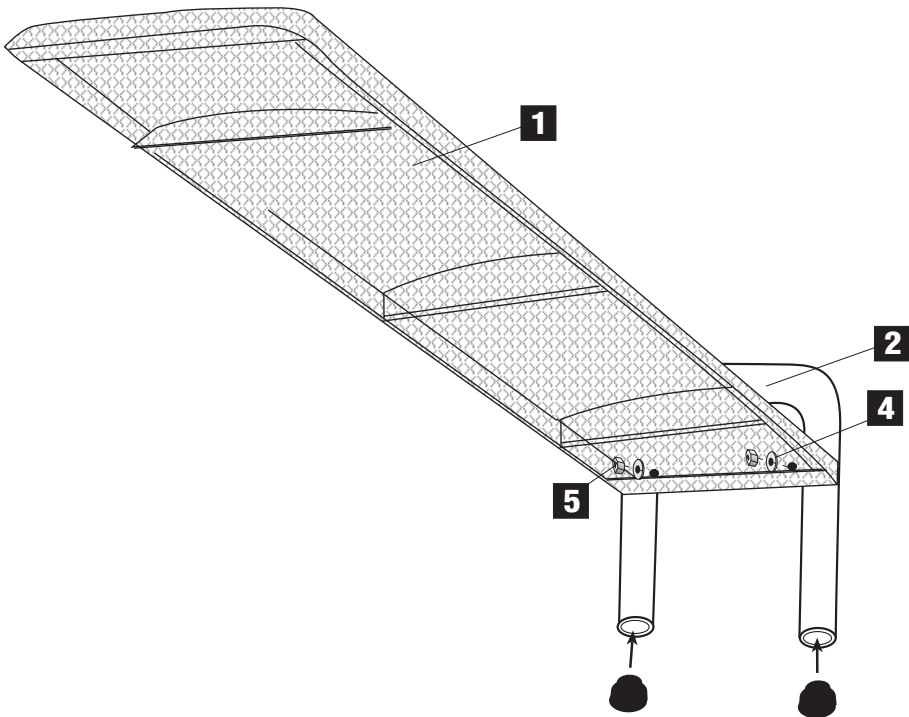

NOTE:

Leave all connections loose until completely assembled. Secure all fasteners in final assembly.

ITEM NO.	DESCRIPTION	WEIGHT	QTY
1	Seat	80	1
2	Tubular Legs	20	1
3	3/8" x 3" Bolts		2
4	3/8" Flat Washers		2
5	3/8" Lock Nut		2
6	5/16" Assembly Wrench		1

- Size:70" x 16" x 24" Nominal.
- Weight:110 lbs
- Construction:Panels - 11 Gauge Perforated Steel Metal-Armor Coated
Framework - 2" Diameter - 12 Gauge Galvanized Tube
- Standard Features: Metal-Armor Coating - With U. V. Inhibitors on Panels -
Vandal Resistant Security Head Bolts -
Baked-On Polyester Powder Coat on Framework
- Color Options: Standard Metal-Form Options:
Panel: Yellow - Green - Brown - Red - Blue - Black - Gray -
Beige - Burgundy - Federal Green
Framework: Gray - Sand - Black - Silver
(Custom colors are available - contact Metal-Form for options)
- Other Options: Permanent Anchoring Kit Available From Metal-Form
- Warranty: 5 Years - Metal-Armor Coated Products
2 Years - Framework

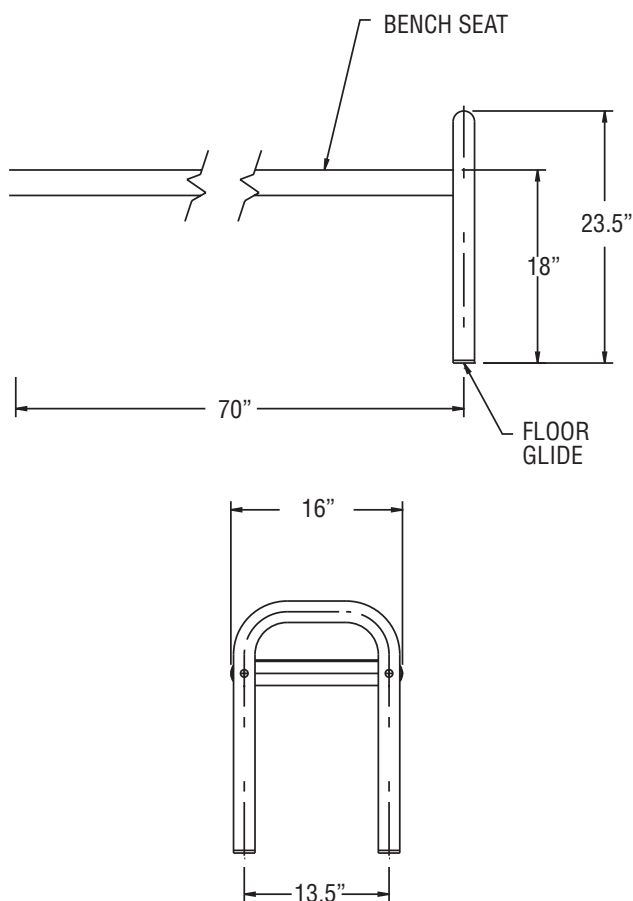

1.1 SUMMARY

- A. Section includes: Furnish Metal-Form benches on drawings or specified herein.

1.2 REFERENCES

- A. American Society for Testing & Materials
 1. ASTM-D533 ASTM-D4541 ASTM-D3359 ASTM-2794
 - ASTM-D523 ASTM-4060 ASTM-B117 ASTM-D2247
 - ASTM-E84 ASTM-D3170 ASTM-A569 ASTM-B6
 - ASTM G26 ASTM-A569/A569M

1.3 SUBMITTALS

- A. Submit product data, shop drawings and samples.
 1. Product Data: Manufacturer's specifications and technical data edited specifically for proposed product, including the following specific information:
 - a. Detailed specification of construction fabrication.
 - b. Manufacturer's installation instructions
 - c. Product warranty
- B. Shop Drawings: Indicate pertinent dimensions, general construction, component connections, anchoring methods, hardware and installation procedures.
- C. Samples as requested by Architect.

1.4 QUALITY ASSURANCE

- A. Qualifications of Manufacturer: Manufacturer to be prequalified by specifier prior to bidding. Failure to comply will result in disqualification of bid. Manufacturer to have at least three years experience in the manufacture of thermo plastic coated steel site furnishings field proven for at least three years.
- B. Warranty: 5 Years - Metal Armor Coated Products
2 Years - Framework

1.5 MANUFACTURERS

- A. Acceptable manufacturer for thermo plastic coated steel site furnishings to be known as:
Wausau Tile, Inc.
PO Box 1520
Wausau, WI 54402-1520
(800) 388-8728 FAX (715) 355-4627
- B. Clarification Note: Drawings and installation specifications are based on manufacturers proprietary literature from Wausau Tile, Inc., Metal-Form Division. Other manufacturers shall comply with minimum levels of material and detailing indicated on drawings or specified herein.