

Interior Wall Mount

Yoke

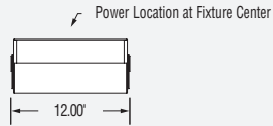

Hub

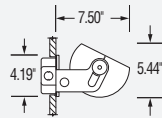
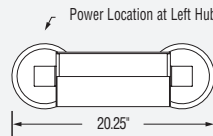
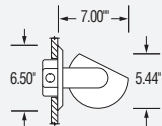

Horizontal Stem

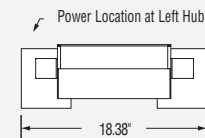
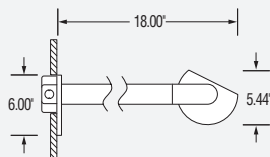

Cantilever Arm

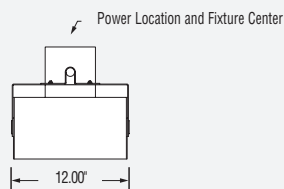
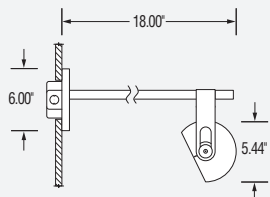

Specifications:

- **Extruded** - Extruded .125" aluminum housing.
- **Solid** - Roll-formed .05" aluminum housing.
- **Perforated** - Roll-formed, perforated 18 gauge steel housing.
- Cast aluminum end caps with flush-mounted fasteners.
- Housing is field adjustable for application specific aiming and can be mechanically locked in the desired position.
- H.I.D. and Tungsten Halogen luminaires utilize a segmented, 95% reflective, specular clear, aluminum reflector. Impact and heat-resistant, tempered glass lens.
- Yoke bracket is die-formed from 14 gauge steel.
- Hub and Horizontal Stem mountings utilize cast aluminum canopies. Horizontal Stem mount units include 1 1/2" square steel stems and square canopies. Hub mount supplied with round canopies.
- Cantilever Arm mount utilizes a yoke bracket with a 1" dia. steel arm.
- Formed aluminum cover to fit over a standard 4" junction box.
- Housing, endcaps, brackets, cover plates and stems painted to match. Standard finish is thermoset polyester powder coat. All metal surfaces go through a 5-stage pretreatment process prior to powder coat application.
- H.I.D. ballasts are remote, encased and potted, magnetic CWA-HPF design (120/277 volt operation). Ballasts are thermally protected and have a Class "B" sound rating.
- UL listed (U.S. and Canada) for damp locations. (Not for exterior use.)

Assistance Available: Please see our website, or call 262-242-1420 for more specific product information, applications assistance or modification requests.

FT	PW	VG	Lamp Wattage Range	Lamp
				FL
			39-150W	MH
			150-250W	TH

SELECT STYLE

	Mounting	Housing
EIW 2000	Yoke	Extruded
EIW 2002	Yoke	Perforated
EIW 2004	Yoke	Solid
EIW 2006	Hub	Extruded
EIW 2008	Hub	Perforated
EIW 2010	Hub	Solid
EIW 2012	Horiz. Stem	Extruded
EIW 2014	Horiz. Stem	Perforated
EIW 2016	Horiz. Stem	Solid
EIW 2018	Cant. Arm	Extruded
EIW 2020	Cant. Arm	Perforated
EIW 2022	Cant. Arm	Solid

SELECT LAMPING

	Lamping Detail
1M39	(1) 39W T6 CMH/G12
1M70	(1) 70W T6 CMH/G12
1M150	(1) 150W T6 CMH/G12
1T150²	(1) 150W T4 DC BAY QTZ
1T250²	(1) 250W T4 DC BAY QTZ

² 120 volt only

For additional lamping details and options, see Technical Notes on pages 160-161.

SELECT OPTICAL PACKAGE

FT	Forward Throw
PW	Plane Wash
VG	Vertical Graze

SELECT VOLTAGE

120
277

SELECT FINISH

PT_ Painted. (Include Paint Number)

See SPI Finish Selection Guide on pages 168-169.

Other voltages/frequencies are available. For additional details and options, see Technical Notes on page 166 or consult factory for information.

SELECT OPTIONS

CS	Cut-off Shield.
RPI	Remote ballast support tray. (metal halide lamping)
F	Fuse. (metal halide lamping)
Q*	Standby Quartz Lighting. (for 39W and 70W metal halide lamping, 75W quartz auxiliary lamping)

For further details on Options, see Technical Notes on page 165.

*Only available with Forward Throw (FT) Optics.

12

Reflections
Wall
Ceiling
Pendant

3.5
Wall
Ceiling
Pendant

5.0
Wall
Ceiling
Pendant
Pier
Cove
MRI
Shapes

6.0
Wall
Ceiling
Pendant
Pier
Cove
MRI

9.0
Wall
Ceiling
Pendant
Pier
Cove
MRI
Shapes

16.5
Wall
Pier
Pendant

Exterior

Lightruss