

Quarter Sphere

performance architectural lighting



PIW1040
Painted-White



PIW1042
Painted-White
with Brushed Brass Over Steel Accent



PIW1044
Painted-White
with Brushed Brass Over Steel Accent



PIW1046
Painted-White
with Brushed Brass Over Steel Accent

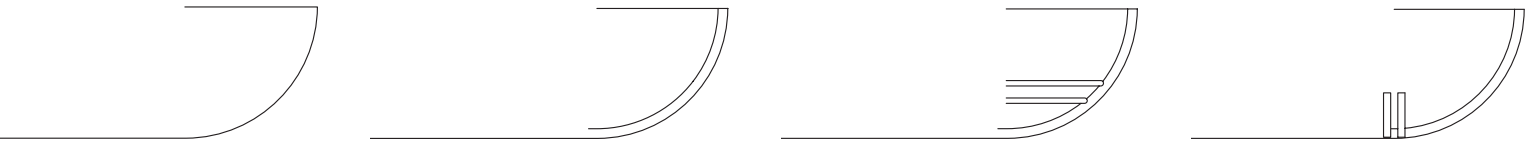

PIW1030
Acrylic with Brushed Brass Over Steel Accent



PIW1032
Acrylic with Brushed Brass Over Steel Accent



PIW1050
Painted-White



PIW1034
Acrylic with Brushed Brass Over Steel Accent

Quarter Sphere Surface Mount Sconce

PHACES

Flush

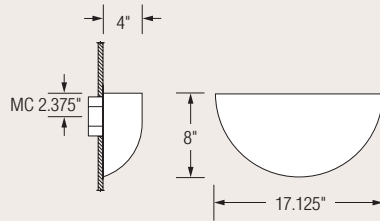

PIW1040
ADA

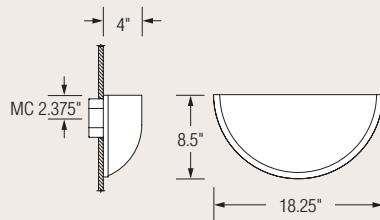

PIW1042
ADA

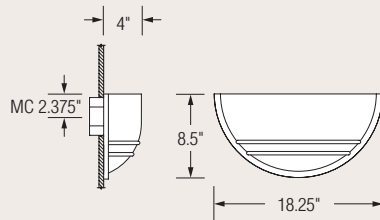

PIW1044
ADA

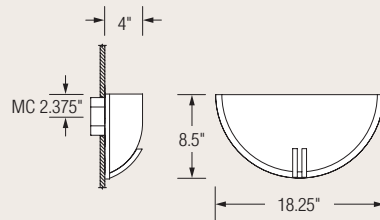

PIW1046
ADA

Floating

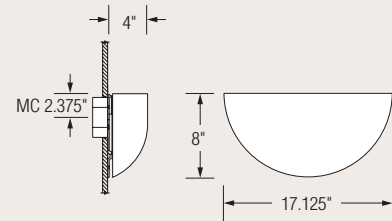

PIW1050
ADA

Specifications:

- 18 gauge formed cold-rolled steel housing
- ADA compliant
- Integral ballast
- Ballast thermally protected
- Universal mounting holes and direct access to a standard 4" octagonal junction box.
- UL listed for damp locations. (Not recommended for exterior use.)

Sample model number: **PIW1042 - 1F42 - 120 - PT03 - PBST - TL**

Select Style	Select any Lamping (indirect/bowl illumination)	Select Voltage	Select Finish	Select Accent Finish	Select Options																																							
<p>PIW1040</p> <p>PIW1042</p> <p>PIW1044</p> <p>PIW1046</p> <p>PIW1050</p>	<table border="1"> <thead> <tr> <th>Lamping Detail (indirect - bowl illumination)</th> <th>Optical Pkg.</th> <th>Photometry</th> </tr> </thead> <tbody> <tr><td>1N150</td><td>(1) 150W A21 INC</td><td>A NA</td></tr> <tr><td>1F13</td><td>(1) CFQ13W/G24q</td><td>B E14-2</td></tr> <tr><td>1F26</td><td>(1) CFQ26W/G24q</td><td>B E14-2</td></tr> <tr><td>1F26DM</td><td>(1) CFQ26W/G24q</td><td>B E14-2</td></tr> <tr><td>1F32</td><td>(1) CFQ32W/G24q</td><td>B E14-2</td></tr> <tr><td>1F32DM</td><td>(1) CFQ32W/G24q</td><td>B E14-2</td></tr> <tr><td>1F42</td><td>(1) CFQ42W/G24q</td><td>B E14-2</td></tr> <tr><td>1F42DM</td><td>(1) CFQ42W/G24q</td><td>B E14-2</td></tr> <tr><td>2N75</td><td>(2) 75W A19 INC</td><td>C NA</td></tr> <tr><td>2F13</td><td>(2) CFQ13W/G24q</td><td>D E14-2</td></tr> <tr><td>2F26</td><td>(2) CFQ26W/G24q</td><td>D E14-2</td></tr> <tr><td>2F26DM</td><td>(2) CFQ26W/G24q</td><td>D E14-2</td></tr> </tbody> </table> <p>DM = Dimming ballast(s) provided (Requires RAB option.)</p> <p><i>If Photometry is not available, consult factory for further details.</i></p>	Lamping Detail (indirect - bowl illumination)	Optical Pkg.	Photometry	1N150	(1) 150W A21 INC	A NA	1F13	(1) CFQ13W/G24q	B E14-2	1F26	(1) CFQ26W/G24q	B E14-2	1F26DM	(1) CFQ26W/G24q	B E14-2	1F32	(1) CFQ32W/G24q	B E14-2	1F32DM	(1) CFQ32W/G24q	B E14-2	1F42	(1) CFQ42W/G24q	B E14-2	1F42DM	(1) CFQ42W/G24q	B E14-2	2N75	(2) 75W A19 INC	C NA	2F13	(2) CFQ13W/G24q	D E14-2	2F26	(2) CFQ26W/G24q	D E14-2	2F26DM	(2) CFQ26W/G24q	D E14-2	<p>120</p> <p>277</p>	<p>PT __ Painted. (Include Paint Number.)</p>	<p>PT __ Painted. (Include Paint Number.)</p> <p>ABST Antique brass over steel</p> <p>BBST Brushed brass over steel</p> <p>CPST Polished chrome over steel</p> <p>PBST Polished brass over steel</p> <p><i>See Finish Selection Guide, pages 268-269.</i></p> <p><i>*Not required for PIW1040 and 1050.</i></p>	<p>TL Top Lens. Clear tempered glass. Standard on 1T150 lamping.</p> <p>F Fuse option. Factory installed.</p> <p>EMI Integral Emergency Lighting. Use with RAB - recessed accessory box. Fluorescent only. Battery lumen packages 650 and below.</p> <p>EMR Remote Emergency Lighting. Fluorescent only. Required for battery lumen packages greater than 650.</p> <p>RAB Recessed Accessory Box. Required with DM and EMI options.</p> <p><i>For further detail on options, see Technical Notes on page 266.</i></p>
Lamping Detail (indirect - bowl illumination)	Optical Pkg.	Photometry																																										
1N150	(1) 150W A21 INC	A NA																																										
1F13	(1) CFQ13W/G24q	B E14-2																																										
1F26	(1) CFQ26W/G24q	B E14-2																																										
1F26DM	(1) CFQ26W/G24q	B E14-2																																										
1F32	(1) CFQ32W/G24q	B E14-2																																										
1F32DM	(1) CFQ32W/G24q	B E14-2																																										
1F42	(1) CFQ42W/G24q	B E14-2																																										
1F42DM	(1) CFQ42W/G24q	B E14-2																																										
2N75	(2) 75W A19 INC	C NA																																										
2F13	(2) CFQ13W/G24q	D E14-2																																										
2F26	(2) CFQ26W/G24q	D E14-2																																										
2F26DM	(2) CFQ26W/G24q	D E14-2																																										

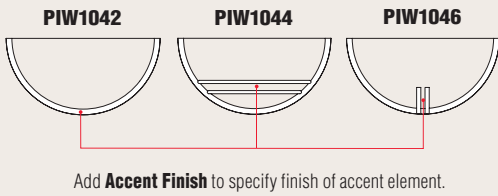

OPTICAL PACKAGES

