

GFSF6KKX

GE® ENERGY STAR® 25.8 Cu. Ft. French Door Refrigerator with Icemaker

Dimensions and Installation Information (in inches)

Overall Dimensions	Height to top of hinge (in.) A	70
	Height to top of case (in.) B	69-1/2
	Case depth without door (in.) C	29-1/8
	Case depth less door handle (in.) D	32-7/8
	Case depth with door handle (in.) E	35-5/8
	Depth with fresh food door open 90° (in.) F	47-3/4
	Width (in.) G	35-3/4
Air Clearances	Width with door open 90° inc. door handle (in.) H	44-1/2
	Each side (in.)	1/8
	Top (in.)	1
	Back (in.)	1

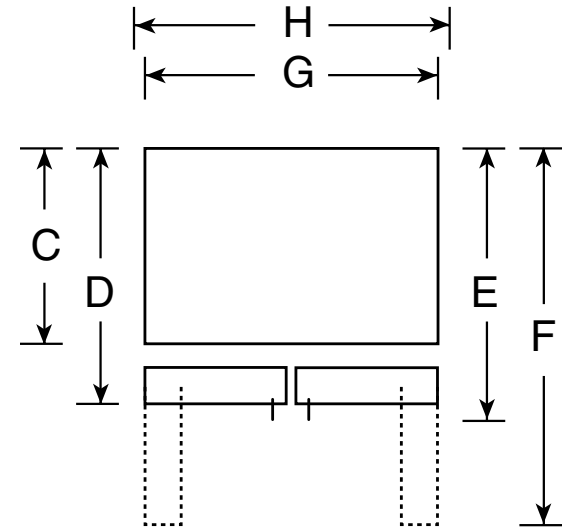
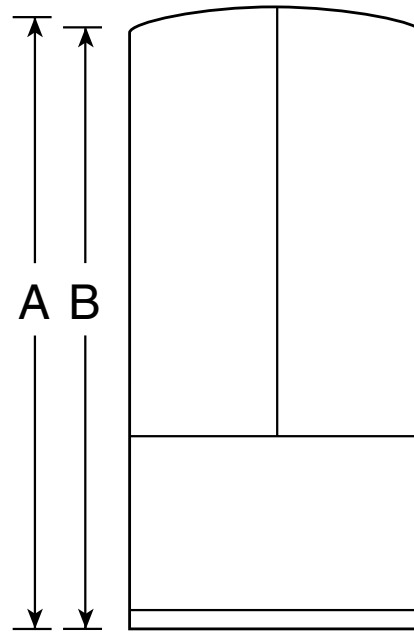

For answers to your Monogram®, GE Profile™ or GE® appliance questions, visit our website at ge.com or call GE Answer Center® service, 800.626.2000.



As an ENERGY STAR® partner, GE has determined that this product meets the ENERGY STAR guidelines for energy efficiency.

GFSF6KKX

GE® ENERGY STAR® 25.8 Cu. Ft. French Door Refrigerator with Icemaker

Features and Benefits

- High-Gloss Crown Doors with Hidden Hinges - Provides a striking finish to accentuate kitchen decor and includes concealed hinges
- Ice & Water Dispenser with Actual Temperature Display - Offers crushed ice and fresh water, while making it easy to monitor all the functions of the refrigerator
- ClimateKeeper with Dual Evaporators - Uses two evaporators to maintain higher humidity for fresh foods
- Freshness Center™ - Offers maximum convenience by utilizing two humidity-controlled drawers
- BrightSpace™ Interior with GE Reveal™ Lighting - Cast a natural-looking glow throughout the refrigerator
- Two-level Slide 'n Store™ System - Uses large and medium freezer baskets to allow easy access to frozen foods
- Adjustable Spillproof Glass Shelves - Raised edges help contain spills to make clean up quick and easy
- Secure-Close Door System - Securely pulls the door shut, even after you release the handle
- Deluxe Quiet Design - Significantly reduces operating noise
- Model GFSF6KKXBB - Black
- Model GFSF6KKXWW - White

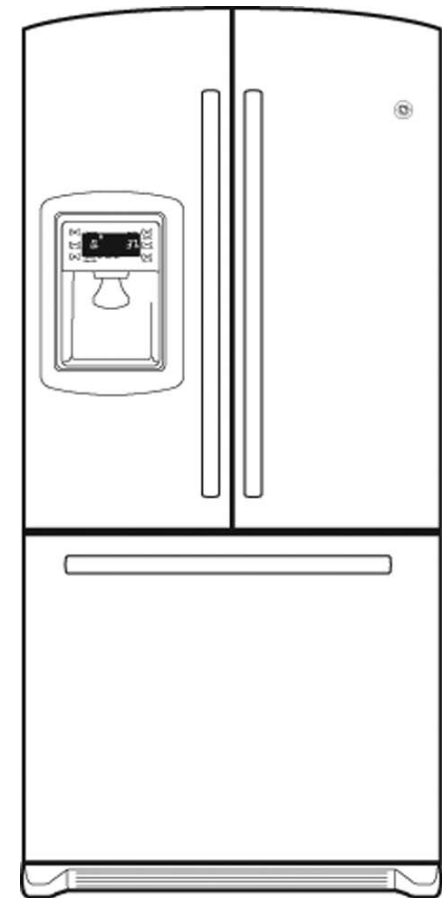

imagination at work



As an ENERGY STAR® partner, GE has determined that this product meets the ENERGY STAR guidelines for energy efficiency.