

GTS17JBW

GE® 16.6 Cu. Ft. Top-Freezer Refrigerator

Dimensions and Installation Information

Overall Dimensions	Height to top of hinge (in.) A	64-3/4
	Height to top of case (in.) B	64-1/4*
	Case depth without door (in.) C†	25-7/8
	Case depth less door handle (in.) D†	29-1/8
	Case depth with door handle (in.) E†	31
	Depth with fresh food door open 90° (in.) F†	54-7/8
	Width (in.) G	28
	Width with door open 90° less door handle (in.) H	30-1/2
Air Clearances	Each side (in.)	3/4
	Top (in.)	1
	Back (in.)	1

*Height to mid-freezer (in.): 54-3/8

Front View

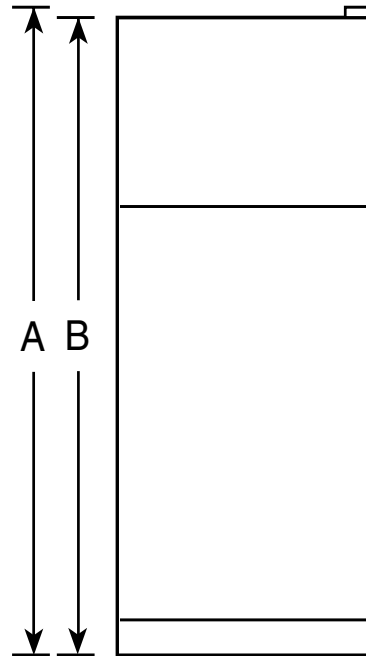

Top View

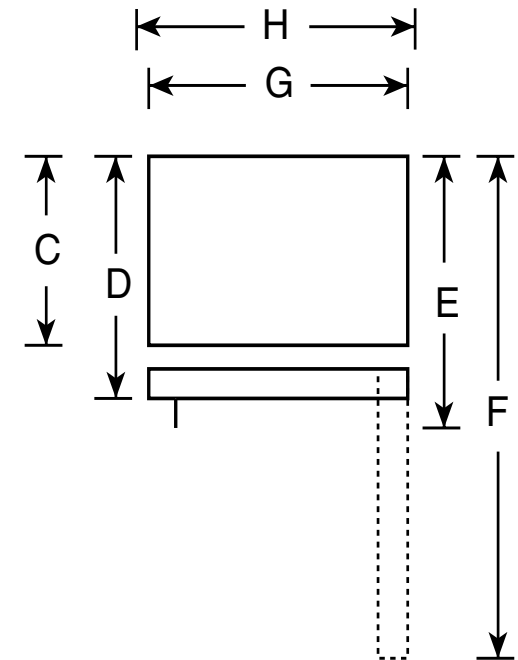

For answers to your Monogram®, GE Profile™ or GE® appliance questions, visit our website at ge.com or call GE Answer Center® service, 800.626.2000.

Dimension and installation information are shown in inches.



Specification Created 6/07

310479

GTS17JBW

GE® 16.6 Cu. Ft. Top-Freezer Refrigerator

Features and Benefits

- Spillproof Glass Shelves - Help contain spills for ease of cleaning
- Upfront Temperature Controls - Are positioned up front, close at hand, for maximum convenience and ease of use
- Adjustable Humidity Vegetable/Fruit Crispers - Provide easy storage environment for fruits and vegetables
- Gallon Door Storage - Makes room for gallon-size containers
- NeverClean™ Condenser - Condenser coils are encased, so they don't require cleaning in normal operating environments
- Deluxe Quiet Design - Significantly reduces operating noise
- Model GTS17JBWW - White on white
- Model GTS17JBWBB - Black on black

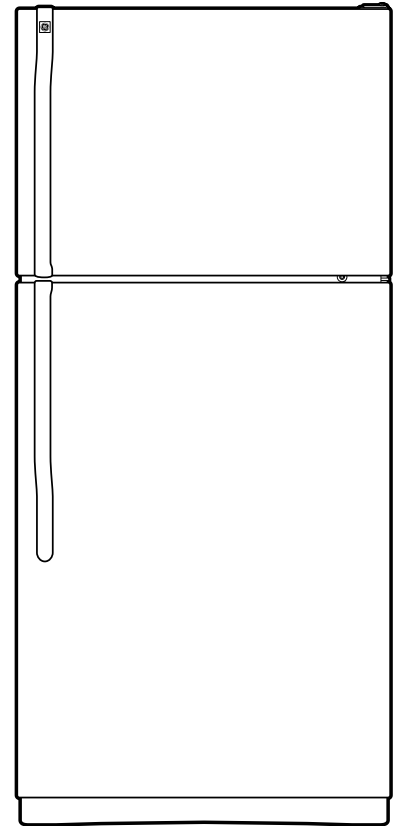

imagination at work

Specification Created 6/07

310479