

L E U C O S[®]

INSTALLATION INSTRUCTIONS - LEUCOS USA

PLANET 48 & PLANET 65

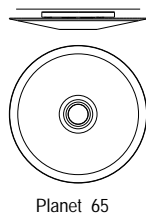

Revised
11. Sept. 2008

A1 Enclosed



Two installers



Save instructions



WARNING: - DISCONNECT POWER BEFORE INSTALLATION. - FIXTURE TO BE INSTALLED BY A CERTIFIED ELECTRICIAN. - INSTALL IN ACCORDANCE WITH THE NATIONAL AND LOCAL ELECTRICAL CODES. - TAKE GREAT CARE TO AVOID SCRATCHING OR CHIPPING THE GLASS WHEN CARRYING OUT THE OPERATIONS BELOW

- .1. Install fixture "A" by to the J- box, the "H" slots provided.
 - .2. Halogen version: remove the cover-reflector "B".
 - .3. Make electrical connections to supply wires. Take care to respect the correct polarity.
 - .4. Replace the cover reflector "B" on the two corresponding seats "D". Then insert bulbs and make a working test.
 - .5. **For the fluorescent version:** place the circuline bulb into the lampholder "J" and take care to clamp the fluorescent tube inside the two plastic clips "Z".
 - .6. **Diffuser Installation:** First of all insert the plastic bushing "X" into the three glass holes.
 - .7. Place the diffuser on structure matching the three holes with the corresponding "C" treaded holes on structure. Than place the disk "E" and lock it with the three "F" screws provided.
- PAY ATTENTION TO TIGHTEN MODERATELY BY FINGERS. DO NOT USE TOOLS.**
- .8. Place cover "G" on the middle magnet as shown. Restore power.

PLANET 48: max 6x40W 120V G9
max 1x40W - 120 or 277V 2GX13 FC12T5

PLANET 65: max 6x40W 120V G9
max 1x40W - 120 or 277V 2GX13 FC12T5
max 1x22W - 120 or 277V 2GX13 FC9T5

For additional information please contact your local dealer
or **LEUCOS U.S.A.** at: Tel. (732) 225-0010 Fax. (732) 225-0250
www.leucos.com - info@leucosusa.com

Halogen version:

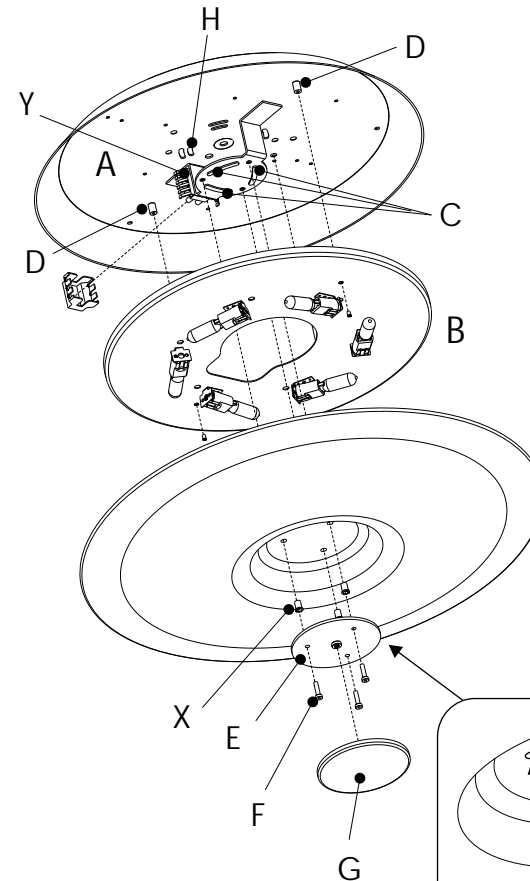

Fluorescent version:

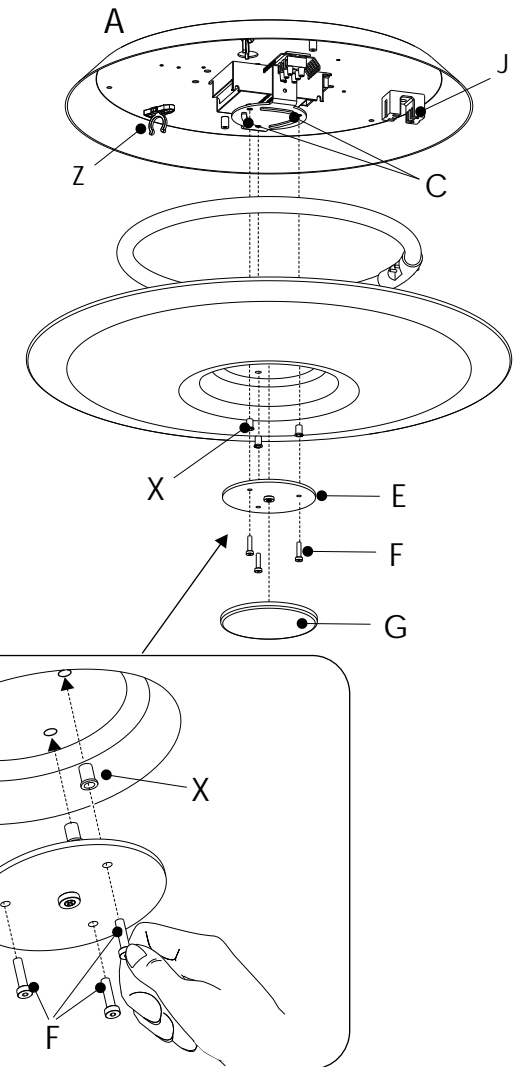

FOR U.S.A. MARKET ONLY

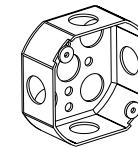

MOUNTS TO STANDARD JUNCTION BOX

CIRCUIT DIAGRAM:

