

INSTALL GLASS

- To install glass, position round part (A) in center of glass (B) and align holes in glass (B) with holes on round part (A).
- Slide stems (C) through the glass into round part (A).

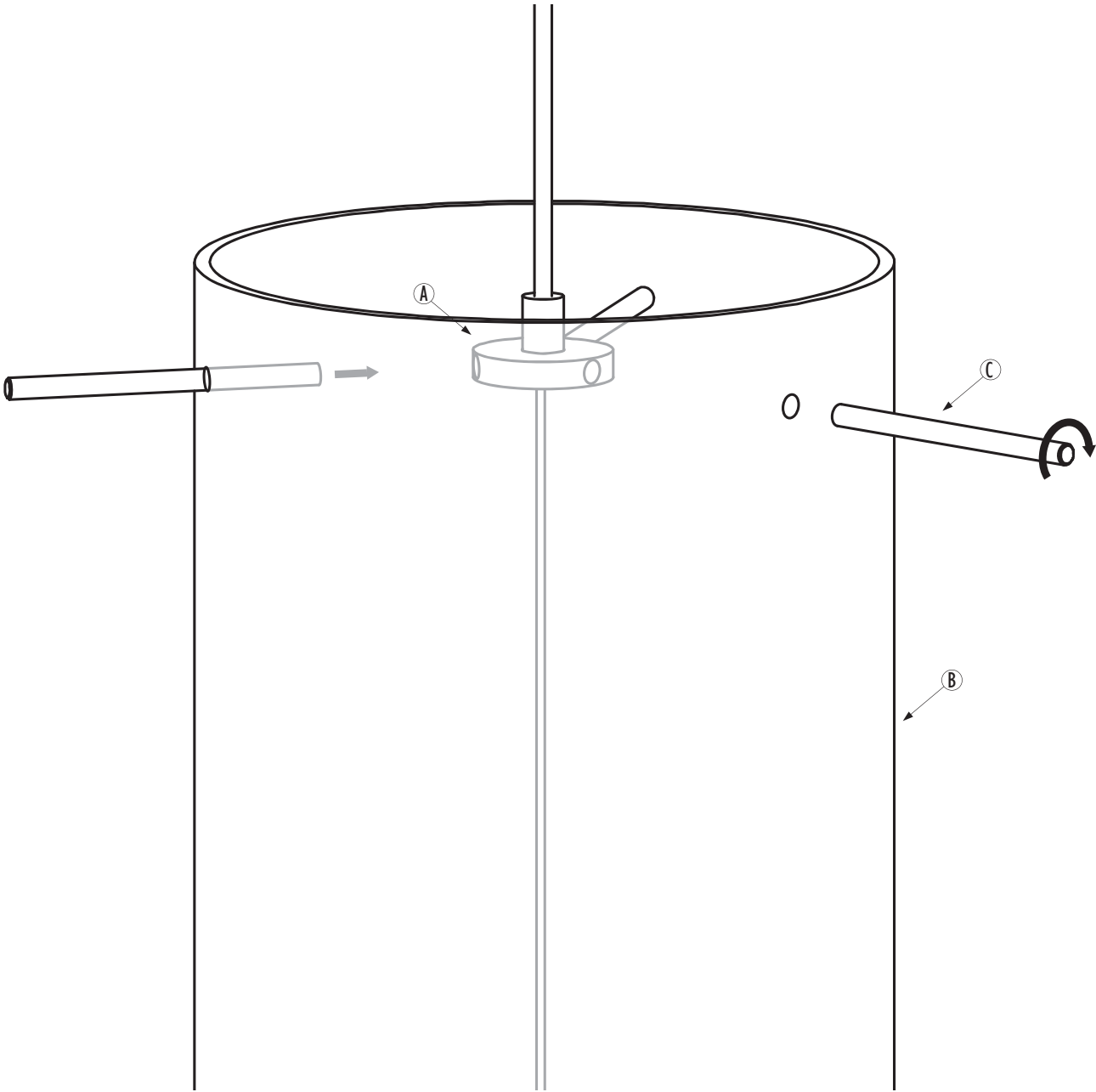

REGAL LED DOWN

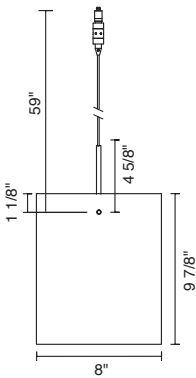
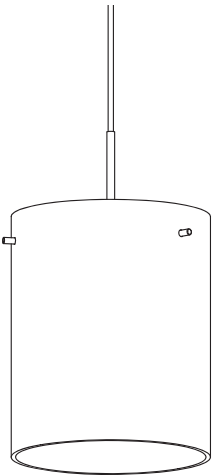

IMPORTANT SAFETY INSTRUCTIONS



1. Save these instructions and refer to them when additions to or changes to the fixture are made.
2. KEEP THIS INSTRUCTION AND REFER TO THEM WHEN ADDING ADDITIONAL FIXTURES, MODIFICATIONS, OR SERVICES ARE MADE.
3. THIS PRODUCT MUST BE INSTALLED BY A PERSON FAMILIAR WITH THE CONSTRUCTION AND OPERATION OF THE PRODUCT AND THE HAZARDS INVOLVED, IN ACCORDANCE WITH THE APPLICABLE NEC CODE.
4. Do not install this fixture in damp or wet locations.
5. CAUTION - Do not install any fixture assembly closer than 6 inches from any curtain, or similar combustible material. Turn off power prior to any work on the systems. Warranty is void in case of unauthorized modifications and/ or improper use.

READ ALL OF THESE INSTRUCTIONS BEFORE INSTALLATION

PART NUMBERS

222 871bz	bronze, apricot glass	222 873bz	bronze, merlot glass
222 871ch	chrome, apricot glass	222 873ch	chrome, merlot glass
222 871mc	matte chrome, apricot glass	222 873mc	matte chrome, merlot glass
222 872bz	bronze, white glass	222 874bz	bronze, brown glass
222 872ch	chrome, white glass	222 874ch	chrome, brown glass
222 872mc	matte chrome, white glass	222 874mc	matte chrome, brown glass

INSTALLATION INSTRUCTIONS

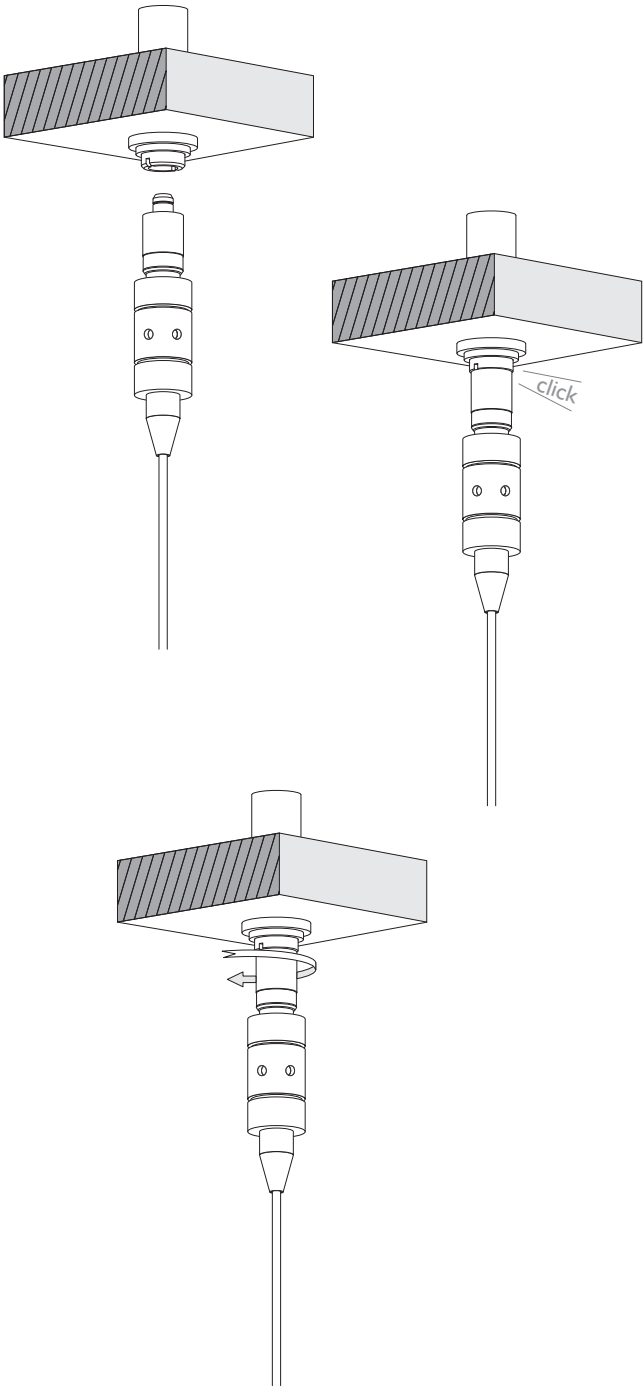

NOTE

Fixture cannot be shortened in the field.

INSTRUCTIONS FOR USE

- Mount the fixture to the canopy or adaptor by plugging in the Uni-Plug. The Uni-Plug will 'click' when properly inserted. Tighten the retaining collar to complete the installation (see diagram).