

DESCRIPTION

- Chrome plated metal construction
- 1/2" IPS connections will accept standard ball nose connection for 3/8" tubing

OPERATION

- Acrylic knob style handles
- Rotate either handle counterclockwise to open and clockwise to close

FLOW

- Aerator is limited to 2.2 gpm max (8.3 L/min)

CARTRIDGE

- 1224 cartridge design
- Nonmetallic and stainless steel material

STANDARDS

- Third party certified by CSA to meet CSA B-125 and ASME A112.18.1M and all applicable requirements referenced therein.
- Certified to ANSI/NSF 61/9
- Complies with California Proposition 65 and with the Federal Safe Water Drinking Act

WARRANTY

- Lifetime limited warranty against leaks, drips and finish defects to the original consumer purchaser
- 5 year warranty if used in commercial installations

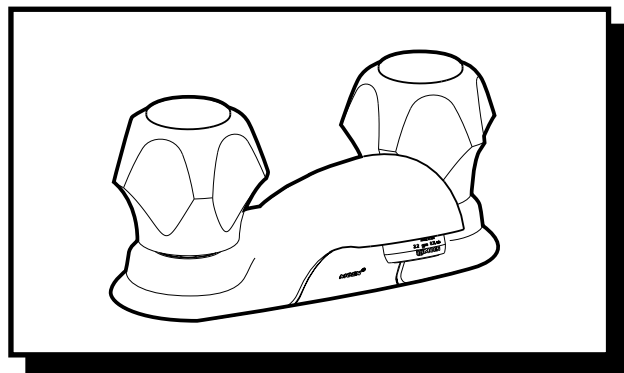

MOEN® Two-Handle Lavatory Faucet Without Waste Assembly

Models: 84433

NOTE: See reverse side for
illustrated parts and optional handle inserts

NOTE: THIS FAUCET IS DESIGNED TO BE IN-
STALLED THRU 3 HOLES, 1" MIN. DIA.

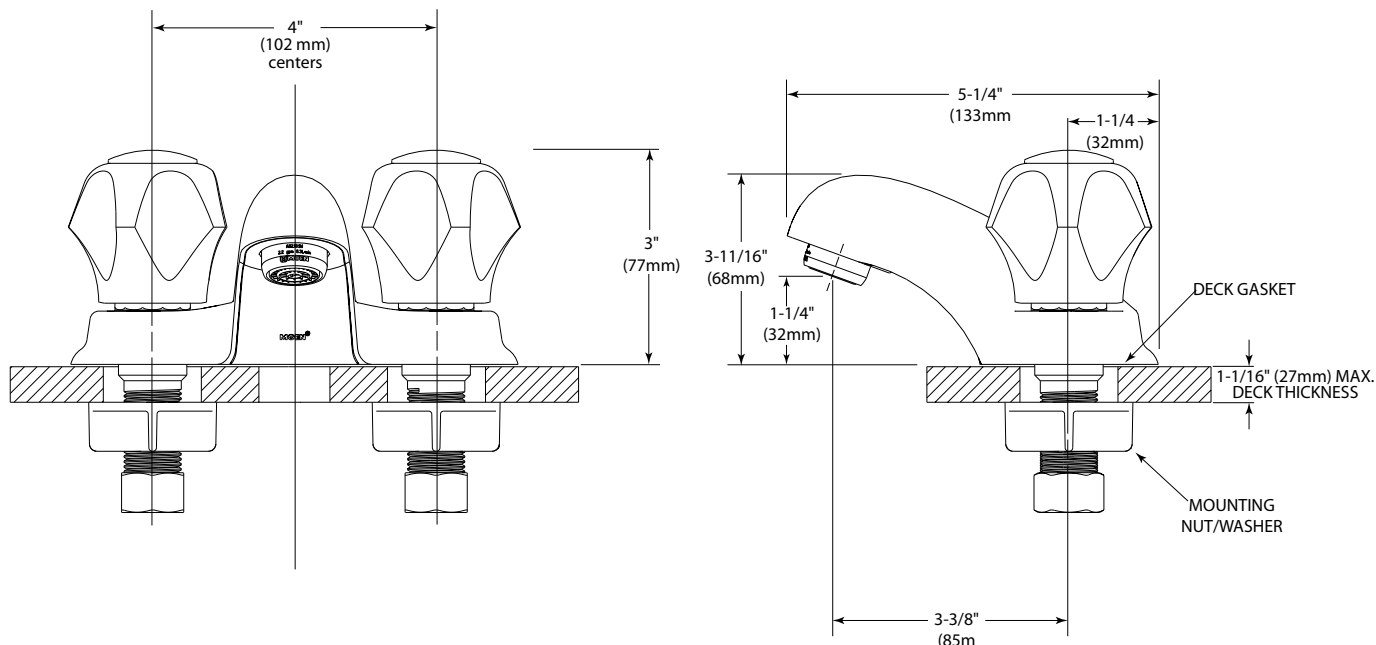

CRITICAL DIMENSIONS

(DO NOT SCALE)