

**Exploded View**

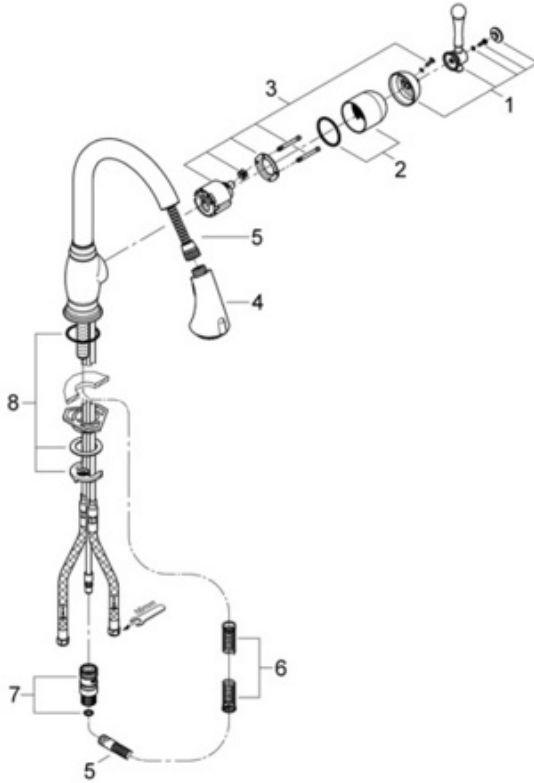

**Parts Breakdown**

Pos No.	Spare Part Description	Product No.	Pcs.
	<b>33 870</b>		
1	Lever assembly	46 593	1
2	Cover cap	46 243	1
3	Ceramic cartridge	46 048	1
4	Hand held spray	46 173	1
5	Hose	46 174	1
6	Pressure spring	07 240	1
7	Quick coupling	46 315	1
8	Mounting kit	46 345	1