

### Specifications:

**Construction:** Electronic circuitry encapsulated in a flame retardant plastic casing to withstand harsh and damp conditions.

**Specifications:**

- 120, 230, or 277 VAC input.
- 11.6 Volt output for use with 12 Volt lamps.
- Power factor > .93.
- THD < 20%.
- Operating frequency > 20 kHz.
- Class A insulation system, maximum transformer temperature 90°C.
- Minimum operating temperature of -15°C.
- Minimum load of 10 Watts.
- Dimmable (120 VAC input model only). Generally the dimmer should have a minimum load of 40 Watts for proper functioning.
- For non short proof units, do not short output conductors.

**Certification:** CSA & UL tested & certified to US and Canadian safety standards.

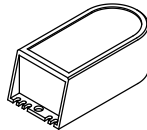
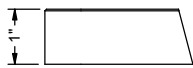
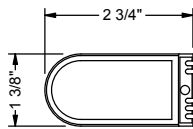

75 VA Transformer

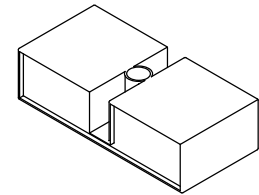
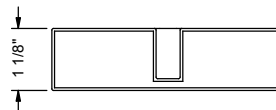
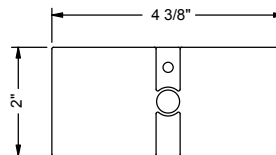

150 VA Transformer



### Ordering Information:

XM3		
Model	Wattage	Voltage
XM3 - Electronic Transformer	75 - 75 VA	120 - 120 Volts
	150 - 150 VA	230 - 230 Volts <sup>1</sup>
		277 - 277 Volts

**Notes:**

1. 230 Volt input is not available with 150VA Wattage.
2. Specifications, certifications, and ordering information are subject to change. Please check website for latest specification sheets.

Example: **XM3 - 75 - 277**